

LANDSCAPE DESIGN REPORT

46 WEST ST
ROCHEDALE 4123

06.08.2025

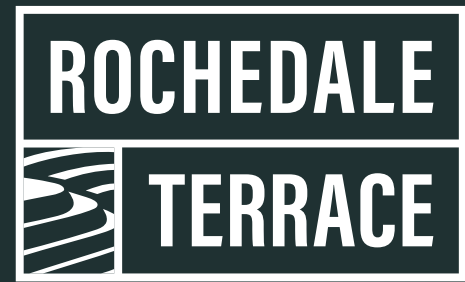

ACKNOWLEDGEMENT OF COUNTRY

The project team acknowledges that the Traditional Custodians of the land have for tens of thousands of years managed, cultivated and cared for the landscape where our towns and cities were established and continue to grow.

We acknowledge and respect their connection and care of Country, and to honour this we strive to create places and spaces that benefit all.

DOCUMENT TRACKER

Rev A	Issued 08 March 2024	Authorised by BN
Rev B	Issued 11 March 2024	Authorised by BN
Rev C	Issued 10 April 2024	Authorised by BN
Rev D	Issued 19 April 2024	Authorised by BN
Rev E	Issued 07 August 2024	Authorised by NC
Rev F	Issued 12 August 2024	Authorised by NC
Rev G	Issued 21 August 2024	Authorised by BN
Rev H	Issued 30 August 2024	Authorised by BN
Rev I	Issued 2 September 2024	Authorised by BN
Rev J	Issued 12 September 2024	Authorised by BN
Rev H	Issued 02 July 2025	Authorised by BN
Rev I	Issued 09 July 2025	Authorised by BN
Rev J	Issued 10 July 2025	Authorised by BN
Rev H	Issued 06 August 2025	Authorised by BN

PROJECT TEAM

ARCADIA

Arkhefield

CONTENTS

01	DESIGN ASPIRATIONS	5	03	LANDSCAPE PROGRAMMING AND CHARACTER	17
	LANDSCAPE VISION	6		LANDSCAPE PROGRAMMING	18
	LANDSCAPE PRINCIPLES	7		LANDSCAPE CHARACTER	19
	DESIGN DRIVERS AND STRATEGIES	8			
02	PROJECT BENCHMARKS	13	04	LANDSCAPE CONCEPT DESIGN	27
	DESIRED OUTCOMES	14		LANDSCAPE MASTERPLAN	28
	BENCHMARK PROJECTS	15		LANDSCAPE DETAIL AREAS	34
				PLANTING DEPTHS AND DEEP SOIL ZONES	42
				PLANTING PALETTE	47
				MATERIALS PALETTE	49



01 DESIGN ASPIRATIONS

- Landscape Vision
- Landscape Principles
- Design Drivers and Strategies

LANDSCAPE VISION

Supporting the Project Vision, the Landscape Vision guides the outdoor realm for the Rochedale Terrace:

“A Transient Water Journey Amidst The Paper Bark”

The landscape will create a community heart enriched with activity, vibrancy and social connection. It will embrace the site’s unique ecologies to enrich biodiversity and create experiences celebrating the adjacent creek and surrounding habitats.



ROCHEDALE TERRACE – DA REPORT

LANDSCAPE PRINCIPLES

BCC DS
RECEIVED
02/09/2025
APPLICATION REF
A006522664



CELEBRATING OVERLAND FLOW

The waterway alongside Rochedale Terraces is exceptionally pure and an inspiring principle and natural element to draw inspiration from, influencing the landscape design. In this landscape, the flow and passive treatment of stormwater will be dynamic and celebrated to maintain the water quality of the waterway and create an immersive and connected experience for the community.



CULTIVATING ECOLOGICAL INTEGRATION AND GREEN CONNECTIVITY

A two part principle; the first to connect community with nature which has proven restorative effects on people. The second to sensitively integrate and enhance the surrounding local creek ecology in an urban context for biodiversity resilience

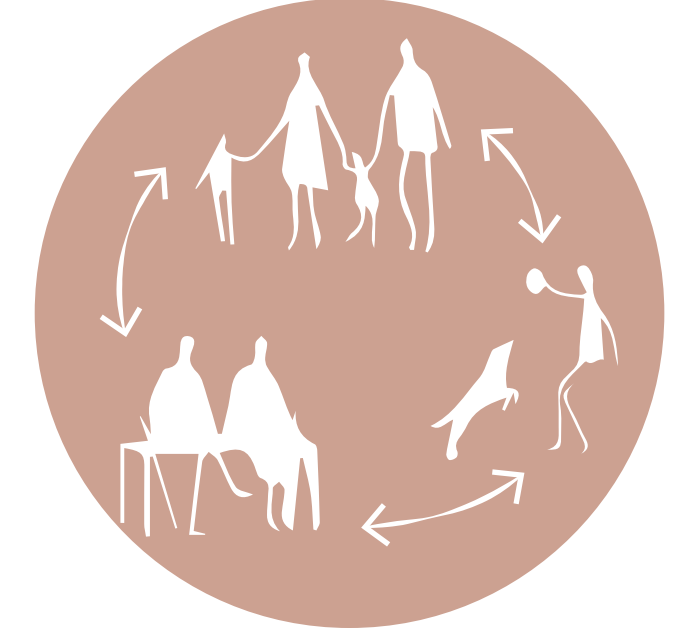

FOSTERING COMMUNITY ENGAGEMENT AND SOCIAL CONNECTIONS

The third landscape design principle will look to enhance the wider urban fabric by providing amenity to local residents and workers and a wide variety of uses and flexible spaces for community engagement, encouraging social connections

DESIGN DRIVERS AND STRATEGIES



BLUE INFRASTRUCTURE

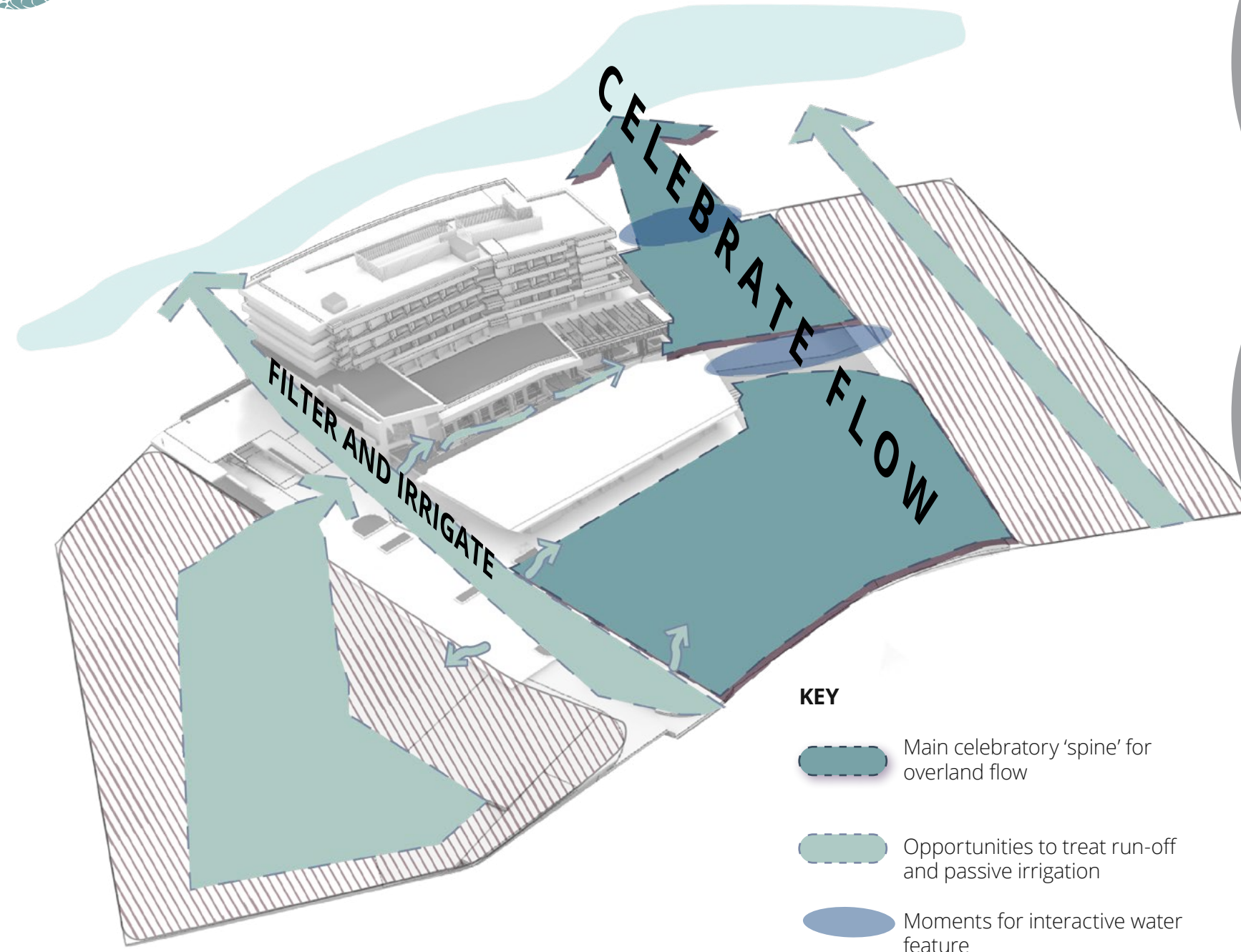

SPATIAL ORGANISATION

KEY

- Main celebratory 'spine' for overland flow
- Opportunities to treat run-off and passive irrigation
- Moments for interactive water feature
- Future stages

Site investigations revealed the incredibly pure water quality of the unnamed waterway adjacent to the Rochedale Terraces site. This has inspired the landscape design and intent to firstly, ensure the pureness of the waterway remains and secondly, to weave this water story throughout the development as a strategy to engage and delight residents and visitors.

Taking advantage of the sloping topography, filter media such as natural gravel, sandstone boulders, rhizomatic plants and meandering swales will work to slow the flow of water (reduce erosion) and filter overland flow before it reaches the creek below.



HOLD

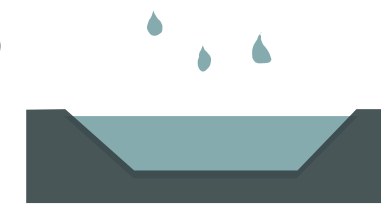

TRICKLE

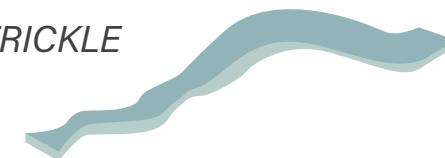

FILTER

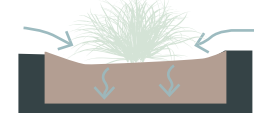

DESIGN STRATEGIES

ROCHEDALE TERRACE - DA REPORT

ROCHEDALE TERRACE - DA REPORT



GREEN CORRIDORS AND INFRASTRUCTURE



SPATIAL ORGANISATION

KEY

- Existing trees
- Future stages



DESIGN STRATEGIES

The overarching strategy to achieve ecological integration and green connectivity is via green infrastructure.

Site investigations revealed ongoing revegetation works to restore the waterway corridor adjacent to the development site. The landscape design firstly draws upon this to bring urban revegetation into the development site through a planting palette comprised of native species that grew within a

10km diameter pre-clearing. This pays tribute to the *genius loci* or 'sense of place' that is in keeping with the local context while providing pockets of ecological patches that contribute to urban ecology.

This is further supplemented by the retainment of 3x significant eucalypt trees and an opportunity to create an urban forest around the park edges that provide shade and visual amenity.

BCC DS
RECEIVED
02/09/2025
APPLICATION REF
A006522664



RESTORE



URBAN FOREST



PERMEATE



Lastly, plants that control erosion and/or are nitrogen fixing will work to retain water and soil health within the site.

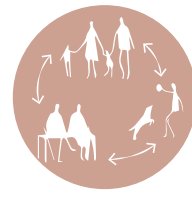

PLACE ACTIVATION

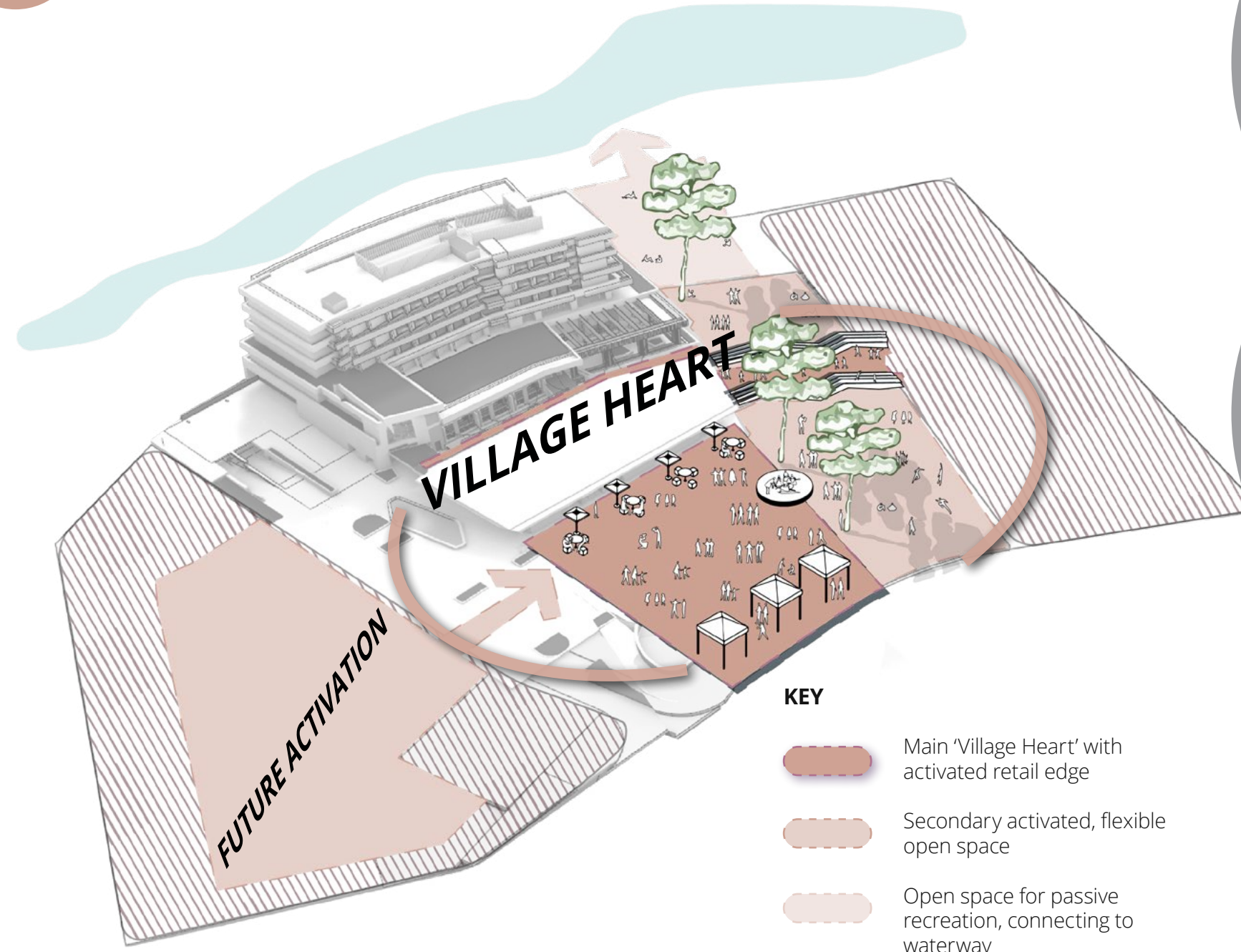

SPATIAL ORGANISATION

- KEY**
- Main 'Village Heart' with activated retail edge
 - Secondary activated, flexible open space
 - Open space for passive recreation, connecting to waterway
 - Future stages

The activation of the landscape spaces focuses on flexibility and multi-functionality.

Firstly, the park spaces have been left largely un-programmed and open to accommodate a range of community activities at varying levels of intensity.

The landscape design utilises blue-green infrastructure which provides both functionality (i.e. urban ecology, water filtration, urban cooling) and unique experiential interactions (sensory experiences of water and local plants).

The retaining structures provide another opportunity to incorporate informal play and interaction while heightening the experience of trickling water during rainfall.



FLEXIBLE

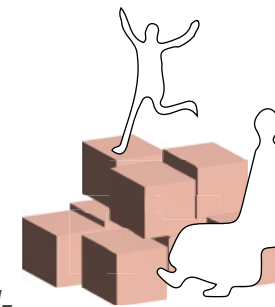

MULTI-FUNCTIONAL

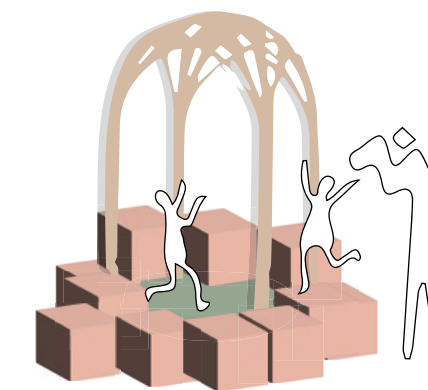

INTERACTIVE

DESIGN STRATEGIES

Unique markers placed at major nodes such as the entryway to the Gorge and at the intersection of the Upper and Lower Terraces provide opportunity as a meeting place and platform for interactive sculptural artworks that create an identifying icon associated with the Rochedale Terraces.

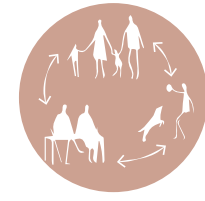

PLACE-INSPIRED FORMS



LOCAL MELALEUCA BARK

'Place-inspired forms' draws on significant local fauna and/or flora as the basis of the design language used throughout the landscape.

Abstracted and re-interpreted, these organic forms reference the patterning found within the melaleuca bark and pay homage to the surrounding landscape.

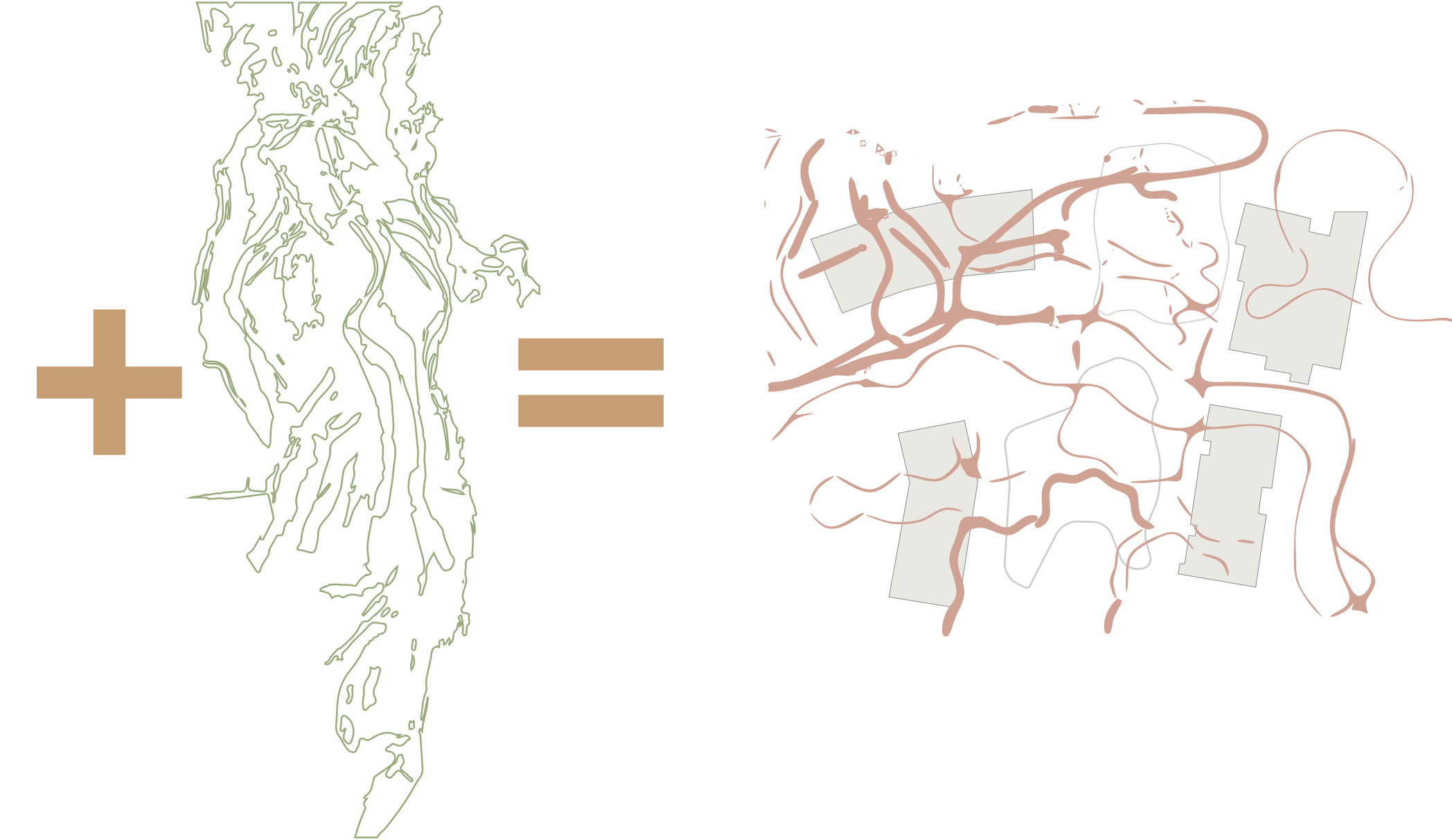

ABSTRACTED FORMS

These melaleuca inspired spaces forms a cohesive design language, tying the landscape together through the design of varying sized nooks and spaces for different scales of activity to occur within the site.



02 PROJECT BENCHMARKS

Desired Outcomes

Benchmark Projects

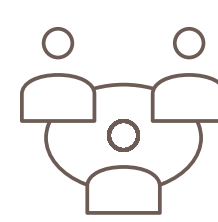

COMMUNITY ENGAGEMENT

Placemaking should involve active participation and collaboration with the local community. Engaging residents, businesses, and other stakeholders throughout the process helps to ensure that the resulting place reflects their needs, aspirations, and values. Community engagement fosters a sense of ownership and pride in the place and encourages ongoing stewardship.

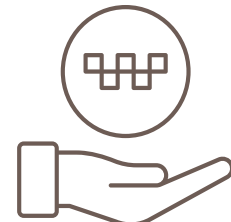

IDENTITY AND CULTURE

Successful placemaking embraces and celebrates the unique identity and culture of the community. It should reflect the local history, traditions, and character, creating a sense of place that is distinct and authentic. Incorporating local art, architecture, and design elements can help reinforce the cultural fabric of the community overall experience and encourage people to spend time in the place.

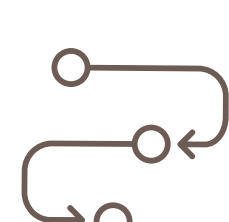

ACCESSIBILITY AND CONNECTIVITY

A well-designed place should be accessible and connected to its surroundings. It should provide various modes of transportation, including pedestrian-friendly infrastructure, bicycle lanes, and public transit options. Easy access for people of all abilities is crucial, ensuring that the place is inclusive and welcoming to everyone.

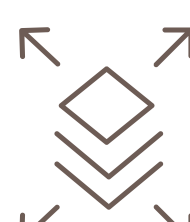

FUNCTIONALITY AND FLEXIBILITY

A successful place should be versatile and adaptable to accommodate a range of activities and uses. It should be designed to support a variety of functions, such as social interactions, recreation, commerce, and cultural events. Flexibility in design allows the space to evolve and respond to changing needs and trends over time.



GREEN AND SUSTAINABLE FEATURES

Integrating green spaces, landscaping, and sustainable design principles is essential for creating a healthy and environmentally friendly place. Incorporating trees, plants, and green infrastructure not only enhances the aesthetic appeal but also improves air quality, provides shade, and promotes biodiversity. Sustainable features like renewable energy, rainwater harvesting, and efficient use of resources contribute to the long-term viability of the place.



SAFETY AND COMFORT

Safety and comfort are critical aspects of placemaking. Well-lit spaces, clear wayfinding, and proper signage help ensure the safety and security of users. Comfortable seating, shading, and amenities like public restrooms and drinking fountains enhance the overall experience and encourage people to spend time in the place.



ACTIVATION AND PROGRAMMING

A successful place should be vibrant and activated, attracting people and creating a sense of vitality. Programming events, festivals, markets, and performances can activate the space and encourage community interaction. Providing opportunities for active and passive recreation, such as sports facilities, playgrounds, and relaxation areas, also contributes to the liveliness and attractiveness of the place.

WEST END VILLAGE



A highly activated retail development with flexible spaces and key urban forest draw card with sculpture and play trails coupled with weekend markets, events and community functions.



FISH LANE TOWN SQUARE



This highly popular precinct transformed the infrastructure under-belly of South Brisbane into a cool micro-climate for a thriving and rich diversity of cultural eateries with the lush sub-tropical identity of the greater area allowing for both work and play within the same precinct.



JAMES STREET PRECINCT



The high end retail precinct boasts large canopies and dense lush planting on the street level, enhancing comfortability, visual appeal and a wider green strategy approach.



BCC DS RECEIVED
02/09/2025
APPLICATION REF
A006522664

THE CANOPY LANE COVE



The bustling hub at Lane Cove invites a vast array of user profiles to this mixed-use space, opening endless opportunities for events and encouraging long-term use of the precinct's facilities.



PALMWOODS TOWN SQUARE



By working in collaboration and hosting design workshops with the people of the place, the resulting Town Square design is a highly responsive public space that works to facilitate the needs of community.



YAGAN SQUARE



A flourishing Town Centre designed with Country strategies to provide safe, activated places for visitors, ecologies and local groups, recognising the importance of First Nations advocacy and place identity.



03 LANDSCAPE PROGRAMMING AND CHARACTER

- Landscape Programming
- Landscape Overlays
- Landscape Character



LANDSCAPE PROGRAMMING

- 01. UPPER AND LOWER TERRACES**
 - > Public park characterized by sloping topography and terracing
- 02. ACTIVATED RETAIL EDGE**
 - > Interface with proposed Tavern and retail
 - > Strong connection to terraces
- 03. VILLAGE HEART**
 - > Event space for formalised and resident organised events.
 - > Flexible breakout interface with retail and dining - centralised gathering.
- 04. GREEN SPINE**
 - > A pedestrian prioritised green spine drawing users through the park space, while encouraging connection deeper in the community hub
- 05. THE GORGE**
 - > A space for relaxation and immersion that is shaded and embedded with fine grain detail and vegetation
- 06. ENTRY SEQUENCE**
 - > Feature entry threshold to demarcate site entry and assist with wayfinding

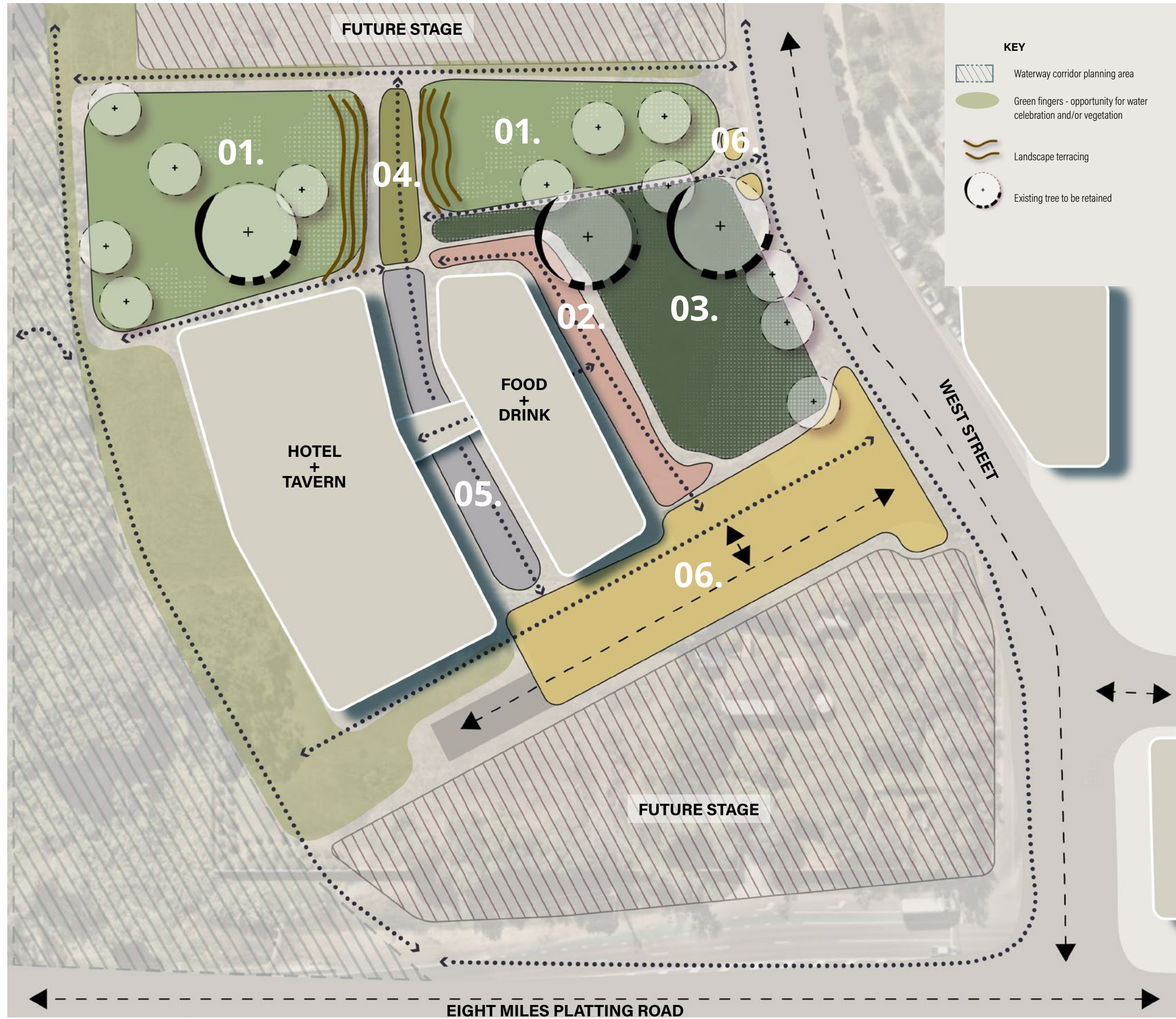

1:750 @ A3 0 7.5 15 30m

ARCADIA

- 01. UPPER TERRACE**
 1. Planting character tying in with the surrounding ecology of Eucalypts and Melaleucas
 2. Integrating with the Green Spine and Active Retail edge by providing spill out areas
 3. Terracing with natural stone, celebrate local geology and provides large group seating
 4. Open and flexible space supporting a variety of community activities

KEY PLAN



ARCADIA



LANDSCAPE CHARACTER

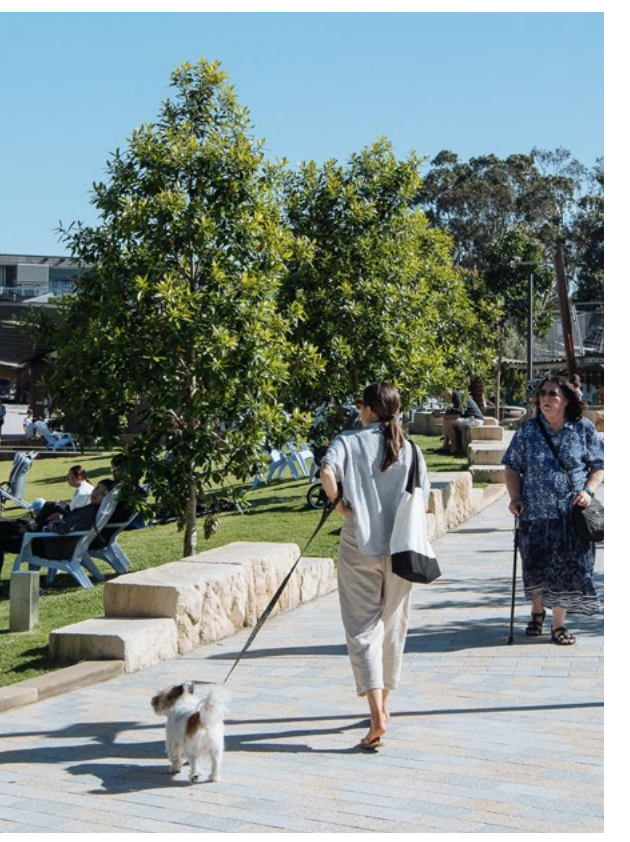
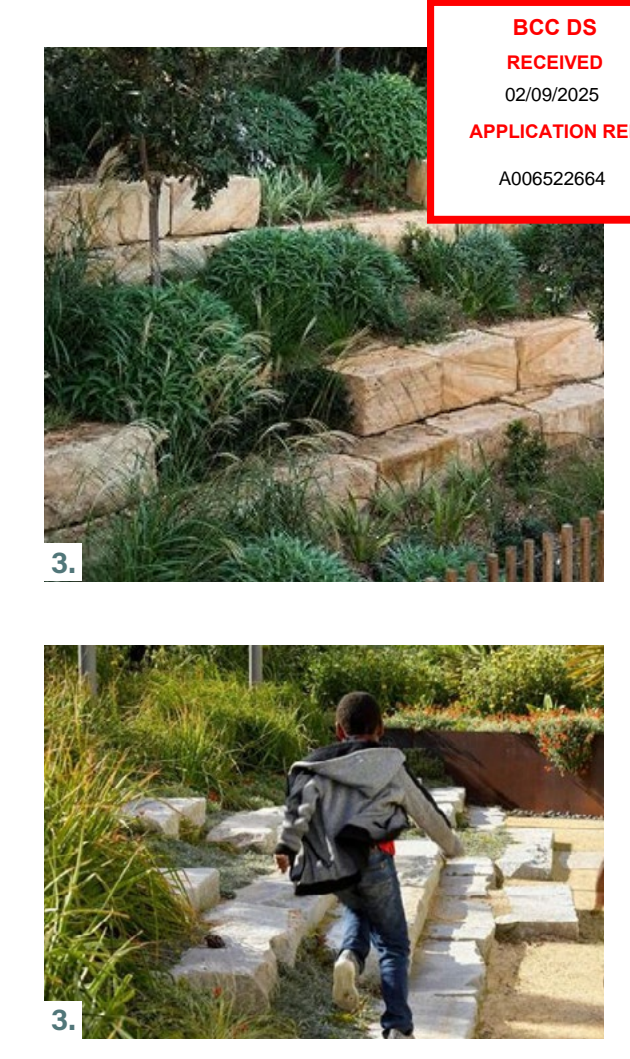

BCC DS
RECEIVED
02/09/2025
APPLICATION REF
A006522664

BCC DS
RECEIVED
02/09/2025
APPLICATION REF
A006522664

01.

LOWER TERRACE

- 1. Open and flexible space supporting a variety of community activities
- 2. Planting character tying in with the surrounding ecology of Eucalypts and Melaleucas
- 3. Terracing with concrete and natural sandstone provides large group seating
- 4. Opportunity for informal play and learning with art/sculptural pieces
- 5. Opportunity for locals to connect with waterway corridor and informal riparian play for children utilising blue and green infrastructure incl. riparian revegetation

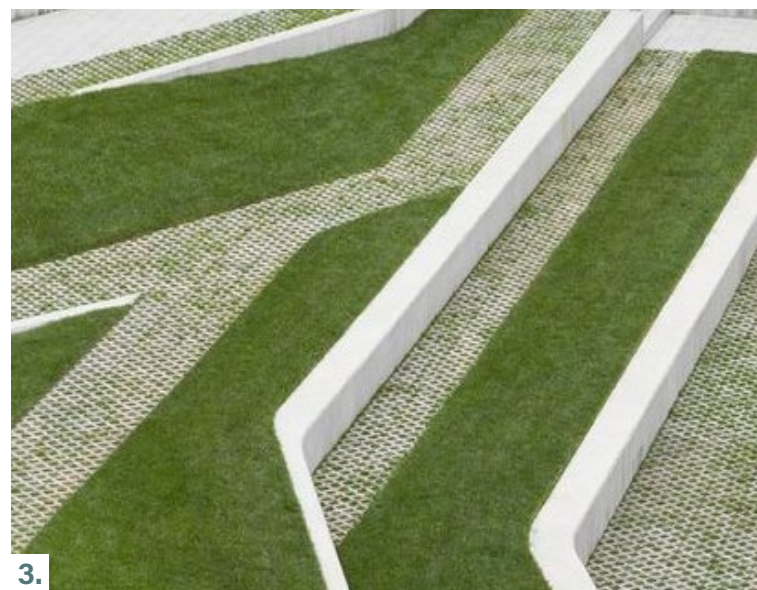

KEY PLAN



02.

ACTIVATED RETAIL EDGE

- 1. Opportunity for planting in decorative pots and planters for flexibility
- 2. Lush sub-tropical character spatially delineates the retail edge from the public park character
- 3. Vibrant retail edge with opportunities for integrated lighting/art/signage strategy
- 4. Concrete terracing multi-functioning as flexible seating and retaining
- 5. Opportunity for high quality paving and sculptural elements at nodal points that multi-functions as wayfinding cues
- 6. Loose and fixed furniture for flexible group seating

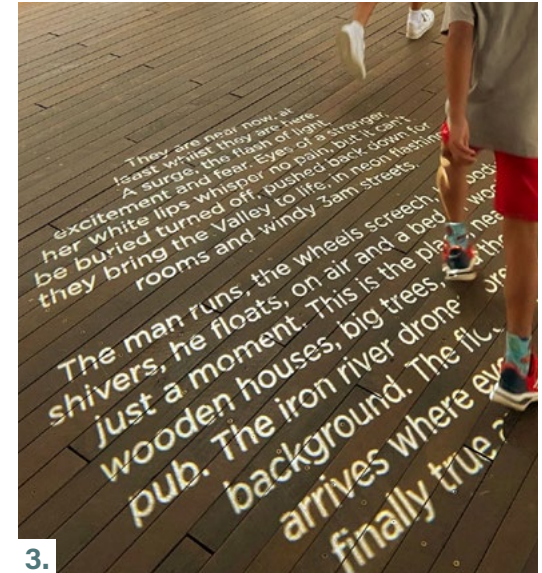

KEY PLAN

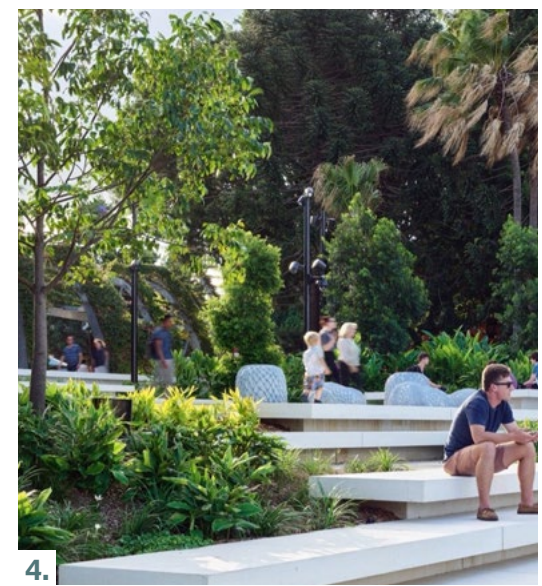

03.

VILLAGE HEART

- 1. Heart of the Rochedale terraces characterised by a flexible open space with opportunity for community spill out events and markets
- 2. Public park and private retail space delineated with concrete terraces that multi-functions as seating and retaining, interspersed with sub-tropical planting for a lush edge
- 3. Larger shade trees with subtle batters provide shade while sensitively working with site topography
- 4. Outdoor stage provides opportunity for social, cultural and artistic performances

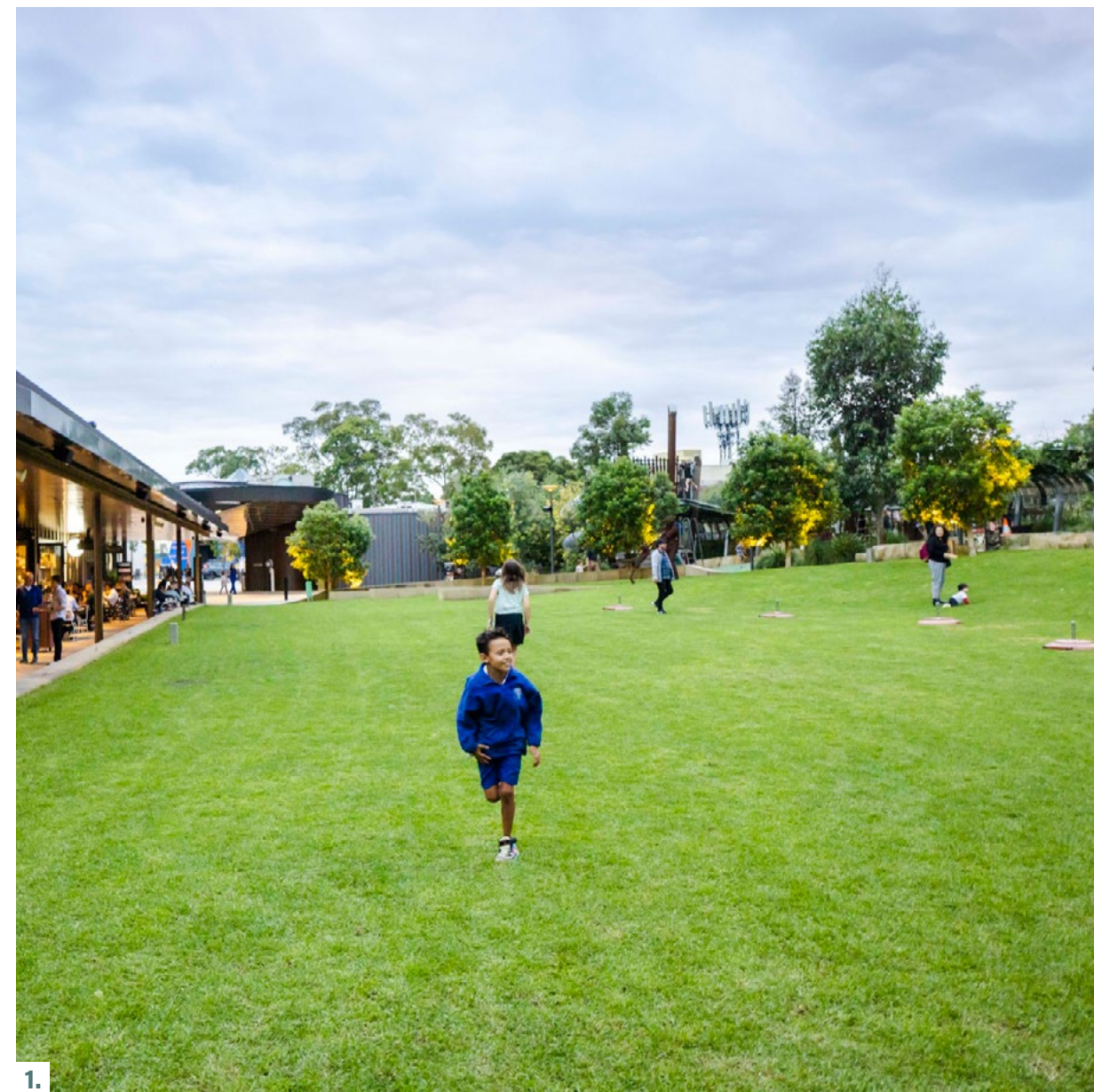

1.



1.

KEY PLAN



2.

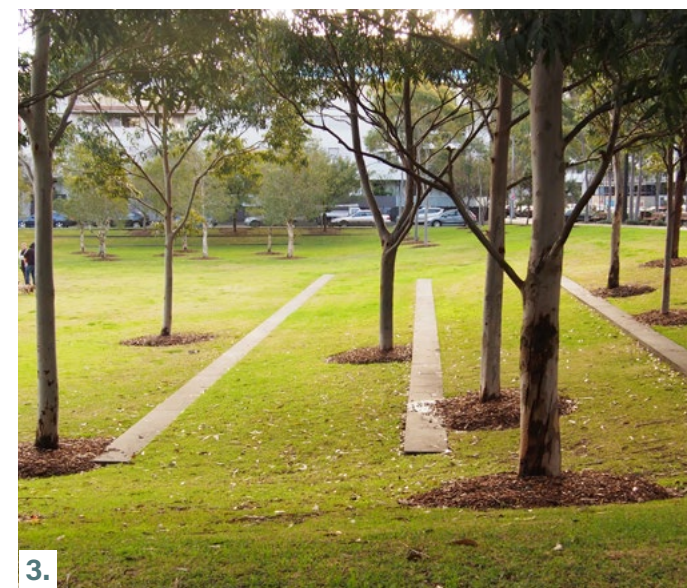

3.

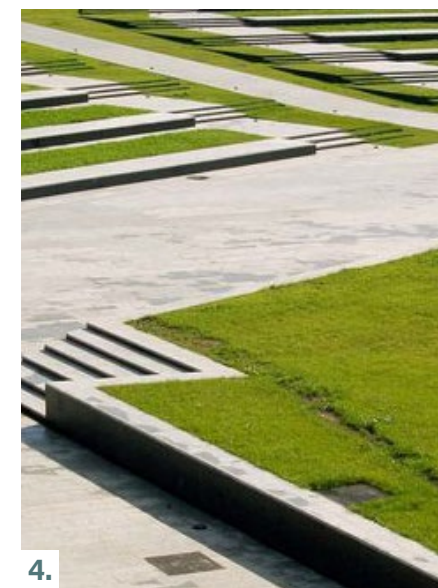

4.

04.

GREEN SPINE

- 1. A lush, interactive green spine that connects pedestrians between the Upper and Lower Terraces to The Gorge
- 2. Provide opportunities to celebrate the landscape character with integrated boulders and local planting species
- 3. Opportunity for climbers to provide a vertical frame of green
- 4. Opportunity for small art/ sculptural pieces
- 5. Opportunity to celebrate the water narrative of the site with plants drawn from the adjacent riparian corridor



1.



3.



4.

KEY PLAN

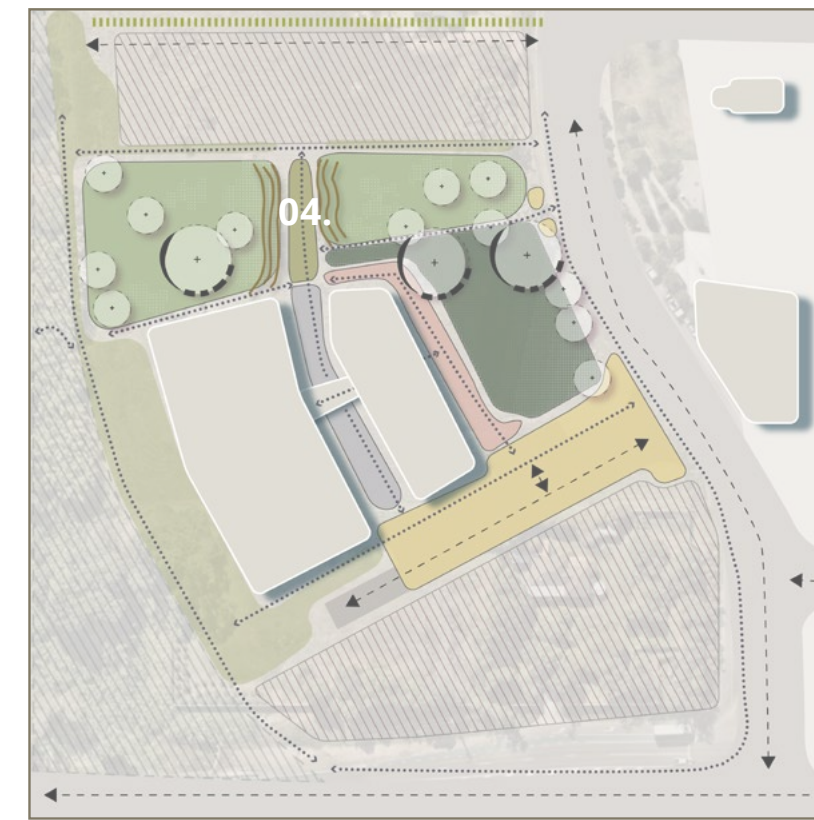

2.



5.

BCC DS
RECEIVED
02/09/2025
APPLICATION REF
A006522664

05.

THE GORGE

- 1. A sunken 'gorge' like space with a connective terrace spanning from the upper floor to the lower floor
- 2. Emphasising verticality through verdant columnar planting and cascading groundcovers from podium and rooftop planting
- 3. Integrated public seating opportunities support adjacent retail activity
- 4. Opportunity to celebrate water through pavement patterns and wet/dry elements (within private boundary only - not in public park)

KEY PLAN



1.



2.



3.



4.

06.

ENTRY SEQUENCE

- 1. Feature entry planting and sculptural piece using local sandstone create a landmark arrival experience as well as an 'identity' piece for residents
- 2. Pavement treatments soften and create visual interest as part of the entry experience
- 3. Planting cultivates biodiversity by drawing from the surrounding local ecology while requiring low maintenance
- 4. Opportunity to provide continuous canopy cover and seating nooks for comfort

KEY PLAN



1.



1.

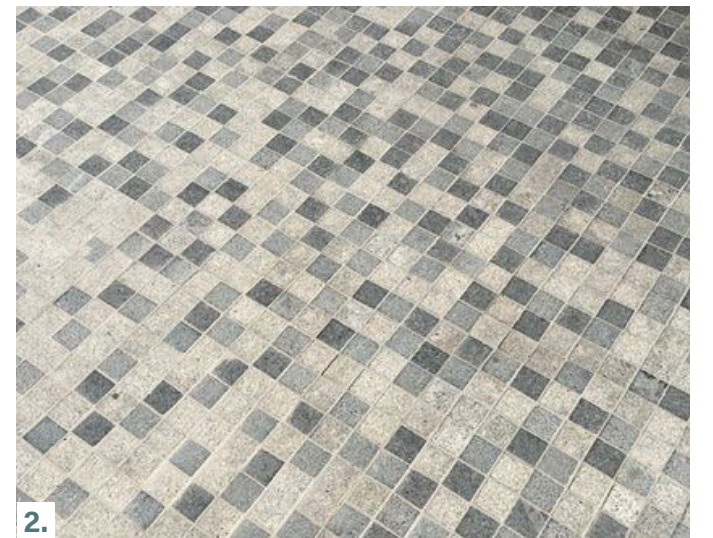

2.



3.



4.

BCC DS
RECEIVED
02/09/2025
APPLICATION REF
A006522664



04 LANDSCAPE CONCEPT DESIGN

- Landscape Masterplan
- Landscape Detail Plans
- Landscape Sections
- Planting Palette
- Materials Palette

LANDSCAPE MASTERPLAN

KEY

- 01 Village Heart
- 02 Upper Terrace
- 03 Lower Terrace
- 04 Sandstone blocks of varied height forms retaining and informal play element
- 05 Concrete terraces interspersed with planting
- 06 Existing trees to be retained
- 07 Green buffer envelope to building. Planting to slow overland flow and filter water
- 08 Concrete terracing with sub-tropical canopy plantings
- 09 Pedestrian priority treatment
- 10 Future cycleway land dedication
- 11 3000mm wide, DDA compliant maintenance path
- 12 Feature shade tree with lush understorey planting to assists with wayfinding and place activation
- 13 Ramp down to parking
- 14 Cascading planting to retail forms a vertical green edge
- 15 Mounded sandstone terraces demarcated with feature tree for arrival experience
- 16 Key pedestrian cross over connection from town centre
- 17 Short term drop off area
- 18 Short stay parking
- 19 Pavement treatment to carpark bays
- 20 1:4 turf embankment up to road level
- 21 Van bay for equipment dropoff and loading to outdoor stage
- 22 Outdoor stage for artistic, social/cultural performances for the public with a 450mm high seating wall edge
- 23 Angled Hardwood Bollards along park edge
- 24 1800mm high Fence to Northern interface of park



ROCHEDALE TERRACE - DA REPORT

ROCHEDALE TERRACE - DA REPORT

SECTION A-A: ACTIVE TRANSPORT AND WATERWAY BUFFER



SECTION B-B: PARK CROSS SECTION

ROCHEDALE TERRACE - DA REPORT

ROCHEDALE TERRACE - DA REPORT

BCC DS
RECEIVED
02/09/2025
APPLICATION REF
A006522664

KEY

- 01 Low maintenance buffer planting between public space and future residential development
- 02 3000mm wide, DDA compliant maintenance path
- 03 450mm high sandstone block seating wall along edge of path
- 04 Existing tree to be retained
- 05 Flexible, flat public open space supporting a variety of local recreational needs
- 06 1800mm high Fence to Northern interface of park



KEY

- 01 Celebrate existing tree with concrete terrace seating and feature planting
- 02 Existing tree to be retained
- 03 Flexible, flat public open space supporting a variety of local recreational needs
- 04 Outdoor stage for artistic, social/cultural performances for the public with a 450mm high seating wall edge
- 05 Mounded sandstone terraces demarcated with feature tree for arrival experience

1:100 @ A3 0 0.5 1 2 3 4m

1:100 @ A3 0 0.5 1 2 3 4m

ARCADIA

ARCADIA

SECTION C-C: UPPER AND LOWER TERRACE CROSS SECTION

SECTION C-C: UPPER AND LOWER TERRACE CROSS SECTION

KEY

- 01 Celebrate existing tree with concrete terrace seating and feature planting
- 02 Existing tree to be retained
- 03 Flexible, flat public open space supporting a variety of local recreational needs
- 04 Concrete terrace seating with sub-tropical planting of varying canopy heights create a lush interface between the retail and public domain

KEY

- 01 Sandstone blocks at varying heights interspersed with native planting create a delightful nature and explorative play in lieu of the traditional playground
- 02 Opportunity for passive irrigation design through mass planting of low maintenance, native plant species with nitrogen-fixing properties and rhizomatic root structures that minimise soil erosion
- 03 Feature shade tree with lush understorey planting to assist with wayfinding and place activation
- 04 Sub-tropical planting of varying canopy heights create a lush interface between the retail and public domain

BCC DS
 RECEIVED
 02/09/2025
 APPLICATION REF
 A006522664



SECTION C-C: UPPER AND LOWER TERRACE CROSS SECTION

KEY

- 01 Multi-functional, concrete terrace acts as seating and retaining infrastructure while ensuring flat levels for kickabout space
- 02 Existing tree to be retained
- 03 Flexible, flat public open space supporting a variety of local recreational needs
- 04 Sub-tropical green buffer to carpark



SECTION D-D: PUBLIC PARK AND GORGE INTERFACE

BCC DS
RECEIVED
 02/09/2025
APPLICATION REF
 A006522664



KEY

- 01 Low maintenance buffer planting between public space and future residential development
- 02 3000mm wide, DDA compliant maintenance path
- 03 Sandstone blocks at varying heights interspersed with native planting create a delightful nature and explorative play in lieu of the traditional playground
- 04 Opportunity for passive irrigation design through mass planting of low maintenance, native plant species with nitrogen-fixing properties and rhizomatic root structures that minimise soil erosion
- 05 Feature shade tree with lush understorey planting to assist with wayfinding and place activation
- 06 Sub-tropical planting of varying canopy heights create a lush interface between the retail and public domain
- 07 1800mm high Fence to Northern interface of park

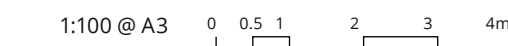

LANDSCAPE DETAIL AREAS

VILLAGE HEART

KEY

- 01 Village Heart
- 02 Existing tree to be retained
- 03 Concrete seat terracing to existing tree with informal steppers through garden create an informal play element
- 04 1:4 turf batter with terrace seating up to road level
- 05 Concrete terraces interspersed with planting provide seating opportunity along park interface and shade
- 06 Mounded sandstone terraces demarcated with feature tree for arrival experience
- 07 Outdoor stage for artistic, social/cultural performances for the public with a 450mm high seating wall edge
- 08 Van bay for equipment dropoff and loading to outdoor stage
- 09 Pedestrian pathway connecting the Village Heart to the Upper and Lower Terraces



SECTION E-E: VILLAGE HEART INTERFACE



KEY

- 01 Concrete terrace seating interspersed with planting provides seating opportunity and delineates the public park from the retail space.
- 02 Flexible, flat public open space supporting a variety of local recreational needs including both active and passive recreation
- 03 Existing tree to be retained
- 04 1:4 turf embankment up to road level with integrated terrace seating with wide canopy shade trees
- 05 Streetscape with 2000mm wide path of continuous travel
- 06 Planted street verge
- 07 1500mm wide, DDA compliant maintenance path

SECTION F-F: OUTDOOR STAGE CROSS SECTION



KEY

- 01 Feature entry tree with sandstone block terracing interspersed with native planting form part of the arrival experience and creates backdrop to outdoor stage
- 02 Outdoor stage for artistic, social/cultural performances for the public with a 450mm high seating wall edge
- 03 Flexible public open space - Village Heart

OUTDOOR STAGE: DESIGN INTENT

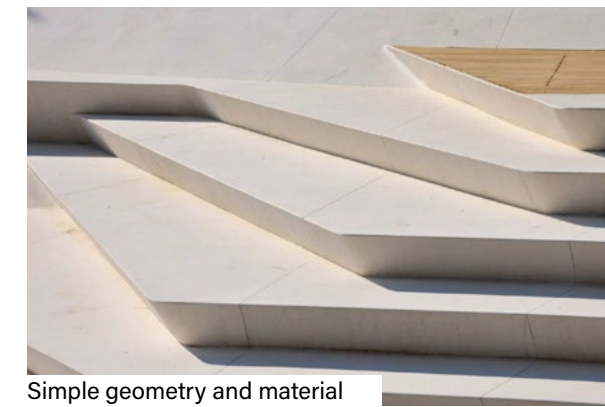

The community stage is integrated as part of the Village Heart. With a footprint of 50m², it can comfortably accommodate groups of 15 - 20 people and equipment.

This asset would be managed by council with members of the public being able to book the stage through BCC.

1:100 @ A3 0 0.5 1 2 3 4m

SECTION G-G: OUTDOOR STAGE LONG ELEVATION



BCC DS
RECEIVED
02/09/2025
APPLICATION REF
A006522664

KEY

- 01 Turf batter up to road level
- 02 Flexible, flat public open space (Village Heart) supporting a variety of local recreational needs
- 03 Outdoor stage for artistic, social/cultural performances for the public with a 450mm high seating wall edge
- 04 Feature entry tree with sandstone block terracing interspersed with native planting form part of the arrival experience and creates backdrop to outdoor stage
- 05 Access to stage from carpark for unloading equipment
- 06 Access to stage from West Street

1:100 @ A3 0 0.5 1 2 3 4m

THE GORGE

KEY

- 01 Feature shade tree with lush understorey planting to assists with wayfinding and place activation
- 02 Green buffer envelope to building. Planting to naturally slow overland flow and filter water
- 03 Native planting interspersed within sandstone blocks create natural retaining, slows overland flow and interactive nature play
- 04 Concrete terracing with sub-tropical canopy plantings
- 05 Sandblasting pattern reinforcing water and overland flow
- 06 DDA compliant ramp
- 07 Seating opportunity above
- 08 Hanging groundcovers to the Tavern create a cascade of vertical greenery to the buildings
- 09 Sub-tropical planting of varying canopy heights emphasise the 'gorge' like spatiality of the lower retail level and create a unique ambience



SECTION H-H: THE GORGE AND PARK INTERFACE

BCC DS
 RECEIVED
 02/09/2025
 APPLICATION REF
 A006522664



KEY

- 01 Feature shade tree with lush understorey planting to assists with wayfinding and place activation
- 02 Sandstone blocks at varying heights interspersed with native planting create a delightful public engagement opportunity
- 03 Path connecting up to Upper Terrace and Village Heart
- 04 Sub-tropical planting of varying canopy heights emphasise the 'gorge' like spatiality of the lower retail level and create a unique ambience
- 05 Concrete terracing provides retaining and seating opportunity

1:100 @ A3 0 0.5 1 2 3 4m

SECTION I-I: THE GORGE AND UPPER GROUND LEVEL INTERFACE

KEY

- 01 Sub-tropical planting of varying canopy heights emphasise the 'gorge' like spatiality of the lower retail level and create a unique ambience
- 02 Stairs to upper ground level
- 03 Bridge to hotel
- 04 Cascading plants create a green envelope to the upper retail edge



1:100 @ A3 0 0.5 1 2 3 4m

SECTION J-J: THE GORGE AND UPPER GROUND LEVEL INTERFACE

KEY

- 01 Sub-tropical planting of varying canopy heights emphasise the 'gorge' like spatiality of the lower retail level and create a unique ambience
- 02 Seating opportunity facilitates leisurely retail activity
- 03 Upper retail level
- 04 Tavern - outdoor dining area
- 05 Cascading plants create a green envelope to the upper retail edge



BCC DS
RECEIVED
02/09/2025
APPLICATION REF
A006522664

1:100 @ A3 0 0.5 1 2 3 4m

ENTRY DRIVEWAY

KEY

- 01 Pavement treatment to carparking bays
- 02 Native garden on raised planter
- 03 Threshold treatment signal pedestrian prioritised zone/crossing
- 04 Seating opportunity at Ground level
- 05 Flush kerb with vehicle impact rated bollards
- 06 Feature entry tree with sandstone block terracing interspersed with native planting form part of the arrival experience
- 07 Outdoor stage for artistic, social/ cultural performances for the public with a 450mm high seating wall edge
- 08 Van bay for equipment dropoff and loading to outdoor stage
- 09 Direct path connection to outdoor stage for equipment set up
- 10 10 minute set down zone
- 11 Village Heart
- 12 Street path and verge to BCC standards



SECTION K-K: ENTRY DRIVEWAY AND VILLAGE HEART INTERFACE

BCC DS
RECEIVED
02/09/2025
APPLICATION REF
A006522664



KEY

- 01 1:4 turf batter up to road level from Village Heart
- 02 1800mm pedestrian pathway
- 03 Pavement treatment to carparking bays
- 04 Feature entry tree with sandstone block terracing interspersed with native planting form part of the arrival experience
- 05 Short stay parking (parallel)

PLANTING DEPTHS AND DEEP SOIL ZONES

GROUND AND PARK (EXCLUDING THE GORGE)

KEY

- TOTAL SITE AREA: 40108 m2**
- STAGE 1 TRUNK PARK BOUNDARY
Total Area: 6079m2
- STAGE 1 MIXED USED AND RETAIL BOUNDARY
Total Area: 9871m2
- STAGE 1 ROAD DEDICATION BOUNDARY
Total Area: 1954m2
- 450mm Planter Depths
- Deep Soil Planting Areas
- 4 x 4 Deep Soil Planting Area

DEEP SOIL PLANTING AREA SUMMARY:

STAGE 1 TRUNK PARK

Total Stage Area: **6187m2**
 Total Deep Soil Planting Area: **1990m2**
 Total Quantity of 4x4 Deep Soil Planting Area (60 squares) **960m2**

Percentage of Deep Soil Planting Area: **32.1%**

STAGE 1 MIXED USED AND RETAIL

Total Stage Area: **9763m2**
 Total Deep Soil Planting Area: **1066m2**
 Total Quantity of 4x4 Deep Soil Planting Area (30 squares) **480m2**

Percentage of Deep Soil Planting Area: **10.9%**

STAGE 1 ROAD DEDICATION

Total Stage Area: **1954m2**
 Total Deep Soil Planting Area: **262m2**

Percentage of Deep Soil Planting Area: **13.4%**

TOTAL OVERALL STAGE 1 SUMMARY (Exclu. The Gorge):

Total Stage Area: **17904m2**
 6187 + 9763 + 1954 =
 Total Deep Soil Planting Area: **3318m2**
 Total Quantity of 4x4 Deep Soil Planting Area (90 squares) **1440m2**

Percentage of Deep Soil Planting Area: **18.5%**

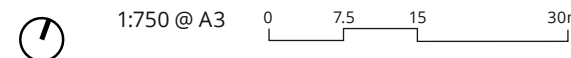

THE GORGE

KEY

- Deep soil planting
- 4 x 4 Deep Soil Planting Area

DEEP SOIL PLANTING AREA SUMMARY:

Total Stage Area: **841m2**

Total Deep Soil Planting Area: **248m2**

Total Quantity of 4x4 Deep Soil Planting Area (4 squares) **64m2**

Percentage of Deep Soil Planting Area: **29.5%**

BCC DS
RECEIVED
 02/09/2025
APPLICATION REF
 A006522664

HOTEL LEVEL 1

KEY

- 600mm podium soil depth
- 750mm podium soil depth

TOTAL COMBINED PODIUM
 PLANTING AREA LEVEL 1: **255m2**

Note: All hotel planting to be maintained via abseiling system.

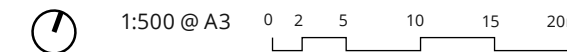
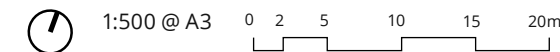

HOTEL LEVEL 2

KEY

- 300mm podium soil depth
- 600mm podium soil depth

TOTAL COMBINED PODIUM
 PLANTING AREA LEVEL 2: **368m2**

Note: All hotel planting to be maintained via abseiling system.

HOTEL LEVEL 3 & LEVEL 4

KEY

- 300mm podium soil depth
- 600mm podium soil depth

TOTAL COMBINED PODIUM PLANTING AREA LEVEL 3 & 4: **210m²**

Note: All hotel planting to be maintained via abseiling system.

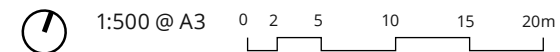

BCC DS
RECEIVED
02/09/2025
APPLICATION REF
A006522664

PLANTING PALETTE

OPEN SPACE

CODE	BOTANIC NAME	COMMON NAME	MATURE SIZE (h x w) (m)
------	--------------	-------------	-------------------------

TREES			
ACM smi	<i>Acmena smithii</i>	Lilly Pilly	8 x 3
BAN int	<i>Banksia integrifolia</i>	Coastal Banksia	15 x 6
COR cit	<i>Corymbia citriodora</i>	Lemon Scented Gum	20 x 10
COR int	<i>Corymbia intermedia</i>	Pink Bloodwood	20 x 10
CUP ana	<i>Cupaniopsis anacardioides</i>	Tuckeroo	6-8 x 4-6
CUP par	<i>Cupaniopsis parvifolia</i>	Small Leaf Tuckeroo	10 x 8
EUC gra	<i>Eucalyptus grandis</i>	Flooded Gum	40 x 7
EUC ter	<i>Eucalyptus tereticornis</i>	Forest Red Gum	30 x 7
EUC mic	<i>Eucalyptus microcorys</i>	Tallowwood	40 x 7
FLI aus	<i>Flindersia australis</i>	Crow's Ash	10 x 5
GRE bai	<i>Grevillea baileyana</i>	Brown Silky Oak	10 x 5
GRE ban	<i>Grevillea banksii</i>	Red Flowered Silky Oak	10 x 5
GRE rob	<i>Grevillea robusta</i>	Silky Oak	~30 x 20
HIB til	<i>Hibiscus tiliaceus</i>	Sea Hibiscus	8 x 4
LOP con	<i>Lophostemon confertus</i>	Queensland Brush Box	15 x 10
MEL lin	<i>Melaleuca linariifolia</i>	Narrow-leaved Paperbark	8m H
MEL qui	<i>Melaleuca quinquenervia</i>	Broad-leaved Paperbark	25 x 10
MEL aze	<i>Melia azedarach</i>	White Cedar	12 x 8
SYZ ole	<i>Syzygium oleosum</i>	Blue Lilly Pilly	7 x 4
SYZ lue	<i>Syzygium luehmannii</i>	Small-leaved Lilly Pilly	15 x 5
WAT flo	<i>Waterhousia floribunda</i>	Lilly Pilly	30 x 10

SHRUBS AND ACCENTS			
ACA fri	<i>Acacia fimbriata</i>	Fringed Wattle	6 x 4
ACA dis	<i>Acacia disarrima</i>	Southern Salwood	12 x 4
ACA lei	<i>Acacia leiocalyx</i>	Black Wattle	8 x 4
BAN BC	<i>Banksia 'Birthday Candles'</i>	Hairpin Banksia	0.5 x 1
BAN obl	<i>Banksia oblongifolia</i>	Dwarf Banksia	2 x 1.5
BAN spi	<i>Banksia spinulosa</i>	Hairpin Banksia	3 x 3
BRE obl	<i>Breynia oblongifolia</i>	Coffee Bush	3 x 2
CAL sp.	<i>Callistemon sp.</i>	Callistemon	
OZO dio	<i>Ozothamnus diosmifolius</i>	Dogwood	1.5-2.5 x 1-1.5
PUL vil	<i>Pultenaea villosa</i>	Hairy Pea Bush	1.5 x 1.5
WES ere	<i>Westringia eremicola</i>	Slender Western Rosemary	1.5 x 1.5

GRASSES			
CAL dub	<i>Calochlaena dubia</i>	False Bracken	2 x 1.5
CAR app	<i>Carex appressa</i>	Tall Sedge	1 x 1
CYP exa	<i>Cyperus exaltatus</i>	Tall Flat Sedge	1.5 x 1
GAH asp	<i>Gahnia aspera</i>	Saw Leaf Sedge	0.8 x 1
FIM dic	<i>Fimbristylis dichotoma</i>	Eight Day Grass	
FIC nod	<i>Ficinia nodosa</i>	Knobbly Club Rush	1 x 1
IMP cyl	<i>Imperata cylindrica</i>	Blade Grass	0.6 x 1
ISO inu	<i>Isolepis inundata</i>	Swamp Club Sedge	0.5 x 1
JUN usi	<i>Juncus usitatus</i>	Common Rush	1 x 0.6
LOM fil	<i>Lomandra filiformis</i>	Wattle Mat Rush	0.2 x 0.5
LOM hys	<i>Lomandra hystrix</i>	Mat Rush	1 x 1
LOM mul	<i>Lomandra multiflora</i>	Mat Rush	0.75 x 0.75
XAN mac	<i>Xanthorrhoea macronema</i>	Coastal Grass Tree	0.8 x 1.5

GROUNDCOVERS AND CLIMBERS			
CAL cun	<i>Calotis cuneifolia</i>	Purple Burr Daisy	
MYO par	<i>Myoporum parvifolium</i>	Creeping Boobialla	0.3 x spreading

THE GORGE

CODE	BOTANIC NAME	COMMON NAME	MATURE SIZE (h x w) (m)
------	--------------	-------------	----------------------------

TREES AND PALMS

ARC ale	<i>Archontophoenix alexandrae</i>	Alexandra Palm	25 x 2.5
COM bar	<i>Commersonia bartramia</i>	Brown Kurrajong	6-12 H
ELA eum	<i>Eleocharis eumundii</i>	Smooth Leaved Quandong	8 x 4
FIC mac	<i>Ficus macrophylla</i>	Moreton Bay Fig	21 x 15
FIC obl	<i>Ficus obliva</i>	Small Leaved Fig	30 x 20
FIC rub	<i>Ficus rubiginosa</i>	Rusty Fig	30 x 15
LIC ele	<i>Licuala elegans</i>	Elegant Fan Palm	4 x 4
LIC ram	<i>Licuala ramsayi</i>	Queensland Fan Palm	10 x 8
LIV dec	<i>Livistona decipiens</i>	Ribbon Fan Palm	10-20 x 5
LOP con	<i>Lophostemon confertus</i>	Queensland Brush Box	15 x 10
RAN fit	<i>Randia fitzalanii</i>	Native Gardenia	5 x 4
RHA exc	<i>Rhapis excelsa</i>	Lady Palm	3 x 3
SYZ ole	<i>Syzygium oleosum</i>	Blue Lilly Pilly	7 x 4
XAN chr	<i>Xanthostemon chrysanthus</i>	Golden Penda	15 x 12

SHRUBS, ACCENTS AND FERNS

ALO bri	<i>Alocasia brisbanensis</i>	Cunjevoi	1.5 x 1
ALO mac	<i>Alocasia macrorrhiza</i>	Giant Taro	1.5 x 1.2
ALP cae	<i>Alpinia caerulea</i>	Native Ginger	2 x 1.5
ASP nid	<i>Asplenium nidus</i>	Bird's Nest Fern	1 x 1.5
BAN obl	<i>Banksia oblongifolia</i>	Dwarf Banksia	2 x 1.5
BAN rob	<i>Banksia robur</i>	Swamp Banksia	1.5 x 1
BAN spi	<i>Banksia spinulosa</i>	Hairpin Banksia	3 x 3
BLE car	<i>Blechnum cartilagineum</i>	Gristle Fern	1 x 1
BLE gib	<i>Blechnum gibbum</i>	Dwarf Tree Fern	1.2 x 1
BRE obl	<i>Breynia oblongifolia</i>	Coffee Bush	3 x 2
CAL zeb	<i>Calathea zebrina</i>	Zebra Plant	0.8 x 0.5
CHR den	<i>Christella dentata</i>	Binung Fern	
COR pet	<i>Cordyline petiolaris</i>	Cordyline	5 x 2
COR rub	<i>Cordyline rubra</i>	Cordyline	3 x 1.5
CYA coo	<i>Cyathea cooperi</i>	Australian Fern Tree	6 x 3
CHR den	<i>Christella dentata</i>	Binung Fern	
DOO asp	<i>Doodia aspera</i>	Prickly Rasp Fern	0.5 x 0.5
GLE dic	<i>Gleichenia dicarpa</i>	Tangle Fern	2 x 2
HEL RC	<i>Heliconia 'Red Christmas'</i>	Heliconia	3 x 2
HEL JAC	<i>Heliconia 'Jacquini'</i>	Heliconia	4 x 2
HYM lit	<i>Hymenocallis littoralis</i>	Spider Lilly	0.7 x 0.7
HYP mue	<i>Hypolepis muelleri</i>	Ground Fern	1 x 1
PHI RC	<i>Philodendron 'Rajo Congo'</i>	Rojo Congo	1 x 1
PLA bif	<i>Platyrium bifurcatum</i>	Elkhorn Fern	0.7 x 0.7
PLA sup	<i>Platyrium superbum</i>	Staghorn Fern	1 x 0.5m
PRO cun	<i>Proiphys cunninghamii</i>	Brisbane Lily	0.5 x 0.5

GRASSES

JUN usi	<i>Juncus usitatus</i>	Common Rush	1 x 0.6
LOM hys	<i>Lomandra hystrix</i>	Mat Rush	1 x 1
LOM LC	<i>Lomandra 'Little Con'</i>	Mat Rush	0.3 x 0.3

GROUNDCOVERS AND CLIMBERS

BRA mic	<i>Brachyscome microcarpa</i>	Forest Daisy	
CAR gla	<i>Carpobrotus glaucescens</i>	Pigface	0.15 x spreading
CAS gla	<i>Casuarina glauca</i>	Swamp She-oak	0.3 x spreading
CHR api	<i>Chrysocephalum apiculatum</i>	Yellow Buttons	0.3-0.6 x 0.6-1
CIS ant	<i>Cissus antarctica</i>	Kangaroo Vine	climbing
DIC rep	<i>Dichondra repens</i>	Kidney Weed	0.15 x spreading
FIC pum	<i>Ficus pumila</i>	Creeping Fig	climbing
HAR vio	<i>Hardenbergia violacea</i>	False Sarsaparilla	0.25 x spreading
HIB asp	<i>Hibbertia aspera</i>	Rough Guinea Flower	0.5 x spreading
HIB dif	<i>Hibbertia aspera</i>	Wedge Guinea Flower	0.3 x spreading
MYO par	<i>Myoporum parvifolium</i>	Creeping Boobialla	0.3 x spreading
PAN flo	<i>Pandorea floribunda</i>	Bower Vine	climbing
PAN pan	<i>Pandorea pandorana</i>	Wonga Wonga Vine	climbing
VIO hed	<i>Viola hederacea</i>	Native Violet	0.10 x spreading

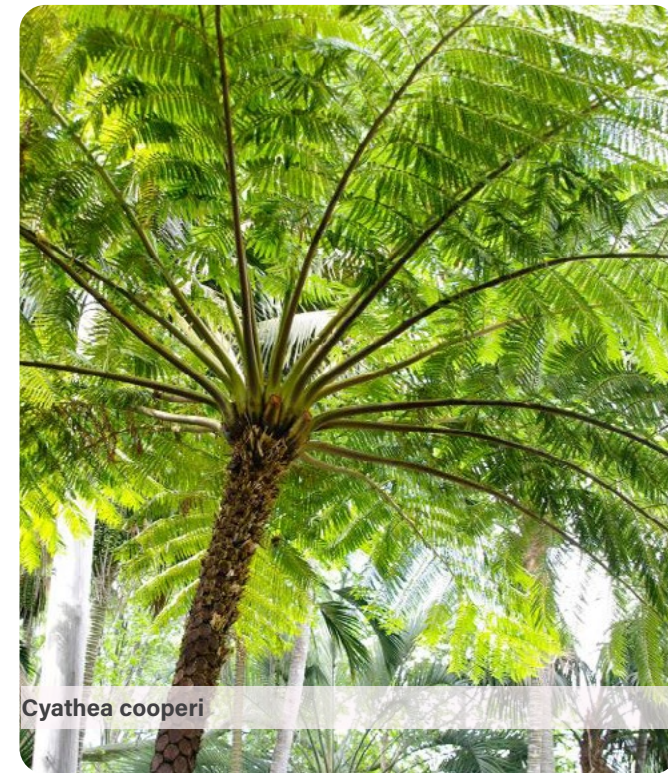

Cyathea cooperi

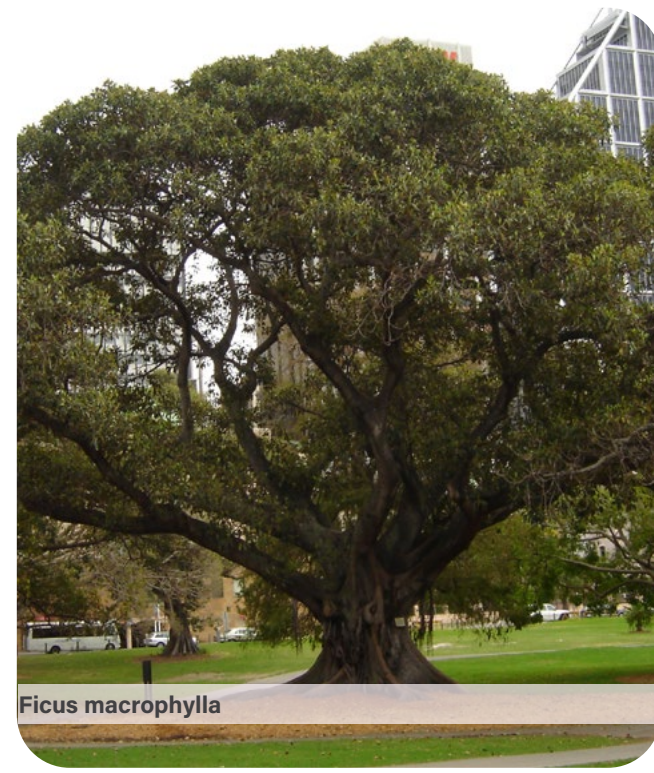

Ficus macrophylla



Archontophoenix alexandrae



Livistona decipiens



Alocasia brisbanensis



Alocasia macrorrhiza



Asplenium nidus



Alpinia caerulea



Banksia robur

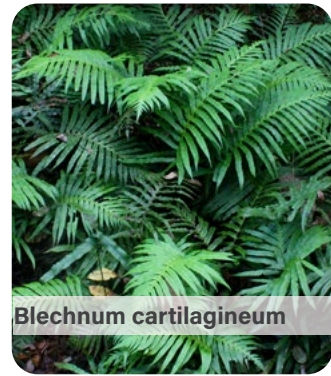

Blechnum cartilagineum



Calathea zebrina



Cordyline 'Rubra'



Heliconia 'Red Christmas'



Philodendron 'Congo'



Lomandra hystrix



Chrysocephalum apiculatum



Dichondra repens



Pandorea pandorana



Platyrium bifurcatum

PODIUM PLANTING

CODE	BOTANIC NAME	COMMON NAME	MATURE SIZE (h x w) (m)
------	--------------	-------------	----------------------------

SHRUBS, ACCENTS AND FERNS

ALC imp	<i>Alcantarea imperialis</i>	Giant Bromeliad	1 x 1
ALO bri	<i>Alocasia brisbanensis</i>	Cunjevoi	1.5 x 1
ALP cae	<i>Alpinia caerulea</i>	Native Ginger	2 x 1.5
ASP nid	<i>Asplenium nidus</i>	Bird's Nest Fern	1 x 1.5
BLE car	<i>Blechnum cartilagineum</i>	Gristle Fern	1 x 1
BLE gib	<i>Blechnum gibbum</i>	Dwarf Tree Fern	1.2 x 1
CAL zeb	<i>Calathea zebrina</i>	Zebra Plant	0.8 x 0.5
CYA coo	<i>Cyathea cooperi</i>	Australian Fern Tree	6 x 3
DOO asp	<i>Doodia aspera</i>	Prickly Rasp Fern	0.5 x 0.5
HEL RC	<i>Heliconia 'Red Christmas'</i>	Heliconia	3 x 2
HYM lit	<i>Hymenocallis littoralis</i>	Spider Lilly	0.7 x 0.7
MAC rie	<i>Macrozamia riedlei</i>	Zamia Palm	0.5 - 3 (H)
MON del	<i>Monstera deliciosa</i>	Swiss Cheese Plant	3 x 3
NEO gra	<i>Neomarica gracilis</i>	Walking Iris	1.5 x 1.5
PHI RC	<i>Philodendron 'Rajo Congo'</i>	Rojo Congo	1 x 1
PLA bif	<i>Platyrium bifurcatum</i>	Elkhorn Fern	0.7 x 0.7
PLA sup	<i>Platyrium superbum</i>	Staghorn Fern	1 x 0.5m
ZAM fur	<i>Zamia furfuracea</i>	Cardboard Palm	1 x 1.5

GRASSES

DIA cae	<i>Dianella caerulea</i>	Blue Flag Lilly	1 x 1
LOM sha	<i>Lomandra fluvialis 'Shara'</i>	River Mat Rush	0.6 x 0.6

GROUNDCOVERS AND CLIMBERS

CAR gla	<i>Carpobrotus glaucescens</i>	Pigface	0.15 x spreading
CAS gla	<i>Casuarina glauca</i>	Swamp She-oak	0.3 x spreading
CIS ant	<i>Cissus antarctica</i>	Kangaroo Vine	climbing
DIC SF	<i>Dichondra Silver Falls</i>	Kidney Weed	0.15 x spreading
FIC pum	<i>Ficus pumila</i>	Creeping Fig	climbing
MYO par	<i>Myoporum parvifolium</i>	Creeping Boobialla	0.3 x spreading
PAN flo	<i>Pandorea floribunda</i>	Bower Vine	climbing
PAN pan	<i>Pandorea pandorana</i>	Wonga Wonga Vine	climbing
PLE aus	<i>Plectranthus australis</i>	Swedish Ivy	0.3 x spreading
VIO hed	<i>Viola hederacea</i>	Native Violet	0.10 x spreading



Alcantarea imperialis



Asplenium nidus



Alocasia brisbanensis



Alpinia caerulea



Cyathea cooperi



Dianella caerulea



Doodia aspera



Doryanthes Palmeri



Monstera deliciosa



Neomarica gracilis



Philodendron 'Congo'



Plectranthus australis



Rhapis excelsa



Zamia furfuracea

BCC DS
RECEIVED
02/09/2025
APPLICATION REF
A006522664

INSPIRATION



LOCAL SANDSTONE GEOLOGY



- 01 Sandstone terracing
- 02 Sandstone accent blocks
- 03 Sandstone feature paving
- 04 Natural stone accent paving

NATIVE HARDWOOD



- 01 Native hardwood seating
- 02 Native hardwood accent decking
- 03 Timber as sculptural material
- 04 Native hardwood battens

WATER NARRATIVE



- 01 Meandering concrete terraces
- 02 Blurring, meandering edges through pavement treatments
- 03 Unit pavers enabling water filtration
- 04 Carving on stone/ concrete terrace
- 05 Concrete pavement and sandblasting/ etching