

BCC DS  
 RECEIVED  
 20/05/2026  
 APPLICATION REF  
 A006902496

**COPYRIGHT**  
 All rights in relation to these drawings are reserved as the copyright of idearchitecture Pty Ltd, and to be used only to produce the project for the client and in the location detailed hereon and are not to be copied or retained without written notice.

- All construction, materials and building work is to comply with the Queensland Building Act, the National Construction Code and applicable Australian Standards.
- Main Contractor and/or subcontractor to confirm setbacks, levels, setbacks, and critical dimensions on site, including all building services and service fixtures before commencing work on site and during construction.
- Do not scale from this drawing - use figured dimensions only. Dimensions generally relate to structure only, and do not include linings or claddings unless otherwise noted in detail information.
- Any conflicts or discrepancies identified by the building or subcontractor need to be notified to the architect for clarification prior to proceeding with the work.
- The client is to review design and documentation detailed within this document. idearchitecture will assume the design and documentation satisfies the Client's Principal Project Requirements unless written notice is provided within 20 working days from its last issue.
- Main Contractor to provide a finished sample or prototype of each selected item, finish, furniture and fixture, and to obtain approval from idearchitecture and other consultants where relevant, prior to commencing work. Verify lead times for all products and orders placed to ensure procurement times of all selections meet the agreed building program.
- Information noted in the drawing revisions may not be indicative of all changes made.

rev	date	detail	checked
A	15.08.25	PRELIMINARY ISSUE	FI
B	26.08.25	PRELIMINARY ISSUE	FI
C	23.09.25	ISSUE FOR DA APPROVAL	FI
D	09.10.25	ISSUE FOR DA APPROVAL	FI
E	22.04.26	REVISED BIN STORE	FI

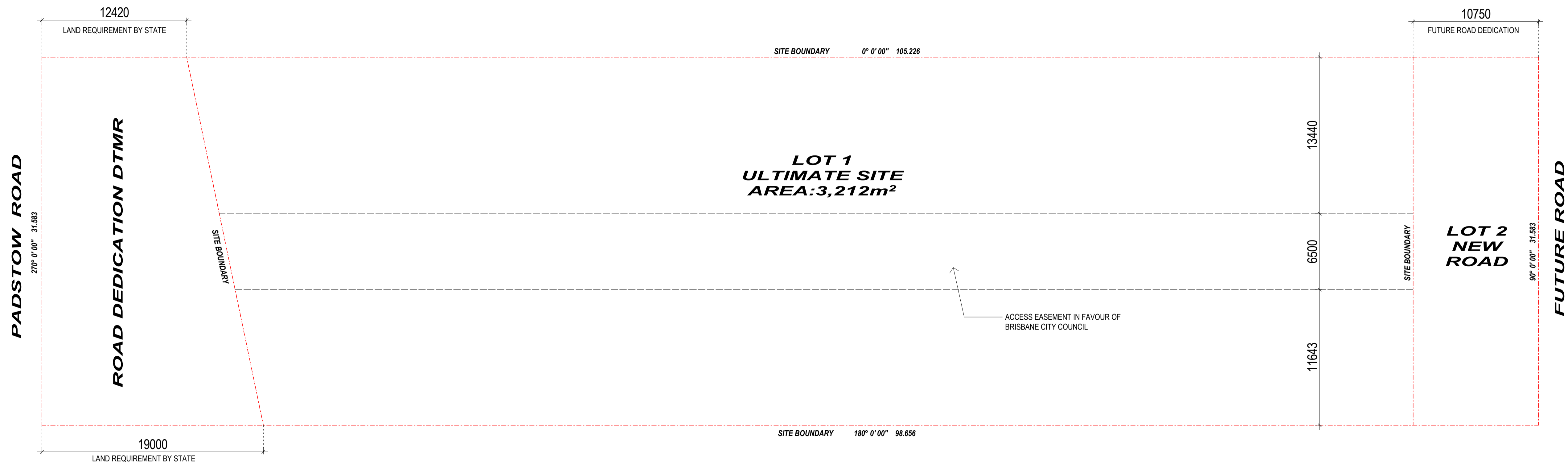

**idearchitecture**  
 T4 / 125 Wellington Rd, East Brisbane, 4169 Australia  
 p +617 3392 4534 e idea@ideagroup.com.au

client	TYD GROUP
project	PROPOSED MULTI UNIT DEVELOPMENT
locale	268 PADSTOW ROAD, EIGHT MILE PLAINS 4113
title	SUBDIVISION PLAN

scale	1 : 200	drawn	BK
date	02.04.2026	checked	FI
job no	1705_ 1307	dwg no / cadfile	DA-01
		rev	E

status **FOR APPROVAL**