



**BCC DS  
LODGED**  
11/04/2025  
**APPLICATION REF**  
A006752110

**IFC**

**Code Abbreviations**

| Code  | Description                                    |
|-------|--|
| BAL03 | METAL BALUSTRADE (0461)                        |
| BOL01 | RETRACTABLE BOLLARD (0552)                     |
| CBF01 | CONCRETE BROOM FINISH (0310)                   |
| CEA01 | CONCRETE EXPOSED AGGREGATE (0310)              |
| CEA02 | CONCRETE EXPOSED AGGREGATE (0310)              |
| DGP01 | DOUBLE GENERAL PURPOSE OUTLET (0951)           |
| DNP01 | DOWNPIPE EXTERNAL (0421)                       |
| DNP02 | DOWNPIPE INTERNAL (0421)                       |
| FEN01 | FENCE (0242)                                   |
| FEX01 | FIRE EXTINGUISHER (0573)                       |
| FWT02 | FLOOR WASTE CAPPED (0811)                      |
| GAB01 | GABION WALL (0332)                             |
| GRD02 | GRATED DRAIN (0802)                            |
| HCK01 | HOSE COCK (0572)                               |
| LIT07 | EXTERIOR SPIKE GARDEN LIGHT (0951)             |
| LSW01 | LIGHT SWITCH (0951)                            |
| LSW02 | OPERATION SWITCH (0951)                        |
| SCN06 | ACOUSTIC SCREEN (0552)                         |
| STL01 | STRUCTURAL STEEL BY STRUCTURAL ENGINEER (0341) |
| TFZ01 | Tenant Floor Zone (0572)                       |
| TGS01 | TACTILE GROUND SURFACE INDICATORS (0651)       |
| TGS02 | TACTILE GROUND SURFACE INDICATORS (0651)       |
| TLO1  | FLOOR TILE (0631)                              |
| TSS01 | TENSILE TRELLIS SYSTEM (0552)                  |
| WTK01 | WATER TANK (0802)                              |

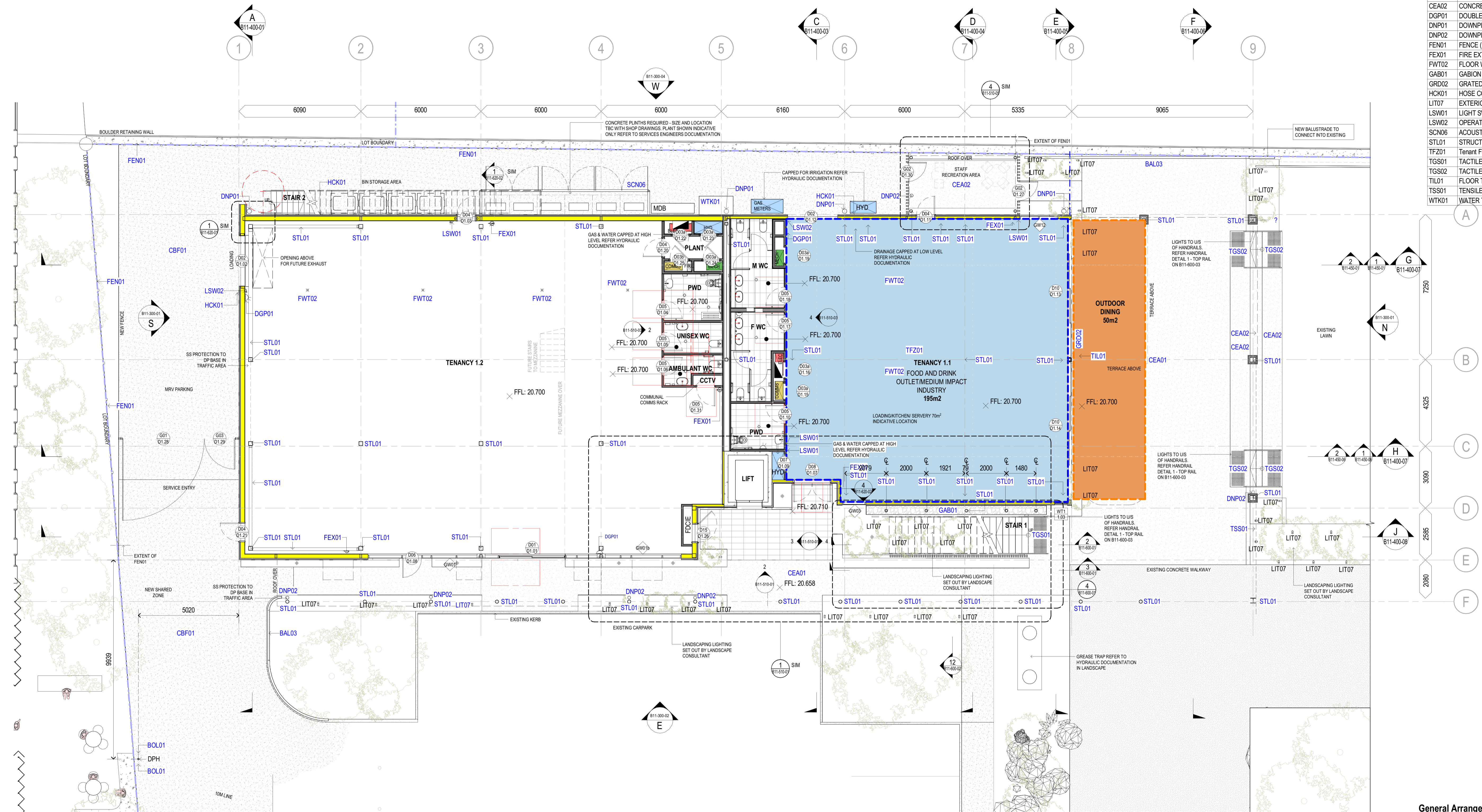

**General Arrangement Notes:**

- 50mm topping to falls to all wet areas on L2 and L3
- 40mm topping to falls to all wet areas on L2 and L3
- To be read in conjunction with consultants documentation.
- To be read in conjunction with all schedules and specifications.
- Vegetation shown indicatively only. Builder to provide D&G package of all new soil landscape elements and to tie new planting into existing including design, specification, details and coordination
- Reticulation of irrigation pipework by Landscape Contractor

| REV. | DATE     | DESCRIPTION      | INT. |
|------|----------|------------------|------|
| 10   | 28.09.23 | FOR CONSTRUCTION | LK   |
| 11   | 06.10.23 | FOR CONSTRUCTION | LK   |
| 12   | 30.10.23 | FOR INFORMATION  | LK   |
| 13   | 23.11.23 | FOR INFORMATION  | LK   |
| 14   | 04.12.23 | FOR INFORMATION  | LK   |
| 15   | 12.12.23 | FOR INFORMATION  | LK   |
| 16   | 24.03.25 | FOR INFORMATION  | AK   |

DO NOT SCALE FROM DRAWING. DIMENSIONS ARE TO BE CHECKED ON SITE PRIOR TO COMMENCEMENT OF WORK. DISCREPANCIES TO BE BROUGHT TO THE ATTENTION OF THE AUTHOR.  
ELECTRONIC DRAWINGS ARE UNCONTROLLED DOCUMENTS AND ARE ISSUED FOR INFORMATION ONLY. ANY DIMENSIONS NOT NOMINATED MUST BE REFERRED TO THE ARCHITECT FOR CONFIRMATION.  
THE CONCEPTS AND INFORMATION CONTAINED IN THIS DOCUMENT ARE THE COPYRIGHT OF O'NEILL ARCHITECTURE. USE OR COPYING OF THE DOCUMENT IN WHOLE OR IN PART WITHOUT THE WRITTEN PERMISSION OF O'NEILL ARCHITECTURE CONSTITUTES AN INFRINGEMENT OF COPYRIGHT.

**PROJECT**  
Rivermakers HQ B11  
82 Colmslie Rd, Morningside, QLD

**CLIENT**  
BMI Group

**DRAWING NAME**  
General Arrangement Plan -  
Level 01 (Ground)

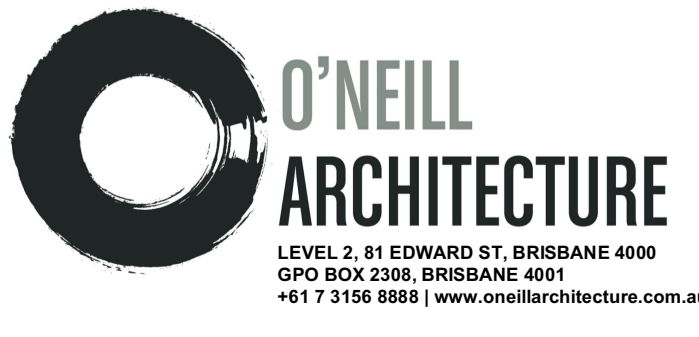

|                  |          |                    |                   |
|------------------|----------|--------------------|-------------------|
| PROJECT NO. 1425 |          | SCALE 1 : 100      | <b>A1</b><br>Size |
| DRAWN: KL / CRS  |          | CHECKED: AK        |                   |
| DISC. A          | PHASE CD | DWG NO. B11-200-01 | REV. 16           |