

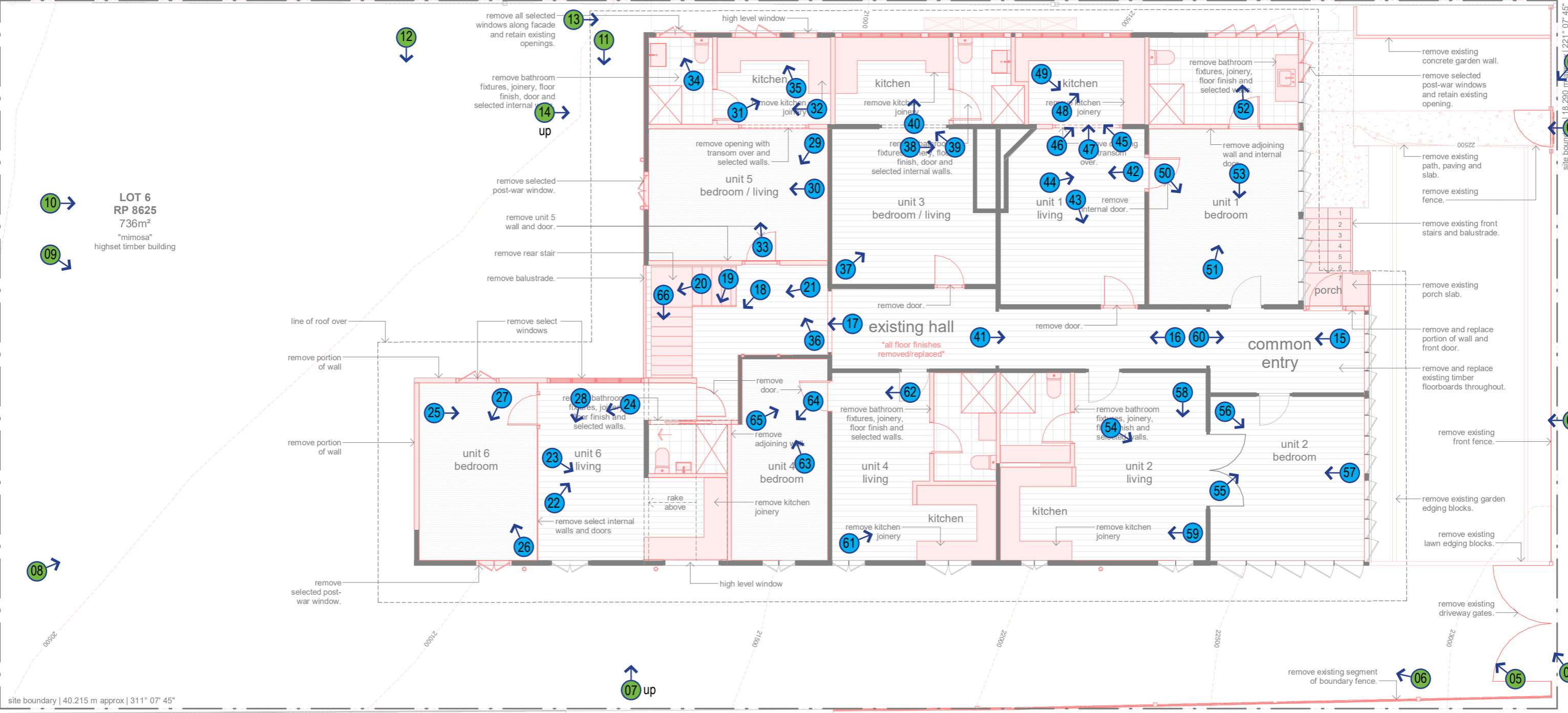

site boundary | 40.215 m approx | 131° 07' 45"

site boundary | 18.290 m approx | 141° 07' 45"

site boundary | 18.290 m approx | 221° 07' 45"



**1** first floor demolition plan  
190.03 1:100

general notes		general items legend							
1. all works to be carried out in accordance with the <b>general construction notes</b> in coversheets of this package.	6. levels and services locations for civil works may vary from those shown - verify all levels and services locations prior to commencement of construction.	⊕ RL 60.200	spot level tos = top of step bos = bottom of step RL = lvl at point (AHD typ)	L1 (level) w01 (window ref)	window code. refer to window elevations + door/window hardware schedules	dp01	component code. (refer material code for similar)	20	step down code.
2. all works to be carried out in accordance with the DA (if required) and BA including drawings & conditions.	7. concrete profile and blockwork setout is provided on 220 (series) of drawings, refer to these for setout. licensed surveyor to establish grids, where discrepancies occur the 220 series drawings are to take precedent.	RL xx.xxx	top of wall (surface) level	L1 (level) d01 (door/gate ref)	door/gate code. refer to window elevations + door/window hardware schedules	2700 lpb01 height* finish**	ceiling code * heights are relative to associated finished floor * refer finishes schedule	hc	hose cock. refer services schedule. client to confirm locations
3. handrails are required to all stairways where a change of level of 1000mm or greater occurs as per BCA 2013 Part 3.9.2.4.		SSL xx.xxx	structural slab level	lpb01	material code. refer finishes schedule (typical). (refer also to sanitary/ appliances/ lighting/services as appropriate)	level joinery reference	joinery code. refer to cabinetry elevations on 820 (series) and details on 830 (series) drawings	(cos) (mir) (sim) (part)	check on site mirrored detail similar detail partial detail
4. where boundary locations are not clear, the builder shall arrange for survey to locate the boundaries and complete an identification survey prior to setting out the new work.		FPL xx.xxx	finished floor level						
5. contours shown are existing and do not represent finished levels.									

35 masters street . newstead . qld . 4006  
07 3257 7288 | 0409 541 462 | www.lockyerarchitects.com.au

shaunlockyerarchitects pty ltd

DRAWN REV DATE ISSUE

ns D 24.05.2021 DA Issue

ij E 24.01.2023 Revised Preliminary Design

ij F 28.03.2023 Revised Heritage Review

ss G 18.04.2023 Revised DA Issue

PROJECT

33 Balfour Street  
New Farm 4005

CLIENT

Maria & Steven  
Fleming

DRAWING NAME

demolition plan - first  
floor

PHASE

DA

DWG NO

190.01

REV

G

PROJECT NO 0335

SCALE 1:100

1:1 @

A3

Do not scale from drawings. Dimensions are to be checked on site prior to commencement of work. Discrepancies to be brought to the attention of the author. Any dimensions not nominated must be referred to the Architect for confirmation. The concepts and information contained in this document are the copyright of Architect. Use or copying of the document in whole or in part without the written permission of the Architect constitutes an infringement of copyright.