

**NOTE:**  
DA DESIGN ONLY. NOT TO BE USED FOR CONSTRUCTION.

**LEGEND**

- EXISTING LOT BOUNDARY
- - - PROPOSED KERB
- - - EARTHWORKS BATTER TOP
- - - EARTHWORKS BATTER BOTTOM
- - - EARTHWORKS PAD
- - - PROPOSED RETAINING WALL (HEIGHT IN m)
- - - RAISED BLOCK BASE
- AREA OF CUT
- AREA OF FILL
- LOCALISED VERGE WORKS
- 58.00 — DESIGN SURFACE CONTOUR (0.1m INTERVALS)
- 56.00 — EXISTING SURFACE CONTOUR (0.1m INTERVALS)
- × RL 13.48 PROPOSED SPOT LEVEL
- - - SW - - - EXISTING STORMWATER
- - - RW - - - EXISTING ROOFWATER
- - - S - - - EXISTING SEWER
- - - W - - - EXISTING WATER
- - - E - - - EXISTING ELECTRICAL
- - - T - - - EXISTING TELECOMMUNICATION
- TREES TO BE RETAINED
- TREES TO BE REMOVED

**NOTE:**  
PRIOR TO CONSTRUCTION CONTRACTOR TO CONFIRM EXISTING ADJACENT LOT LEVELS, RETAINING WALLS, INCLUDING TOP AND BOTTOM & WALL HEIGHTS.

**NOTE:**  
RETAINING WALLS WILL BE A DESIGN & CONSTRUCT ITEM BY THE CONTRACTOR. RETAINING WALL TYPE & DESIGN TO BE CONFIRMED AS PART OF CONTRACTOR'S DESIGN & CONSTRUCT WORKS.

**NOTE:**  
EXISTING WATER ALIGNMENT TO BE CONFIRMED PRIOR TO CONSTRUCTION. LINE SHOWN ON THESE PLANS HAVE BEEN PLOTTED FROM UU MAPPING AND HAVE NOT BEEN SURVEYED.

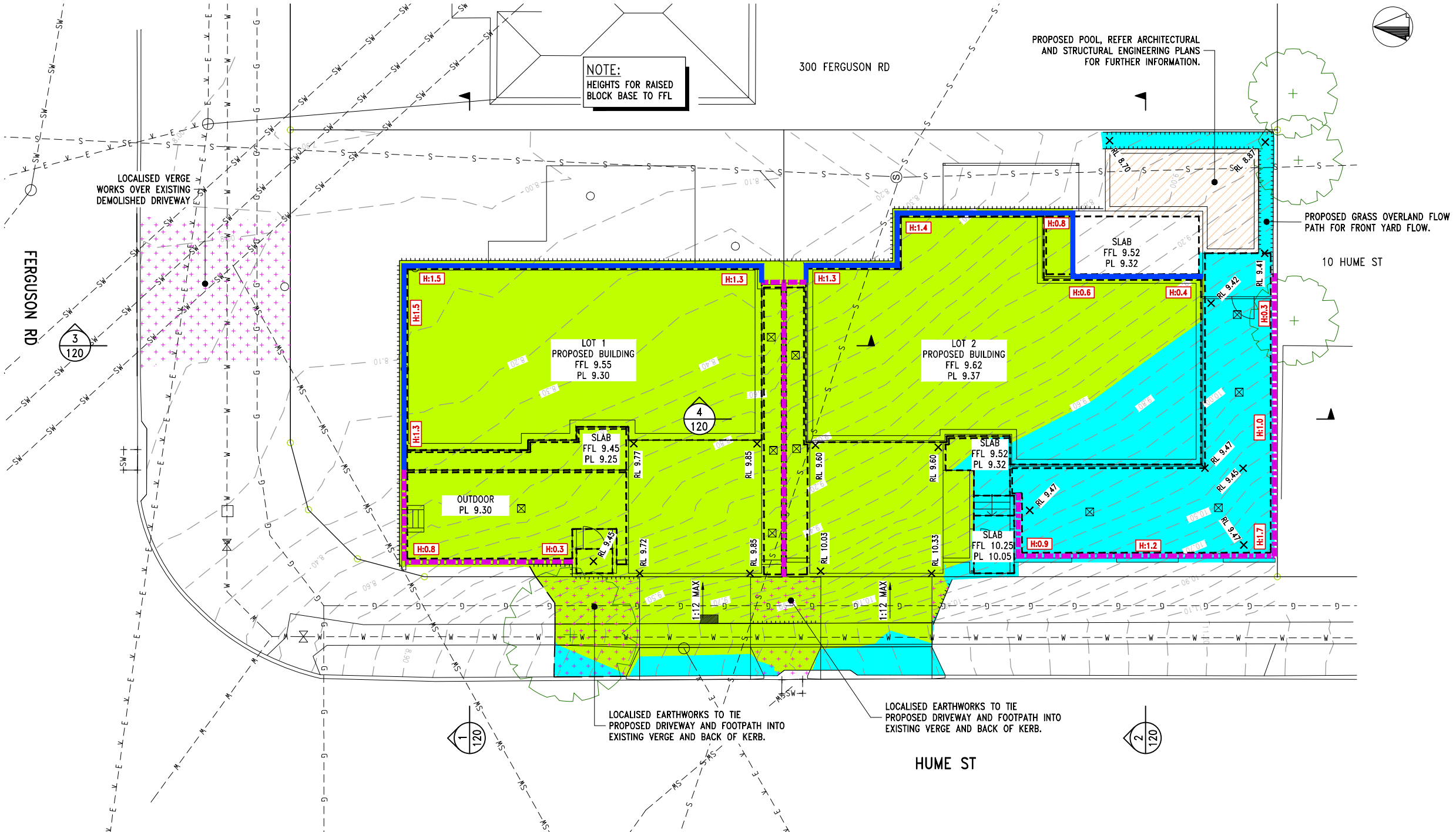

**NOTE:**  
HEIGHTS FOR RAISED BLOCK BASE TO FFL

PROPOSED POOL, REFER ARCHITECTURAL AND STRUCTURAL ENGINEERING PLANS FOR FURTHER INFORMATION.

PROPOSED GRASS OVERLAND FLOW PATH FOR FRONT YARD FLOW.

LOCALISED EARTHWORKS TO TIE THE PROPOSED DRIVEWAY AND FOOTPATH INTO EXISTING VERGE AND BACK OF KERB.

LOCALISED EARTHWORKS TO TIE THE PROPOSED DRIVEWAY AND FOOTPATH INTO EXISTING VERGE AND BACK OF KERB.

**EARTHWORKS LAYOUT PLAN**  
SCALE 1:100

**BCC DS**  
**RECEIVED**  
09/12/2025  
**APPLICATION REF**  
A006796692

| REV | DESCRIPTION         | BY | DES | DATE     |
|-----|---------------------|----|-----|----------|
| A   | FOR APPROVAL        | NM | JH  | 10.06.25 |
| B   | UPDATED COUNCIL REF | NM | JH  | 04.09.25 |

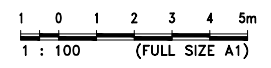













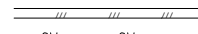
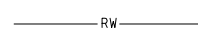
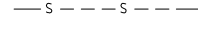
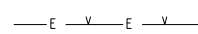

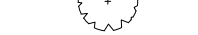

NAME: JASON HARLEY  
RPEQ: DATE:  
Approved by, for and on behalf of Ensilon  
This drawing has been produced for the exclusive use of the client (nominated on this document). No third party is to rely on this document without written permission from Ensilon. This drawing is not to be constructed from unless "Issued for construction" is displayed and only where signed by an RPEQ.  
© Copyright

Ensilon Pty Ltd  
ACN 644 618 253  
<http://www.ensilon.com.au>  
© Copyright

CLIENT  
**KOSMOS PROPERTY GROUP PTY LTD**  
TITLE  
**BULK EARTHWORKS LAYOUT PLAN**

| PROJECT                                                   |            | STATUS       |  | DESIGNED | DRAWN | APPROVED | DATE     | SCALE @ A1 | SHEET  |
|-----------------------------------------------------------|------------|--------------|--|----------|-------|----------|----------|------------|--------|
| 302 FERGUSON ROAD, SEVEN HILLS<br>PROPOSED 1 IN 2 LOT ROL |            | FOR APPROVAL |  | NM       | NM    | JH       | 10.06.25 | 1:100      | 1 of 1 |
| PROJECT No                                                | DRAWING No | REV          |  |          |       |          |          |            |        |
| 25-004                                                    | 100        | B            |  |          |       |          |          |            |        |

**LEGEND**

-  EXISTING LOT BOUNDARY
-  EXISTING SURFACE CONTOUR (0.1m INTERVALS)
-  EXISTING CONCRETE
-  EXISTING DWELLING
-  EXISTING STORMWATER
-  EXISTING ROOFWATER
-  EXISTING SEWER
-  EXISTING WATER
-  EXISTING ELECTRICAL
-  EXISTING TELECOMMUNICATION
-  EXISTING FENCE
-  TREES TO BE REMOVED
-  EXISTING CONCRETE REMOVED
-  EXISTING DWELLING REMOVED
-  EXISTING STORMWATER REMOVED
-  EXISTING ROOFWATER REMOVED
-  EXISTING SEWER REMOVED
-  EXISTING WATER REMOVED
-  EXISTING ELECTRICAL REMOVED
-  EXISTING TELECOMMUNICATION REMOVED
-  EXISTING FENCE REMOVED
-  TREES TO BE REMOVED

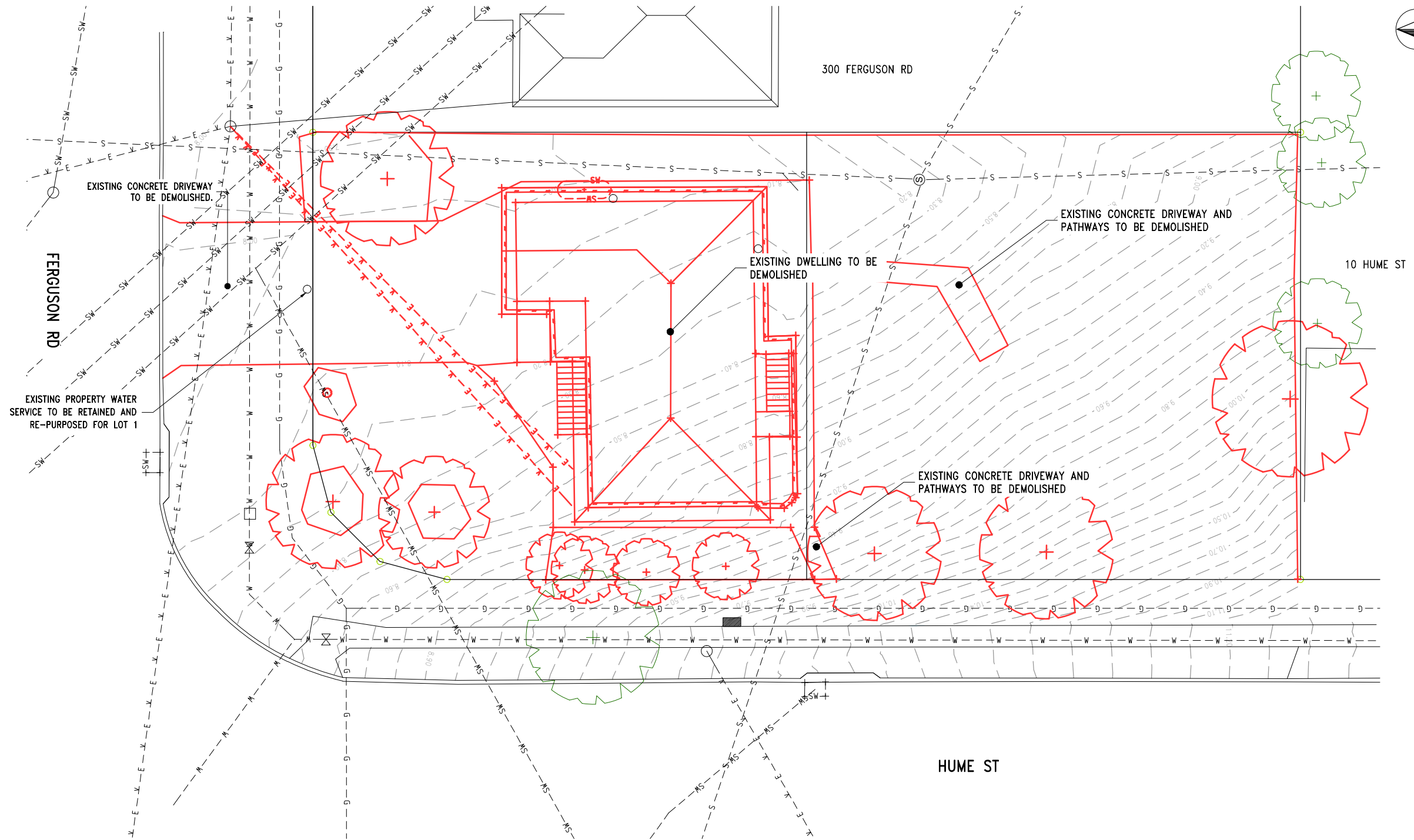

**DEMOLITION LAYOUT PLAN**  
SCALE 1:100

**BCC DS**  
 RECEIVED  
 09/12/2025  
 APPLICATION REF  
 A006796692

| REV | DESCRIPTION  | BY | DES | DATE     |
|-----|--------------|----|-----|----------|
| A   | FOR APPROVAL | NM | JH  | 10.06.25 |

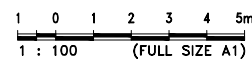

NAME: JASON HARLEY  
RPEQ: DATE:

Approved by, for and on behalf of Ensilon

This drawing has been produced for the exclusive use of the client (nominated on this document). No third party is to rely on this document without written permission from Ensilon. This drawing is not to be constructed from unless "Issued for construction" is displayed and only where signed by an RPEQ.  
© Copyright

Ensilon Pty Ltd  
ACN 644 618 253  
<http://www.ensilon.com.au>  
© Copyright



CLIENT  
**KOSMOS PROPERTY GROUP PTY LTD**

TITLE  
**DEMOLITION LAYOUT PLAN**

| PROJECT                                                   |            | STATUS       |  | DESIGNED | DRAWN | APPROVED | DATE     | SCALE @ A1 | SHEET  |
|-----------------------------------------------------------|------------|--------------|--|----------|-------|----------|----------|------------|--------|
| 302 FERGUSON ROAD, SEVEN HILLS<br>PROPOSED 1 IN 2 LOT ROL |            | FOR APPROVAL |  | NM       | NM    | JH       | 10.06.25 | 1:100      | 1 of 1 |
| PROJECT No                                                | DRAWING No | REV          |  |          |       |          |          |            |        |
| 25-004                                                    | 101        | A            |  |          |       |          |          |            |        |

**NOTE:**  
DA DESIGN ONLY. NOT TO BE  
USED FOR CONSTRUCTION.

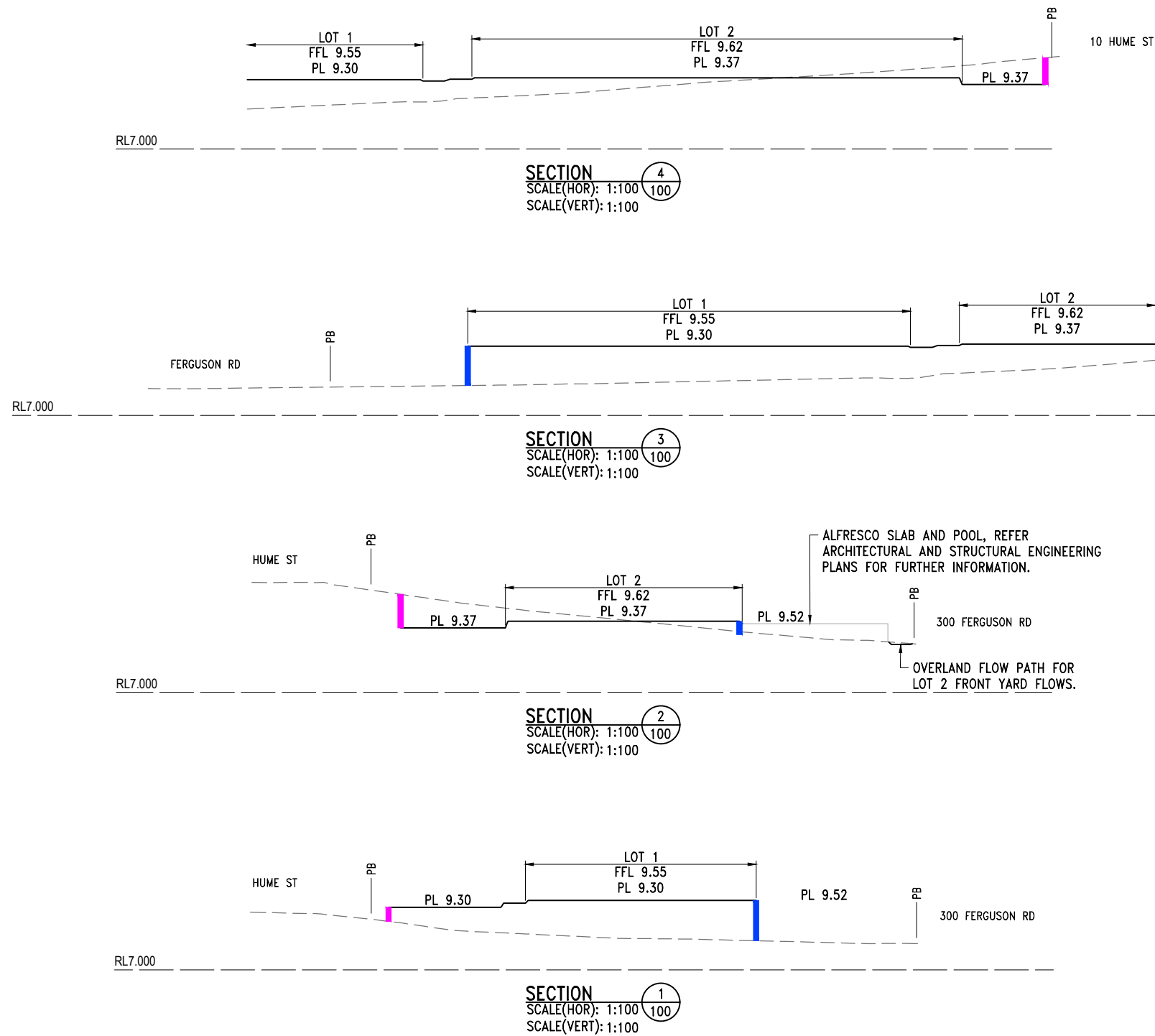

**BCC DS**  
**RECEIVED**  
09/12/2025  
**APPLICATION REF**  
A006796692

| REV | DESCRIPTION         | BY | DES | DATE     |
|-----|---------------------|----|-----|----------|
| A   | FOR APPROVAL        | NM | JH  | 10.06.25 |
| B   | UPDATED COUNCIL REF | NM | JH  | 04.09.25 |

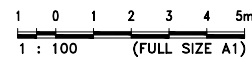

NAME: JASON HARLEY  
RPEQ: DATE:  
Approved by, for and on behalf of Ensilon  
This drawing has been produced for the exclusive use of the client (nominated on this document). No third party is to rely on this document without written permission from Ensilon. This drawing is not to be constructed from unless "Issued for construction" is displayed and only where signed by an RPEQ.  
© Copyright

Ensilon Pty Ltd  
ACN 644 618 253  
<http://www.ensilon.com.au>  
© Copyright

CLIENT  
**KOSMOS PROPERTY GROUP PTY LTD**  
TITLE  
SITE SECTIONS

|            |                                                           |          |          |            |        |
|------------|-----------------------------------------------------------|----------|----------|------------|--------|
| PROJECT    | 302 FERGUSON ROAD, SEVEN HILLS<br>PROPOSED 1 IN 2 LOT ROL |          |          |            |        |
| STATUS     | FOR APPROVAL                                              |          |          |            |        |
| DESIGNED   | DRAWN                                                     | APPROVED | DATE     | SCALE @ A1 | SHEET  |
| NM         | NM                                                        | JH       | 10.06.25 | 1:100      | 1 of 1 |
| PROJECT No | DRAWING No                                                |          | REV      |            |        |
| 25-004     | 120                                                       |          | B        |            |        |

**NOTE:**  
DA DESIGN ONLY. NOT TO BE USED FOR CONSTRUCTION.

**LEGEND**

- EXISTING LOT BOUNDARY
- PROPOSED KERB
- DESIGN SURFACE CONTOUR (0.1m INTERVALS)
- PROPOSED STORMWATER LINE
- PROPOSED STORMWATER STRUCTURE
- PROPOSED WATER RETICULATION
- PROPOSED WATER CONNECTION & M
- PROPOSED SEWER RETICULATION
- EARTHWORKS BATTER TOP
- EARTHWORKS BATTER BOTTOM
- EARTHWORKS PAD
- PROPOSED RETAINING WALL
- RAISED BLOCK BASE
- PROPOSED DRIVEWAY CROSSOVER
- PROPOSED FOOTPATH
- INTERNAL DRAINAGE BY OTHERS
- EXISTING STORMWATER
- EXISTING ROOFWATER
- EXISTING SEWER
- EXISTING WATER
- EXISTING ELECTRICAL
- EXISTING TELECOMMUNICATION
- TREES TO BE RETAINED

**NOTE:**  
EXISTING WATER ALIGNMENT TO BE CONFIRMED PRIOR TO CONSTRUCTION. LINE SHOWN ON THESE PLANS HAVE BEEN PLOTTED FROM UU MAPPING AND HAVE NOT BEEN SURVEYED.

**NOTE:**  
HEIGHTS FOR RAISED BLOCK BASE TO FFL

**NOTE:**  
WHERE STRUCTURAL BRIDGING OVER EXISTING SEWER / STORMWATER SERVICES TO BE DESIGNED & CERTIFIED BY REGISTERED RPEQ STRUCTURAL ENGINEER & TO HAVE PERMITS SUBMITTED & APPROVED PRIOR TO COMMENCEMENT OF WORKS ON SITE.

**NOTE:**  
FOR LOT 1 AND 2 DRIVEWAY GRADES REFER BCC STANDARD DRAWING BSD-2025 FOR RESIDENTIAL VEHICULAR ENTRANCE GRADES. FOR FURTHER INTERNAL DRIVEWAY GRADING REFER IPWEA STD DRG RS-050 AND AS 2890.1 PARKING FACILITIES OFF STREET CAR PARKING.

**BCC DS RECEIVED**  
09/12/2025  
**APPLICATION REF**  
A006796692

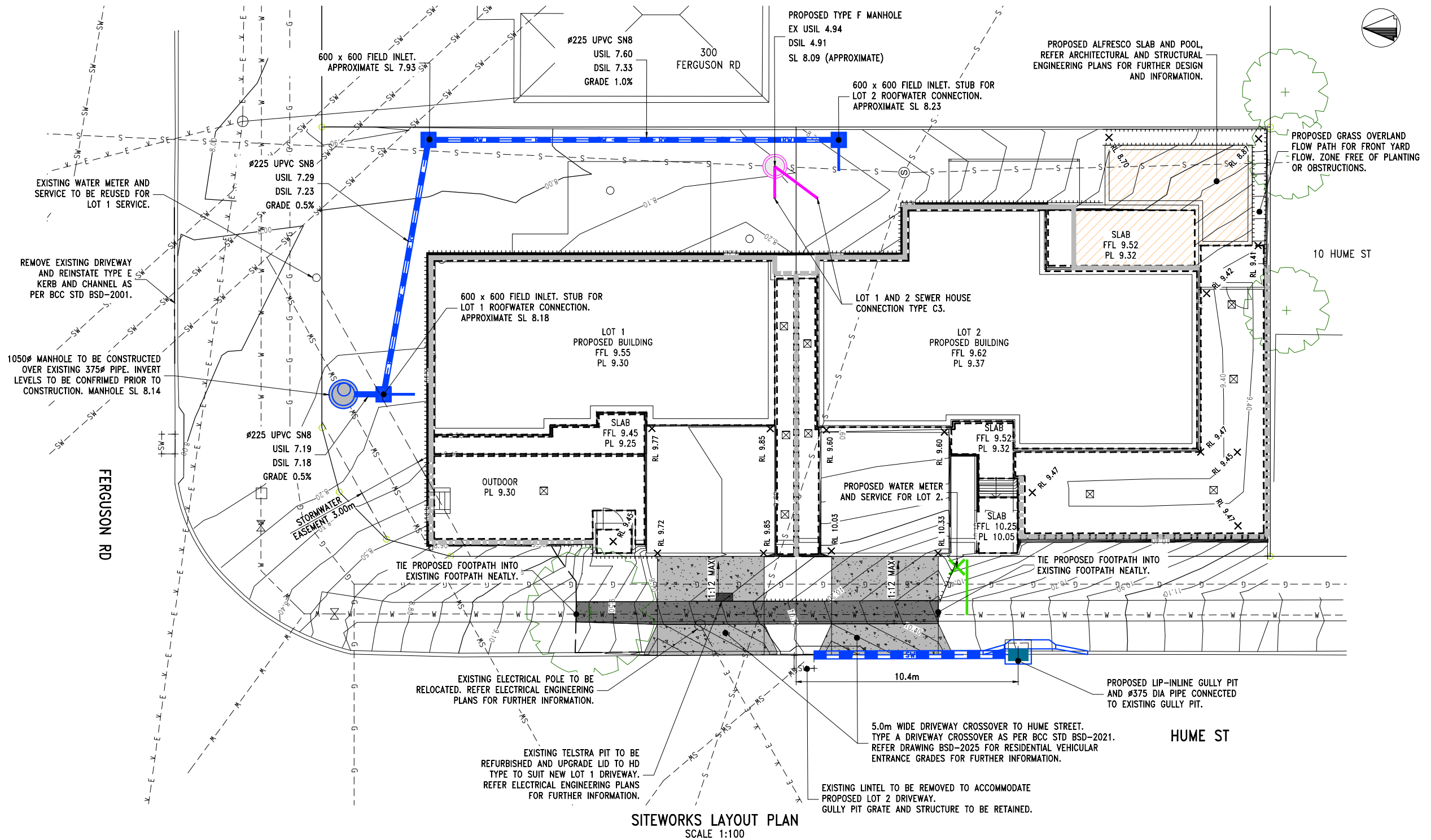

**SITWORKS LAYOUT PLAN**  
SCALE 1:100

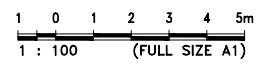

| REV | DESCRIPTION         | BY | DES | DATE     |
|-----|---------------------|----|-----|----------|
| A   | FOR APPROVAL        | NM | JH  | 10.06.25 |
| B   | UPDATED COUNCIL REF | NM | JH  | 04.09.25 |

NAME: JASON HARLEY  
RPEQ: DATE:  
Approved by, for and on behalf of Ensilon  
This drawing has been produced for the exclusive use of the client (nominated on this document). No third party is to rely on this document without written permission from Ensilon. This drawing is not to be constructed unless "Issued for construction" is displayed and only where signed by an RPEQ.  
© Copyright

Ensilon Pty Ltd  
ACN 644 618 253  
<http://www.ensilon.com.au>  
© Copyright

CLIENT  
**KOSMOS PROPERTY GROUP PTY LTD**  
TITLE  
**SITWORKS LAYOUT PLAN**

| PROJECT                                                   |            | STATUS       |  | DESIGNED | DRAWN | APPROVED | DATE     | SCALE | SHEET  |
|-----------------------------------------------------------|------------|--------------|--|----------|-------|----------|----------|-------|--------|
| 302 FERGUSON ROAD, SEVEN HILLS<br>PROPOSED 1 IN 2 LOT ROL |            | FOR APPROVAL |  | NM       | NM    | JH       | 10.06.25 | 1:100 | 1 of 1 |
| PROJECT No                                                | DRAWING No |              |  |          |       |          |          |       |        |
| 25-004                                                    | 200        |              |  |          |       |          |          |       | B      |