

**TYPICAL CROSS SECTION - KRAFT ROAD**  
NEIGHBOURHOOD ROAD WIDENING  
SCALE 1: 100

107  
RPB7803

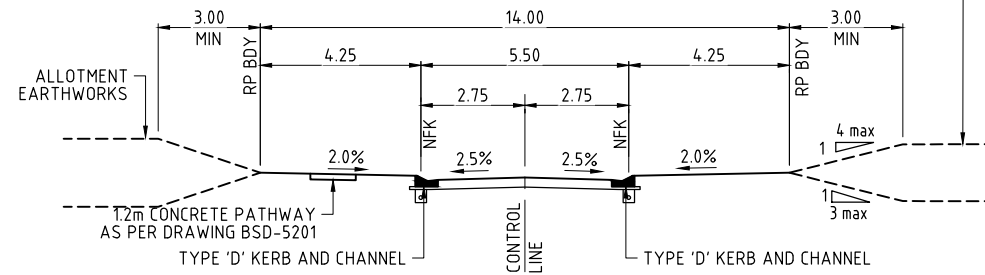

**TYPICAL CROSS SECTION - ROAD 1 & 2**  
LOCAL ROAD  
SCALE 1: 100

**LEGEND:**

- FINISHED CONTOURS
- EXISTING KERB & CHANNEL
- EXISTING EDGE OF BITUMEN
- PROPOSED KERB & CHANNEL
- PROPOSED RETAINING WALL
- DRAINAGE SWALE
- 10m BUSHFIRE BUFFER

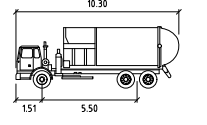

BCC SIDE LOAD REFUSE TRUCK

- Width : 2.50 meters
- Track : 2.50 meters
- Lock To Lock Time : 6.0
- Steering Angle : 35.7

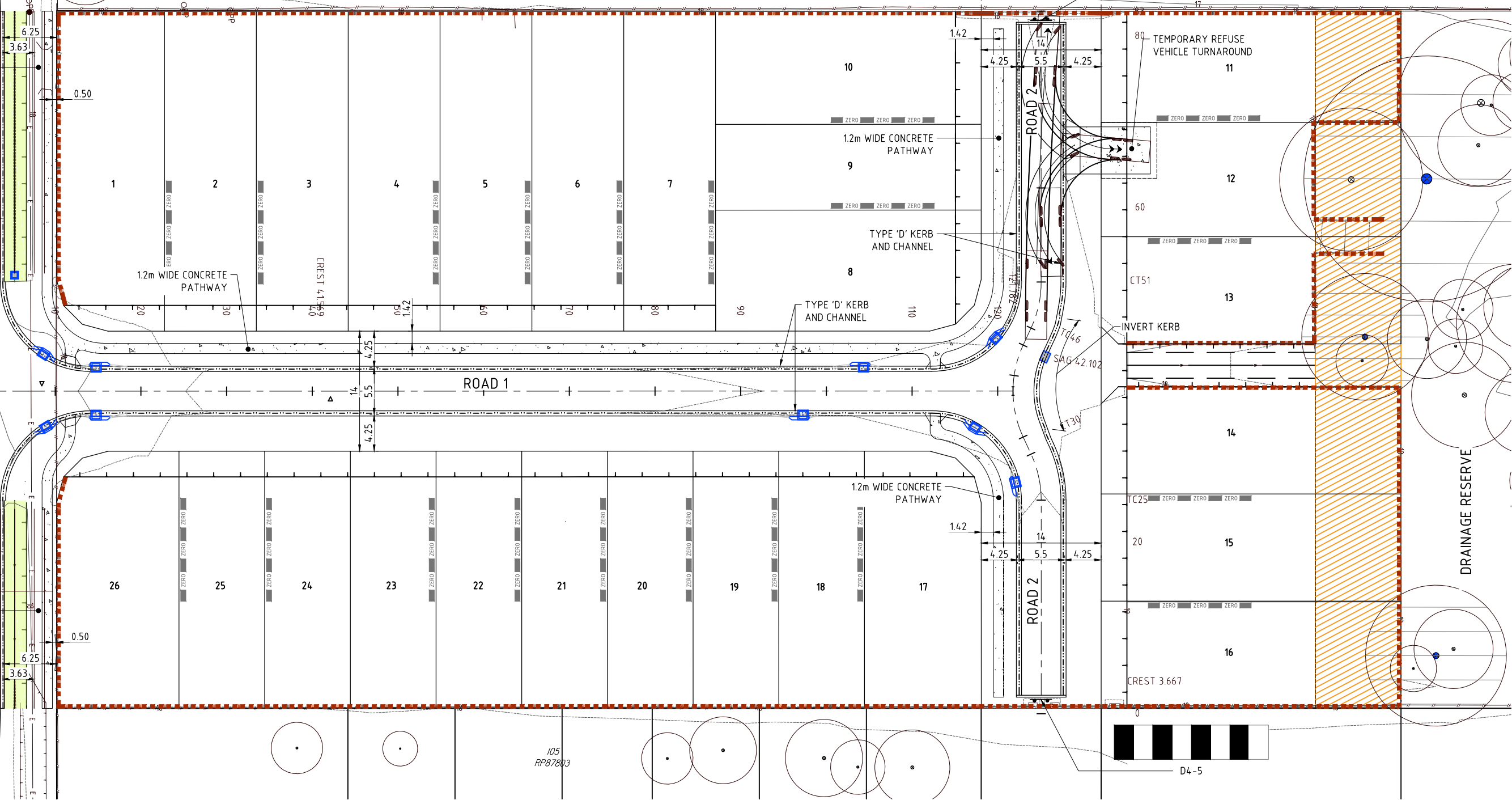
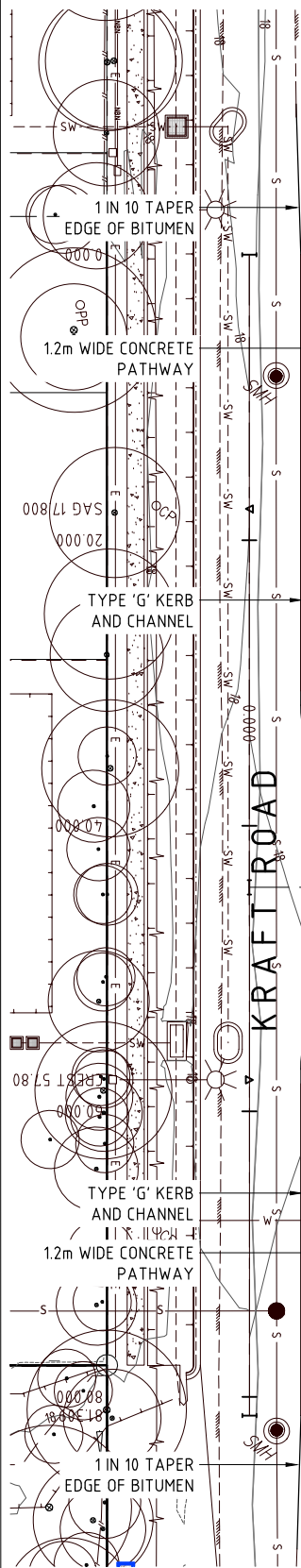

105  
RPB7803

**ENGINEERING CONCEPT - FUNCTIONAL TRAFFIC LAYOUT**

62 KRAFT ROAD, PALLARA  
ADC GROUP NO 12 PTY LTD

BCC DS  
RECEIVED  
08/06/2026  
APPLICATION REF  
A006135426

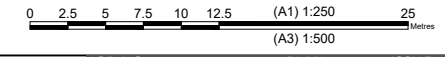

BRISBANE - SUNSHINE COAST - CENTRAL QLD  
BRISBANE  
JFP House - 76 Ernest Street,  
South Brisbane Qld 4101  
P 07 3012 0100 W www.jfp.com.au  
JFP URBAN CONSULTANTS PTY. LTD. A.C.N. 050 414 045

PLANNERS  
URBAN DESIGNERS  
SURVEYORS  
ENGINEERS  
LANDSCAPE ARCHITECTS

JOB NO: B3602EA7\_DA19 CT01  
PLAN: E  
ISSUE:  
SCALE: 1:250 @ A1  
DATE: 26/05/2026  
DRAFTED BY: FW  
FILE NAME: B3602EA7\_DA19.DWG

Z:\05\2026\N\B3602EA7\DESIGN\WORKING DRAWINGS\B3602EA7\_DWG

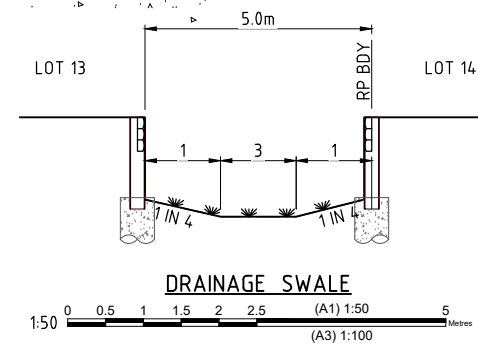

**NOTES:**

1. BATTERS BETWEEN ALLOTMENTS TO BE 1 IN 2 MAXIMUM.
2. PAD AND EARTHWORKS LEVELS ARE PRELIMINARY ONLY AND ARE SUBJECT TO DETAILED ENGINEERING DESIGN.
3. RETAINING WALL HEIGHTS ARE INDICATIVE ONLY AND ARE SUBJECT TO DETAIL ENGINEERING DESIGN.

**TREE LEGEND**

TREES TO BE RETAINED AND PROTECTED

TREES TO BE RETAINED AND REQUIRES THE SUPERVISION OF ANY EXCAVATION OR SERVICES WORKS WITHIN THE HATCHED PROTECTION ZONE BY AN ARBORIST ON SITE.

**TPZ**  
Tree Protection Zone  
All vegetation to be protected in accordance with AS4970 - Protection of Trees on Development Sites & any conditions of approval.

**LEGEND:**

- FINISHED CONTOURS
- PRELIMINARY PAD LEVEL (PL)
- PRELIMINARY FILLING
- PRELIMINARY EXCAVATION
- PRELIMINARY RETAINING WALL
- DRAINAGE SWALE
- 10m BUSHFIRE BUFFER

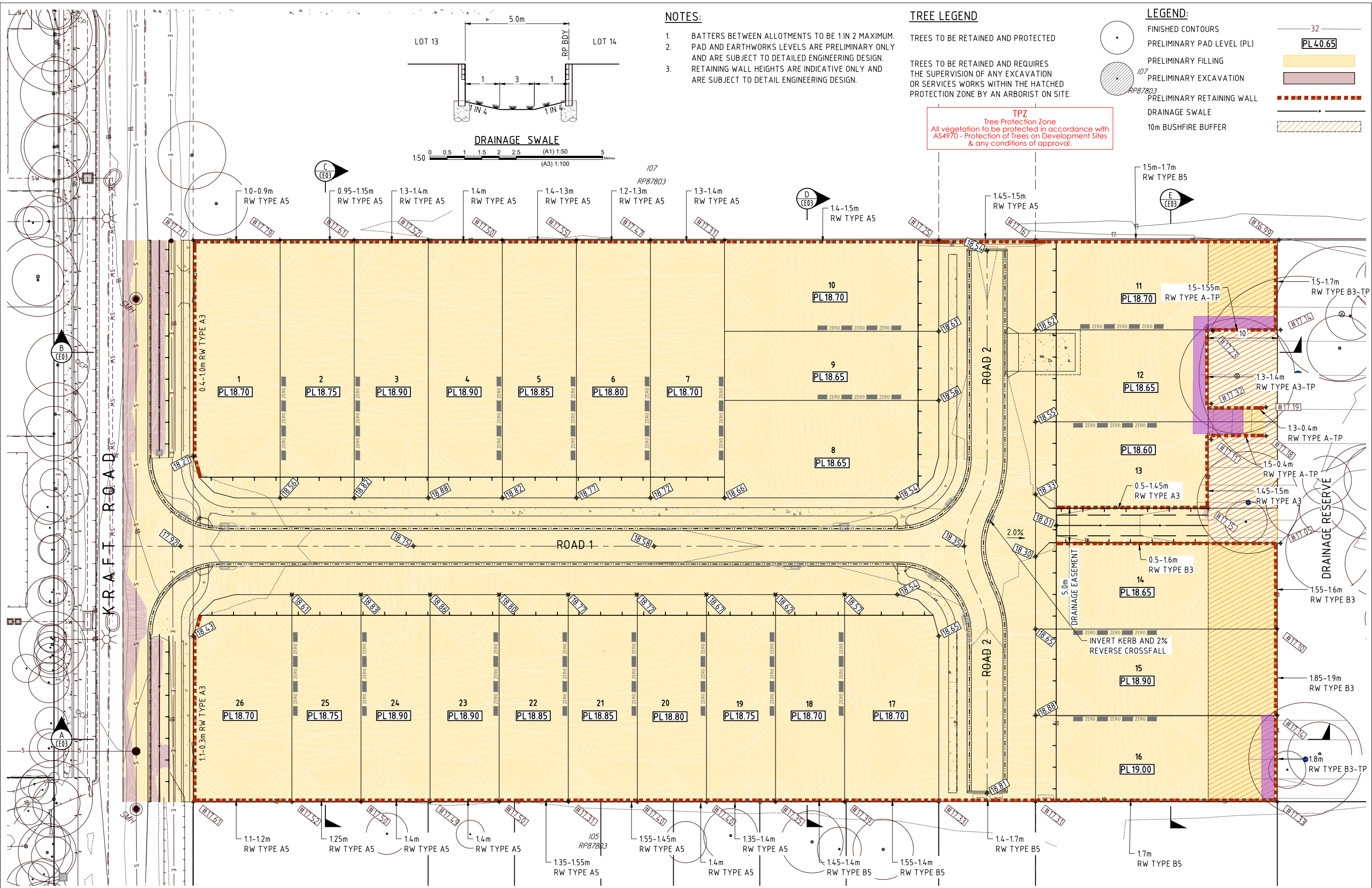

**ENGINEERING CONCEPT - EARTHWORKS LAYOUT PLAN**

62 KRAFT ROAD, PALLARA  
ADC GROUP NO 12 PTY LTD

BCC DS  
RECEIVED  
08/06/2026  
APPLICATION REF  
A006135426

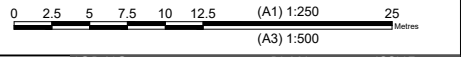

**JFOP**  
URBAN CONSULTANTS

BRISBANE - SUNSHINE COAST - CENTRAL QLD  
BRISBANE  
JFP House - 76 Ernest Street,  
South Brisbane Qld 4101  
P 07 3012 0100 W www.jfp.com.au

PLANNERS  
URBAN DESIGNERS  
SURVEYORS  
ENGINEERS  
LANDSCAPE ARCHITECTS

JOB NO: B3602EA7\_DA19 CE01  
PLAN: E  
ISSUE: E  
SCALE: 1:250 @ A1  
DATE: 26/05/2026  
DRAFTED BY: FW  
FILE NAME: B3602EA7\_DA19.DWG

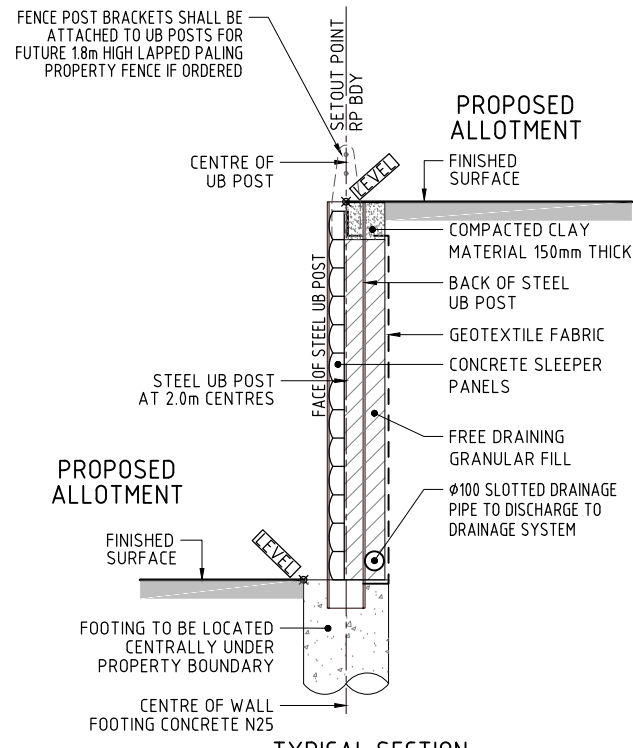

**TYPICAL SECTION  
CONCRETE SLEEPER/UB POST RETAINING WALL**  
SCALE 1:20

NOTE: RETAINING WALL DESIGN (INCLUDING FENCE POST BRACKETS AND FITTINGS) AND CONSTRUCTION CERTIFICATION TO INCORPORATE LOADING FROM FUTURE 1.8m HIGH LAPPED PALING PROPERTY FENCE

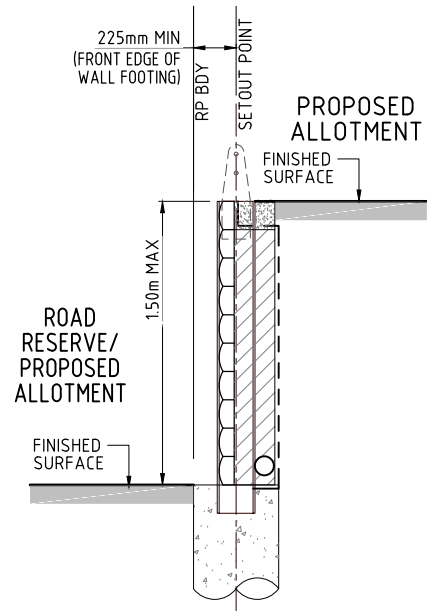

**TYPE A3  
CONCRETE SLEEPER RETAINING WALL**  
SCALE 1:20

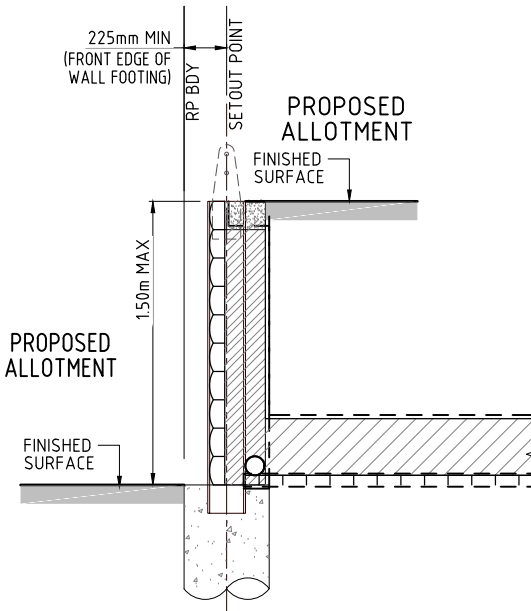

**TYPE A3-TP (TREE PROTECTION)  
CONCRETE SLEEPER RETAINING WALL**  
SCALE 1:20

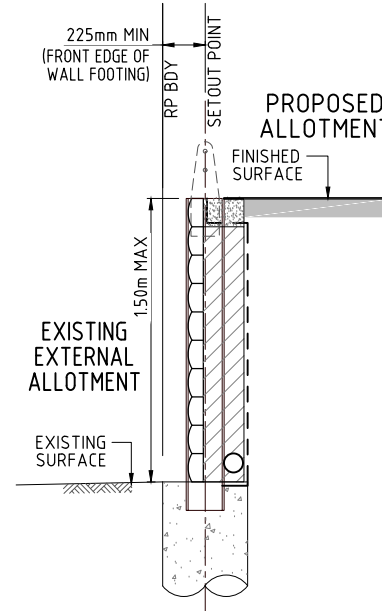

**TYPE A5  
CONCRETE SLEEPER RETAINING WALL**  
SCALE 1:20

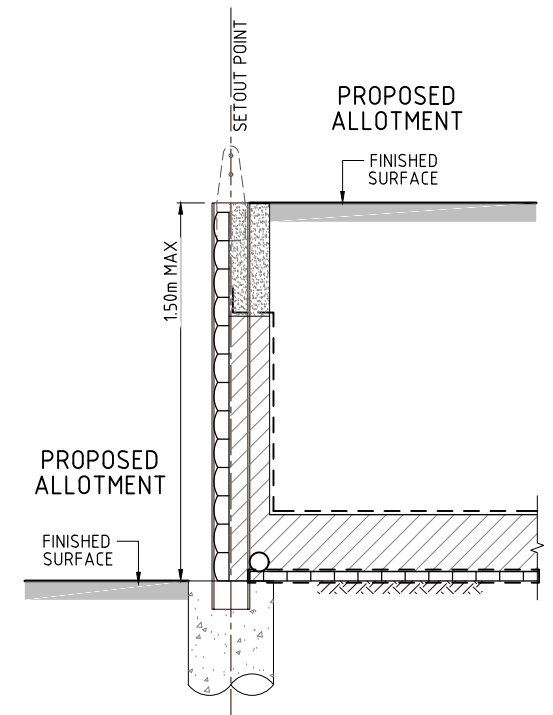

**TYPE A-TP (TREE PROTECTION)  
CONCRETE SLEEPER RETAINING WALL**  
SCALE 1:20

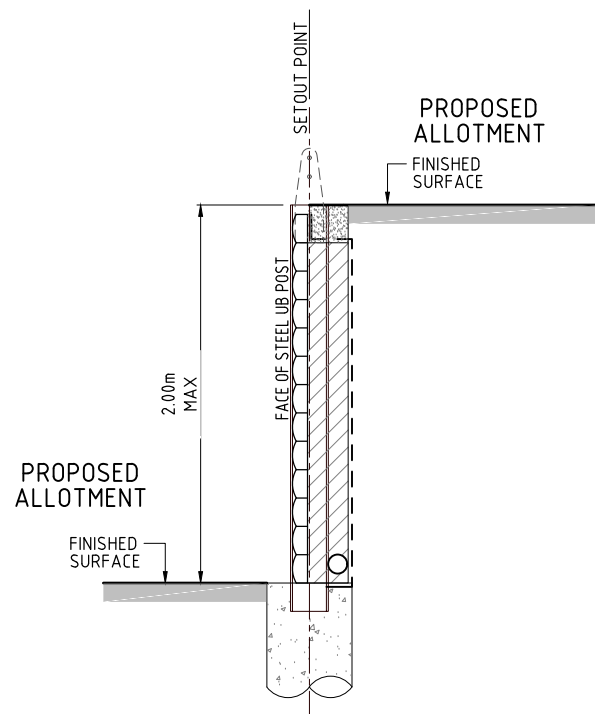

**TYPICAL SECTION - TYPE B  
CONCRETE SLEEPER/UB POST RETAINING WALL**  
SCALE 1:20

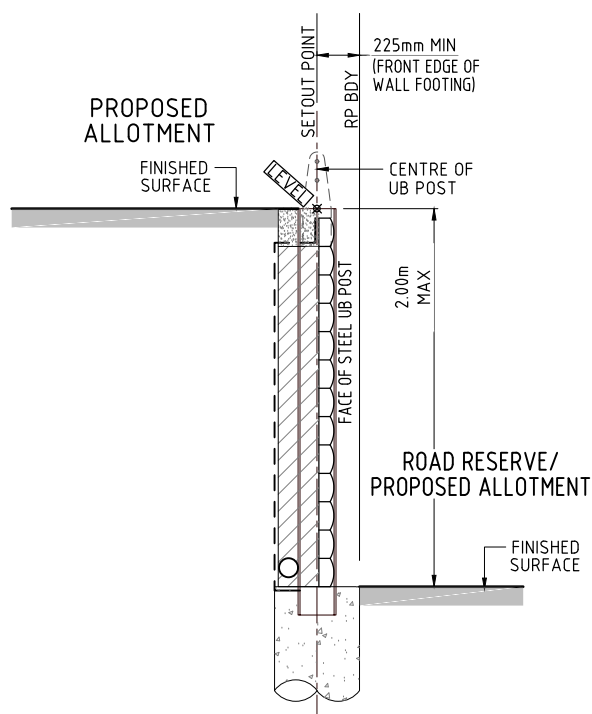

**TYPICAL SECTION - TYPE B3  
CONCRETE SLEEPER/UB POST RETAINING WALL**  
SCALE 1:20

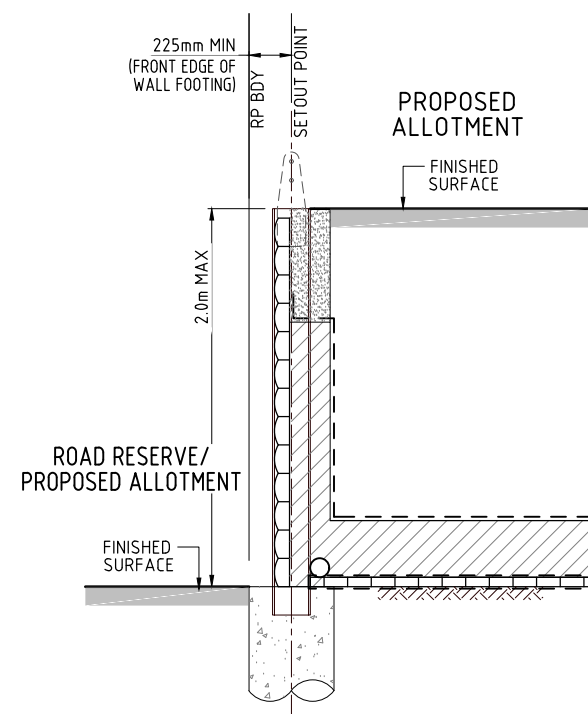

**TYPE B3-TP (TREE PROTECTION)  
CONCRETE SLEEPER RETAINING WALL**  
SCALE 1:20

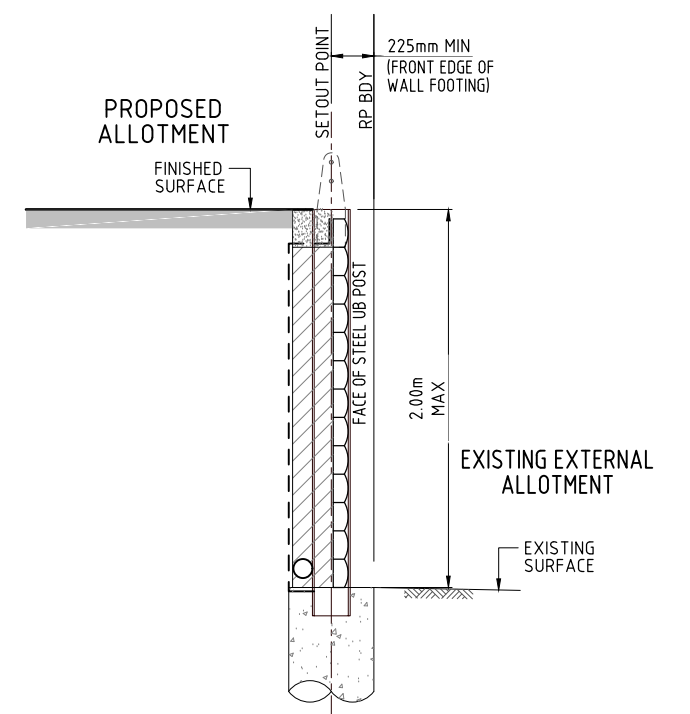

**TYPICAL SECTION - TYPE B5  
CONCRETE SLEEPER/UB POST RETAINING WALL**  
SCALE 1:20



BRISBANE - SUNSHINE COAST - CENTRAL QLD  
BRISBANE  
JFP House - 76 Ernest Street,  
South Brisbane Qld 4101  
P 07 3012 0100 W www.jfp.com.au

PLANNERS  
URBAN DESIGNERS  
SURVEYORS  
ENGINEERS  
LANDSCAPE ARCHITECTS

**ENGINEERING CONCEPT - EARTHWORKS DETAILS PLAN**

62 KRAFT ROAD, PALLARA  
ADC GROUP NO 12 PTY LTD

BCC DS  
RECEIVED  
08/06/2026  
APPLICATION REF  
A006135426

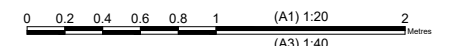

JOB NO: B3602EA7\_DA19 CE02 D  
SCALE: 1:20 @ A1  
DATE: 06/05/2026  
DRAFTED BY: FW  
FILE NAME: B3602EA7\_DA19.DWG

20/05/2026 14:18:02/DA19/DESIGN/WORKING DRAWING/B3602EA7\_DA19

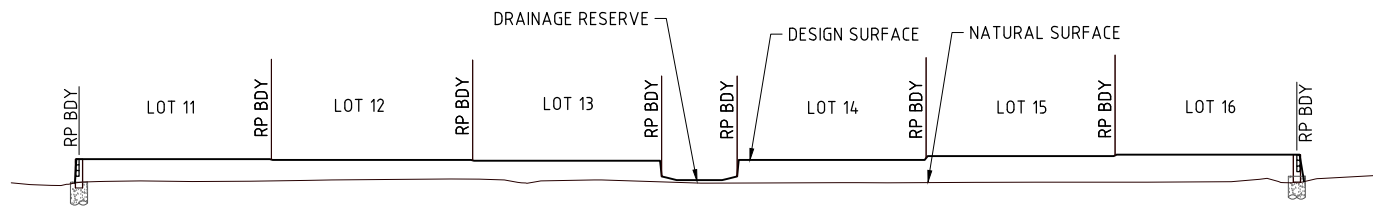

DATUM R.L. 10.0

SECTION **E**  
SCALE 1: 250

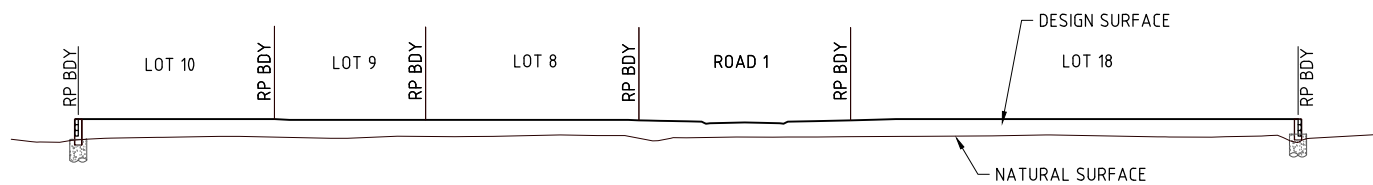

DATUM R.L. 10.0

SECTION **D**  
SCALE 1: 250

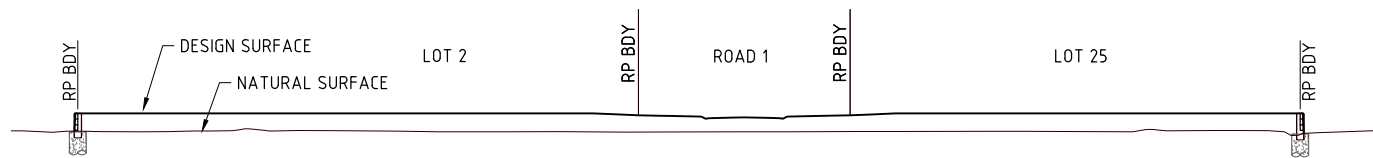

DATUM R.L. 10.0

SECTION **C**  
SCALE 1: 250

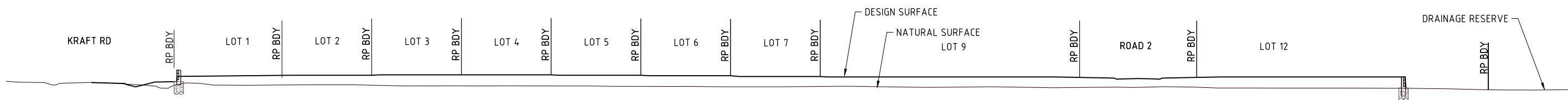

DATUM R.L. 10.0

SECTION **B**  
SCALE 1: 250

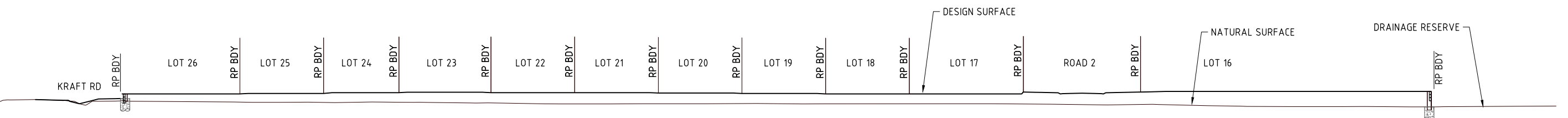

DATUM R.L. 10.0

SECTION **A**  
SCALE 1: 250



BRISBANE - SUNSHINE COAST - CENTRAL QLD  
BRISBANE  
JFP House - 76 Ernest Street,  
South Brisbane Qld 4101  
P 07 3012 0100 W www.jfp.com.au

PLANNERS  
URBAN DESIGNERS  
SURVEYORS  
ENGINEERS  
LANDSCAPE ARCHITECTS

## ENGINEERING CONCEPT - EARTHWORKS CROSS SECTIONS

62 KRAFT ROAD, PALLARA  
ADC GROUP NO 12 PTY LTD

BCC DS  
RECEIVED  
08/06/2026  
APPLICATION REF  
A006135426

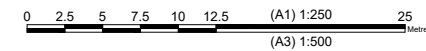

JOB NO: PLAN: ISSUE:  
B3602EA7\_DA19 CE03 E  
SCALE: 1:250 @ A1  
DATE: 26/05/2026  
DRAFTED BY: FW  
FILE NAME: B3602EA7\_DA19.DWG

**TREE LEGEND**

TREES TO BE RETAINED AND PROTECTED



TREES TO BE RETAINED AND REQUIRES THE SUPERVISION OF ANY EXCAVATION OR SERVICES WORKS WITHIN THE HATCHED PROTECTION ZONE BY AN ARBORIST ON SITE.



**TPZ**  
Tree Protection Zone  
All vegetation to be protected in accordance with AS4970 - Protection of Trees on Development Sites & any conditions of approval.

107  
RP87803

**PRELIMINARY SERVICES LEGEND:**

- |                          |  |                                |  |
|--------------------------|--|--------------------------------|--|
| PRELIMINARY DRAINAGE     |  | FINISHED CONTOURS              |  |
| PRELIMINARY SEWERAGE     |  | EXISTING WATER                 |  |
| PRELIMINARY WATER        |  | EXISTING SEWERAGE              |  |
| PRELIMINARY SLEEPER WALL |  | EXISTING DRAINAGE              |  |
| DRAINAGE SWALE           |  | EXISTING ROOFWATER             |  |
| 10m BUSHFIRE BUFFER      |  | EXISTING COMMUNICATIONS        |  |
| FLOW ARROW               |  | EXISTING ELECTRICAL (U/GROUND) |  |
| PRELIMINARY ROOFWATER    |  | EASEMENT                       |  |

- |  |          |
|--|----------|
|  | 32       |
|  | W        |
|  | S        |
|  | SW       |
|  | RW       |
|  | T        |
|  | E        |
|  | EASEMENT |

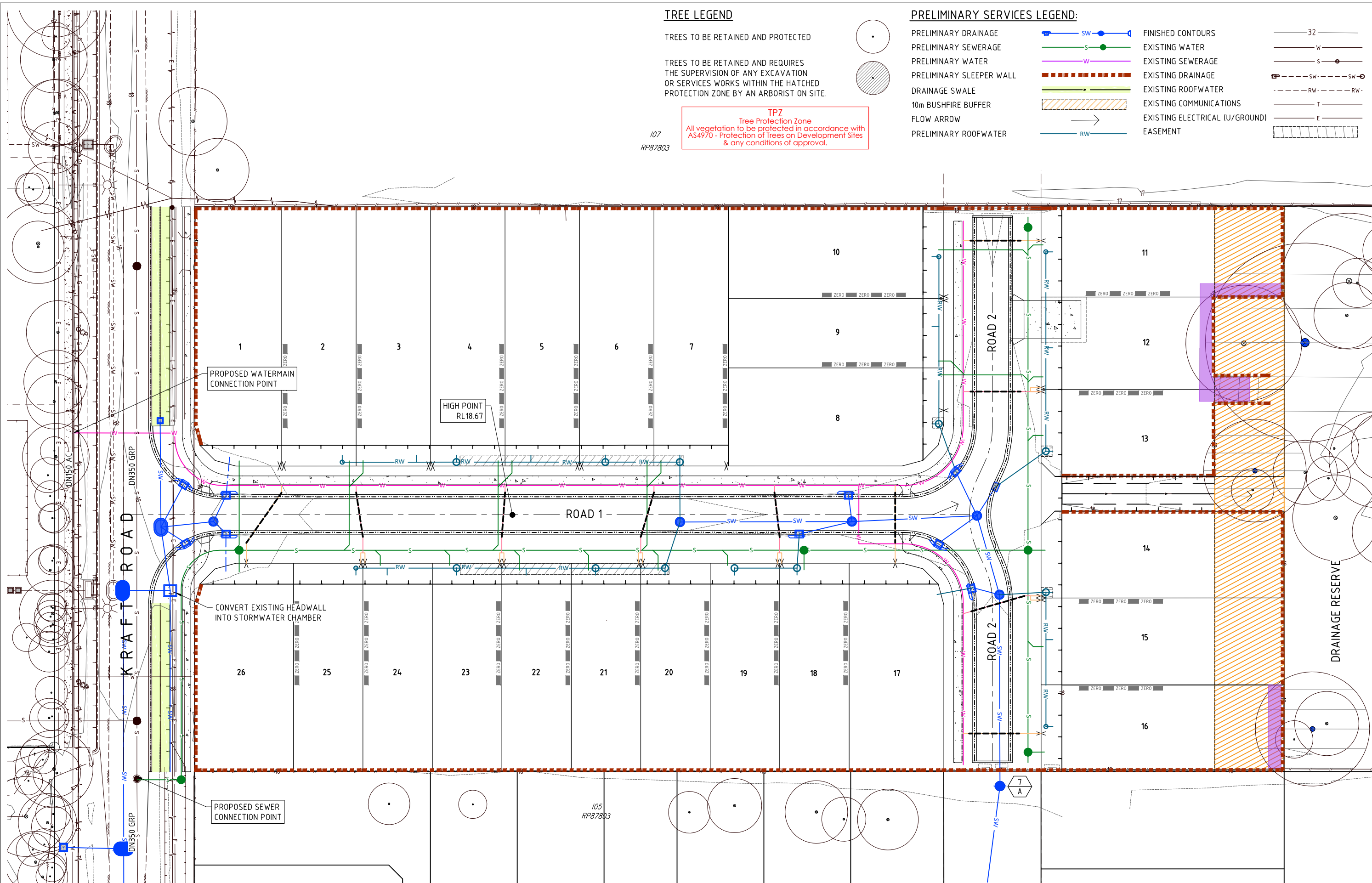

FOR CONTINUATION REFER PLAN 2 OF 4

**ENGINEERING CONCEPT - SERVICES LAYOUT PLAN 1 OF 4**

0 2.5 5 7.5 10 12.5 15 25  
(A1) 1:250  
(A3) 1:500

**JFOP**  
URBAN CONSULTANTS

BRISBANE - SUNSHINE COAST - CENTRAL QLD  
BRISBANE  
JFP House - 76 Ernest Street,  
South Brisbane Qld 4101  
P 07 3012 0100 W www.jfp.com.au

PLANNERS  
URBAN DESIGNERS  
SURVEYORS  
ENGINEERS  
LANDSCAPE ARCHITECTS

JFP URBAN CONSULTANTS PTY. LTD. A.C.N. 050 414 045  
COPYRIGHT © 2011 JFP URBAN CONSULTANTS PTY LTD. THIS DOCUMENT MAY NOT BE COPIED OR TRANSMITTED IN ANY FORM OR BY ANY MEANS IN PART OR IN WHOLE WITHOUT THE WRITTEN CONSENT OF JFP URBAN CONSULTANTS PTY LTD.

62 KRAFT ROAD, PALLARA  
ADC GROUP NO 12 PTY LTD

BCC DS  
RECEIVED  
08/06/2026  
APPLICATION REF  
A006135426

JOB NO: B3602EA7\_DA19 CS01  
SCALE: 1:250 @ A1  
DATE: 26/05/2026  
DRAFTED BY: FW  
FILE NAME: B3602EA7\_DA19.DWG

PLAN: CS01  
ISSUE: E

Z:\05\2026\N\16302\DA19\DESIGN\WORKING DRAWINGS\B3602EA7\_DA19

**TREE LEGEND**

TREES TO BE RETAINED AND PROTECTED



TREES TO BE RETAINED AND REQUIRES THE SUPERVISION OF ANY EXCAVATION OR SERVICES WORKS WITHIN THE HATCHED PROTECTION ZONE BY AN ARBORIST ON SITE.



**TPZ**  
Tree Protection Zone  
All vegetation to be protected in accordance with AS4970 - Protection of Trees on Development Sites & any conditions of approval.

**PRELIMINARY SERVICES LEGEND:**

- PRELIMINARY DRAINAGE
- PRELIMINARY SEWERAGE
- PRELIMINARY WATER
- PRELIMINARY SLEEPER WALL
- DRAINAGE SWALE
- 10m BUSHFIRE BUFFER
- FLOW ARROW
- PRELIMINARY ROOFWATER

- FINISHED CONTOURS
- EXISTING WATER
- EXISTING SEWERAGE
- EXISTING DRAINAGE
- EXISTING ROOFWATER
- EXISTING COMMUNICATIONS
- EXISTING ELECTRICAL (U/GROUND)

- 32
- W
- S
- SW
- RW
- T
- E

FOR CONTINUATION REFER PLAN 1 OF 4

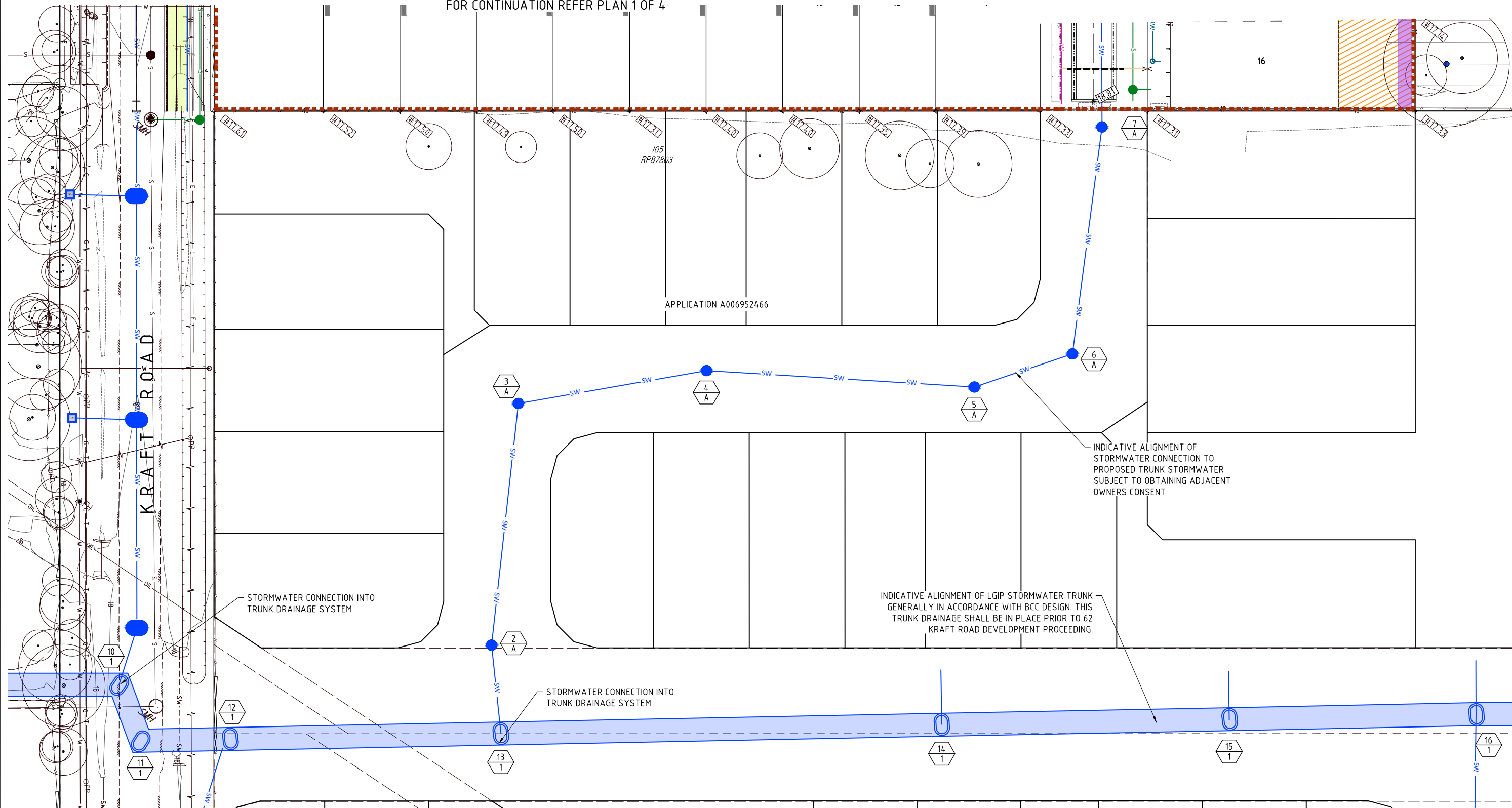

STORMWATER CONNECTION INTO TRUNK DRAINAGE SYSTEM

STORMWATER CONNECTION INTO TRUNK DRAINAGE SYSTEM

INDICATIVE ALIGNMENT OF LGIP STORMWATER TRUNK GENERALLY IN ACCORDANCE WITH BCC DESIGN. THIS TRUNK DRAINAGE SHALL BE IN PLACE PRIOR TO 62 KRAFT ROAD DEVELOPMENT PROCEEDING.

INDICATIVE ALIGNMENT OF STORMWATER CONNECTION TO PROPOSED TRUNK STORMWATER SUBJECT TO OBTAINING ADJACENT OWNERS CONSENT

**ENGINEERING CONCEPT - SERVICES LAYOUT PLAN 2 OF 4**

62 KRAFT ROAD, PALLARA  
ADC GROUP NO 12 PTY LTD

BCC DS  
RECEIVED  
08/06/2026  
APPLICATION REF  
A006135426

0 2.5 5 7.5 10 12.5 15 20 25 METRES  
(A1) 1:250  
(A3) 1:500

JOB NO: B3602EA7\_DA19 CS02 D  
SCALE: 1:250 @ A1  
DATE: 06/05/2026  
DRAFTED BY: FW  
FILE NAME: B3602EA7\_DA19.DWG

**JFOP**  
URBAN CONSULTANTS  
BRISBANE - SUNSHINE COAST - CENTRAL QLD  
BRISBANE  
JFP House - 76 Ernest Street,  
South Brisbane Qld 4101  
P 07 3012 0100 W www.jfp.com.au  
JFP URBAN CONSULTANTS PTY. LTD. A.C.N. 050 414 045

PLANNERS  
URBAN DESIGNERS  
SURVEYORS  
ENGINEERS  
LANDSCAPE ARCHITECTS

Z:\05\2026\19\B3602EA7\DA19\DESIGN\WORKING DRAWINGS\B3602EA7\_DA19

**TREE LEGEND**

TREES TO BE RETAINED AND PROTECTED



TREES TO BE RETAINED AND REQUIRES THE SUPERVISION OF ANY EXCAVATION OR SERVICES WORKS WITHIN THE HATCHED PROTECTION ZONE BY AN ARBORIST ON SITE.



**TPZ**  
Tree Protection Zone  
All vegetation to be protected in accordance with AS4970 - Protection of Trees on Development Sites & any conditions of approval.

**PRELIMINARY SERVICES LEGEND:**

- |                          |  |                                |  |
|--------------------------|--|--------------------------------|--|
| PRELIMINARY DRAINAGE     |  | FINISHED CONTOURS              |  |
| PRELIMINARY SEWERAGE     |  | EXISTING WATER                 |  |
| PRELIMINARY WATER        |  | EXISTING SEWERAGE              |  |
| PRELIMINARY SLEEPER WALL |  | EXISTING DRAINAGE              |  |
| DRAINAGE SWALE           |  | EXISTING ROOFWATER             |  |
| 10m BUSHFIRE BUFFER      |  | EXISTING COMMUNICATIONS        |  |
| FLOW ARROW               |  | EXISTING ELECTRICAL (U/GROUND) |  |
| PRELIMINARY ROOFWATER    |  |                                |  |

FOR CONTINUATION REFER PLAN 4 OF 4

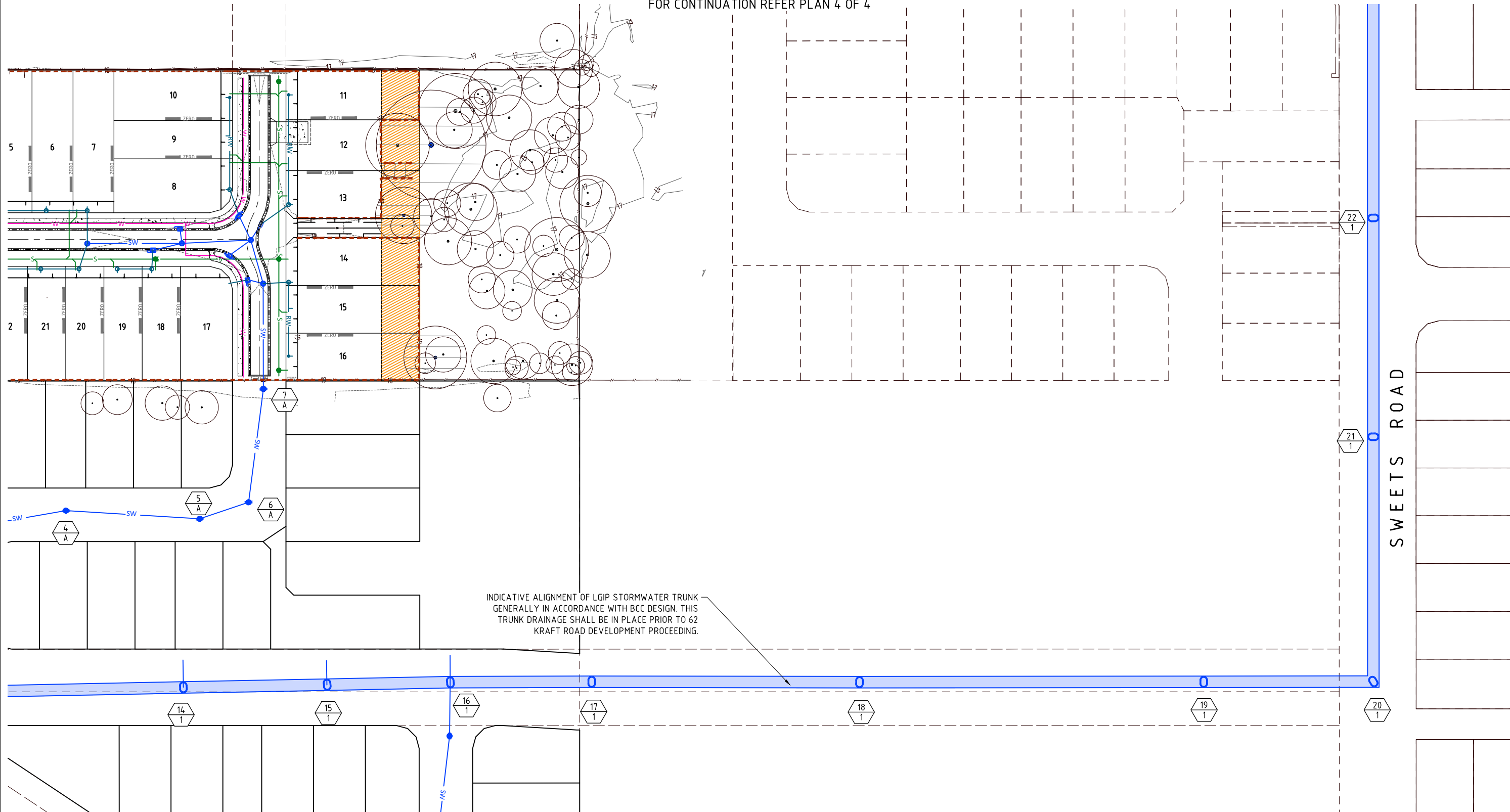

INDICATIVE ALIGNMENT OF LGIP STORMWATER TRUNK  
GENERALLY IN ACCORDANCE WITH BCC DESIGN. THIS  
TRUNK DRAINAGE SHALL BE IN PLACE PRIOR TO 62  
KRAFT ROAD DEVELOPMENT PROCEEDING.

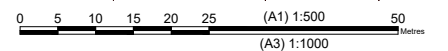

**JFOP**  
BRISBANE - SUNSHINE COAST - CENTRAL QLD  
BRISBANE  
JFP House - 76 Ernest Street,  
South Brisbane Qld 4101  
P 07 3012 0100 W www.jfp.com.au  
URBAN CONSULTANTS JFP URBAN CONSULTANTS PTY. LTD. A.C.N. 050 414 045

- PLANNERS
- URBAN DESIGNERS
- SURVEYORS
- ENGINEERS
- LANDSCAPE ARCHITECTS

**ENGINEERING CONCEPT - SERVICES LAYOUT PLAN 3 OF 4**

62 KRAFT ROAD, PALLARA  
ADC GROUP NO 12 PTY LTD

BCC DS  
RECEIVED  
08/06/2026  
APPLICATION REF  
A006135426

JOB NO: B3602EA7\_DA19 CS03  
SCALE: 1:500 @ A1  
DATE: 26/05/2026  
DRAFTED BY: FW  
FILE NAME: B3602EA7\_DA19.DWG  
ISSUE: E

Z:\05\2026\19\B3602EA7\DA19\DESIGN\WORKING DRAWINGS\B3602EA7\_DA19

**TREE LEGEND**

TREES TO BE RETAINED AND PROTECTED



TREES TO BE RETAINED AND REQUIRES THE SUPERVISION OF ANY EXCAVATION OR SERVICES WORKS WITHIN THE HATCHED PROTECTION ZONE BY AN ARBORIST ON SITE.



**TPZ**  
Tree Protection Zone  
All vegetation to be protected in accordance with AS4970 - Protection of Trees on Development Sites & any conditions of approval.

**PRELIMINARY SERVICES LEGEND:**

- PRELIMINARY DRAINAGE
- PRELIMINARY SEWERAGE
- PRELIMINARY WATER
- PRELIMINARY SLEEPER WALL
- DRAINAGE SWALE
- 10m BUSHFIRE BUFFER
- FLOW ARROW
- PRELIMINARY ROOFWATER

- SW
- S
- W
- SW
- RW
- SW
- RW
- RW

- FINISHED CONTOURS
- EXISTING WATER
- EXISTING SEWERAGE
- EXISTING DRAINAGE
- EXISTING ROOFWATER
- EXISTING COMMUNICATIONS
- EXISTING ELECTRICAL (U/GROUND)

- 32
- W
- S
- SW
- RW
- T
- E

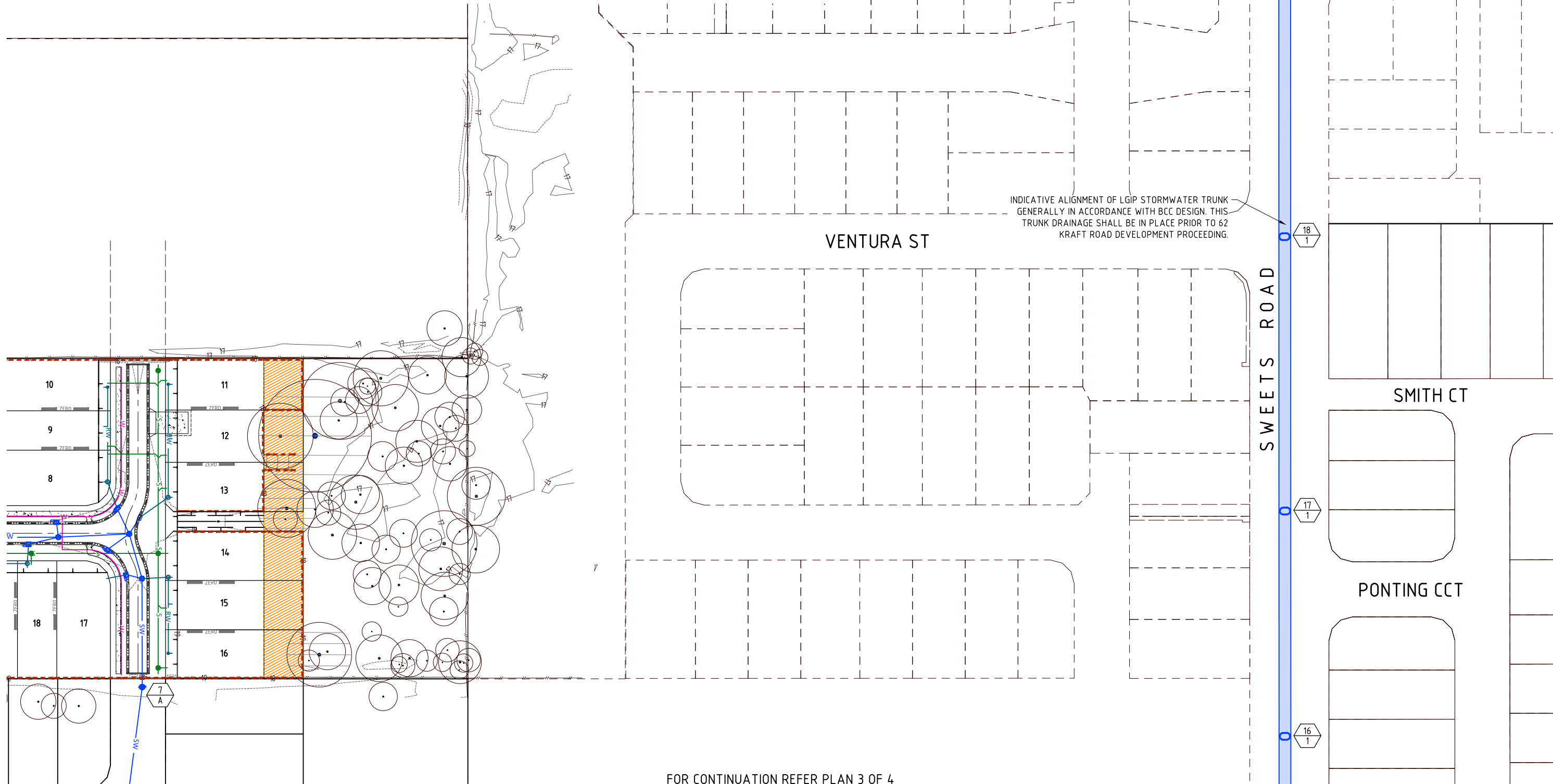

FOR CONTINUATION REFER PLAN 3 OF 4

**ENGINEERING CONCEPT - SERVICES LAYOUT PLAN 4 OF 4**

62 KRAFT ROAD, PALLARA  
ADC GROUP NO 12 PTY LTD

- PLANNERS
- URBAN DESIGNERS
- SURVEYORS
- ENGINEERS
- LANDSCAPE ARCHITECTS

BCC DS  
RECEIVED  
08/06/2026  
APPLICATION REF  
A006135426

JOB NO: B3602EA7\_DA19 CS04 E  
PLAN: CS04  
ISSUE: E  
SCALE: 1:500 @ A1  
DATE: 26/05/2026  
DRAFTED BY: FW  
FILE NAME: B3602EA7\_DA19.DWG



BRISBANE - SUNSHINE COAST - CENTRAL QLD  
BRISBANE  
JFP House - 76 Ernest Street,  
South Brisbane Qld 4101  
P 07 3012 0100 W www.jfp.com.au  
JFP URBAN CONSULTANTS PTY. LTD. A.C.N. 050 414 045

COPYRIGHT © 2011 JFP URBAN CONSULTANTS PTY LTD. THIS DOCUMENT MAY NOT BE COPIED OR TRANSMITTED IN ANY FORM OR BY ANY MEANS IN PART OR IN WHOLE WITHOUT THE WRITTEN CONSENT OF JFP URBAN CONSULTANTS PTY LTD.

26/05/2026 14:18:00 J:\PROJECTS\62 KRAFT ROAD\DESIGN\WORKING DRAWINGS\B3602EA7\_DA19

STRUCTURE NUMBER	1-9	1-10	1-11	1-12	1-13	1-14	1-15	1-16	1-17	1-18	1-19	1-20	1-21	1-22													
STRUCTURE DESCRIPTION	STD BCC MANHOLE 1500mm DIAMETER; EXT 900mm	STD BCC MANHOLE 1500mm DIAMETER; EXT 900mm	STD BCC MANHOLE 1500mm DIAMETER; EXT 900mm	STD BCC MANHOLE 1500mm DIAMETER; EXT 900mm	STD BCC MANHOLE 1500mm DIAMETER; EXT 900mm	STD BCC MANHOLE 1500mm DIAMETER; EXT 900mm	STD BCC MANHOLE 1500mm DIAMETER; EXT 900mm	CUSTOM MANHOLE REFER TO DETAIL	STD BCC MANHOLE 1500mm DIAMETER; EXT 900mm	STD BCC MANHOLE 1500mm DIAMETER; EXT 900mm	STD BCC MANHOLE 1500mm DIAMETER; EXT 900mm	STD BCC MANHOLE 1500mm DIAMETER; EXT 900mm	STD BCC MANHOLE 1500mm DIAMETER; EXT 900mm	CUSTOM MANHOLE REFER TO DETAIL													
EXISTING SURFACE	[Profile line showing existing ground surface]																										
PROPOSED SURFACE	[Profile line showing proposed stormwater pipe surface]																										
PIPE SIZE (mm)	2100x900	2700x900	2700x900	2700x1200	2700x1200	2700x1200	2700x1200	2700x1200	3000x1200	3000x1200	3000x1200	3000x1200	3000x1200	(2x)2100x900													
PIPE CLASS	RCBC	RCBC	RCBC	RCBC	RCBC	RCBC	RCBC	RCBC	RCBC	RCBC	RCBC	RCBC	RCBC	RCBC													
PIPE GRADE (%)	0.2%	0.2%	0.2%	0.2%	0.2%	0.2%	0.2%	0.2%	0.2%	0.2%	0.2%	0.2%	0.2%	0.2%													
PIPE GRADE (1 in)	1 in 500	1 in 500	1 in 500	1 in 500	1 in 500	1 in 500	1 in 500	1 in 500	1 in 500	1 in 500	1 in 500	1 in 500	1 in 500	1 in 500													
DATUM RL (m)	-4.0																										
DEPTH TO INVERT	1.875	1.987	2.127	2.030	2.180	2.146	2.125	2.105	2.061	2.044	1.941	2.281	2.231	2.090													
INVERT LEVEL OF DRAIN	16.423	16.307	16.292	16.268	16.197	16.082	16.007	15.943	15.869	15.729	15.549	15.460	15.332	15.217													
DESIGN SURFACE LEVEL	18.298	18.294	18.418	18.298	18.378	18.228	18.132	18.048	17.930	17.772	17.489	17.741	17.563	17.308													
RUNNING CHAINAGE PIPE LENGTH	377.744	57.792	4.35.537	7.807	4.43.343	11.734	4.55.078	35.331	4.90.409	57.584	54.7.992	37.580	5.85.572	32.157	6.17.729	37.060	6.54.789	70.000	7.24.789	90.000	8.14.789	4.4.378	8.59.167	63.952	9.23.119	57.377	9.80.496
LINE	1				1																						

EXISTING SURFACE  
PROPOSED SURFACE

FSL 18.380  
FSL 18.263  
FSL 18.167  
FSL 18.071  
FSL 17.966  
FSL 17.829  
FSL 17.641  
FSL 17.565

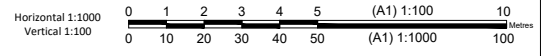

BRISBANE - SUNSHINE COAST - CENTRAL QLD  
BRISBANE  
JFP House - 76 Ernest Street,  
South Brisbane Qld 4101  
P 07 3012 0100 W www.jfp.com.au

PLANNERS  
URBAN DESIGNERS  
SURVEYORS  
ENGINEERS  
LANDSCAPE ARCHITECTS

## ENGINEERING CONCEPT - LGIP STORMWATER LONG SECTION - SHEET 1 OF 2

62 KRAFT ROAD, PALLARA  
ADC GROUP NO 12 PTY LTD

BCC DS  
RECEIVED  
08/06/2026  
APPLICATION REF  
A006135426

JOB NO: B3602EA7\_DA19 CS05 C  
SCALE: H: 1:1000 V: 1:100 @ A1  
DATE: 06/05/2026  
DRAFTED BY: FW  
FILE NAME: B3602EA7\_DA19.DWG

STRUCTURE NUMBER	1-22	1-23	1-24	1-25	1-26
STRUCTURE DESCRIPTION	CUSTOM MANHOLE REFER TO DETAIL	STD BCC MANHOLE 1500mm DIAMETER, EXT 900mm	CUSTOM MANHOLE REFER TO DETAIL	STD BCC MANHOLE 1500mm DIAMETER, EXT 900mm	OUTFALL
PIPE SIZE (mm)	(2x)2100x900		(2x)2100x900		(2x)2100x900
PIPE CLASS	RCBC		RCBC		RCBC
PIPE GRADE (%)	0.2%		0.2%		0.2%
PIPE GRADE (1 in)	1 in 500		1 in 500		1 in 500
DATUM RL (m)	-6.0				
DEPTH TO INVERT	2.090	1.928	1.831	1.828	0.900
INVERT LEVEL OF DRAIN	15.217	15.078	14.936	14.897	14.870
DESIGN SURFACE LEVEL	17.308	17.006	16.768	16.725	15.770
RUNNING CHAINAGE PIPE LENGTH	980.496	69.645	70.894	19.728	13.347

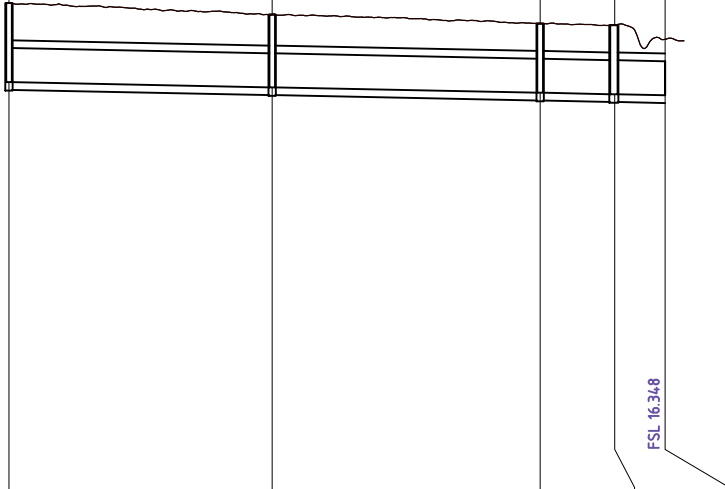

LINE 1

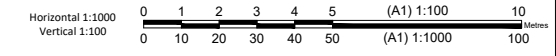

BRISBANE - SUNSHINE COAST - CENTRAL QLD  
 BRISBANE  
 JFP House - 76 Ernest Street,  
 South Brisbane Qld 4101  
 P 07 3012 0100 W www.jfp.com.au

PLANNERS  
 URBAN DESIGNERS  
 SURVEYORS  
 ENGINEERS  
 LANDSCAPE ARCHITECTS

## ENGINEERING CONCEPT - LGIP STORMWATER LONG SECTION - SHEET 2 OF 2

62 KRAFT ROAD, PALLARA  
 ADC GROUP NO 12 PTY LTD

BCC DS  
 RECEIVED  
 08/06/2026  
 APPLICATION REF  
 A006135426

JOB NO: B3602EA7\_DA19 CS06 C  
 PLAN: H: 1:1000 V: 1:100 @ A1  
 DATE: 06/05/2026  
 DRAFTED BY: FW  
 FILE NAME: B3602EA7\_DA19.DWG

COPYRIGHT © 2011 JFP URBAN CONSULTANTS PTY LTD. THIS DOCUMENT MAY NOT BE COPIED OR TRANSMITTED IN ANY FORM OR BY ANY MEANS IN PART OR IN WHOLE WITHOUT THE WRITTEN CONSENT OF JFP URBAN CONSULTANTS PTY LTD.

Z:\05\2026\19\B3602EA7\DA19\DESIGN\WORKING DRAWINGS\B3602EA7\_DA19

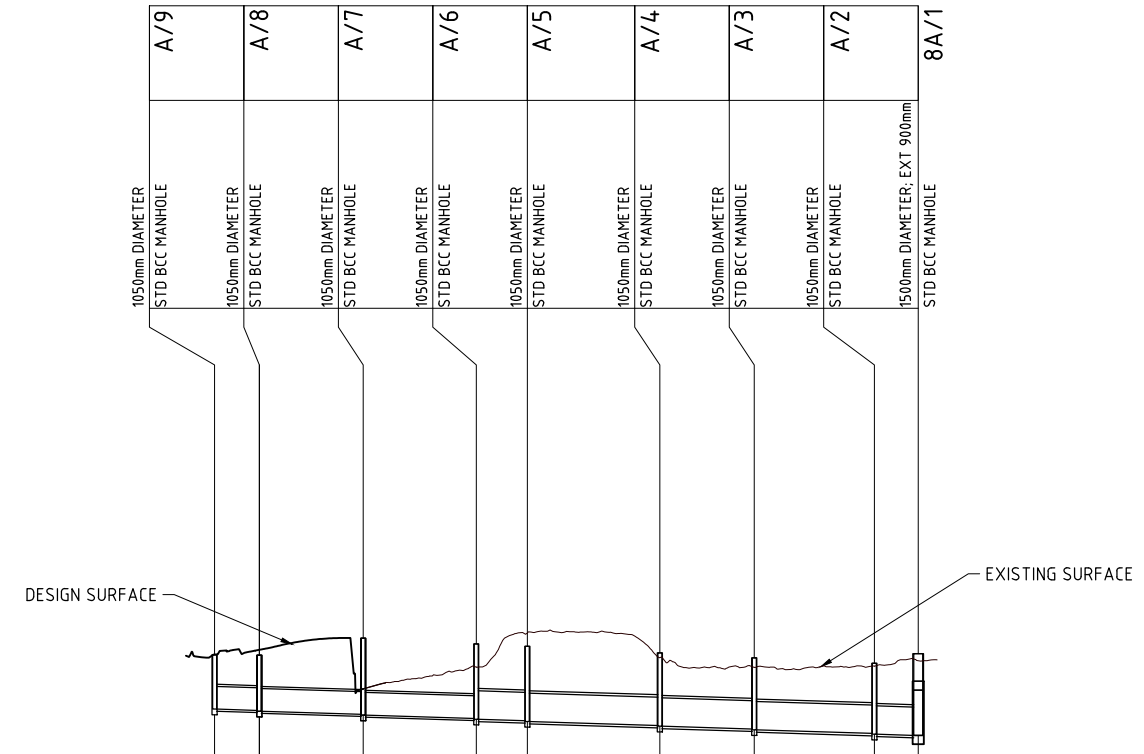

PIPE SIZE (mm)	600	600	600	750	750	750	750	750	750								
PIPE CLASS	4	4	4	4	4	4	4	4	4								
PIPE GRADE (%)	0.3%	0.3%	0.3%	0.3%	0.3%	0.3%	0.3%	0.3%	0.3%								
PIPE GRADE (1 in)	1 in 333.3	1 in 333.3	1 in 333.5	1 in 333.5	1 in 333.5	1 in 333.5	1 in 333.5	1 in 333.5	1 in 333.5								
DATUM RL (m)	0.0																
DEPTH TO INVERT	1.439	-16.860	-16.840	2.010	2.030	1.973	1.993	1.969	1.989	1.919	1.939	1.883	1.903	1.855	1.875	1.697	2.165
INVERT LEVEL OF DRAIN	16.895	16.860	16.840	16.757	16.737	16.648	16.628	16.587	16.567	16.462	16.442	16.367	16.347	16.252	16.232	16.197	
DESIGN SURFACE LEVEL	18.334	0.000	18.767	18.767	18.620	18.556	18.381	18.250	18.107	18.000	17.855	17.710	17.565	17.420	17.275	17.130	16.985
RUNNING CHAINAGE	176.558	11.828	164.730	27.495	137.234	29.907	107.327	13.515	93.812	18.556	35.076	58.736	24.969	33.767	31.769	1.997	11.612
PIPE LENGTH																	
LINE	A																

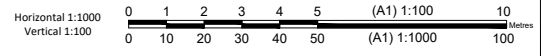

## ENGINEERING CONCEPT - STORMWATER LONG SECTION - SHEET 1 OF 1

62 KRAFT ROAD, PALLARA  
ADC GROUP NO 12 PTY LTD

**BCC DS**  
 RECEIVED  
 08/06/2026  
 APPLICATION REF  
 A006135426

JOB NO: B3602EA7\_DA19 CS07 C  
 SCALE: H: 1:1000 V: 1:100 @ A1  
 DATE: 06/05/2026  
 DRAFTED BY: FW  
 FILE NAME: B3602EA7\_DA19.DWG

**JFP**  
 BRISBANE - SUNSHINE COAST - CENTRAL QLD  
 BRISBANE  
 JFP House - 76 Ernest Street,  
 South Brisbane Qld 4101  
 P 07 3012 0100 W www.jfp.com.au

PLANNERS  
 URBAN DESIGNERS  
 SURVEYORS  
 ENGINEERS  
 LANDSCAPE ARCHITECTS

URBAN CONSULTANTS  
JFP URBAN CONSULTANTS PTY. LTD. A.C.N. 050 414 045

COPYRIGHT © 2011 JFP URBAN CONSULTANTS PTY LTD. THIS DOCUMENT MAY NOT BE COPIED OR TRANSMITTED IN ANY FORM OR BY ANY MEANS IN PART OR IN WHOLE WITHOUT THE WRITTEN CONSENT OF JFP URBAN CONSULTANTS PTY LTD.

Z:\05\2026\B3602EA7\DA19\DESIGN\WORKING DRAWINGS\B3602EA7\_DA19

**TREE LEGEND**

TREES TO BE RETAINED AND PROTECTED



TREES TO BE RETAINED AND REQUIRES THE SUPERVISION OF ANY EXCAVATION OR SERVICES WORKS WITHIN THE HATCHED PROTECTION ZONE BY AN ARBORIST ON SITE.



**TPZ**  
Tree Protection Zone  
All vegetation to be protected in accordance with AS4970 - Protection of Trees on Development Sites & any conditions of approval.

107  
RP87803

**PRELIMINARY SERVICES LEGEND:**

- PRELIMINARY DRAINAGE SW
- PRELIMINARY SEWERAGE S
- PRELIMINARY WATER W
- PRELIMINARY SLEEPER WALL
- DRAINAGE SWALE
- 10m BUSHFIRE BUFFER
- PRELIMINARY ROOFWATER RW
- FINISHED CONTOURS
- EXISTING WATER
- EXISTING SEWERAGE
- EXISTING DRAINAGE
- EXISTING ROOFWATER
- EXISTING COMMUNICATIONS
- EXISTING ELECTRICAL (U/GROUND)

- 32
- W
- S
- SW
- RW
- T
- E

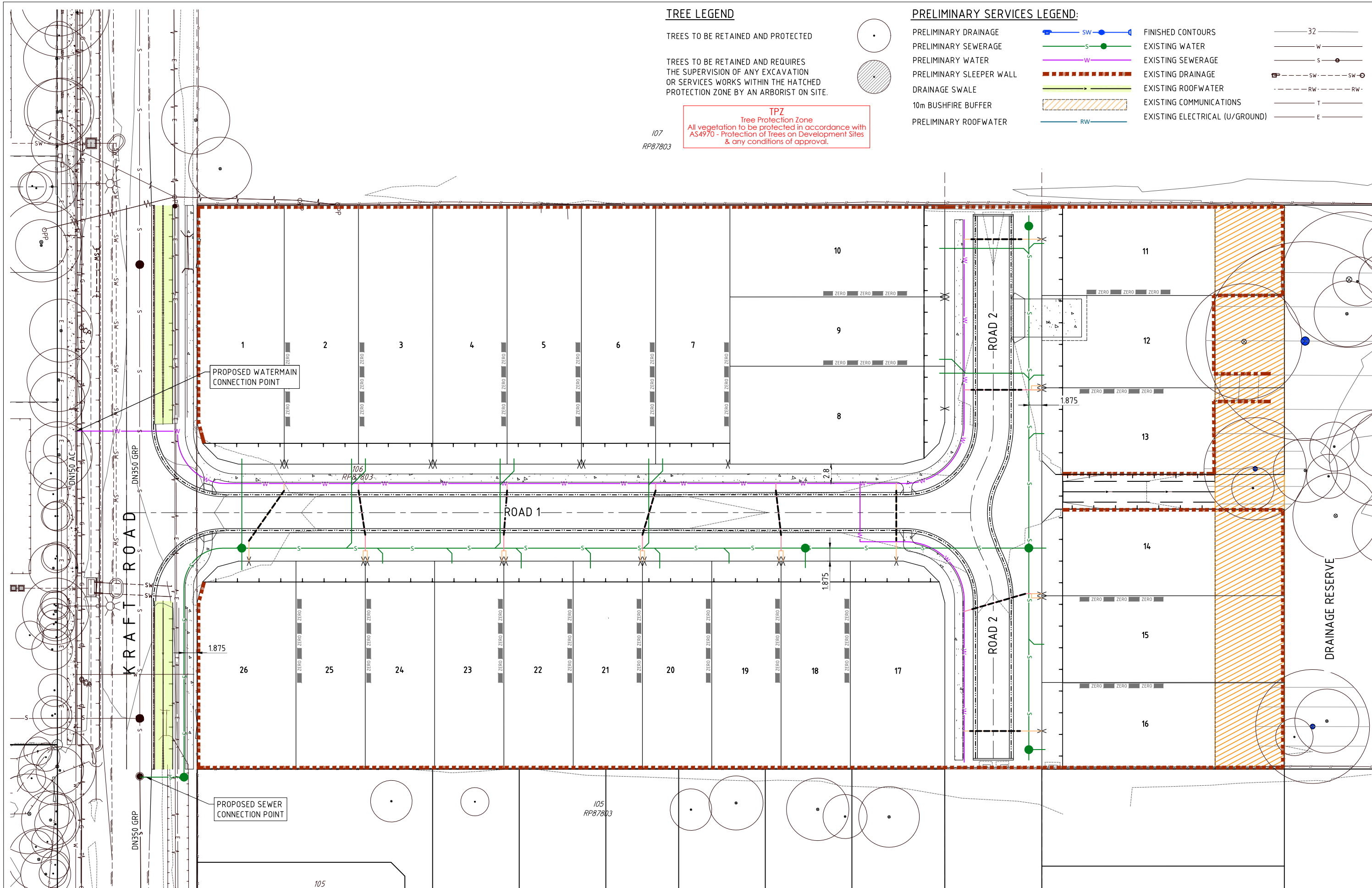

BRISBANE - SUNSHINE COAST - CENTRAL QLD  
 BRISBANE  
 JFP House - 76 Ernest Street,  
 South Brisbane Qld 4101  
 P 07 3012 0100 W www.jfp.com.au

PLANNERS  
 URBAN DESIGNERS  
 SURVEYORS  
 ENGINEERS  
 LANDSCAPE ARCHITECTS

**ENGINEERING CONCEPT - WATER & WASTE WATER LAYOUT PLAN**

62 KRAFT ROAD, PALLARA  
 ADC GROUP NO 12 PTY LTD

BCC DS  
 RECEIVED  
 08/06/2026  
 APPLICATION REF  
 A006135426

0 2.5 5 7.5 10 12.5 (A1) 1:250 25  
 (A3) 1:500

JOB NO: B3602EA7\_DA19  
 PLAN: CW01  
 ISSUE: E  
 SCALE: 1:250 @ A1  
 DATE: 26/05/2026  
 DRAFTED BY: FW  
 FILE NAME: B3602EA7\_DA19.DWG

COPYRIGHT © 2011 JFP URBAN CONSULTANTS PTY LTD. THIS DOCUMENT MAY NOT BE COPIED OR TRANSMITTED IN ANY FORM OR BY ANY MEANS IN PART OR IN WHOLE WITHOUT THE WRITTEN CONSENT OF JFP URBAN CONSULTANTS PTY LTD.