

BCC DS
RECEIVED
 08/06/2026
APPLICATION REF
 A007043433

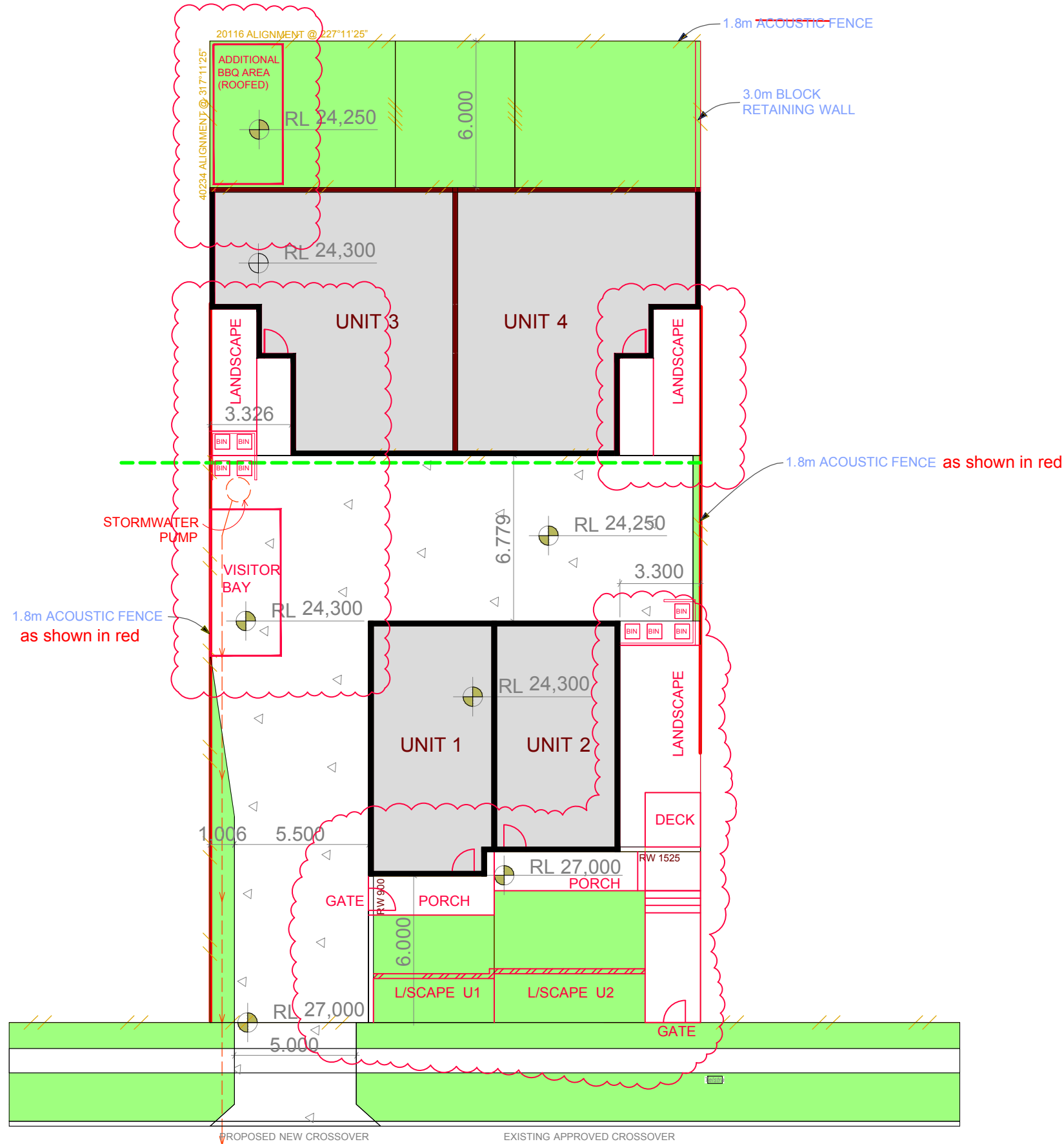

©Copyright SKYCITY DEVELOPMENTS.
 Do not copy any part of this drawing without the prior written consent of the copyright owner.
 Use figured dimensions in preference to scale.
 Check all dimensions on site and report any discrepancies to SKYCITY DEVELOPMENTS.
 Use the building code of Australia as the minimum standard of compliance.

sergestojanovic@gmail.com

PROPOSED NEW 2 X TOWNHOUSE UNITS (2 x MUD)
& 1 X RENOVATION OF HOUSE (2 x MUD) at
 15 WILKINS STREET, ANNERLEY QLD 4103

rev	date	details	init.
01	17.08.2023	DA ISSUE	
02	21.04.2026	REVISED ELEMENTS	

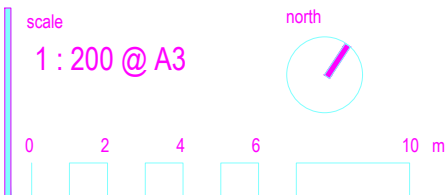

DA ISSUE
SITE PLAN - PROPOSED

DA-A-03b
 21.04.2026 rev. 02

BCC DS
RECEIVED
 08/06/2026
APPLICATION REF
 A007043433

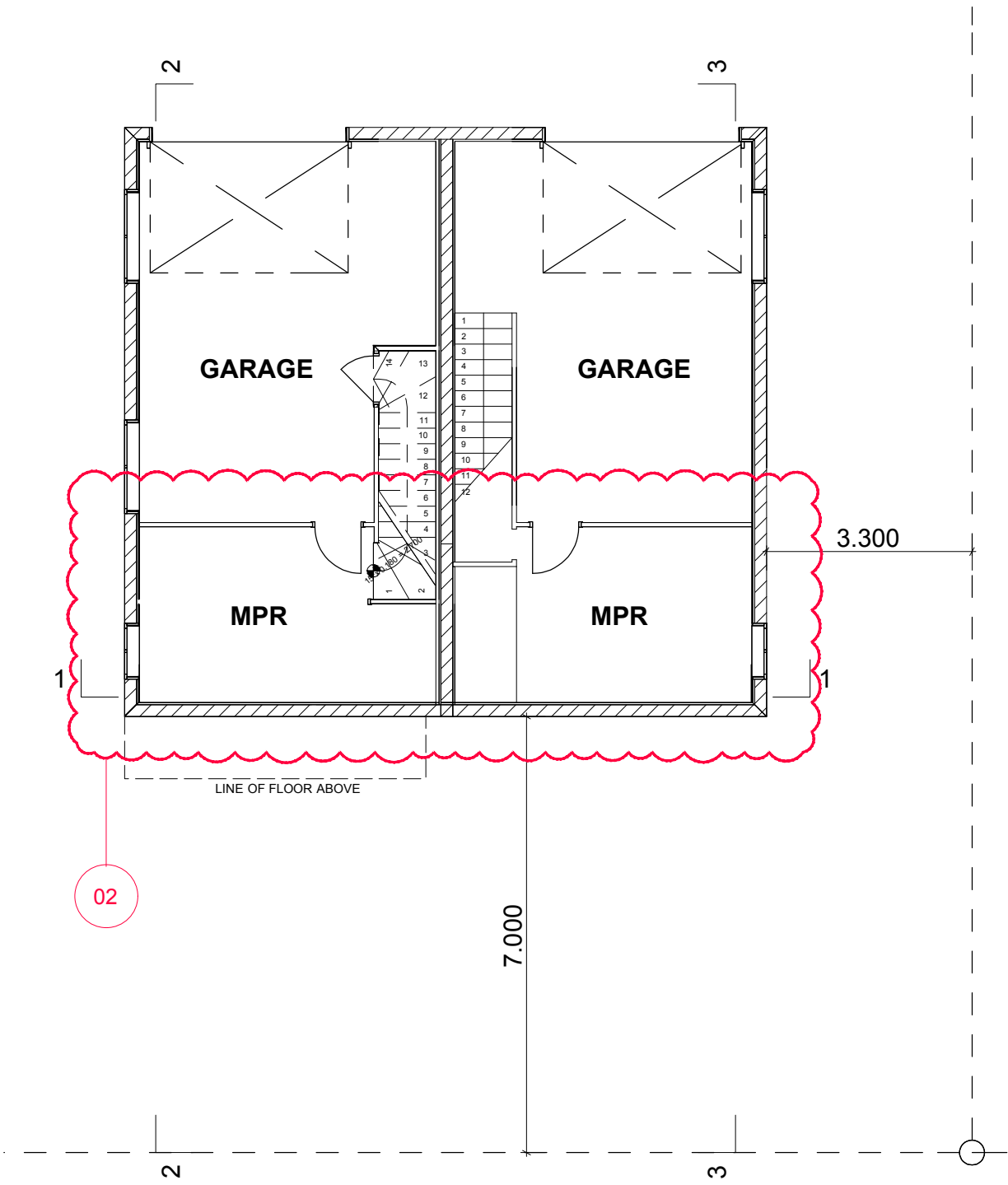

NO CHANGE TO PREVIOUS DA

**PROPOSED NEW 2 X TOWNHOUSE UNITS (2 x MUD)
 & 1 X RENOVATION OF HOUSE (2 x MUD) at**
 15 WILKINS STREET, ANNERLEY QLD 4103

01	17.08.2023	DA ISSUE
02	11.05.2026	REVISIONS TO DA

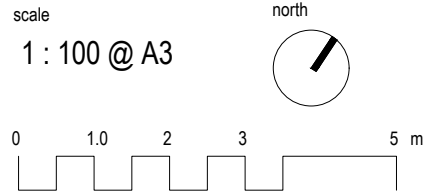

DA ISSUE
MUD A BASEMENT FLOOR PLAN

DA-B-02

17.08.2023 rev. 01

©Copyright SKYCITY DEVELOPMENTS.
 Do not copy any part of this drawing without the prior written consent of the copyright owner.
 Use figured dimensions in preference to scale.
 Check all dimensions on site and report any discrepancies to SKYCITY DEVELOPMENTS.
 Use the building code of Australia as the minimum standard of compliance.

sergestojanovic@gmail.com

BCC DS
RECEIVED
 08/06/2026
APPLICATION REF
 A007043433

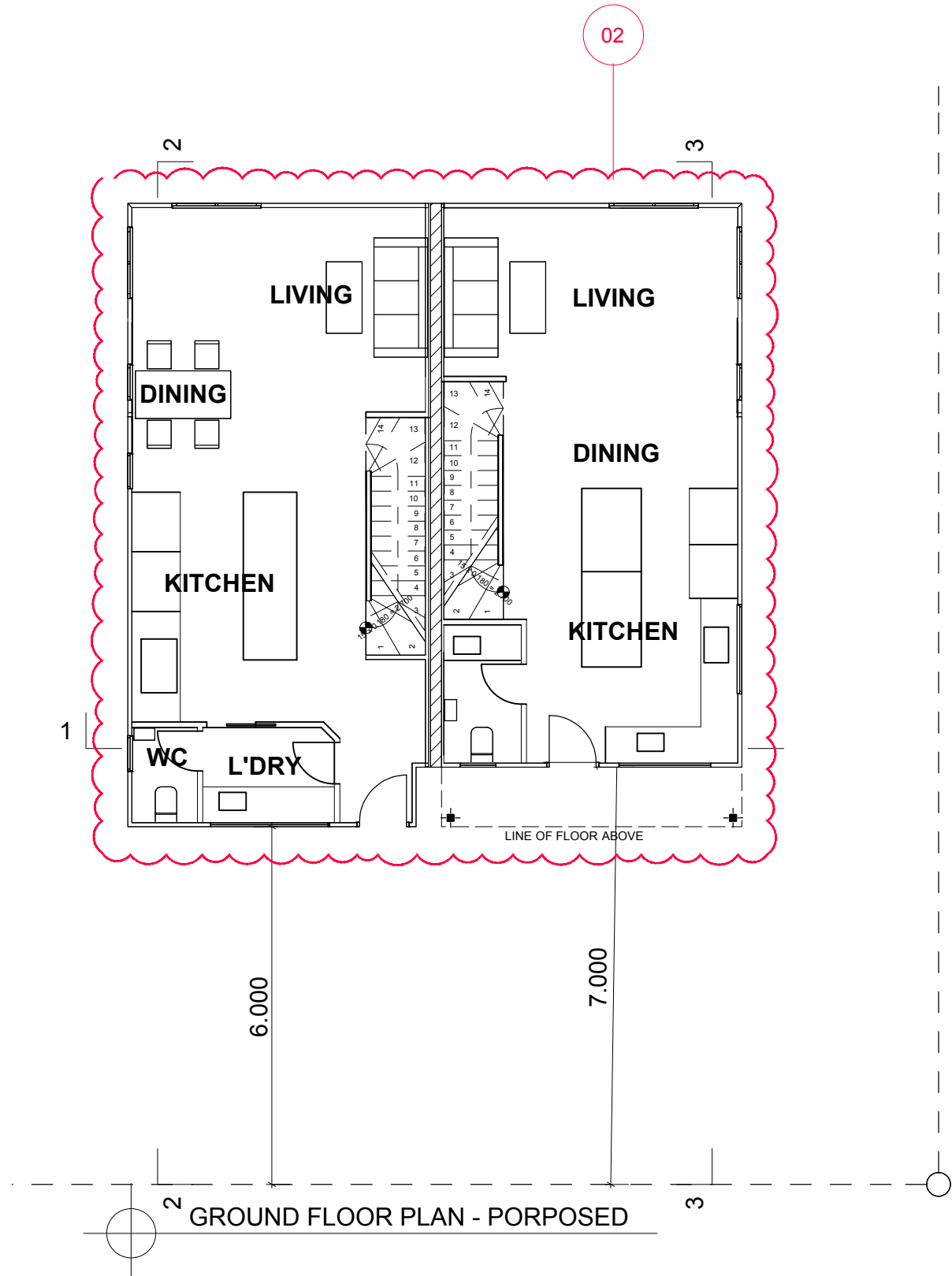

**PROPOSED NEW 2 X TOWNHOUSE UNITS (2 x MUD)
 & 1 X RENOVATION OF HOUSE (2 x MUD) at**
 15 WILKINS STREET, ANNERLEY QLD 4103

01	17.08.2023	DA ISSUE
02	11.05.2026	REVISION TO DA

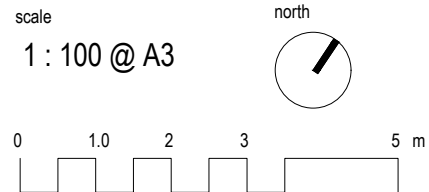

DA ISSUE
**MUD A GROUND FLOOR PLAN -
 PROPOSED**
 DA-B-03
 11.05.2026 rev. 02

©Copyright SKYCITY DEVELOPMENTS.
 Do not copy any part of this drawing without the
 prior written consent of the copyright owner.
 Use figured dimensions in preference to scale.
 Check all dimensions on site and report any
 discrepancies to SKYCITY DEVELOPMENTS.
 Use the building code of Australia as the minimum
 standard of compliance.

sergestojanovic@gmail.com

BCC DS
RECEIVED
 08/06/2026
APPLICATION REF
 A007043433

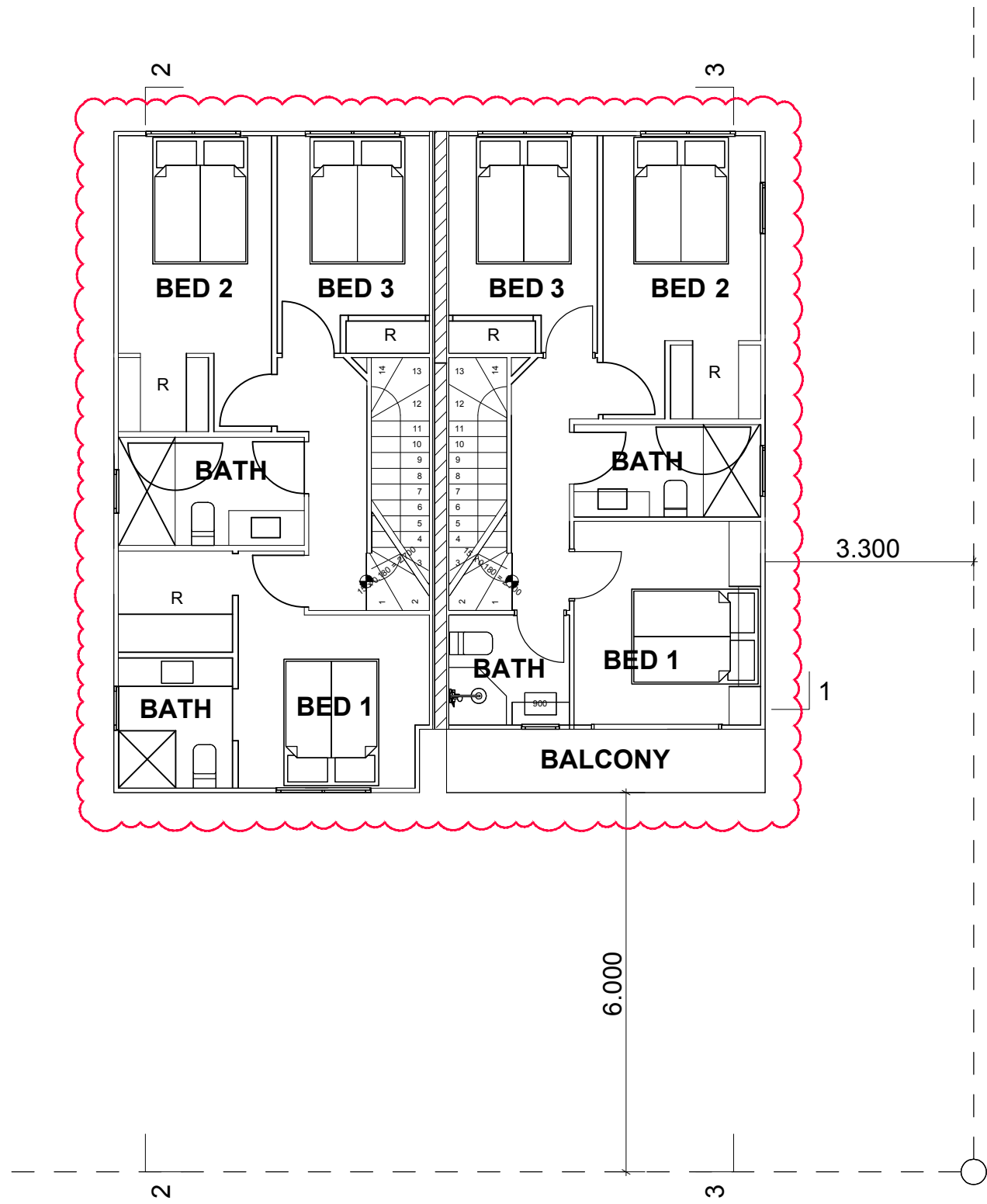

NO CHANGE TO PREVIOUS DA

PROPOSED NEW 2 X TOWNHOUSE UNITS (2 x MUD)
& 1 X RENOVATION OF HOUSE (2 x MUD) at

15 WILKINS STREET, ANNERLEY QLD 4103

01	17.08.2023	DA ISSUE
02	11.05.2026	REVISION TO DA

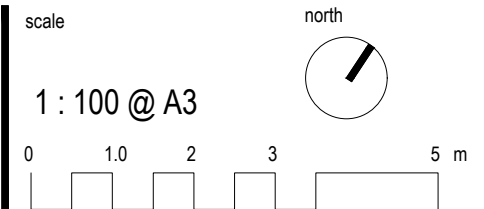

DA ISSUE
MUD A FIRST FLOOR PLAN

DA-B-04

15.05.2026 rev. 02

©Copyright SKYCITY DEVELOPMENTS.
 Do not copy any part of this drawing without the prior written consent of the copyright owner.
 Use figured dimensions in preference to scale.
 Check all dimensions on site and report any discrepancies to SKYCITY DEVELOPMENTS.
 Use the building code of Australia as the minimum standard of compliance.

sergestojanovic@gmail.com

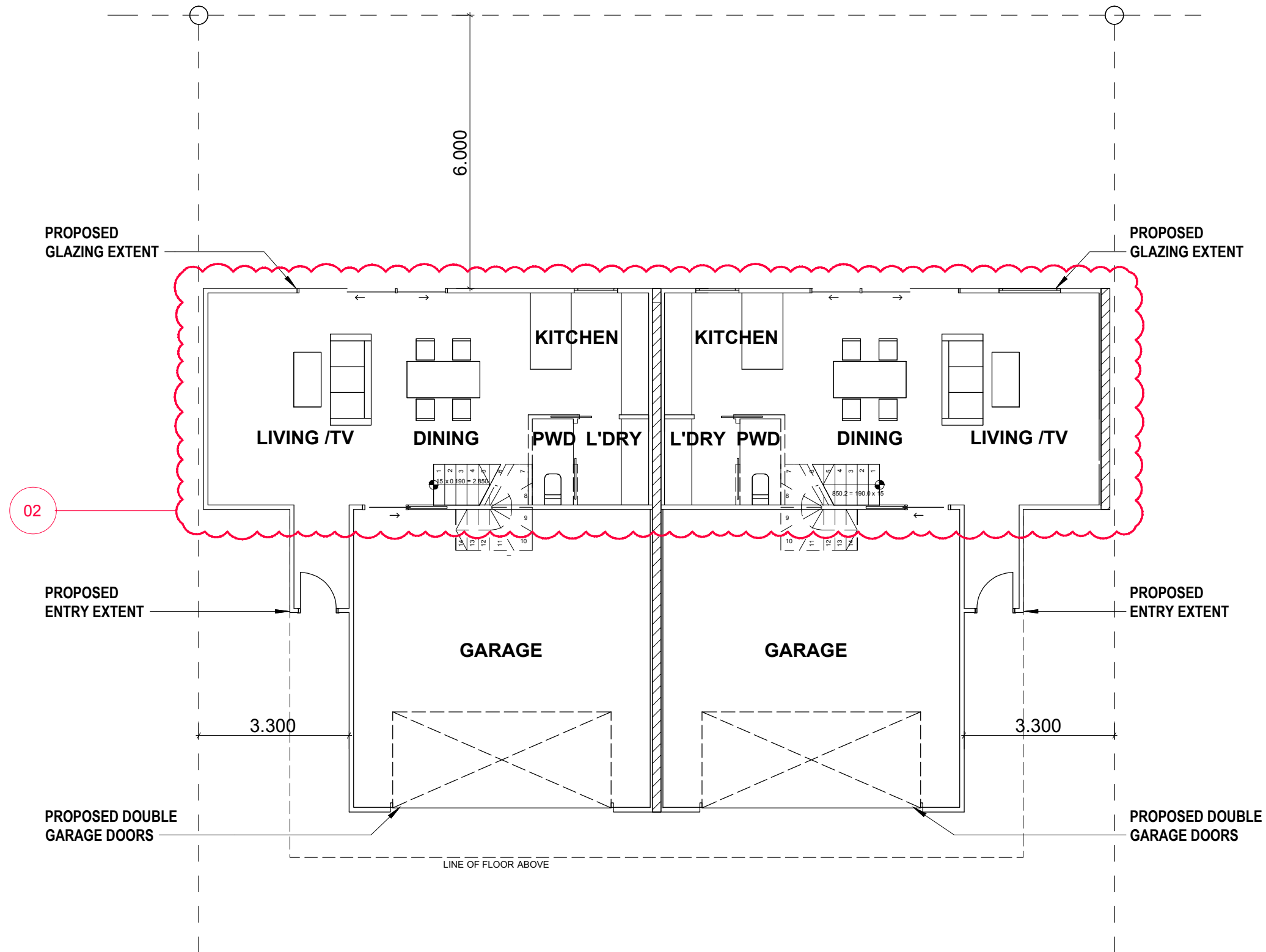

BCC DS
RECEIVED
 08/06/2026
APPLICATION REF
 A007043433

©Copyright SKYCITY DEVELOPMENTS.
 Do not copy any part of this drawing without the prior written consent of the copyright owner.
 Use figured dimensions in preference to scale.
 Check all dimensions on site and report any discrepancies to SKYCITY DEVELOPMENTS.
 Use the building code of Australia as the minimum standard of compliance.

sergestojanovic@gmail.com

PROPOSED NEW 2 X TOWNHOUSE UNITS (2 x MUD)
& 1 X RENOVATION OF HOUSE (2 x MUD) at
 15 WILKINS STREET, ANNERLEY QLD 4103

01	17.08.2023	DA ISSUE
02	11.05.2026	REVISION TO DA

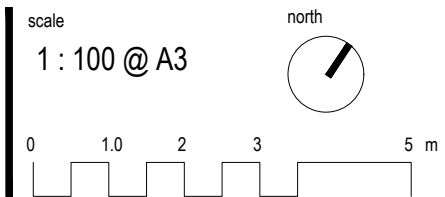

DA ISSUE
MUD B GROUND FLOOR PLAN - PROPOSED
DA-B-06b
 11.05.2026 rev. 02

BCC DS
RECEIVED
 08/06/2026
APPLICATION REF
 A007043433

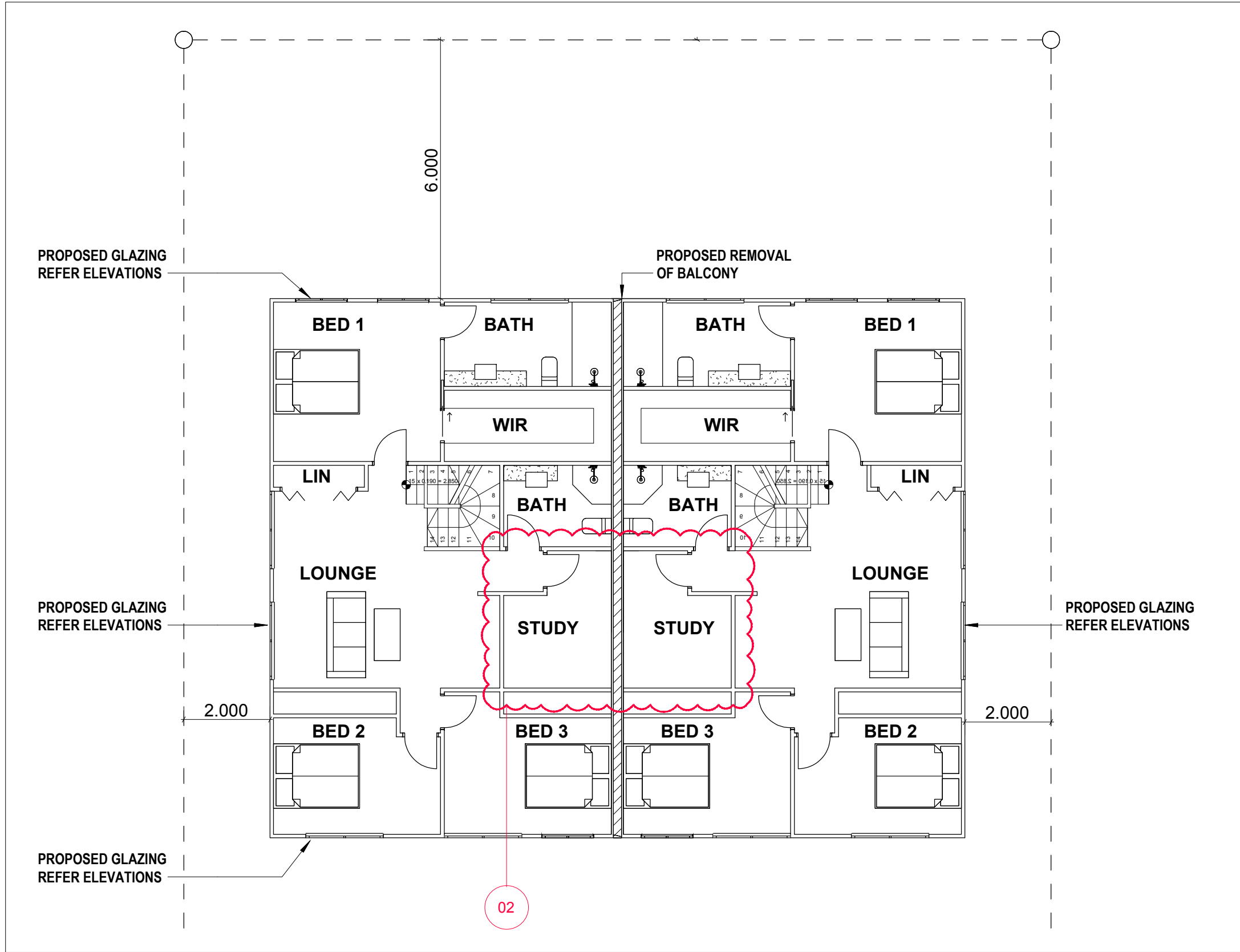

©Copyright SKYCITY DEVELOPMENTS.
 Do not copy any part of this drawing without the prior written consent of the copyright owner.
 Use figured dimensions in preference to scale.
 Check all dimensions on site and report any discrepancies to SKYCITY DEVELOPMENTS.
 Use the building code of Australia as the minimum standard of compliance.

sergestojanovic@gmail.com

**PROPOSED NEW 2 X TOWNHOUSE UNITS (2 x MUD)
 & 1 X RENOVATION OF HOUSE (2 x MUD) at**
 15 WILKINS STREET, ANNERLEY QLD 4103

01	17.08.2023	DA ISSUE
02	11.05.2026	REVISION TO DA

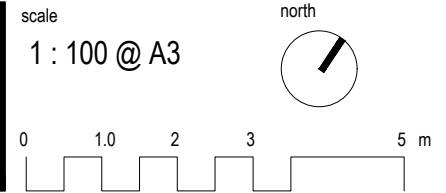

DA ISSUE
**MUD B FIRST FLOOR PLAN -
 PROPOSED**
DA-B-07b
 11.05.2026 rev. 02

BCC DS
RECEIVED
 08/06/2026
APPLICATION REF
 A007043433

PROPOSED
 HIPPED ROOF TO
 REAR & SIDES

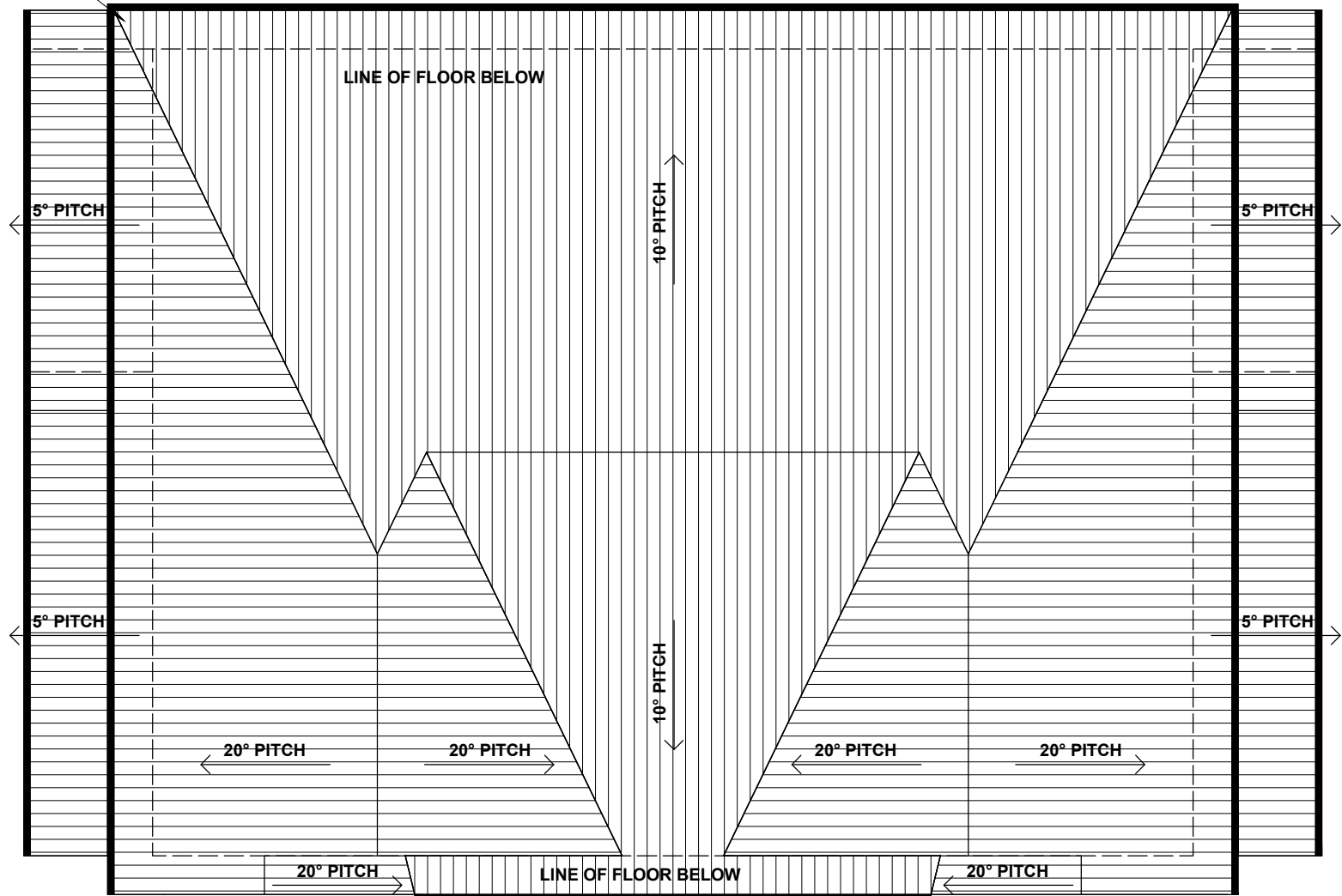

PROPOSED
 STEPPING GABLE ROOF TO FRONTAGE
 TO FOLLOW CHARACTER OF
 EXISTING MUD A ROOF

©Copyright SKYCITY DEVELOPMENTS.
 Do not copy any part of this drawing without the
 prior written consent of the copyright owner.
 Use figured dimensions in preference to scale.
 Check all dimensions on site and report any
 discrepancies to SKYCITY DEVELOPMENTS.
 Use the building code of Australia as the minimum
 standard of compliance.

sergestojanovic@gmail.com

**PROPOSED NEW 2 X TOWNHOUSE UNITS (2 x MUD)
 & 1 X RENOVATION OF HOUSE (2 x MUD) at**

15 WILKINS STREET, ANNERLEY QLD 4103

01	17.08.2023	DA ISSUE
02	11.05.2026	REVISIONS TO DA

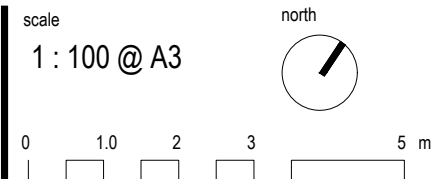

DA ISSUE
MUD B ROOF PLAN - PROPOSED

DA-B-08b

11.05.2026 **rev. 02**

BCC DS

RECEIVED

08/06/2026

APPLICATION REF

A007043433

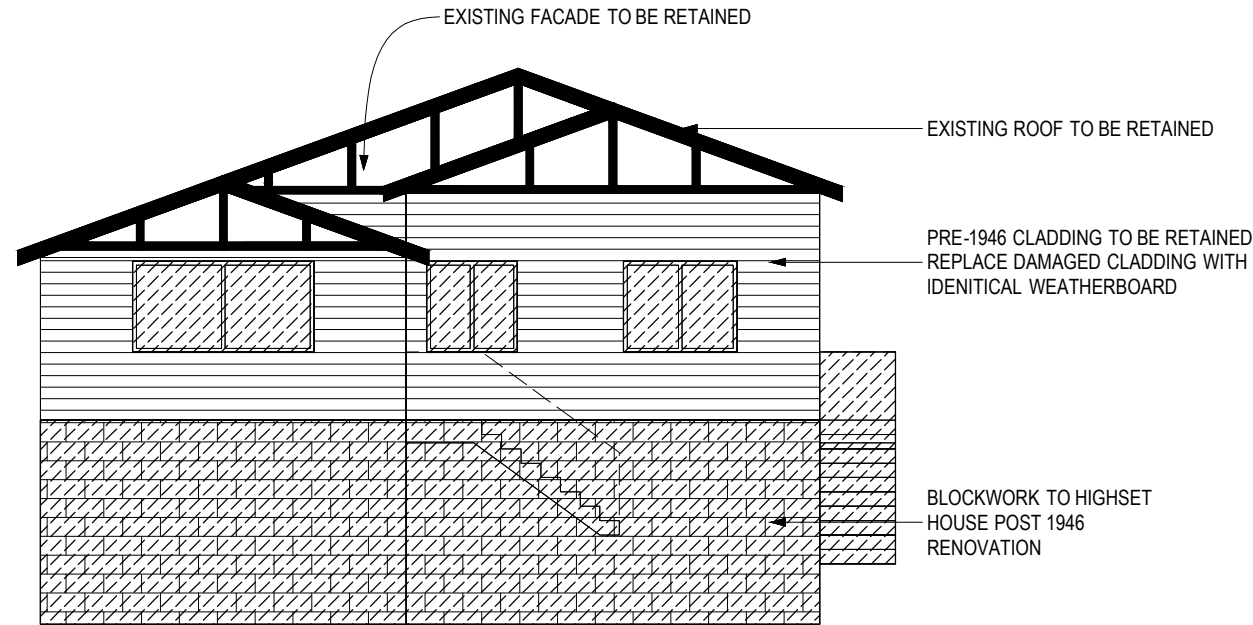

Existing South Elevation



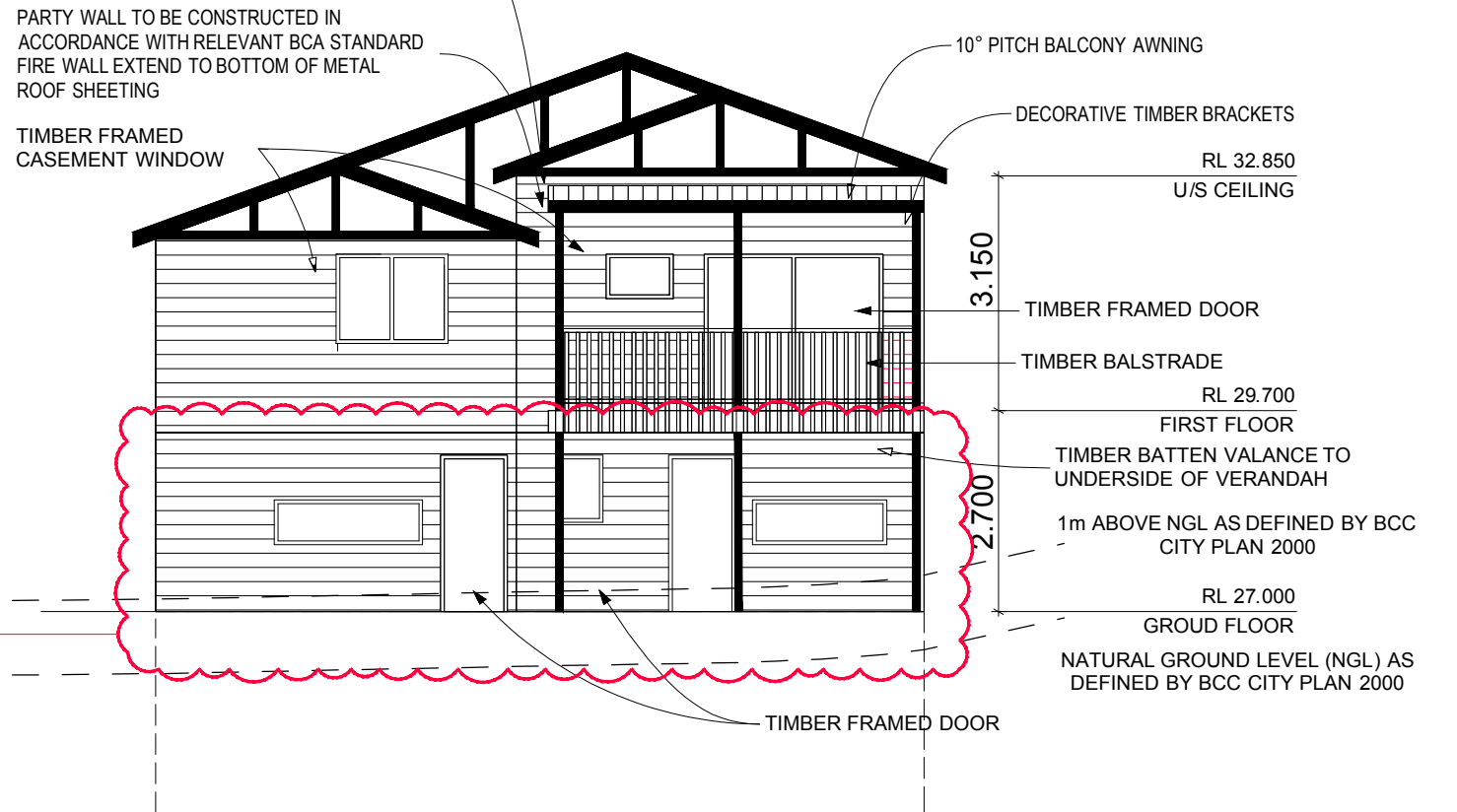

PARTY WALL TO PROTRUDE ON FRONT FACADE TO BE COVERED WITH CLADDING MATCHING THE WALL CLADDING AND TO BE OBSCURED BY VERANDAH POST.

9.5m ABOVE NGL AS DEFINED BY BCC CITY PLAN 2000



MUD A South Elevation

HATCHING DENOTES PROPOSED PARTIAL DEMOLITION

-  R RENDER
-  LB LINEAL BOARDS (e.g. WEATHERBOARD or CHAMFER BOARD)
-  FC1 FC SHEETING WITH VERTICAL GROOVE PATTERN
-  FC2 FC SHEETING WITH COVER BATTENS

©Copyright SKYCITY DEVELOPMENTS.
Do not copy any part of this drawing without the prior written consent of the copyright owner.
Use figured dimensions in preference to scale.
Check all dimensions on site and report any discrepancies to SKYCITY DEVELOPMENTS.
Use the building code of Australia as the minimum standard of compliance.

sergestojanovic@gmail.com

PROPOSED NEW 2 X TOWNHOUSE UNITS (2 x MUD)
& 1 X RENOVATION OF HOUSE (2 x MUD) at

15 WILKINS STREET, ANNERLEY QLD 4103

01 17.08.2023 DA ISSUE
02 11.05.2026 REVISION TO DA

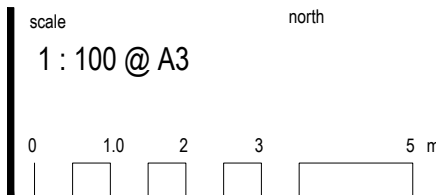

DA ISSUE

MUD A SOUTH ELEVATION
(STREET)

DA-B-09

11.05.2026 rev. 02

BCC DS

RECEIVED

08/06/2026

APPLICATION REF

A007043433

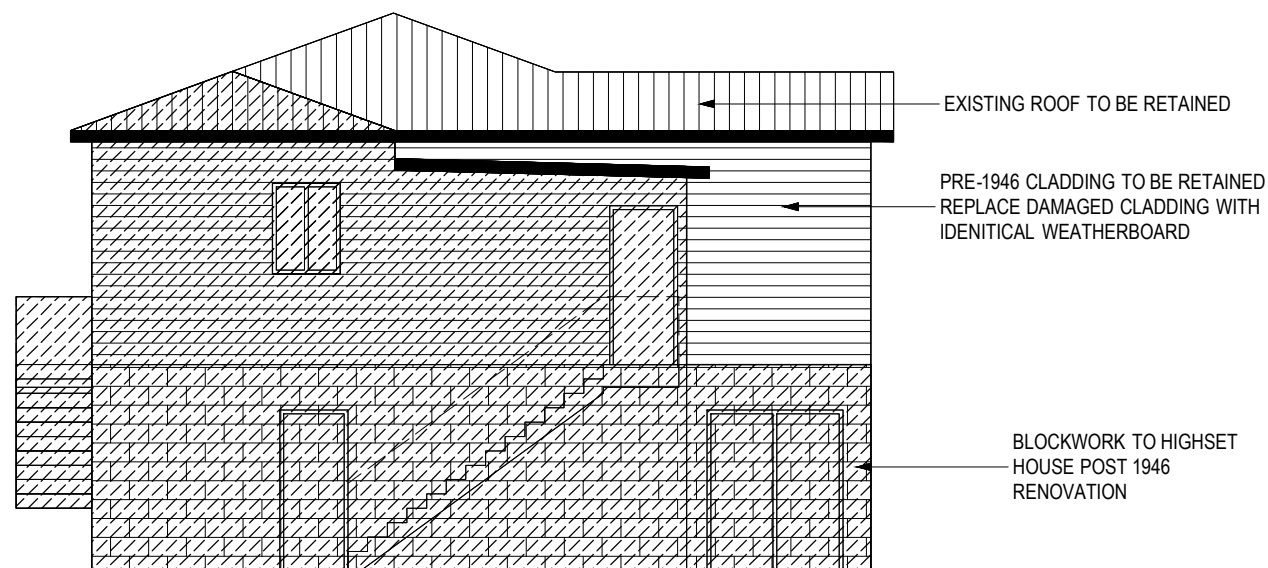



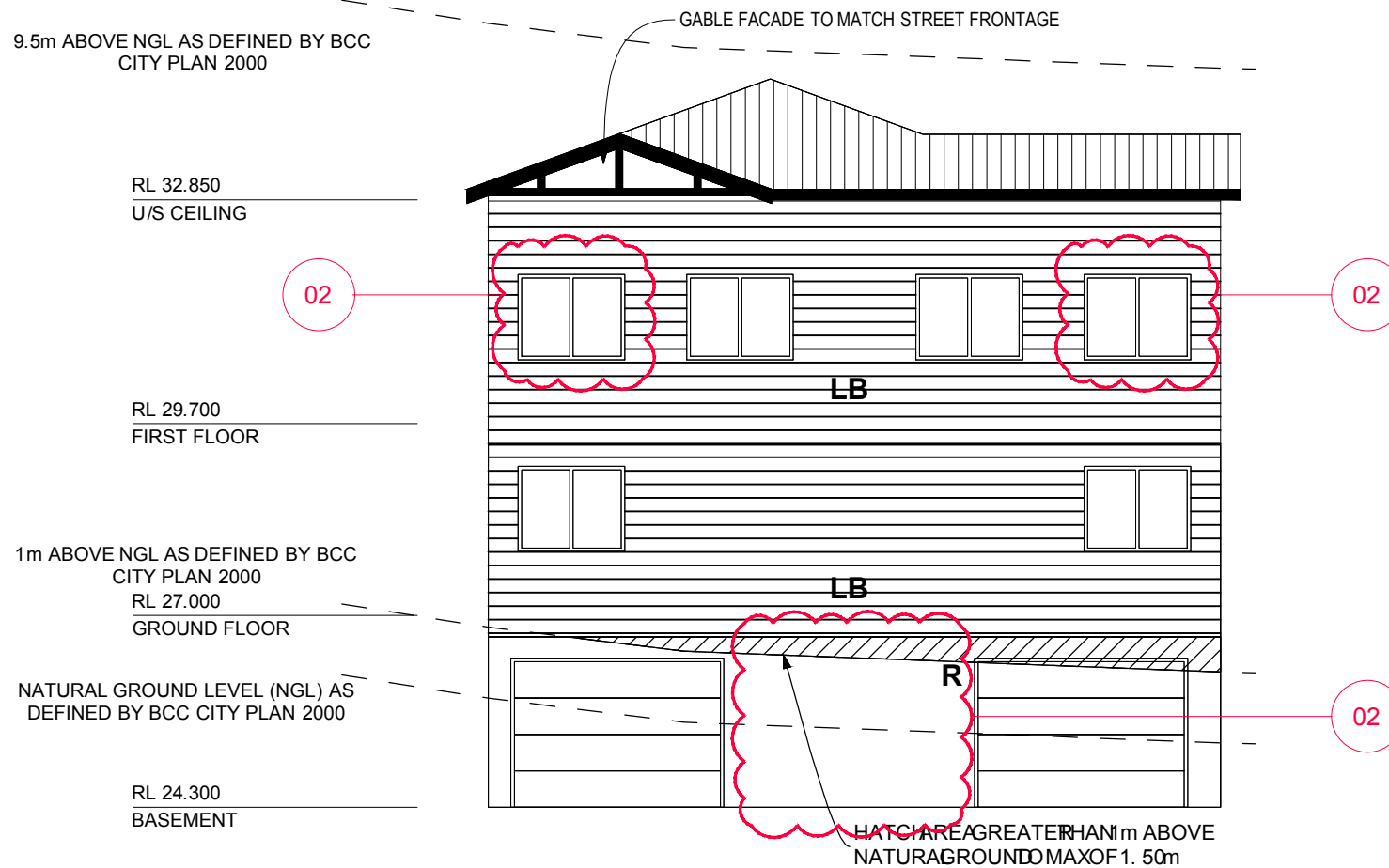

Existing North Elevation

 HATCHING DENOTES PROPOSED PARTIAL DEMOLITION



MUD A North Elevation

-  R RENDER
-  LB LINEAL BOARDS (e.g. WEATHERBOARD or CHAMFER BOARD)
-  FC1 FC SHEETING WITH VERTICAL GROOVE PATTERN
-  FC2 FC SHEETING WITH COVER BATTENS

NO CHANGE TO PREVIOUS DA

PROPOSED NEW 2 X TOWNHOUSE UNITS (2 x MUD)
& 1 X RENOVATION OF HOUSE (2 x MUD) at

15 WILKINS STREET, ANNERLEY QLD 4103

©Copyright SKYCITY DEVELOPMENTS.
Do not copy any part of this drawing without the prior written consent of the copyright owner.
Use figured dimensions in preference to scale.
Check all dimensions on site and report any discrepancies to SKYCITY DEVELOPMENTS.
Use the building code of Australia as the minimum standard of compliance.

sergestojanovic@gmail.com

01 17.08.2023 DA ISSUE
02 11.05.2026 REVISION TO DA

scale north
1 : 100 @ A3

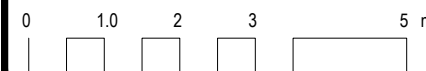

DA ISSUE

MUD A NORTH ELEVATION

DA-B-10

11.05.2026 rev. 02

BCC DS

RECEIVED

08/06/2026

APPLICATION REF

A007043433



Existing East Elevation

9.5m ABOVE NGL AS DEFINED BY BCC CITY PLAN 2000

RL 32.000
U/S CEILING

RL 29.700
SECOND FLOOR

1m ABOVE NGL AS DEFINED BY BCC CITY PLAN 2000

RL 27.000
FIRST FLOOR

NATURAL GROUND LEVEL (NGL) AS DEFINED BY BCC CITY PLAN 2000



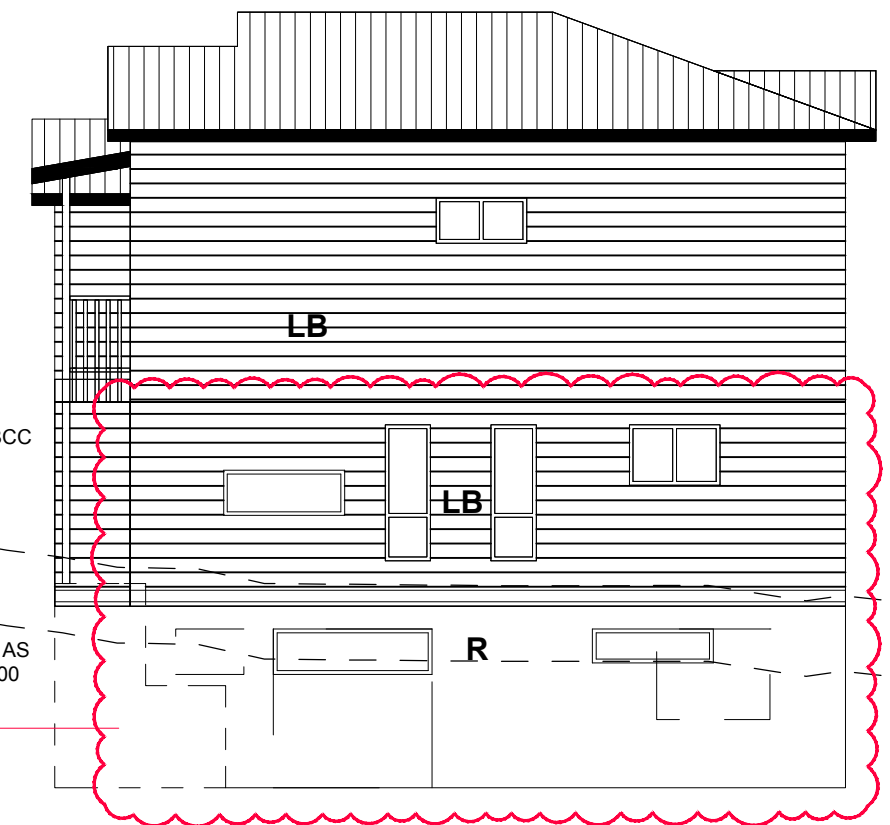

RL 24.300
GROUND FLOOR

02



MUD A East Elevation

HATCHING DENOTES PROPOSED PARTIAL DEMOLITION

-  R RENDER
-  LB LINEAL BOARDS (eg. WEATHERBOARD or CHAMFER BOARD)
-  FC1 FC SHEETING WITH VERTICAL GROOVE PATTERN
-  FC2 FC SHEETING WITH COVER BATTENS

NO CHANGE TO PREVIOUS DA

PROPOSED NEW 2 X TOWNHOUSE UNITS (2 x MUD)
& 1 X RENOVATION OF HOUSE (2 x MUD) at

15 WILKINS STREET, ANNERLEY QLD 4103

sergestojanovic@gmail.com

©Copyright SKYCITY DEVELOPMENTS.
Do not copy any part of this drawing without the prior written consent of the copyright owner.
Use figured dimensions in preference to scale.
Check all dimensions on site and report any discrepancies to SKYCITY DEVELOPMENTS.
Use the building code of Australia as the minimum standard of compliance.

01 17.08.2023 DA ISSUE
02 11.05.2026 REVISION TO DA

scale north

1 : 100 @ A3

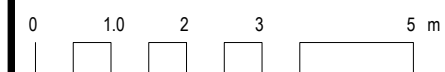

DA ISSUE

MUD A EAST ELEVATION

DA-B-11

11.05.2026 rev. 02

BCC DS

RECEIVED

08/06/2026

APPLICATION REF

A007043433

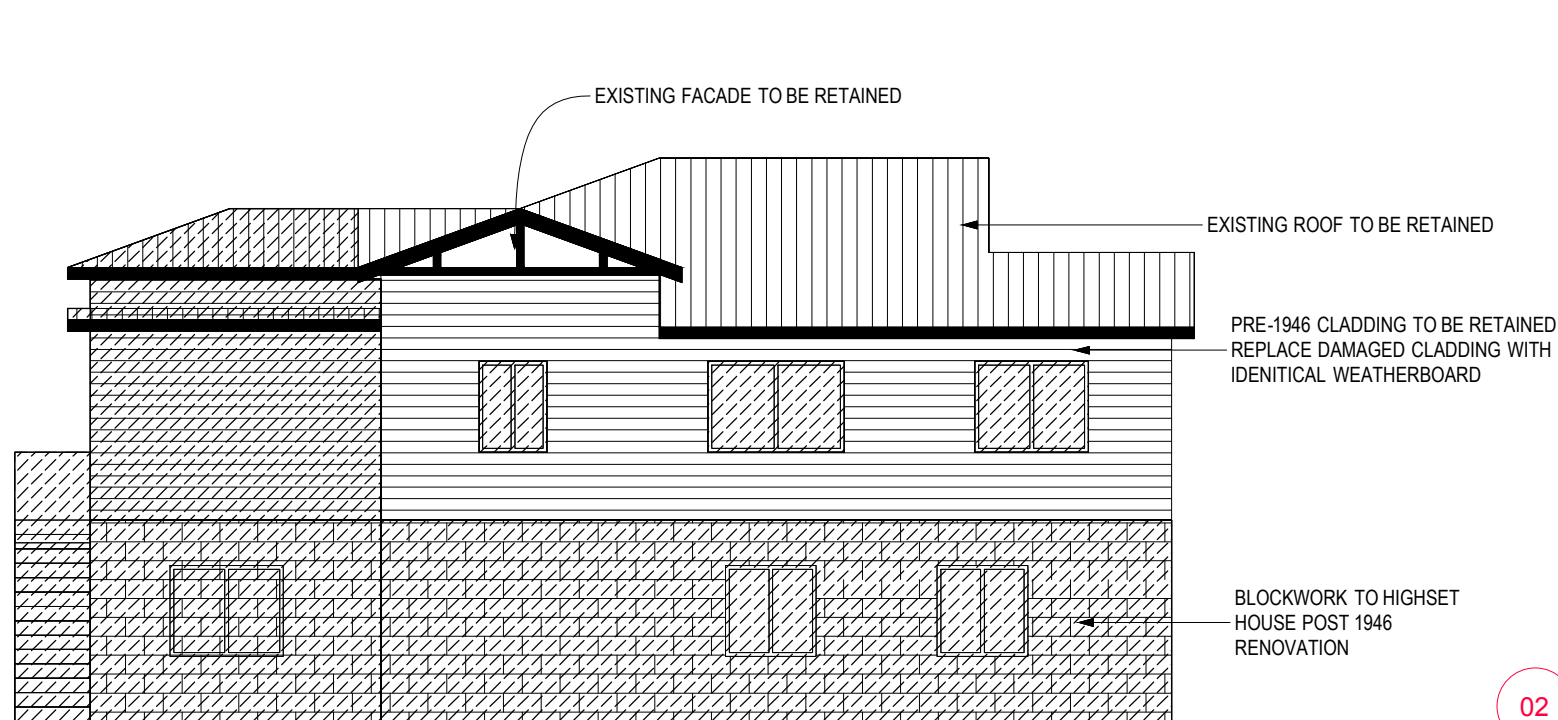



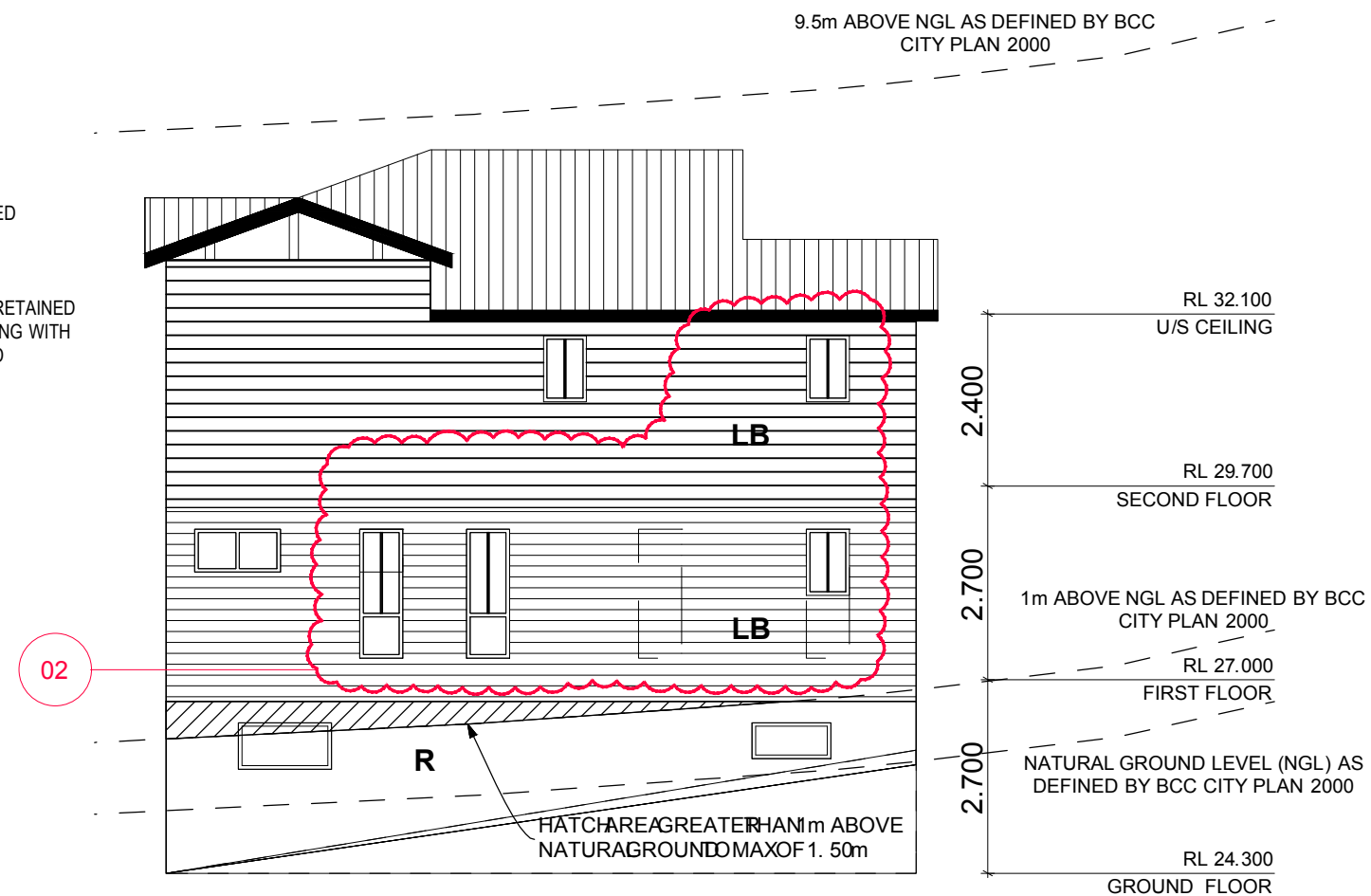

Existing West Elevation



MUD A West Elevation

HATCHING DENOTES PROPOSED PARTIAL DEMOLITION

-  R RENDER
-  LB LINEAL BOARDS (eg. WEATHERBOARD or CHAMFER BOARD)
-  FC1 FC SHEETING WITH VERTICAL GROOVE PATTERN
-  FC2 FC SHEETING WITH COVER BATTENS

NO CHANGE TO PREVIOUS DA

PROPOSED NEW 2 X TOWNHOUSE UNITS (2 x MUD)
& 1 X RENOVATION OF HOUSE (2 x MUD) at

15 WILKINS STREET, ANNERLEY QLD 4103

sergestojanovic@gmail.com

©Copyright SKYCITY DEVELOPMENTS.
Do not copy any part of this drawing without the prior written consent of the copyright owner.
Use figured dimensions in preference to scale.
Check all dimensions on site and report any discrepancies to SKYCITY DEVELOPMENTS.
Use the building code of Australia as the minimum standard of compliance.

01	17.08.2023	DA ISSUE
02	11.05.2026	REVISION TO DA

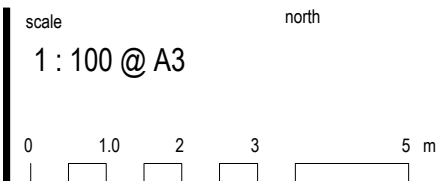

DA ISSUE

MUD A WEST ELEVATION

DA-B-12

11.05.2026 rev. 02

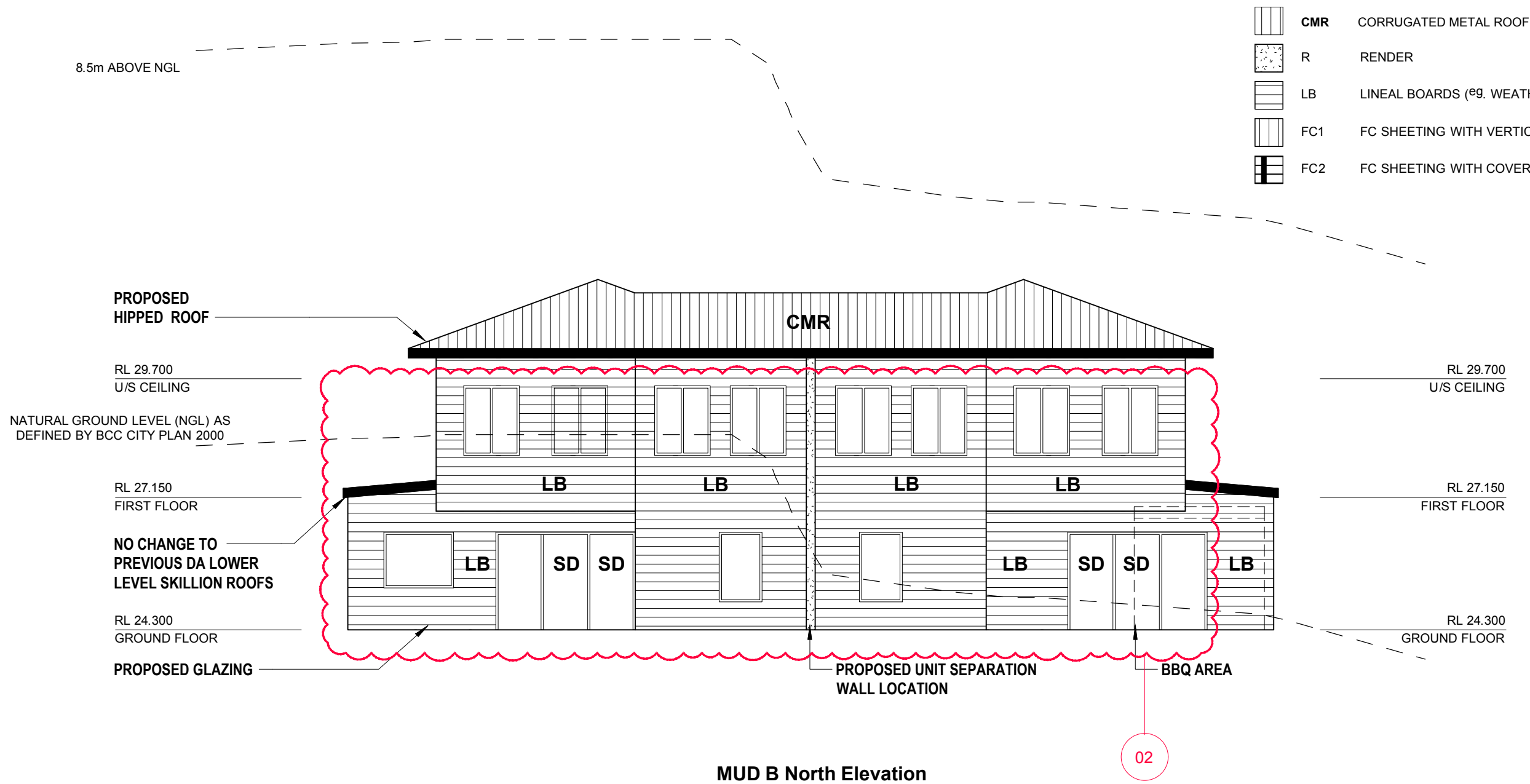

- CMR** CORRUGATED METAL ROOF
- R** RENDER
- LB** LINEAL BOARDS (e.g. WEATHERBOARD or CHAMFER BOARD)
- FC1** FC SHEETING WITH VERTICAL GROOVE PATTERN
- FC2** FC SHEETING WITH COVER BATTENS

©Copyright SKYCITY DEVELOPMENTS.
 Do not copy any part of this drawing without the prior written consent of the copyright owner.
 Use figured dimensions in preference to scale.
 Check all dimensions on site and report any discrepancies to SKYCITY DEVELOPMENTS.
 Use the building code of Australia as the minimum standard of compliance.



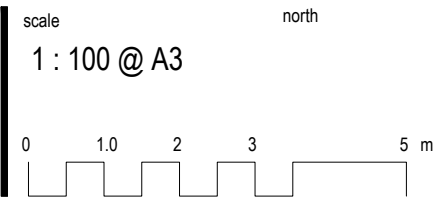

sergestojanovic@gmail.com

**PROPOSED NEW 2 X TOWNHOUSE UNITS (2 x MUD)
 & 1 X RENOVATION OF HOUSE (2 x MUD) at**
 15 WILKINS STREET, ANNERLEY QLD 4103

01	17.08.2023	DA ISSUE
02	11.05.2026	REVISION TO DA



DA ISSUE
**MUD B NORTH ELEVATION -
 PROPOSED**
DA-B-13b
 17.08.2023 rev. 01

-  **CMR** CORRUGATED METAL ROOF
-  **R** RENDER
-  **LB** LINEAL BOARDS (eg. WEATHERBOARD or CHAMFER BOARD)
-  **FC1** FC SHEETING WITH VERTICAL GROOVE PATTERN
-  **FC2** FC SHEETING WITH COVER BATTENS

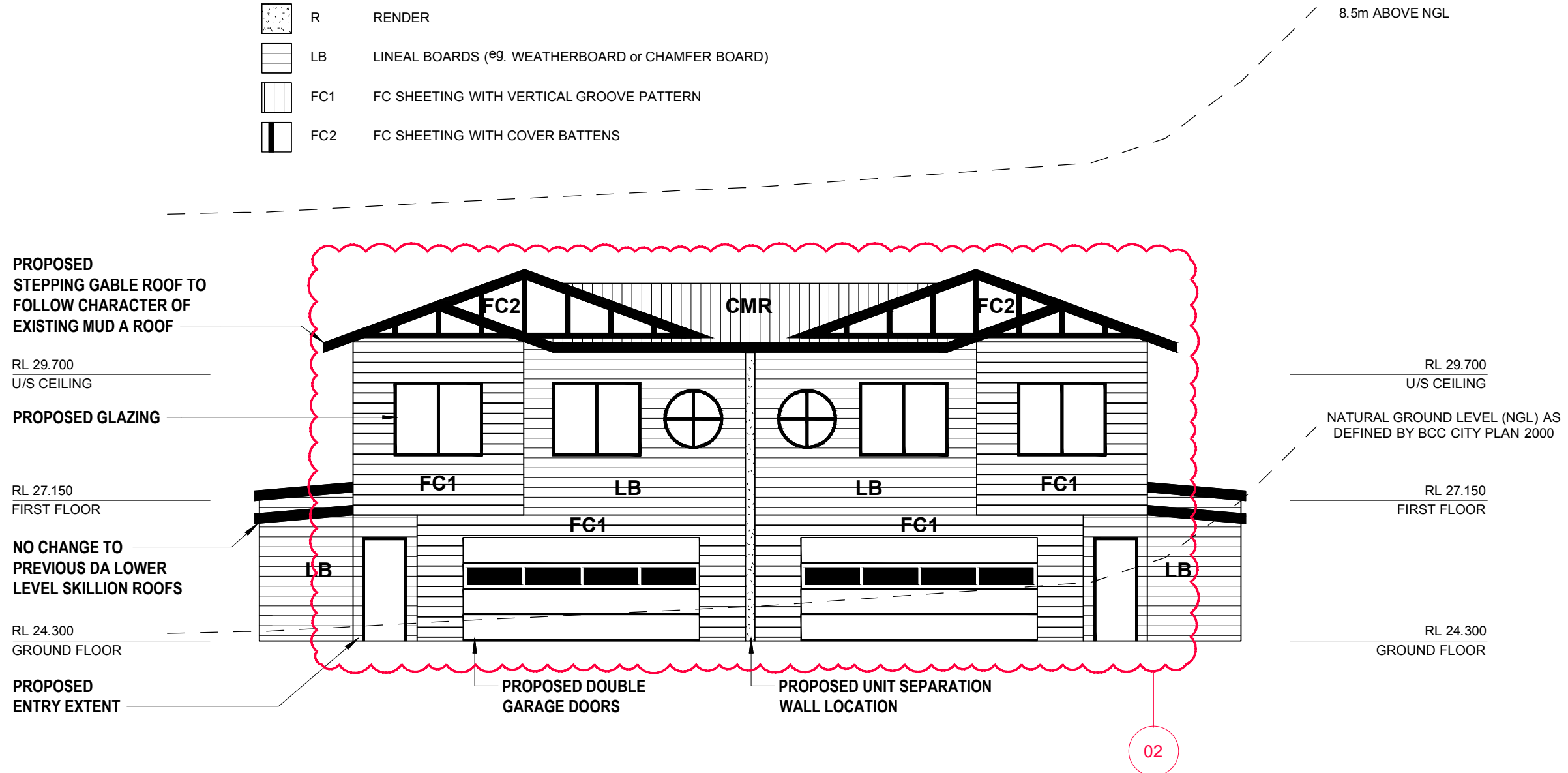

MUD B South Elevation

©Copyright SKYCITY DEVELOPMENTS.
 Do not copy any part of this drawing without the prior written consent of the copyright owner.
 Use figured dimensions in preference to scale.
 Check all dimensions on site and report any discrepancies to SKYCITY DEVELOPMENTS.
 Use the building code of Australia as the minimum standard of compliance.

sergestojanovic@gmail.com

PROPOSED NEW 2 X TOWNHOUSE UNITS (2 x MUD) & 1 X RENOVATION OF HOUSE (2 x MUD) at
 15 WILKINS STREET, ANNERLEY QLD 4103

01	17.08.2023	DA ISSUE
02	11.05.2026	REVISION TO DA

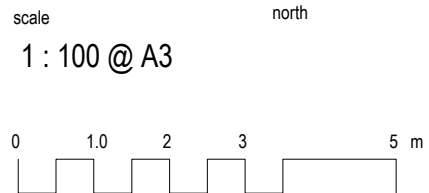

DA ISSUE
MUD B SOUTH ELEVATION - PROPOSED
DA-B-14b
 11.05.2026 rev. 02

**BCC DS
RECEIVED**
08/06/2026
APPLICATION REF
A007043433

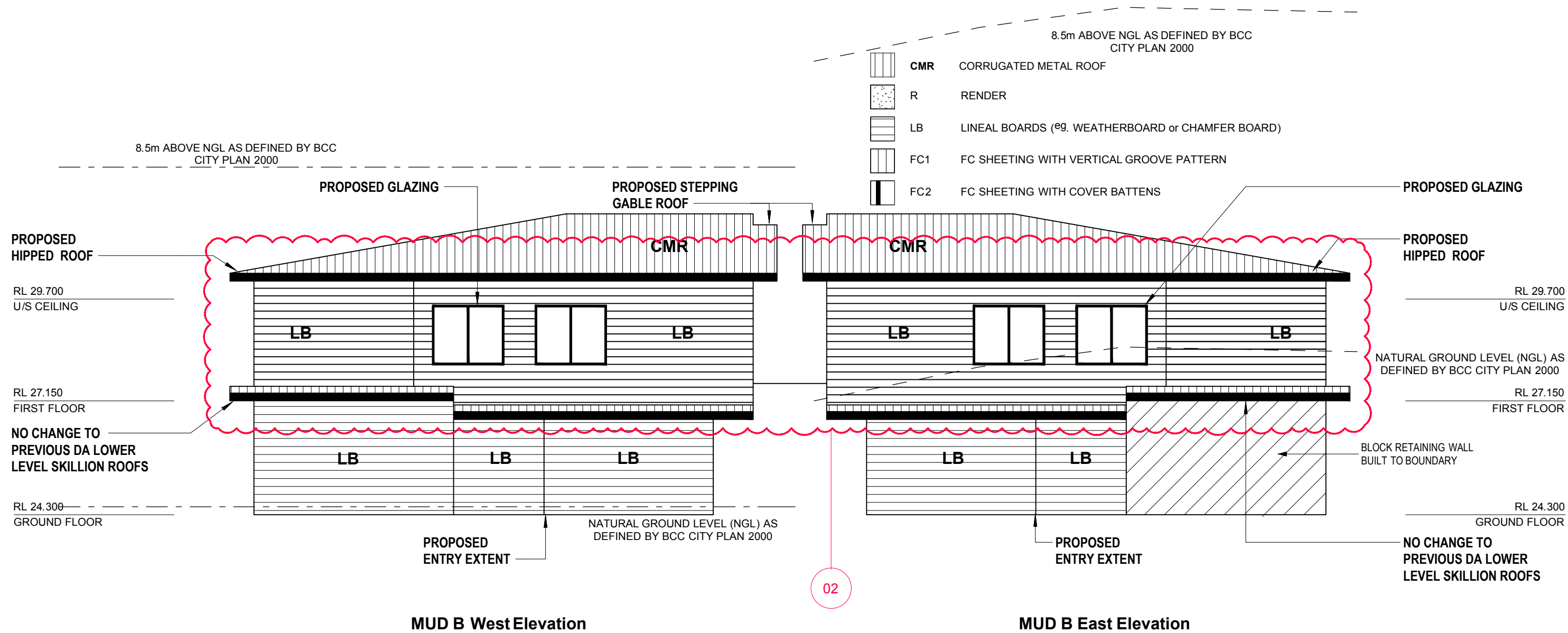

©Copyright SKYCITY DEVELOPMENTS.
Do not copy any part of this drawing without the prior written consent of the copyright owner.
Use figured dimensions in preference to scale.
Check all dimensions on site and report any discrepancies to SKYCITY DEVELOPMENTS.
Use the building code of Australia as the minimum standard of compliance.

sergestojanovic@gmail.com

**PROPOSED NEW 2 X TOWNHOUSE UNITS (2 x MUD)
& 1 X RENOVATION OF HOUSE (2 x MUD) at**
15 WILKINS STREET, ANNERLEY QLD 4103

01 17.08.2023 DA ISSUE
02 11.05.2026 REVISION TO DA

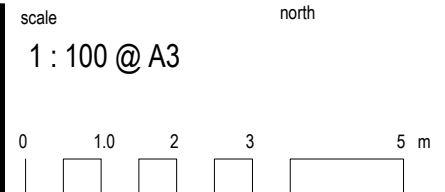

DA ISSUE
MUD B EAST & WEST ELEVATION - PROPOSED
DA-B-15b
11.05.2026 **rev. 02**