



Department of Environment and Science (DES)  
ABN 46 640 294 485  
400 George St Brisbane, Queensland 4000  
GPO Box 2454 Brisbane QLD 4001 AUSTRALIA  
www.des.qld.gov.au

**BCC DS**  
**LODGED**  
11/04/2025  
**APPLICATION REF**  
A006752110

**SEARCH RESPONSE**  
**ENVIRONMENTAL MANAGEMENT REGISTER (EMR)**  
**CONTAMINATED LAND REGISTER (CLR)**

Transaction ID: 50759319    EMR Site Id: 2348    18 February 2022  
This response relates to a search request received for the site:  
Lot: 6    Plan: RP201432

**EMR RESULT**

The above site **IS** included on the Environmental Management Register.

Lot: 6    Plan: RP201432  
Address: 82 COLMSLIE RD  
MORNINGSIDE 4170

The site has been subject to the following Notifiable Activity or Hazardous Contaminant.

**PETROLEUM PRODUCT OR OIL STORAGE** - storing petroleum products or oil -

(a) in underground tanks with more than 200L capacity; or

(b) in above ground tanks with -

(i) for petroleum products or oil in class 3 in packaging groups 1 and 2 of the dangerous goods code - more than 2, 500L capacity; or

(ii) for petroleum products or oil in class 3 in packaging groups 3 of the dangerous goods code - more than 5, 000L capacity; or

(iii) for petroleum products that are combustible liquids in class C1 or C2 in Australian Standard AS1940, 'The storage and handling of flammable and combustible liquids' published by Standards Australia - more than 25, 000L capacity.

**CLR RESULT**

The above site is **NOT** included on the Contaminated Land Register.

**ADDITIONAL ADVICE**

All search responses include particulars of land listed in the EMR/CLR when the search was generated.

The EMR/CLR does **NOT** include:-

1. land which is contaminated land (or a complete list of contamination) if DES has not been notified
2. land on which a notifiable activity is being or has been undertaken (or a complete list of activities) if DES has not been notified

If you have any queries in relation to this search please phone 13QGOV (13 74 68)

**Administering Authority**

Queensland Titles Registry Pty Ltd  
 ABN 23 648 568 101

|                            |                 |                     |                  |
|----------------------------|-----------------|---------------------|------------------|
| <b>Title Reference:</b>    | <b>17149016</b> | <b>Search Date:</b> | 18/02/2022 11:50 |
| <b>Date Title Created:</b> | 30/05/1988      | <b>Request No:</b>  | 40193649         |
| <b>Previous Title:</b>     | 17062107        |                     |                  |

### ESTATE AND LAND

Estate in Fee Simple

LOT 6 REGISTERED PLAN 201432  
 Local Government: BRISBANE CITY

### REGISTERED OWNER

Dealing No: 718781566 31/05/2018  
 DUNHILL PROPERTIES PTY LTD A.C.N. 602 466 339

### EASEMENTS, ENCUMBRANCES AND INTERESTS

- Rights and interests reserved to the Crown by Deed of Grant No. 19555096 (ALLOT 22)
- EASEMENT No 601278553 (E39859) 28/05/1971  
 BENEFITING PART OF THE LAND  
 OVER EASEMENTS A, B AND C ON RP124832
- EASEMENT No 601278554 (E39860) 28/05/1971  
 BENEFITING PART OF THE LAND  
 OVER EASEMENT D ON RP124832 AND EASEMENT H ON RP126491
- EASEMENT No 601278555 (E39861) 28/05/1971  
 BENEFITING PART OF THE LAND  
 OVER EASEMENTS E, F, G AND J ON RP124832
- EASEMENT No 601679948 (K979898W) 23/03/1992  
 BURDENING THE LAND  
 TO LOT 634 ON CP SL5396  
 OVER EASEMENT R ON RP814453
- LEASE No 713352596 15/07/2010 at 11:20  
 HANS CONTINENTAL SMALLGOODS PTY LTD A.C.N. 135 806 683  
 OF THE WHOLE OF THE LAND  
 TERM: 30/03/2009 TO 29/03/2019 OPTION 10 YEARS
- AMENDMENT OF LEASE No 713352599 15/07/2010 at 11:20  
 LEASE: 713352596  
 TERM: 30/03/2009 TO 29/03/2019 OPTION 10 YEARS
- AMENDMENT OF LEASE No 714162058 15/11/2011 at 11:19  
 LEASE: 713352596  
 TERM: 30/03/2009 TO 29/03/2019 OPTION 10 YEARS
- MORTGAGE No 718781567 31/05/2018 at 16:20  
 NATIONAL AUSTRALIA BANK LIMITED A.C.N. 004 044 937

### ADMINISTRATIVE ADVICES

| Dealing   | Type   | Lodgement Date   | Status  |
|-----------|--|------------------|---------|
| 711134342 | HERITGE SITE<br>QUEENSLAND HERITAGE ACT 1992 | 30/10/2007 14:16 | CURRENT |

### UNREGISTERED DEALINGS

NIL

Caution - Charges do not necessarily appear in order of priority

\*\* End of Current Title Search \*\*

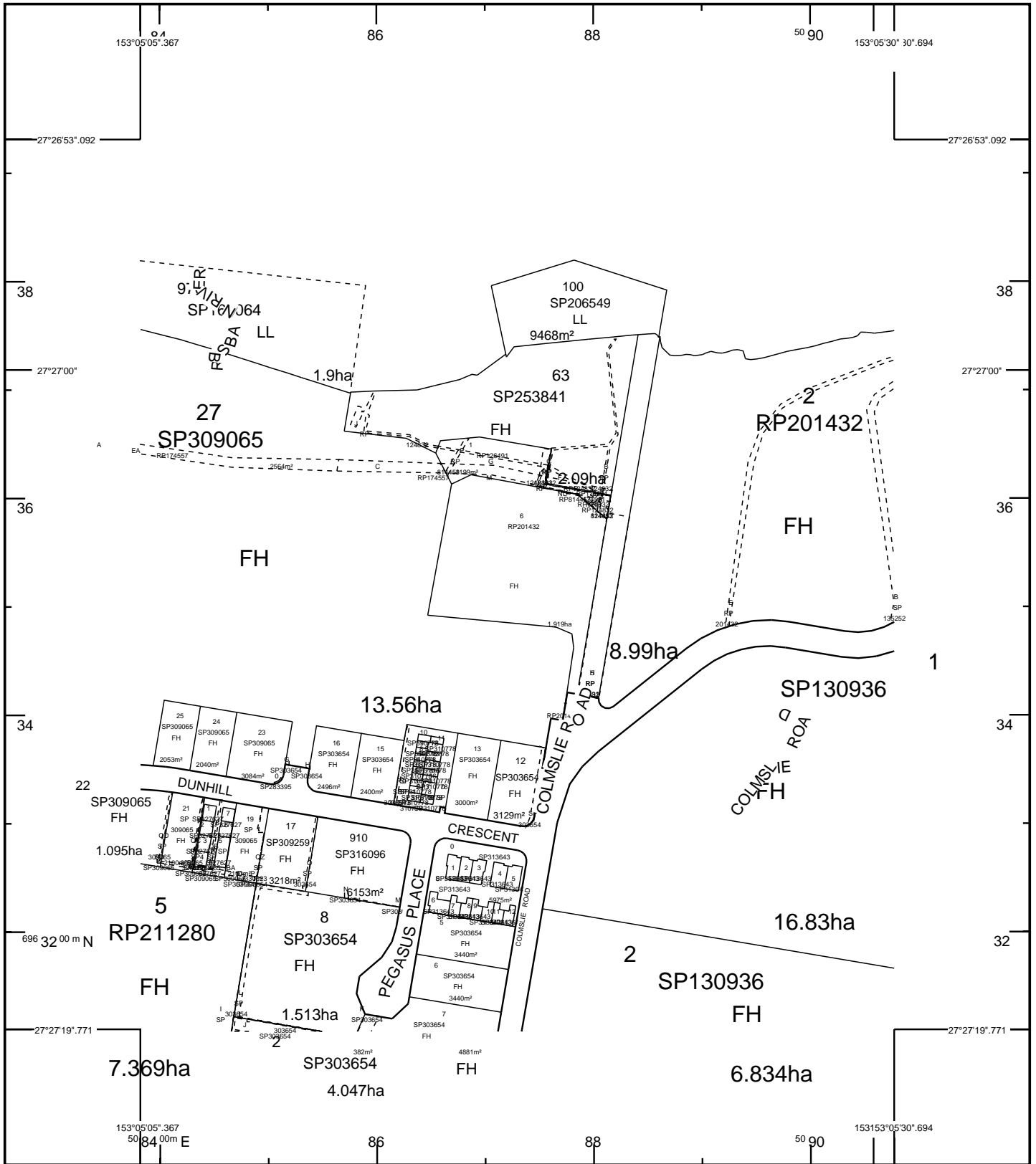

STANDARD MAP NUMBER  
9543-33241

HORIZONTAL DATUM:GDA94 ZONE:56 SCALE 1 : 5000

**SmartMap**

MAP WINDOW POSITION & NEAREST LOCATION

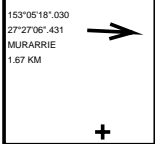

**SUBJECT PARCEL DESCRIPTION**

|                  |               |
|------------------|---------------|
| DCDB             | 6/RP201432    |
| Lot/Plan         | 1.919ha       |
| Area/Volume      | FREEHOLD      |
| Tenure           | BRISBANE CITY |
| Local Government | MORNINGSIDE   |
| Locality         | 18516/14      |
| Segment/Parcel   |               |

**CLIENT SERVICE STANDARDS**

PRINTED 28/03/2025

DCDB 27/03/2025

Users of the information recorded in this document (the Information) accept all responsibility and risk associated with the use of the Information and should seek independent professional advice in relation to dealings with property.

An External Product of SmartMap Information Services  
Based upon an extraction from the Digital Cadastral Data Base



Queensland Government  
(c) The State of Queensland, (Department of Resources) 2025.



Despite Department of Resources best efforts, RESOURCES makes no representations or warranties in relation to the Information, and, to the extent permitted by law, exclude or limit all warranties relating to correctness, accuracy, reliability, completeness or currency and all liability for any direct, indirect and consequential costs, losses, damages and expenses incurred in any way (including but not limited to that arising from negligence) in connection with any use of or reliance on the Information

For further information on SmartMap products visit <https://www.qld.gov.au/housing/buying-owning-home/property-land-valuations/smartmaps>