

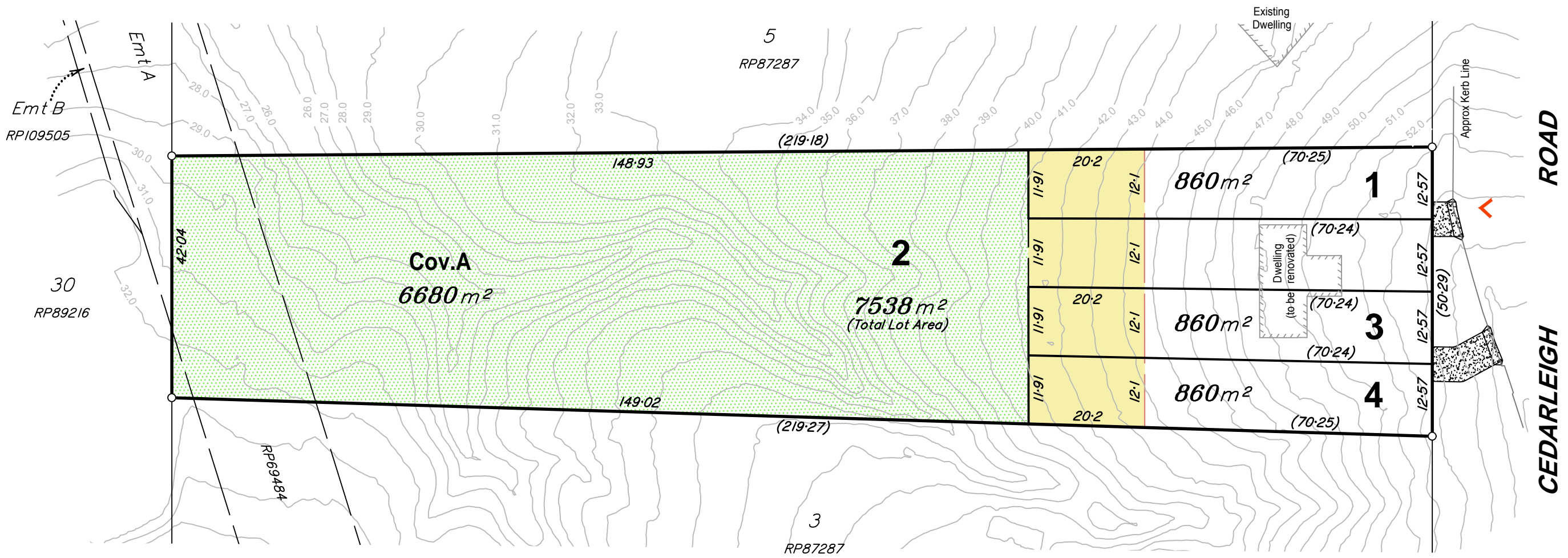



BCC DS
RECEIVED
 06/05/2026
APPLICATION REF
 A006934926



NOTES:
 1. Existing structures shown have been plotted approximately only from BCC Cityplan.
 2. Contours shown have been plotted approximately only from ICSM Elvis Spatial Data.

LEGEND

	Bushfire Management Zone (20.2m wide)		Existing Driveway Crossover
	Proposed Driveway Locations (6m wide)		Environmental Protection Zone

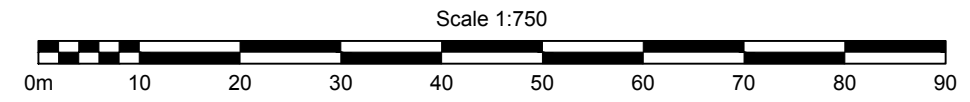

PROPOSED RECONFIGURATION PLAN

LOCATION: 23 Cedarleigh Road, Kenmore

REAL PROPERTY DESCRIPTION:
 Lot 4 on RP87287

CLIENT: Dr Hesam Darouei

Rev	Description	Drawn	Checked	Date
C	Amend Layout	SSDIG	JN	26/03/2026
B	Amend Layout	SSDIG	JN	17/09/2025
A	Original Issue	SSDIG	JN	17/03/2025

Drawing No: JN100-SMJ-43	Scale: 1:750 @ A3
Sheet: 1 of 1	Drawn: SSDIG
Revision: C	Surveyor: N/A

Horiz. Datum: N/A	Contour Interval: 1.0m
Vert. Datum: N/A	
Local Authority: Brisbane City	

This plan was prepared as a proposed plan and should not be used for any other purpose. The dimensions, areas and total number of lots shown hereon are subject to field survey and also to the requirements of Council and any other authority which may have requirements under any relevant legislation. In particular, no reliance should be placed on the information on this plan for any financial dealing involving the land. This note is an integral part of the plan.