

LEGEND

- SW— NEW STORMWATER LINE & CHAMBER
- S— EXISTING STORMWATER LINE & CHAMBER
- >>>> NEW SWALE DRAIN
- S—S— NEW SEWER LINE & MANHOLE
- S—S— EXISTING SEWER LINE & MANHOLE
- W—W— NEW WATER LINE & VALVE
- ⊠ NEW WATER METER
- FH NEW FIRE HYDRANT
- FH EXISTING FIRE HYDRANT
- W—W— EXISTING WATER LINE
- — — — CADASTRAL BOUNDARY
- ▨ NEW RETAINING WALL
- ▨ NEW STORMWATER SWALE
- ▨ EASEMENT (EXISTING)
- — — — EXISTING FENCE LINE
- CD—CD— EXISTING COMBINE DRAIN
- T— EXISTING TELSTRA
- OF—OF— EXISTING OPTIC FIBRE
- G—G— EXISTING GAS
- OH—OH— EXISTING O/H ELECTRICITY
- E—E— EXISTING U/G ELECTRICITY
- ▨ EXISTING CONCRETE
- ▨ EXISTING CONCRETE
- — — — EXISTING BUILDING LINE
- — — — EXISTING BUILDING ROOF
- 10.00— FINISHED FINAL LEVEL CONTOURS
- ▨ EXISTING CONTOURS
- ▨ FINISHED FINAL LEVEL
- ▨ AREA OF FILL
- ▨ AREA OF CUT
- SE— SEDIMENT FENCE
- SEP STABILISED ENTRY/EXIT POINT
- ⊕ MSI WATER QUALITY MONITORING STATION
- DSP DRAINAGE STRUCTURE PROTECTION
- ▨ PROPOSED NEW BCC SW EMT
- ▨ REFUSE BIN PAD

- EARTHWORKS NOTES**
- CONTOURS SHOWN AT 250mm INTERVALS.
 - EARTHWORKS TO BE DONE IN ACCORDANCE WITH THE REQUIREMENTS OF AS3798-2007.
 - CONSTRUCTION AREA TO BE STRIPPED OF ALL GRASS, SHRUBS, RUBBISH, DELETERIOUS MATERIALS AS INSTRUCTED BY THE ENGINEER. STRIPPED MATERIAL TO BE REMOVED OFF SITE.
 - THE AREA SHOULD BE STRIPPED OF 150mm (TOPSOIL) UNCONTROLLED FILL, SOFT, OVERLY WET, FOREIGN OR OTHERWISE DEEMED UNSUITABLE MATERIAL (MATERIAL THAT IS POTENTIALLY COMPRESSIBLE) DOWN TO A RELATIVELY STIFF DRY BASE ENSURING NO ORGANIC MATERIAL IS PRESENT.
 - TOPSOIL TO BE REMOVED OFF SITE UNLESS INSTRUCTED OTHERWISE.
 - STRIPPED AREAS MUST BE INSPECTED BY THE GEOTECHNICAL TESTING AUTHORITY (GTA).
 - IN ACCORDANCE WITH LEVEL 1 OF AS3798-2007 THE GEOTECHNICAL SUPERVISION OF EARTHWORKS IS TO BE DONE BY A N.A.T.A. REGISTERED GEOTECHNICAL TESTING AUTHORITY AT THE CONTRACTOR'S EXPENSE.
 - EARTHWORKS QUALITY TESTING WILL BE REQUIRED ON THIS SITE. THE GTA WILL NEED TO PROVIDE SUPERVISION IN ACCORDANCE WITH AS3798 AND UNDERTAKE FIELD DENSITY TESTS TO MONITOR THE ACTUAL DRY DENSITY AND MOISTURE CONTENT OF PLACED MATERIALS.
 - SITE SOILS BE PLACED NEAR OPTIMUM MOISTURE CONTENT (OMC) FOR GENERAL EARTHWORKS OPERATIONS. A RANGE OF ±2% OF OMC IS RECOMMENDED FOR GENERAL EARTHWORKS.
 - CLAYEY BACKFILL SHOULD NOT BE PLACED TOO DRY OF OMC TO AVOID FUTURE SWELLING WITH CHANGES TO MOISTURE CONTENT OR INUNDATION FROM WATER.
 - CONTRACTOR TO PROVIDE THE ENGINEERS WITH ALL TESTING THROUGHOUT THE PROJECT AND MUST NOTIFY THE ENGINEER OF NON-CONFORMANCES. ALL NON-CONFORMING ITEMS TO BE REMEDIED AS INSTRUCTED BY THE ENGINEER.
 - FILL AREA SUBGRADE TO BE PROOF ROLLED, IN THE PRESENCE OF THE ENGINEER, PRIOR TO FILL OPERATIONS. SOFT AND/OR COMPRESSIBLE MATERIAL TO BE REPLACED WITH ALTERNATIVE MATERIAL AND COMPACTED TO A DENSITY AS PER PROJECT SPECIFICATIONS.
 - FILL MATERIALS SHOULD BE PLACED IN RELATIVELY HORIZONTAL LAYERS WITH A MAXIMUM PLACEMENT THICKNESS OF 250mm. DIFFERENT THICKNESS COULD BE APPLICABLE AS A RESULT OF EQUIPMENT, TYPE OF COMPACTION AND OTHER GOVERNING FACTORS. MATERIALS TO BE COMPACTED TO A MINIMUM DRY DENSITY RATIO RELATIVE TO STANDARD COMPACTION EFFORT AS PER THE GEOTECHNICAL REPORT. LOOSE LAYER THICKNESS TO BE CONFIRMED WITH CERTIFYING ENGINEER.

- EARTHWORKS NOTES**
- INSITU CLAYS MAY NOT BE REUSED AS STRUCTURAL FILL IN THE UPPER 1.5m OF FILLING WITHIN BUILDING AREAS.
 - CONTRACTOR TO NOTIFY THE SUPERINTENDENT UPON COMPLETION OF EARTHWORKS OPERATIONS. THE FINISHED SURFACE MUST BE PROOF ROLLED AND WITNESSED BY THE ENGINEER.
 - IMPORTED FILL MATERIAL TO BE GRANULAR FILL WITH LOW PLASTICITY WITH MATERIAL CHARACTERISTICS: MIN. CBR 10% (SUBJECT TO APPROVAL FROM ENGINEER).
 - SUITABLE FILL MATERIAL IS TO COMPLY WITH CLAUSE 4.3, AS3798, GUIDELINES ON EARTHWORKS FOR COMMERCIAL AND RESIDENTIAL DEVELOPMENTS.
 - AS PER SECTION 11 OF THE ENVIRONMENTAL PROTECTION ACT (EPA) 1994: ALL FILL MATERIALS ON SITE, ONLY COMPRISED OF NATURAL EARTH AND ROCK, MUST BE FREE OF CONTAMINANTS, NOXIOUS, HAZARDOUS, DELETERIOUS AND ORGANIC MATERIALS.
 - RETAINING WALLS WILL NEED TO INCORPORATE FULL HEIGHT DRAINAGE IN ACCORDANCE WITH GOOD DESIGN PRACTICE TO MINIMISE HYDROSTATIC PRESSURE.
 - TEMPORARY DIVERSION DRAINS OR ANY OTHER REQUIRED DRAINAGE CONTROL DEVICES MUST BE IMPLEMENTED DURING CONSTRUCTION TO MINIMISE THE EFFECTS OF WEATHER CONDITIONS. SHOULD THERE BE DAMAGE TO THE WORKS AND/OR SURROUNDING AREA(S) AS A RESULT OF THE CONTRACTOR'S NEGLIGENCE IN NOT PROVIDING ADEQUATE PROTECTION, NO EXTENSION OF TIME WILL BE GRANTED.
 - THE CONTRACTOR IS RESPONSIBLE FOR PROTECTING THE SITE AND SURROUNDING AREAS FROM DAMAGE AS A RESULT OF STORMWATER RUN-OFF.
 - EARTHWORKS NOTES TO BE IN ACCORDANCE WITH THE GEOTECHNICAL REPORT. NOTES TO BE SUPERCEDED BY THE GEOTECHNICAL REPORT FOR ANY DISCREPANCIES BETWEEN THE DRAWINGS AND THE REPORT.
 - THE RELEVANT EPA POLICIES, PARTICULARLY THOSE REGARDING THE PRESENCE AND TREATMENT OF FIRE ANTS APPLY TO ANY MOVEMENT OF MATERIAL TO AND FROM SITE
 - THE CONTRACTOR IS RESPONSIBLE FOR UNDERTAKING ALL SERVICES SEARCHES & PROTECTION OF SERVICES DURING WORKS & FROM IMPACTS OF THE WORKS.
 - THE CONTRACTOR IS RESPONSIBLE FOR WORK METHODOLOGIES TO PROTECT ALL EXISTING INFRASTRUCTURE AND ENSURE COMPLIANCE WITH ALL APPLICABLE LEGISLATION, CODES OF PRACTICE AND REGULATIONS.
 - THE CONTRACTOR IS RESPONSIBLE FOR OBTAINING ALL RELEVANT PERMITS AND APPROVALS INCLUDING, BUT NOT LIMITED TO, ENVIRONMENTAL PERMITS AND APPROVALS.
 - THE CONTRACTOR MUST ENSURE COMPLIANT WORK PRACTICES ARE IN PLACE FOR MANAGING SAFETY, ENVIRONMENTAL AND QUALITY REQUIREMENTS FOR ALL ASPECTS OF WORKS AND OFF-SITE DISPOSAL OF MATERIALS

**BCC DS
RECEIVED**
 19/06/2026
APPLICATION REF
 A006972104

EXISTING SERVICES NOTE

THIS DESIGN HAS BEEN PREPARED BASED ON SERVICE AUTHORITY AS CONSTRUCTED INFORMATION. NO POT HOLING HAS BEEN UNDERTAKEN TO VERIFY EXISTING SERVICE LOCATIONS AND DEPTHS. IT IS THE CONTRACTORS RESPONSIBILITY TO UNDERTAKE POT HOLING TO VERIFY THE DESIGN.

REAL PROPERTY DESCRIPTION

RECONFIGURING A LOT - 1 INTO 2
 L564 RP83332
 DEVELOPMENT APPLICATION No. T.B.C.



NOT FOR CONSTRUCTION

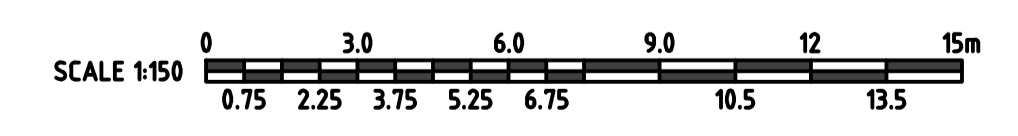

EARTHWORKS LAYOUT
SCALE 1:150

<p>DRAFTING AND RPEQ CERTIFICATION</p>	<p>RPEQ CERTIFICATION</p> <p>DATE 18/06/2026 SIGNED <i>Isaac Scot</i></p> <p>NAME OF SIGNATORY ISAAC SCOT</p> <p>RPEQ No. 16797</p>	<table border="1" style="width: 100%; border-collapse: collapse;"> <thead> <tr> <th>REV No.</th> <th>DATE</th> <th>DESCRIPTION</th> </tr> </thead> <tbody> <tr> <td>A</td> <td>20/02/2026</td> <td>ISSUED FOR APPROVAL</td> </tr> <tr> <td>B</td> <td>08/04/2026</td> <td>UPDATED TO COUNCIL RFI</td> </tr> <tr> <td>C</td> <td>18/06/2026</td> <td>UPDATED TO COUNCIL RFI</td> </tr> </tbody> </table>	REV No.	DATE	DESCRIPTION	A	20/02/2026	ISSUED FOR APPROVAL	B	08/04/2026	UPDATED TO COUNCIL RFI	C	18/06/2026	UPDATED TO COUNCIL RFI	<table border="1" style="width: 100%; border-collapse: collapse;"> <thead> <tr> <th>INITIALS</th> <th>DATE</th> </tr> </thead> <tbody> <tr> <td>DRAWN D.L.R.</td> <td>18/06/2026</td> </tr> <tr> <td>CHECKED S.E.</td> <td>18/06/2026</td> </tr> <tr> <td>APPROVED I.S.</td> <td>18/06/2026</td> </tr> </tbody> </table>	INITIALS	DATE	DRAWN D.L.R.	18/06/2026	CHECKED S.E.	18/06/2026	APPROVED I.S.	18/06/2026	<p>PROJECT RECONFIGURATION (1 INTO 2) OF L564 RP83332, 59 CAMLET STREET, MOUNT GRAVATT EAST, QLD, 4122</p> <p>CLIENT SHANE EDWARDS</p> <p>DRAWING DRIVEWAY & BULK EARTHWORKS LAYOUT</p>	<p>DRAWING STATUS</p> <p>TENDER <input type="radio"/> INFORMATION <input type="radio"/> APPROVAL <input checked="" type="radio"/> CONSTRUCTION <input type="radio"/> AS CONSTRUCTED <input type="radio"/></p> <p>DRAWING No. 3619-002</p> <p>REVISION C</p> <table border="1" style="width: 100%; border-collapse: collapse;"> <tr> <th>SHEET</th> <th>01</th> <th>02</th> </tr> <tr> <td>QE</td> <td></td> <td></td> </tr> </table>	SHEET	01	02	QE		
REV No.	DATE	DESCRIPTION																													
A	20/02/2026	ISSUED FOR APPROVAL																													
B	08/04/2026	UPDATED TO COUNCIL RFI																													
C	18/06/2026	UPDATED TO COUNCIL RFI																													
INITIALS	DATE																														
DRAWN D.L.R.	18/06/2026																														
CHECKED S.E.	18/06/2026																														
APPROVED I.S.	18/06/2026																														
SHEET	01	02																													
QE																															

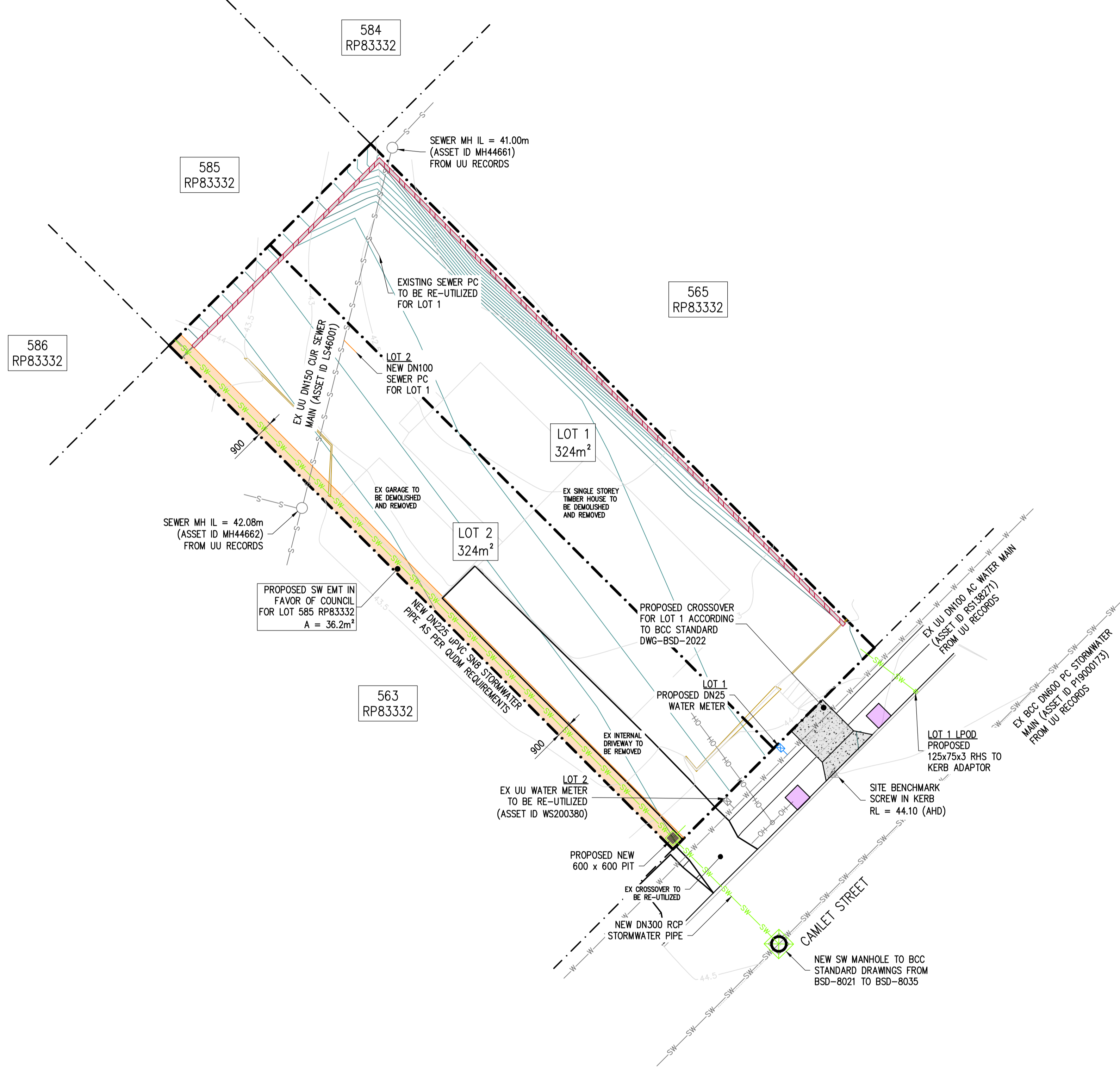
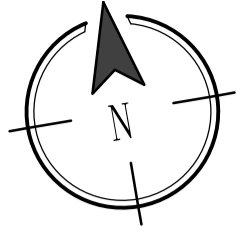

LEGEND

- NEW STORMWATER LINE AND CHAMBER
- EXISTING STORMWATER LINE AND CHAMBER
- NEW SWALE DRAIN
- NEW SEWER LINE AND MANHOLE
- EXISTING SEWER LINE AND MANHOLE
- NEW WATER LINE AND VALVE
- NEW WATER METER
- NEW FIRE HYDRANT
- EXISTING FIRE HYDRANT
- EXISTING WATER LINE
- CADASTRAL BOUNDARY
- NEW RETAINING WALL
- EXISTING RETAINING WALL
- PROPOSED EASEMENT
- EXISTING FENCE LINE
- EXISTING COMBINE DRAIN
- EXISTING TELSTRA
- EXISTING OPTIC FIBRE
- EXISTING GAS
- EXISTING O/H ELECTRICITY
- EXISTING U/G ELECTRICITY
- EXISTING CONCRETE
- EXISTING BUILDING LINE
- EXISTING BUILDING ROOF
- FINISHED FINAL LEVEL CONTOURS
- EXISTING CONTOURS
- FINISHED FINAL LEVEL
- AREA OF CUT
- SEDIMENT FENCE
- REFUSE BIN PAD



BEFORE YOU DIG AUSTRALIA (BYDA) DOCUMENTATION MUST BE OBTAINED BEFORE ANY ON-SITE CONSTRUCTION OR EXCAVATION IS ALLOWED TO COMMENCE. PROJECT DOCUMENTATION IS TO BE READ IN CONJUNCTION WITH THE BEFORE YOU DIG PLANS AND OTHER RELEVANT DOCUMENTATION.

EXISTING SERVICES NOTE

THIS DESIGN HAS BEEN PREPARED BASED ON SERVICE AUTHORITY AS CONSTRUCTED INFORMATION. NO POT HOLING HAS BEEN UNDERTAKEN TO VERIFY EXISTING SERVICE LOCATIONS AND DEPTHS. IT IS THE CONTRACTORS RESPONSIBILITY TO UNDERTAKE POT HOLING TO VERIFY THE DESIGN.

REAL PROPERTY DESCRIPTION

RECONFIGURING A LOT - 1 INTO 2
 L564 RP83332
 DEVELOPMENT APPLICATION No. T.B.C.

**BCC DS
 RECEIVED**
 19/06/2026
APPLICATION REF
 A006972104

NOT FOR CONSTRUCTION

SITE SERVICES LAYOUT
SCALE 1:150

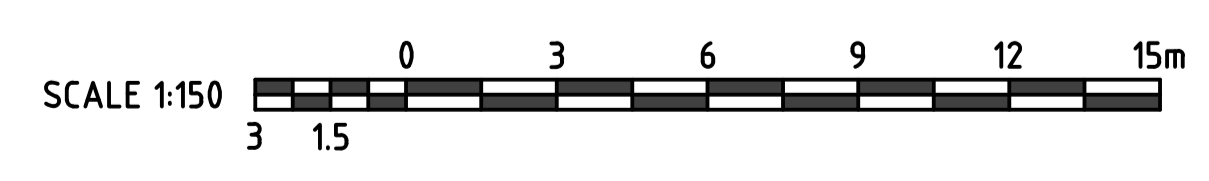

<p>DRAFTING AND RPEQ CERTIFICATION</p>	<p>RPEQ CERTIFICATION</p> <p>DATE 18/06/2026 SIGNED <i>Isaac Scot</i></p> <p>NAME OF SIGNATORY ISAAC SCOT</p> <p>RPEQ No. 16797</p>	<table border="1" style="width: 100%; border-collapse: collapse;"> <thead> <tr> <th>REV No.</th> <th>DATE</th> <th>DESCRIPTION</th> </tr> </thead> <tbody> <tr> <td>A</td> <td>20/02/2026</td> <td>ISSUED FOR APPROVAL</td> </tr> <tr> <td>B</td> <td>08/04/2026</td> <td>UPDATED TO COUNCIL RFI</td> </tr> <tr> <td>C</td> <td>18/06/2026</td> <td>UPDATED TO COUNCIL RFI</td> </tr> </tbody> </table>	REV No.	DATE	DESCRIPTION	A	20/02/2026	ISSUED FOR APPROVAL	B	08/04/2026	UPDATED TO COUNCIL RFI	C	18/06/2026	UPDATED TO COUNCIL RFI	<table border="1" style="width: 100%; border-collapse: collapse;"> <thead> <tr> <th>INITIALS</th> <th>DATE</th> </tr> </thead> <tbody> <tr> <td>DRAWN D.L.R.</td> <td>18/06/2026</td> </tr> <tr> <td>CHECKED S.E.</td> <td>18/06/2026</td> </tr> <tr> <td>APPROVED I.S.</td> <td>18/06/2026</td> </tr> </tbody> </table>	INITIALS	DATE	DRAWN D.L.R.	18/06/2026	CHECKED S.E.	18/06/2026	APPROVED I.S.	18/06/2026	<p>PROJECT RECONFIGURATION (1 INTO 2) OF L564 RP83332, 59 CAMLET STREET, MOUNT GRAVATT EAST, QLD, 4122</p> <p>CLIENT SHANE EDWARDS</p> <p>DRAWING SITE SERVICES LAYOUT</p>	<p>DRAWING STATUS</p> <p>TENDER <input type="radio"/> INFORMATION <input type="radio"/> APPROVAL <input checked="" type="radio"/> CONSTRUCTION <input type="radio"/> AS CONSTRUCTED <input type="radio"/></p> <p>DRAWING No. 3619-004</p> <p>REVISION C</p> <table border="1" style="width: 100%; border-collapse: collapse;"> <tr> <td>SHEET</td> <td>01</td> <td>QE</td> <td>01</td> </tr> </table>	SHEET	01	QE	01
REV No.	DATE	DESCRIPTION																											
A	20/02/2026	ISSUED FOR APPROVAL																											
B	08/04/2026	UPDATED TO COUNCIL RFI																											
C	18/06/2026	UPDATED TO COUNCIL RFI																											
INITIALS	DATE																												
DRAWN D.L.R.	18/06/2026																												
CHECKED S.E.	18/06/2026																												
APPROVED I.S.	18/06/2026																												
SHEET	01	QE	01																										