

BCC DS
RECEIVED
20/08/2024
APPLICATION REF
A006067610

CLOVERDALE ROAD

ROAD

ROAD 16m WIDE

ROAD 14m WIDE

ROAD

CP SP2871/2

Emt.B SP2871/7

Emt.A SP2871/7

Spot 5
RL24.187

Spot 1
RL24.278

Spot 2
RL20.878

Spot 3
RL20.069

Spot 4
RL18.674

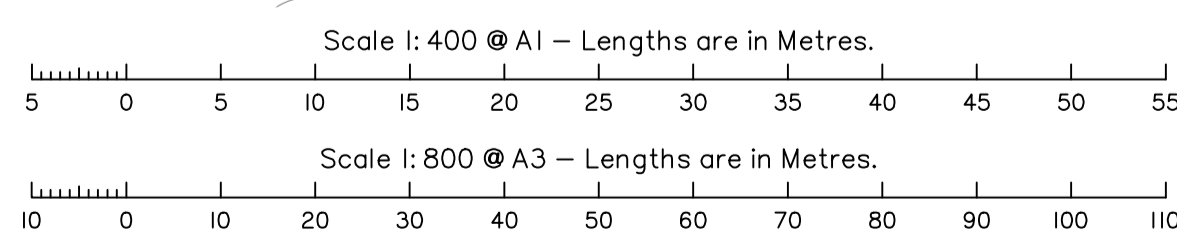
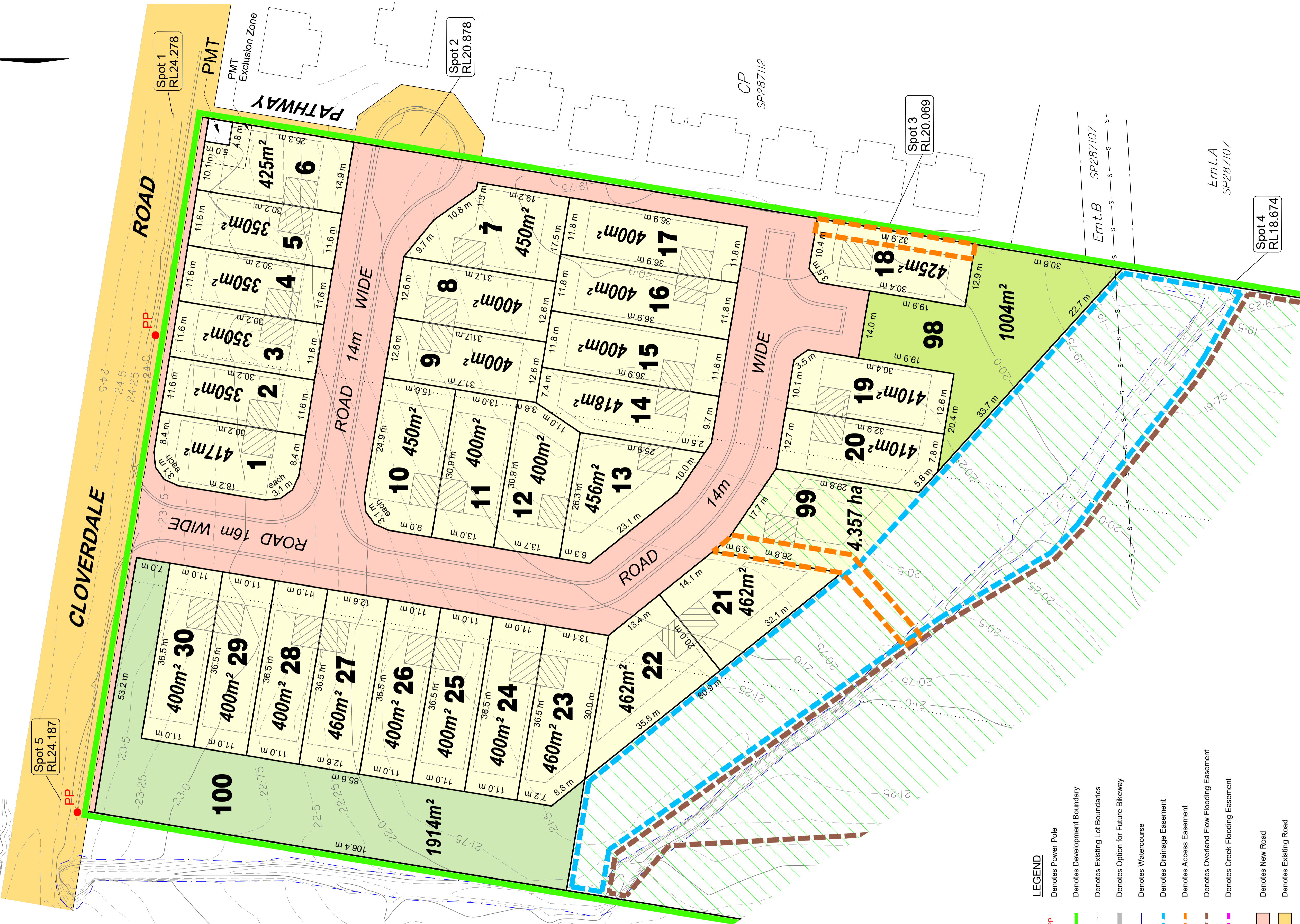

- LEGEND**
- PP Denotes Power Pole
 - Denotes Development Boundary
 - Denotes Existing Lot Boundaries
 - Denotes Option for Future Bikeway
 - Denotes Watercourse
 - Denotes Drainage Easement
 - Denotes Access Easement
 - Denotes Overland Flow Flooding Easement
 - Denotes Creek Flooding Easement
 - Denotes New Road
 - Denotes Existing Road
 - Denotes Drainage Reserve
 - Denotes Bio-retention Basin
 - Denotes Detached House Lots (31 Dwellings)
 - Denotes Environmental Protection Zone

REV	AMENDMENT	DATE
C-3	WIDENING OF EASEMENT	15/02/2022
C-4	ALTERATION OF BUSH LOT FRONTAGE	05/05/2022
C-5	REALIGNMENT OF POTENTIAL ACTIVE TRANSPORT ROUTE	05/07/2022
D-1	REDESIGN	05/08/2023
E-1	REDESIGN	07/08/2024

Intrax
Ground Floor D2, 643 Kessels Rd
Upper Mt. Gravatt QLD 4122
PH: 1300 639 611 | 07 558 588 729
www.intrax.com.au
Intrax Consulting Group
VIC | NSW | SA | QLD

PROPOSED RECONFIGURATION OF LOT APPLICATION OVER
LOTS 101-103 ON RP90234
12, 18 & 26 CLOVERDALE ROAD
LOCALITY OF DOOLANDELLA LOCAL AUTHORITY OF BRISBANE C.C.

This plan was prepared as a proposed subdivision and should not be used for any other purpose. The dimensions, areas and total number of lots shown hereon are subject to field survey and also to the requirements of Council and any other authority which may have requirements under any relevant legislation. In particular, no reliance should be placed on the information on this plan for any financial dealings involving the land. This note is an integral part of this plan.

HORIZONTAL DATUM: MGA, Zone 56
VERTICAL DATUM: AHD
ORIGIN: 3814002-1
CONTOUR INTERVAL: 0.25 m

SCALE: 1:400
DATE: 7/8/2024
SHEET NO. 2 OF 2
S152485

SURVEYED: **Storfields**
DRAWN:
CHECKED:
APPROVED:
REVISION: (E-1)
E A1

SHEET 2

BCC DS
 RECEIVED
 20/08/2024
 APPLICATION REF
 A006067610

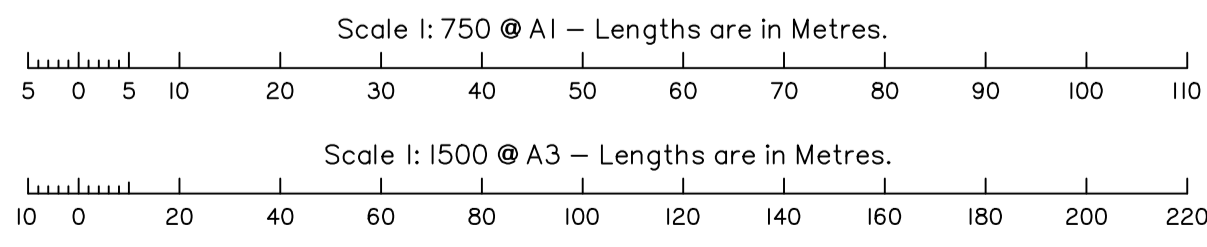
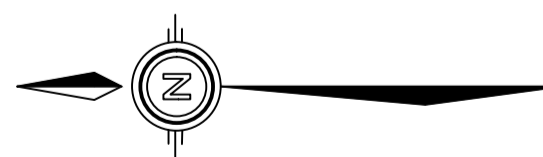

REV	AMENDMENT	DATE
C-3	WIDENING OF EASEMENT	15/02/2022
C-4	ALTERATION OF BUSH LOT FRONTAGE	05/05/2022
C-5	REALIGNMENT OF POTENTIAL ACTIVE TRANSPORT ROUTE	05/07/2022
D-1	REDESIGN	05/06/2023
E-1	REDESIGN	07/08/2024



PROPOSED RECONFIGURATION OF LOT APPLICATION OVER
 LOTS 101-103 ON RP90234
 12, 18 & 26 CLOVERDALE ROAD
 LOCALITY OF DOOLANDELLA LOCAL AUTHORITY OF BRISBANE C.C.

This plan was prepared as a proposed subdivision and should not be used for any other purpose. The dimensions, areas and total number of lots shown hereon are subject to field survey and also to the requirements of Council and any other authority which may have requirements under any relevant legislation. In particular, no reliance should be placed on the information on this plan for any financial dealings involving the land. This note is an integral part of this plan.

HORIZONTAL DATUM: MGA, Zone 56	SCALE: 1:750	SURVEYED:
VERTICAL DATUM: AHD	DATE: 7/8/2024	DRAWN: Storfields
ORIGIN: 3814002-1	SHEET NO. 1 OF 2	CHECKED:
CONTOUR INTERVAL: 0.25 m	S152485	APPROVED:
	E	REVISION: (E-1)
	A1	

SHEET 1