

# LANDSCAPE DEVELOPMENT APPROVAL DRAWINGS

Prepared For

## Multi-Residential Apartment

70 Sylvan Road  
Toowong  
QLD 4066

## LANDSCAPE OBJECTIVES

Provide an aesthetically pleasing landscape scheme, utilising deep planting and subtropical landscape areas.

Implement a selection of specific vegetation to compliment the building design and respond to the local climate.

## GENERAL SPECIFICATION NOTES

These drawings to be read in conjunction with the drawing package from the following consultants:  
- HAL Architects: Architect

Refer to architectural drawings for details relating to:  
- Buildings, hardworks, decks and pavements  
- Enclosures & walls  
- New services.

### Setting out:

Contractor is to verify all set out and dimensions prior to proceeding with the works - refer to superintendent for clarification.

### Contractors facilities:

Site storage / compound location(s) to be confirmed by superintendent.

### Access and safety:

Contractor to maintain safe access paths through site at all times. Ensure all excavations are fully protected at all times.

### Services:

It is the Landscape Contractor's responsibility to confirm with authorities and Builder / Civil Contractor the location of all underground services prior to commencement, repair any damage to services without delay & cost.

### Plant set-out and stock:

All plant stock to be verified by a Landscape Architect / Superintendent for stock quality, size, and set out prior to planting. Substitutions are not to be made without written approval.

Set out of mass planted areas: where not detailed  
- Plants to be set out in swathes of single species of large numbers of plants.  
- Swathes to be set out in naturalistic elongated random sized forms/ shapes  
- Swathes of species to be arranged to provide contrast in size, form, texture and colour.  
- Landscape Architect to discuss and verify on site a sample section of planting swathes set out prior to contractor proceeding to set out and complete.

### Planting standards:

Works to be carried out in accordance with relevant Australian and industry standards unless directed otherwise.

### Protection of works:

Contractor to ensure full protection of the works during the construction and establishment periods.

### Erosion and sediment control:

Sediment runoff from earthwork sites is to be prevented from entering the underground drainage system. Typical sediment trap mechanism will include:  
- Stacked hay bales  
- Entrenched hay bales  
- Earthen embankments  
- Filter cloth fences  
- Shallow temporary berms

The exposed areas are to be stabilised and landscape works carried out as soon as practicable. Diversion drains and sediment traps are to remain in place until stabilisation works have been completed. The maximum width of soil exposed at any time during embankment works should be limited to 10m.

## TREE PROTECTION NOTES

All work near trees (neighbouring & to be protected) to comply with Australian Standard 4970-2025 Protection of Trees on Development Sites.

### Harmful materials:

Keep the area within the drip line free of construction material and debris. Do not place bulk materials and harmful materials under or near trees. Do not place spoil from excavations against tree trunks. Prevent wind-blown materials such as cement from harming trees and plants.

### General:

Do not remove topsoil from, or add topsoil to, the area within the drip line of the trees.

### Excavation:

If excavation is required near trees to be retained, give notice and obtain instructions. Open up excavations under tree canopies for as short a period as possible.

### Hand methods:

Use hand methods to locate, expose and cleanly remove the roots on the line of excavation. If it is necessary to excavate within the drip line, use hand methods such that root systems are preserved intact and undamaged.

### Roots:

Do not cut tree roots exceeding 50 mm diameter. Where it is necessary to cut tree roots, use means such that the cutting does not unduly disturb the remaining root system.

## SOFTWORKS

All mass planting and turf areas to be prepared prior to planting. Preparation to include cultivation of the subgrade to a depth of 150mm. If the subsoil is of a high clay content, apply gypsum at the manufacturers recommended rate. In sandy soils, incorporate organic materials to increase water holding capacity and nutrients.

### Soil (under turf):

Install organic topsoil to all turfed areas. Soil to be free of debris and weed seeds and conform to the required Australian standards for under turf mix.  
Type: under turf blend  
Depth: 150mm

### Soil (on ground):

Install organic topsoil to all mass planting areas. Soil to be free of debris and weed seeds and conform to the required Australian standards for premium planting blend.  
Type: premium planting blend  
Depth: 300mm

### Soil (on structure):

Install organic lightweight podium blend topsoil to all on structure planting areas. Soil to be free of debris and weed seeds and conform to the required Australian standards for premium lightweight podium planting blend.  
Type: premium lightweight podium planting blend  
Depth: varies

### Root barrier

Supply and install root barrier to all trees within isolated garden beds and near (within 1m) of services.

## LANDSCAPING NOTES

### General

All works to be performed by a licensed Contractor familiar with landscape construction of this nature. The Contractor shall verify the location of utilities / services on site prior to the commencement of construction, and ensure that they will not have an effect on the works.  
Should there be any conflict, the Contractor shall notify the Landscape Architect immediately.

### Standards

Soils General: to AS4419

### Fire Ants

All imported materials to be certified and recorded as free of fire ants.

### Site & Soil

Planting beds cultivation minimum depth: 100mm  
Cultivation Depths:  
- Grasses area (turf) 150mm  
- Planting areas 150mm

### Source

General: Import topsoil that complies with AS4419  
Topsoil Source Schedule:

Soil Type: premium organic topsoil mixture (AS4419)

### Topsoil Depths:

Spread topsoil to the following depths:  
- Excavated planting areas: If using organic mulch, 300mm.

### Fertiliser

Provide proprietary fertilisers, delivered to the site in sealed bags marked to show manufacturer or vendor, weight, fertiliser type, N:P:K ratio recommended uses and application rates.

### Existing Trees

Protect all existing vegetation unless otherwise specified.

### Finished Levels & Grades

Minimum cross falls of 1:50 on planting and pathways to drainage collection points and overflow points. Planting areas should not exceed 1:3.

### Cultivation

Cultivate sub-grade to a minimum depth of 150mm prior to placing topsoil to all planting and turf areas on ground.

### Topsoil

Supply and install imported topsoil that complies with Australian Standard 4419 to all turf (100mm) and garden areas (300mm) as shown on drawings unless otherwise specified.  
Ensure modified site soil is free from stones, sticks, roots, rubbish & material toxic to plant growth.  
Modified topsoil shall have a friable structure with good drainage and high organic content.

### Mulch

General: Provide mulch which is free of deleterious and extraneous matter such as soil, weeds and sticks.  
Standard: To AS4454  
Mulch Material:  
Raised planters: 75mm deep TEA TREE MULCH.  
On natural ground: 100mm deep AGED FOREST MULCH.  
Spread organic mulch evenly to above depth.

### Turf

Supply and install A-grade turf (variety specified on drawings) to areas shown on drawings. Finishing levels should be flush with adjacent surfaces unless otherwise detailed. Spread topsoil and grade surface to ensure a level finished surface, which drains to nominated field gullies.

### Plants

General: Provide plants with the following characteristics:  
- Large healthy root systems with no evidence of root curl, restriction or damage  
- Vigorous, well established, free from disease and pests, of good form consistent with the species or variety.  
- Hardened off, not soft or forced, and suitable for planting in the natural climatic conditions prevailing at the site.

Supply plants in weed-free containers of the required size.

Open rooted stock: if trees are to be supplied as open rooted stock, ensure this is appropriate to the species, variety, size and time of year for planting.

### Stakes

#### Stake sizes

- For plants 1-2.5m high:  
Two 50x50x1800mm stakes per plant

#### Ties

Provide ties fixed securely to the stakes, one tie at half the height of the main stem, others as necessary to stabilise plant.

#### Tie Types

For plants < 2.5m high:  
50mm hessian webbing stapled to the stake.

### Planters

Planter depths as indicated on Landscape Plan:  
600 - 2100mm internal depth, which allows for 400 - 1200mm, soil media depth minimum, refer to plans for each level and drawing L007 for more detail. All raised planters to be waterproofed and connected to irrigation and stormwater drainage.  
Indicative planter dimensions are shown on drawings.

### Hydraulics & Irrigation Installation

The irrigation system, shall be fully automatic and provide even cover to all podium planting. All raised planters & undercover areas to be connected to irrigation system.

The equipment and installation processes are intended to produce an irrigation system which complies with all applicable industry, local authority and Australian standards.

Hosecocks, irrigation and field gullies to future detail.

### Lighting

All lighting to be carried out by a qualified electrician. All recommended lighting is merely a suggestion, with the ultimate style of lighting used at the description of the client.

### Maintenance / Establishment Period

Maintenance of all landscape works is to be carried out by the contractor until completion of the landscape works plus 12 weeks from Practical Completion. Maintenance includes replacement of dead and/or diseased plant stock, removal of weeds and rubbish, weed spraying and mowing.

## LANDSCAPE

### General Notes

This drawing is Copyright © Any design or drawing is not to be reproduced, either in whole or part, without written permission by Hayes Anderson Lynch Architects Pty. Ltd. Confirm all dimensions on site. Do not scale off drawings. All levels are approximate only and are subject to confirmation by licensed surveyor. All workmanship, materials and construction to comply with the Queensland Building Act 1975-2011 and The Building Code of Australia 2015, Premises Standard and AS1428.1. Work to be carried out in a neat and appropriate manner. Where ambiguities or discrepancies exist, Hayes Anderson Lynch Architects Pty. Ltd. shall be contacted for clarification. These drawings have been prepared by a registered landscape architect. This is a concept plan for Development Approvals only. Landscape Compliance Certification necessary for Building Approval stage of development.

BCC DS

RECEIVED

03/03/2026

APPLICATION REF

A006737871

27/02/26 C Information Request Issue AL  
24/11/25 B Information Request Issue AL  
17/03/25 A DA Lodgement Issue AL

Date	Issue	Details	Checked
------	-------	---------	---------



ARCHITECTS  
TOWN PLANNERS  
INTERIOR DESIGNERS

3 / 709 MAIN STREET  
KANGAROO POINT QLD 4169

P + 61 7 3 8 5 2 3 1 9 0  
E reception@halarchitects.com.au  
W www.halarchitects.com.au

Project

## Multi-Residential Apartment

70 Sylvan Road  
Toowong  
QLD 4066

Drawing Title

## Landscape Concept Cover Sheet

Scale @ A3	Drawn:	Checked:
NTS	SC	AL
Project Number	Drawing Number	Issue

H4899SYL L001 C

LANDSCAPE CONCEPT PLAN - Ground - 70 Sylvan Road, Toowong

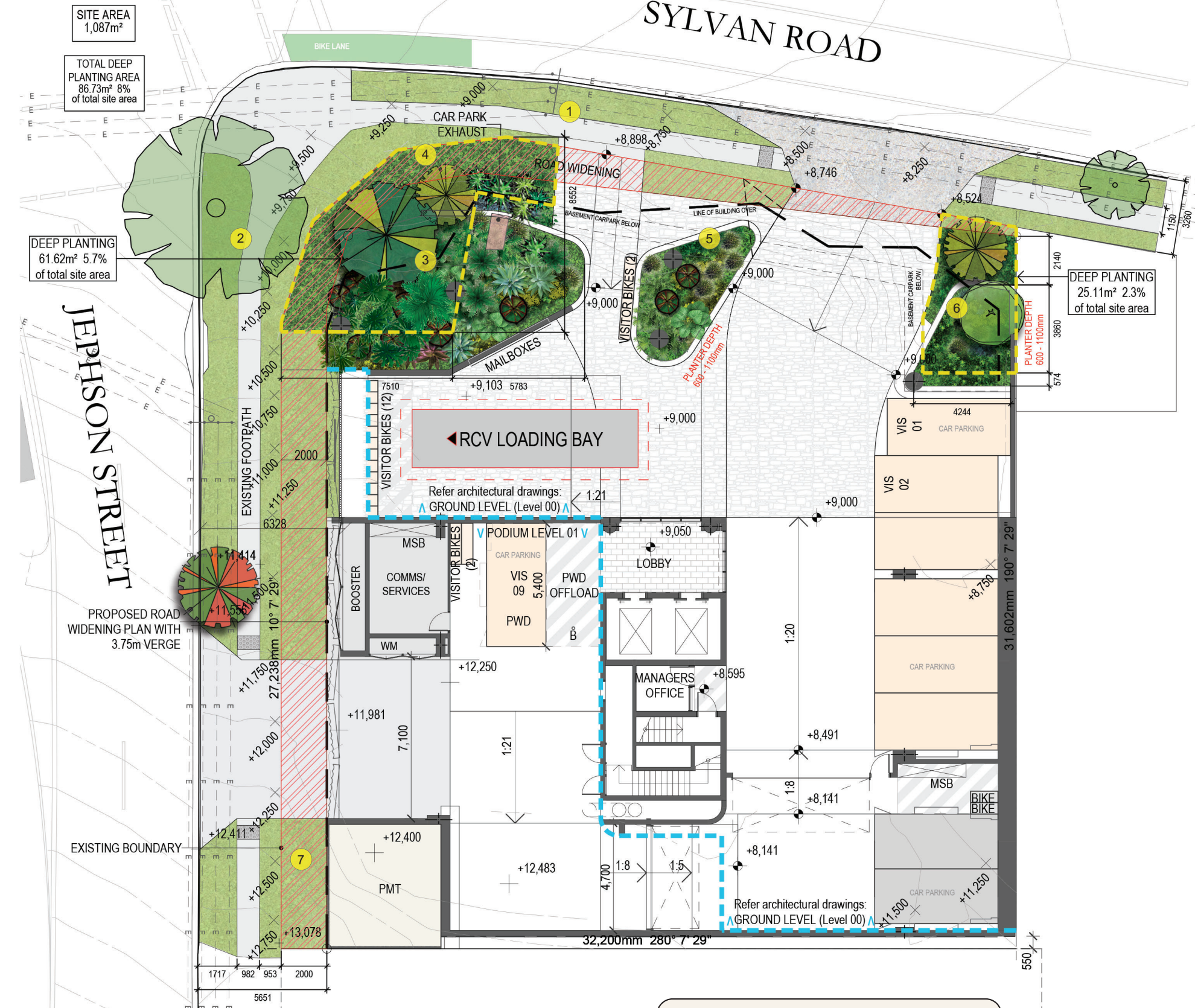
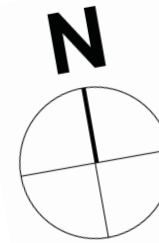











SITE AREA  
1,087m<sup>2</sup>

TOTAL DEEP  
PLANTING AREA  
86.73m<sup>2</sup> 8%  
of total site area

DEEP PLANTING  
61.62m<sup>2</sup> 5.7%  
of total site area

DEEP PLANTING  
25.11m<sup>2</sup> 2.3%  
of total site area

LEGEND

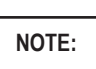
-  EXISTING STREET TREES  
retained & protected
-  PROPOSED STREET TREE  
refer drg L008 for proposed species
-  SHADE TREES  
refer drg L008 for proposed species
-  PALM TREES  
native Cabbage Palms
-  COLUMNAR TREES
-  SMALL CANOPY ORNAMENTAL TREE
-  FEATURE PALMS  
such as Queensland Fan Palm  
and Clumping Betel Nut
-  FEATURE CYCADS & PALMS  
such as Tree Fern & Pygmy Date Palm
-  MIDDLE STOREY SHRUBS  
Screening plants
-  CLIMBING VINES  
STEEL WIRE TRELLIS TO UPPER LEVELS
-  FEATURE PLANTS  
refer drg L008 for proposed species
-  UNDERSTOREY & GROUNDCOVER PLANTS
-  GROUNDCOVER PLANTS
-  NATURAL TURF
-  SERVICES  
overhead powerlines
-  DEEP PLANTING  
Approx. 86.73m<sup>2</sup>  
8% of the total site area

NOTE:

1. With regard to landscape, this drawing has been prepared in accordance with the Brisbane City Council (BCC) City Planning Scheme 2014, including section 9.4.5 Landscape Work Code & SC6.17 Landscape Design Planning Scheme Policy.
2. Refer to Numerical Key on drawing L003.
3. Refer to Landscape Concept Details & Podium Planter Maintenance Schedule on drawing L007.
4. For proposed plant species, refer to Plant Species Palette drawing L008, compiled with reference to BCC Planting Species Planning Scheme Policy.
5. Refer to Landscape Plans for podium planter depths and indicative dimensions.
6. Refer to relevant BCC Standard Drawings.

**LANDSCAPE CONCEPT  
DRAWING SCHEDULE:**

DRG No.	Drawing Title
L001	Landscape Concept Cover Sheet
L002	Landscape Concept Plan - Ground
L003	Landscape Concept - Numerical Key
L004	Podium Levels 02, 03 & 03.5
L005	Landscape Concept Plan - Level 02
L006	Landscape Concept Plan - Roof Terrace
L007	Landscape Concept - Details
L008	Landscape Concept - Plant Species Palette

LANDSCAPE

General Notes

This drawing is Copyright © Any design or drawing is not to be reproduced, either in whole or part, without written permission by Hayes Anderson Lynch Architects Pty. Ltd. Confirm all dimensions on site. Do not scale off drawings. All levels are approximate only and are subject to confirmation by licensed surveyor. All workmanship, materials and construction to comply with the Queensland Building Act 1975-2011 and The Building Code of Australia 2015, Premises Standard and AS1428.1. Work to be carried out in a neat and appropriate manner. Where ambiguities or discrepancies exist, Hayes Anderson Lynch Architects Pty. Ltd. shall be contacted for clarification. These drawings have been prepared by a registered landscape architect. This is a concept plan for Development Approvals only. Landscape Compliance Certification necessary for Building Approval stage of development.

**BCC DS  
RECEIVED**  
 03/03/2026  
**APPLICATION REF**  
 A006737871

Date	Issue	Details	Checked
27/02/26	C	Information Request Issue	AL
24/11/25	B	Information Request Issue	AL
17/03/25	A	DA Lodgement Issue	AL



**HAYES  
ANDERSON  
LYNCH**  
ARCHITECTS PTY LTD

ARCHITECTS  
TOWN PLANNERS  
INTERIOR DESIGNERS

3 / 709 MAIN STREET  
KANGAROO POINT QLD 4169  
**P + 61 7 3 8 5 2 3 1 9 0**  
**E reception@halarchitects.com.au**  
**W www.halarchitects.com.au**

Project  
**Multi-Residential Apartment**  
70 Sylvan Road  
Toowong  
QLD 4066

Drawing Title  
**Landscape Concept Plan - Ground**  
Scale @ A3 Drawn: Checked:  
1:200 SC AL  
Project Number Drawing Number Issue  
**H4899SYL L002 C**

Artist's impressions, refer architectural drawings. Plant species indicative only.



Sylvan Road northern façade - podium level planters & climbing vines to frontage



North west corner / western façade - Jephson Street



Junction of Sylvan Road and Jephson Street, northwest corner

**NUMERICAL KEY** refer drawing L002.

- 1 **Existing footpath to Sylvan Road** to be retained and turf made good if damaged, to Brisbane City Council (BCC) specifications. 'Voodoo' black tactile indicator pavers to concrete exposed aggregate driveway crossover, as per BCC standard drawings and Centre Street Minor (CS2) guidelines Future planned road widening works as indicated on plan. Adjacent Golden Trumpet street tree to be retained and protected.
- 2 **Existing footpath to Jephson Road** to be retained and turf made good if damaged, Brisbane City Council (BCC) specifications. Plain concrete driveway crossover as per Subtropical Boulevard out of centre (SB02) guidelines, with 'Voodoo' black tactile indicator pavers. Proposed street tree planted beneath existing powerlines, installed within mulched garden bed 1.3 x 1.3m with spade cut edge, dependent on future planned road widening works as indicated on plan. Existing large Weeping Bottlebrush street tree to be protected and retained.
- 3 Large subtropical trees, clumping palms and screening shrubs to northern boundary, to form a large **deep planting** area, over 10m wide. A mixture of sun loving to shade tolerant plant species create a tiered vegetative buffer to the front of the site. Refer to Plant Species Palette drawing L008. Middlestorey screening plants, such as Cinnamon Myrtle and Tree Philodendron, over groundcover plants, such as blue Flax Lily, Bird of Paradise and Xanadu. A densely planted diverse mix of species to form a rich layered rainforest feel with large feature plants such as Queensland Fan Palms and Betel Nut Palms overhead, beneath the Podium level building over. Feature plant species to add interest, soften and enhance the built form.  
  
Colourful, lush, tiered mass planting areas to provide visual interest and vertical scale. **Feature shade tree**, such as Queensland Tree Waratah, to bring seasonal interest and colour. Middlestorey screening shrubs and palms with non-invasive root systems to be installed as robust specimens to provide immediate impact, reinforcing privacy whilst assisting with noise reduction and softening the built form.
- 4 **Low groundcover** planting to verge as per BCC recommendations.
- 5 **Feature and groundcover planting** to highlight the pedestrian entrances and maintain safety sightlines in relation to vehicular traffic and CPTED guidelines, whilst reinforcing the private / public landscape boundary.
- 6 Raised planter partially open to natural ground, with **cascading creeping groundcover** plants to spill over planter edges, to create interest at the pedestrian and vehicular entrance to the site. Large subtropical native tree, such as *Elaeocarpus reticulatus* Blueberry Ash to define the northeast corner of the site.
- 7 Turf verge widened to create a **5m verge width on Jephson Street**.



Jephson Street - western boundary, cascading groundcover planting at Level 02



Southwest site corner showing trailing vines to rear south side of building

**LANDSCAPE**

General Notes

This drawing is Copyright © Any design or drawing is not to be reproduced, either in whole or part, without written permission by Hayes Anderson Lynch Architects Pty. Ltd. Confirm all dimensions on site. Do not scale off drawings. All levels are approximate only and are subject to confirmation by licensed surveyor. All workmanship, materials and construction to comply with the Queensland Building Act 1975-2011 and The Building Code of Australia 2015, Premises Standard and AS1428.1. Work to be carried out in a neat and appropriate manner. Where ambiguities or discrepancies exist, Hayes Anderson Lynch Architects Pty. Ltd. shall be contacted for clarification. These drawings have been prepared by a registered landscape architect. This is a concept plan for Development Approvals only. Landscape Compliance Certification necessary for Building Approval stage of development.

**BCC DS**  
**RECEIVED**  
 03/03/2026  
**APPLICATION REF**  
 A006737871

27/02/26	C	Information Request Issue	AL
24/11/25	B	Information Request Issue	AL
17/03/25	A	DA Lodgement Issue	AL
Date	Issue	Details	Checked



**HAYES  
ANDERSON  
LYNCH**  
ARCHITECTS PTY LTD

ARCHITECTS  
TOWN PLANNERS  
INTERIOR DESIGNERS

3 / 709 MAIN STREET  
KANGAROO POINT QLD 4169

**P + 61 7 3 8 5 2 3 1 9 0**  
**E** reception@halarchitects.com.au  
**W** www.halarchitects.com.au

Project  
**Multi-Residential Apartment**

70 Sylvan Road  
Toowong  
QLD 4066

Drawing Title  
**Landscape Concept -  
Numerical Key**

Scale @ A3	Drawn:	Checked:
1:200	SC	AL
Project Number	Drawing Number	Issue
<b>H4899SYL</b>	<b>L003</b>	<b>C</b>

LANDSCAPE CONCEPT PLAN \_ Podium Level 02 & 03 \_ 70 Sylvan Road, Toowong

Planting to **elevated fringe podium planters**, such as Copper Spoons plant with Carissa 'Desert Star' over native Creeping Boobialla. Refer to plant species for **Zone P** for narrow podium planters in full sun, on drawing L008.

Flowering climbing vines create feature **green façades** to the north side of the building. **Flowering climbing vines** to building façade such as native Wonga Wonga Vine. Refer to adjacent architectural image and Plant Species Palette on drawing L008.

**Feature planting** to elevated podium planters, such as large flowering Aloes and Bird of Paradise, over cascading creeping groundcover plants, such as native *Casuarina 'Cousin It'* and Creeping Hop Goodenia. Refer to plant species for **Zone R** for podium planters in full sun, on drg L008.

Landscape maintenance to be performed via abseiling from provided anchor points. Fall arrest equipment to be provided, by others, for landscape maintenance, to ensure safety at height, and designed by accredited safety consultant in accordance with Worksafe requirements and Australian Standards. Access is available from the car park areas to the corner podium planters.

Sylvan Road north façade - climbing vines to frontage



Podium Level 03.5 1:500 @ A3

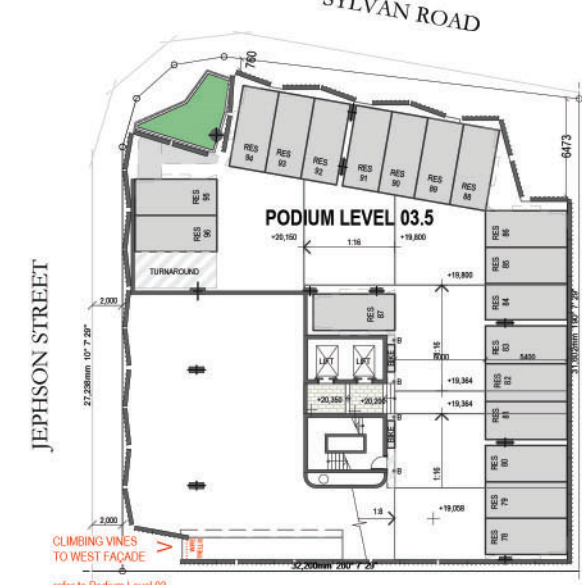

Podium Level 03 1:500 @ A3



LANDSCAPE

**General Notes**  
 This drawing is Copyright © Any design or drawing is not to be reproduced, either in whole or part, without written permission by Hayes Anderson Lynch Architects Pty. Ltd. Confirm all dimensions on site. Do not scale off drawings. All levels are approximate only and are subject to confirmation by licensed surveyor. All workmanship, materials and construction to comply with the Queensland Building Act 1975-2011 and The Building Code of Australia 2015, Premises Standard and AS1428.1. Work to be carried out in a neat and appropriate manner. Where ambiguities or discrepancies exist, Hayes Anderson Lynch Architects Pty. Ltd. shall be contacted for clarification. These drawings have been prepared by a registered landscape architect. This is a concept plan for Development Approvals only. Landscape Compliance Certification necessary for Building Approval stage of development.

BCC DS  
 RECEIVED  
 03/03/2026  
 APPLICATION REF  
 A006737871

27/02/26	C	Information Request Issue	AL
24/11/25	B	Information Request Issue	AL
17/03/25	A	DA Lodgement Issue	AL
Date	Issue	Details	Checked

**HAYES ANDERSON LYNCH ARCHITECTS PTY LTD**  
 ARCHITECTS  
 TOWN PLANNERS  
 INTERIOR DESIGNERS  
 3 / 709 MAIN STREET  
 KANGAROO POINT QLD 4169  
 P +61 7 3852 3190  
 E reception@halarchitects.com.au  
 W www.halarchitects.com.au

Project  
**Multi-Residential Apartment**  
 70 Sylvan Road  
 Toowong  
 QLD 4066

Drawing Title  
**Landscape Concept Plan - Podium Level 02, 03 & 03.5**  
 Scale @ A3 Drawn: Checked:  
 1:200 SC AL  
 Project Number Drawing Number Issue  
**H4899SYL L004 C**

Feature multi stem pygmy Date Palm, or similar to north eastern podium planter on Podium Level 03, where extra height is afforded.

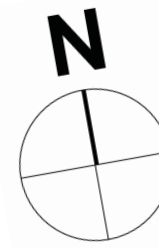

LANDSCAPE

General Notes

This drawing is Copyright © Any design or drawing is not to be reproduced, either in whole or part, without written permission by Hayes Anderson Lynch Architects Pty. Ltd. Confirm all dimensions on site. Do not scale off drawings. All levels are approximate only and are subject to confirmation by licensed surveyor. All workmanship, materials and construction to comply with the Queensland Building Act 1975-2011 and The Building Code of Australia 2015, Premises Standard and AS1428.1. Work to be carried out in a neat and appropriate manner. Where ambiguities or discrepancies exist, Hayes Anderson Lynch Architects Pty. Ltd. shall be contacted for clarification. These drawings have been prepared by a registered landscape architect. This is a concept plan for Development Approvals only. Landscape Compliance Certification necessary for Building Approval stage of development.

**BCC DS**  
**RECEIVED**  
 03/03/2026  
**APPLICATION REF**  
 A006737871

JEPHSON STREET

SYLVAN ROAD



Spilling hardy groundcover and understory species to western side of building.

Native flowering wonga wonga vine to western face of building

Vigorous trailing vine species to cascade down rear face of the building to soften & enliven the builtform. Species such as Star Jasmine, native Kangaroo Vine and Wax Flower Vine. Refer to Plant Species Palette with species for **Zone S** for podium planters in full sun, on drg L008.

Green façade to rear of building



Sun loving feature planting to frontage over entry, over groundcover planting to spill over raised planter.

Screen planting to provide privacy to balcony area.

Upper Levels Plan 1:500 @ A3

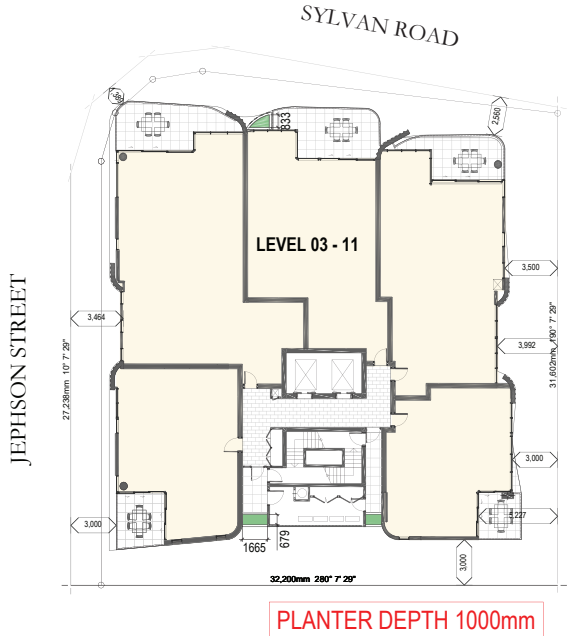

Three podium planters to be installed to Levels 03 - 11. Note internal layout varies, refer architectural drawings. Minimum 600mm media depth to accommodate plant species. See drawings of front façade on drawing L003, showing the planters visually connecting the proposed planting on natural ground with the Roof Terrace.

Levels 12 and 13 repeat the above planter layout (Levels 03 - 11), with the exception of the front planter, which is removed to allow for City views.

Shade loving plant species to the south side of the building, such as native Blue Tongue, Xanadu and Clivia miniata 'Cream', over Silver Spur Flower & Kidneyweed, to cascade over planter edges and soften the builtform.

Access to these planters is available from the Level 02 service area. Narrower podium planters to the west and north faces of the building to be maintained via abseiling methods.

27/02/26	C	Information Request Issue	AL
24/11/25	B	Information Request Issue	AL
17/03/25	A	DA Lodgement Issue	AL
Date	Issue	Details	Checked



ARCHITECTS  
 TOWN PLANNERS  
 INTERIOR DESIGNERS

3 / 709 MAIN STREET  
 KANGAROO POINT QLD 4169

P + 61 7 3 8 5 2 3 1 9 0  
 E reception@halarchitects.com.au  
 W www.halarchitects.com.au

Project  
**Multi-Residential Apartment**

70 Sylvan Road  
 Toowong  
 QLD 4066

Drawing Title  
**Landscape Concept Plan - Level 02 - 13**

Scale @ A3	Drawn:	Checked:
1:200	SC	AL
Project Number	Drawing Number	Issue
H4899SYL	L005	C

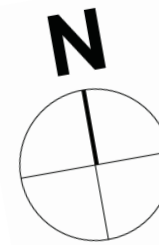

LANDSCAPE

General Notes

This drawing is Copyright © Any design or drawing is not to be reproduced, either in whole or part, without written permission by Hayes Anderson Lynch Architects Pty. Ltd. Confirm all dimensions on site. Do not scale off drawings. All levels are approximate only and are subject to confirmation by licensed surveyor. All workmanship, materials and construction to comply with the Queensland Building Act 1975-2011 and The Building Code of Australia 2015, Premises Standard and AS1428.1. Work to be carried out in a neat and appropriate manner. Where ambiguities or discrepancies exist, Hayes Anderson Lynch Architects Pty. Ltd. shall be contacted for clarification. These drawings have been prepared by a registered landscape architect. This is a concept plan for Development Approvals only. Landscape Compliance Certification necessary for Building Approval stage of development.

BCC DS  
RECEIVED  
03/03/2026  
APPLICATION REF  
A006737871

SYLVAN ROAD

JEPHSON STREET



Low leaf drop evergreen species to pool surround. Pool safety setbacks applied to planting design.

Small canopy **ornamental trees** to large podium planters, such as flowering evergreen natives: Little Evodia (*Melicope rubra*) and Native Gardenias (*Atractocarpus fitzalanii*) underplanted with cascading plants to soften the raised planters. Deep raised planters allow for large trees and palms to grow to a substantial future size, refer to planter depths indicated on plans and planter details on drawing L007 and species on drawing L008.

The majority of landscape maintenance is to be performed from Roof Terrace level. Where abseiling from anchor points is required, to the northwest corner planter, fall arrest equipment is to be provided, by others, for landscape maintenance, to ensure safety at height, and designed by accredited safety consultant in accordance with Worksafe requirements and Australian Standards.

Synthetic turf lawn maintained as a secluded multipurpose open space, fringed with garden beds.

Climbing vines on trellis screen

Artist's impression, refer architectural drawings. Plant species indicative only.



Flowering climbing vine species to adorn open pergola structure, over alfresco dining area.

Large central deep raised planter, 1200mm depth to accommodate small canopy ornamental shade trees, underplanted with native grasses and creeping groundcover for movement and texture.

Flowering climbing vine species to adorn open pergola structure, over open lawn area with bench seating.

Synthetic turf lawn maintained as a multipurpose open space, fringed with garden beds with ornamental trees for shade.

Podium planters with cascading groundcover species.

Communal raised planters, suggested for use for herbs, fruit, vegetables and annual flower gardens.

27/02/26	C	Information Request Issue	AL
24/11/25	B	Information Request Issue	AL
17/03/25	A	DA Lodgement Issue	AL
Date	Issue	Details	Checked

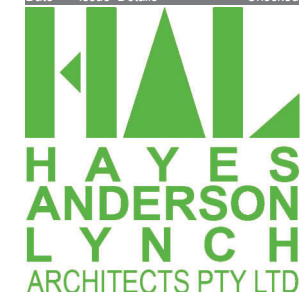

ARCHITECTS  
TOWN PLANNERS  
INTERIOR DESIGNERS

3 / 709 MAIN STREET  
KANGAROO POINT QLD 4169

P + 61 7 3 8 5 2 3 1 9 0  
E reception@halarchitects.com.au  
W www.halarchitects.com.au

Project  
Multi-Residential Apartment

70 Sylvan Road  
Toowong  
QLD 4066

Drawing Title		
Landscape Concept Plan - Roof Terrace		
Scale @ A3	Drawn:	Checked:
1:200	SC	AL
Project Number	Drawing Number	Issue
H4899SYL	L006	C

TIERED PLANTING TO PODIUM PLANTERS

TIERED PLANTING TO PODIUM PLANTERS OF VARYING PLANT SIZE, FORM, COLOUR & TEXTURE. PLANT SPECIES SHOWN ARE INDICATIVE ONLY, REFER TO PLANT SPECIES ON DRAWING L008.

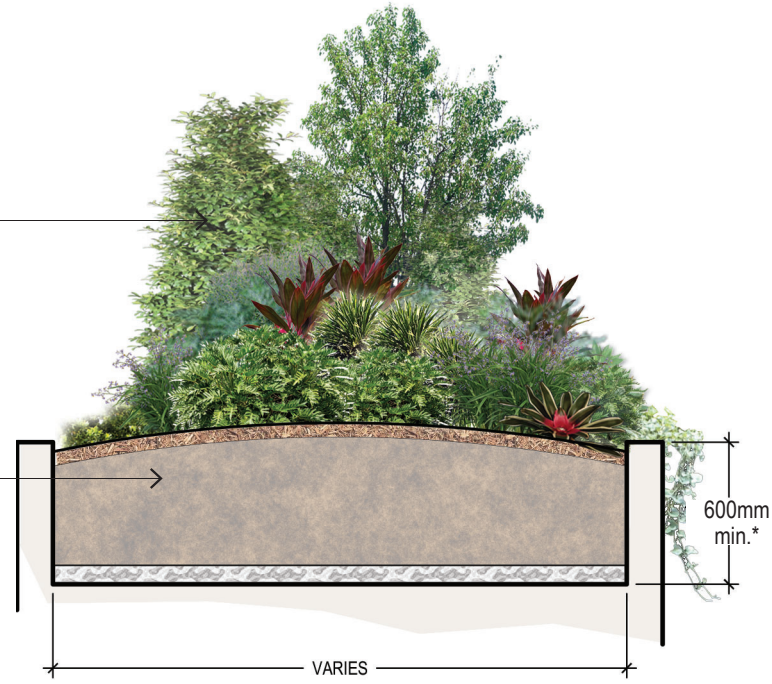

REFER TO PODIUM PLANTER DETAIL BELOW FOR SOIL / MULCH / DRAINAGE AND WATERPROOFING.

**A** TYPICAL PODIUM PLANTER SECTION NTS

\* = Refer to drawings L002, L004 - L006 for planter depths on plans.

NOTE: WATERPROOFING / IRRIGATION & DRAINAGE CONNECTIONS (CONNECTED TO NEAREST SW LINE) ARE INSTALLED TO ALL RAISED PLANTERS.

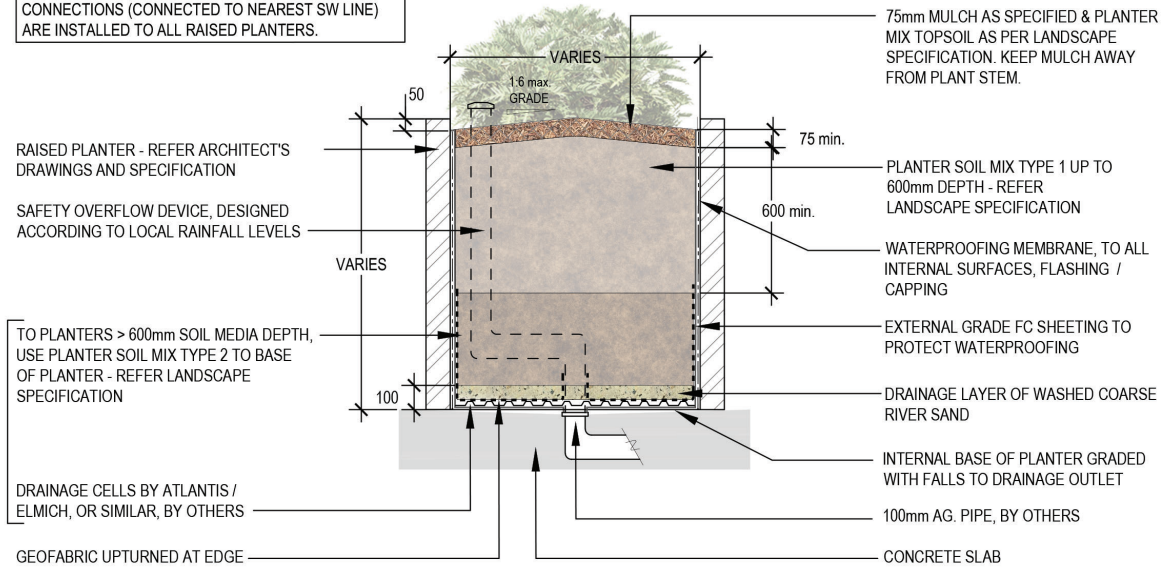

**B** TYPICAL PODIUM PLANTER DETAIL NTS

SOFTSCAPE + GROUND DETAILS

TREE PLANTING - TYPICAL

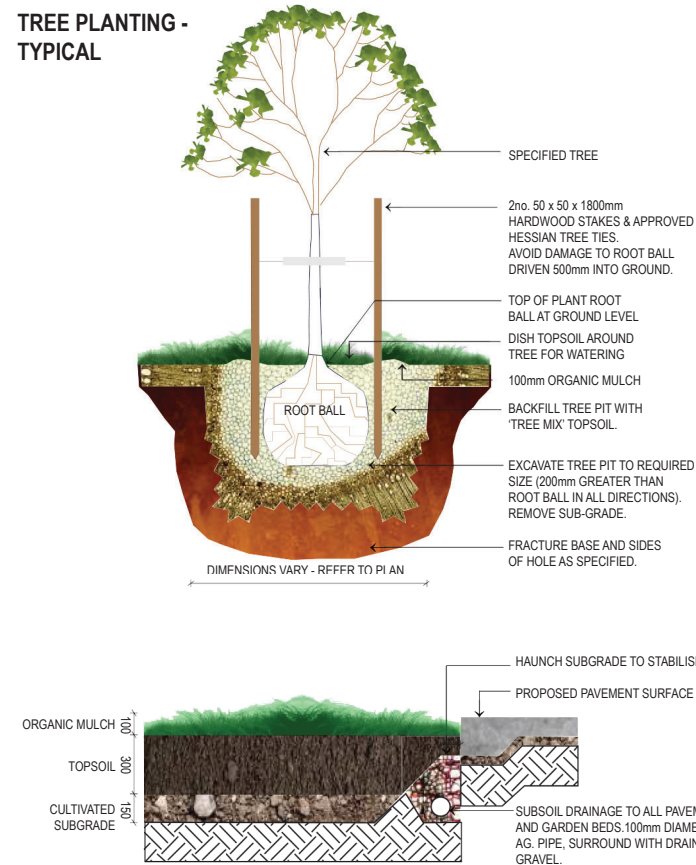

PLANTING TO PAVEMENTS - TYPICAL

PALM PLANTING - TYPICAL

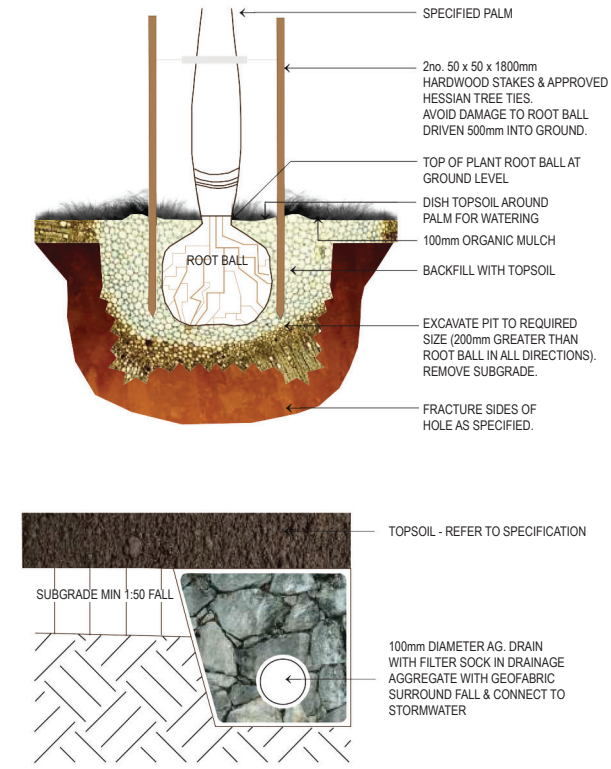

100mm SUBSURFACE DRAINAGE

LANDSCAPE MAINTENANCE SCHEDULE FOR PODIUM PLANTING & GREEN FAÇADES		
	Measure	Frequency
<b>Fertilise</b>	Apply organic fertiliser, at manufacturers' rates to ensure healthy plants.	Annually in September and as required.
<b>Plant Health</b>	Inspect plants for signs of decay, fungal or insect attack. Use organic pesticides / fungicides, at minimum rates, as per manufacturer's specification, as necessary. Continue application for 2 weeks once resolved, to avoid relapse.	Monthly inspection - apply as required.
<b>Mulching</b>	Reapplication of even layer of organic mulch, to maintain depth as specified on Landscape Plan. Remove mulch from adjacent areas, or to gully pits if dispersal occurs.	Biennially (once every two years) in Sept and as required.
<b>Weed Removal</b>	Weeding by hand or with approved organic herbicide. Responsible disposal of waste.	Monthly inspection - apply as required.
<b>Litter Removal</b>	Remove litter manually. Responsible disposal of waste.	Monthly, or as required.
<b>Pruning</b>	Inspect all plants. Trim back plants and encourage dense growth and allow air flow. Generally prune plants after flowering. Prune back over long leaders from groundcover plants.	End of Spring, monthly in Summer & as required due to seasonal conditions.
<b>Plant Replacement</b>	Replace plants as required, as per Landscape Plan, due to failure / plant deterioration. Record location and reason for replacement within a log book and monitor to evaluate whether plant species specification requires adjustment.	Monthly inspection - replace as required.
<b>Irrigation / Watering</b>	Initial regular watering schedule to be instigated upon installation to ensure plant establishment. Maintain and regularly check the installed drip irrigation system, associated automatic controller, pump, backflow, pressure reducers and filters. All plumbing and electrical works are to be maintained in accordance with relevant standards & BCC requirements. Monitor soil saturation to preclude overwatering. Automated programming to be adjusted seasonally. All servicing is to be recorded in a log book. Automated irrigation to be ceased during times of prolonged wet weather.	Fortnightly inspections September to March and monthly inspections April to August. Annual maintenance, or more as required.
<b>Drainage</b>	Soil saturation is to be monitored to ensure that the planter is draining effectively. Drains to be checked for obstructions.	Monthly inspection & as required due to seasonal conditions.
<b>Structure</b>	Inspection and maintenance of all built structures to ensure structural integrity (proposed building and trellis wires / fixtures) to ensure structural integrity. Adjust wire tensioners, if necessary, annually to ensure a taut structure to support plant growth.	Monthly inspection and as required.
<b>Safety</b>	Fall arrest equipment to be provided for landscape maintenance to upper levels (Podium Level 02 and above), & designed by accredited safety consultant in accordance with Worksafe requirements and Australian Standards. Garden maintenance is NOT to be performed by leaning over planter wall / climbing into planter, at height, without adequate safety equipment.	Regular inspections of safety equipment, as specified by certified safety advisor. Use of safety equipment by all operators, at all times.

LANDSCAPE

General Notes

This drawing is Copyright © Any design or drawing is not to be reproduced, either in whole or part, without written permission by Hayes Anderson Lynch Architects Pty. Ltd. Confirm all dimensions on site. Do not scale off drawings. All levels are approximate only and are subject to confirmation by licensed surveyor. All workmanship, materials and construction to comply with the Queensland Building Act 1975-2011 and The Building Code of Australia 2015, Premises Standard and AS1428.1. Work to be carried out in a neat and appropriate manner. Where ambiguities or discrepancies exist, Hayes Anderson Lynch Architects Pty. Ltd. shall be contacted for clarification. These drawings have been prepared by a registered landscape architect. This is a concept plan for Development Approvals only. Landscape Compliance Certification necessary for Building Approval stage of development.

BCC DS RECEIVED 03/03/2026 APPLICATION REF A006737871

Date	Issue Details	Checked
27/02/26	C Information Request Issue	AL
24/11/25	B Information Request Issue	AL
17/03/25	A DA Lodgement Issue	AL



ARCHITECTS  
TOWN PLANNERS  
INTERIOR DESIGNERS

3 / 709 MAIN STREET  
KANGAROO POINT QLD 4169

P + 61 7 3852 3190  
E reception@halarchitects.com.au  
W www.halarchitects.com.au

Project  
Multi-Residential Apartment

70 Sylvan Road  
Toowong  
QLD 4066

Drawing Title  
Landscape Concept - Details

Scale @ A3 Drawn: NTS Checked: SC AL  
Project Number Drawing Number Issue  
H4899SYL L007 C

LANDSCAPE CONCEPT \_ PLANT SPECIES PALETTE \_ 70 Sylvan Road, Toowong



Plant selection of resilient, drought tolerant, low maintenance species. Predominantly native tree, palm and mid storey vegetation, over a broad mix of native and exotic species to suit the climate & specific site conditions.

**PLANTING ZONE CODES**

- F = Frontage planting to natural ground
- S = Shade planting to podium planters, beneath building & to rear (southern façade)
- R = Rooftop and podium planting - Full Sun
- P = Narrow Podium planters to north, and west façade < 600mm width

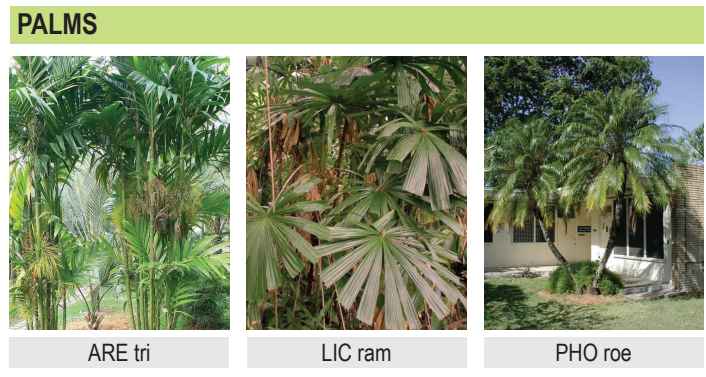

Planting densities to provide ground coverage within two years of planting: generally groundcover & understorey planting at 2 - 5 plants / m<sup>2</sup>

PLANT SPECIES LIST 70 Sylvan Road, Toowong								
Code	Botanical Name	Common Name	Pot Size	Plant Zones				additional information
				F	S	R	P	
<b>TREES</b>								
ACR imp	<i>Acronychia imperforata</i>	Fraser Island Apple	45L	F		R		
ALL fla	<i>Alloxylon flammeum</i>	Queensland Tree Waratah	100L	F				feature tree
ATR fit	<i>Atractocarpus fitzalanii</i>	Native Gardenia	45L	F		R		
CAL HR	<i>Callistemon 'Hannah Ray'</i>	Bottlebrush	45L					street tree
ELA ret	<i>Elaeocarpus reticulatus 'White'</i>	White Blueberry Ash	45L	F				
LAG Nat	<i>Lagerstroemia indica 'Natchez'</i>	White Crepe Myrtle	45L	F				
MEL rub	<i>Melicope rubra</i>	Little Evodia	45L	F		R		
<b>PALMS</b>								
ARE tri	<i>Areca triandra</i>	Clumping Betel Nut	45L		S			
LIC ram	<i>Licuala ramsayi</i>	Queensland Fan Palm	100L		S			
PHO roe	<i>Phoenix roebelenii - multi-stem</i>	Pygmy Date Palm	45L	F		R	P	
PRI hil	<i>Pritchardia hillebrandii</i>	Hawaiian Fan Palm	45L			R		
<b>MIDDLESTOREY SHRUBS / VEGETATIVE SCREENING</b>								
ALP cae	<i>Alpinia caerulea</i>	Native Ginger	200mm		S			
BAC myr	<i>Bachousia myrtifolia</i>	Cinnamon Myrtle	200mm	F		R		
GRE OM	<i>Grevillea 'Orange Marmalade'</i>	Orange Grevillea	300mm	F				
MEL aff	<i>Melastoma affine</i>	Blue Tongue	200mm		S			
PHI sel	<i>Philodendron selloum</i>	Tree Philodendron	200mm	F	S			
RHA exc	<i>Rhapis excelsa</i>	Lady Palm	400mm		S			
<b>FEATURE PLANTS</b>								
AGA att	<i>Agave attenuata</i>	Foxtail Plant	200mm	F		R	P	
ALO mac	<i>Alocasia macrorrhiza</i>	Giant taro	300mm		S			
ALO OO	<i>Aloe 'Outback Orange'</i>	Orange Flowering Aloe	200mm	F		R		
CYA coo	<i>Cyathea cooperi</i>	Tree Fern	300mm		S			
STR reg	<i>Strelitzia reginae</i>	Bird of Paradise	200mm	F		R		
ZAM fur	<i>Zamia furfuracea</i>	Cardboard Plant	200mm	F		R		
<b>UNDERSTOREY SHRUBS</b>								
ALP nut	<i>Alpinia nutans</i>	Dwarf Cardamon	200mm	F	S			
BLE gib	<i>Blechnum gibbum</i>	Silver Lady Fern	140mm		S			
CAR ds	<i>Carissa 'Desert Star'</i>	Natal Plum	200mm	F		R	P	
COR spp.	<i>Cordyline mixed species</i>	Cordyline	200mm		S			
CTE GS	<i>Ctenanthe setosa 'Grey Star'</i>	Grey Never Never Plant	200mm		S			
DRA Var	<i>Dracaena reflexa 'Variegata'</i>	Song of India	200mm		S		P	
KAL org	<i>Kalanchoe orgyalis</i>	Copper Spoons	200mm	F		R	P	
LIG ren	<i>Ligularia reniformis</i>	Tractor Seat Plant	200mm		S			
PHI Xan	<i>Philodendron 'Xanadu'</i>	Xanadu	200mm	F	S			
WES fru	<i>Westringia fruticosa</i>	Coastal Native Rosemary	200mm	F			P	
<b>GROUND COVER PLANTS</b>								
ALO Top	<i>Aloe 'Topaz'</i>	Aloe 'Topaz'	140mm	F		R	P	
CAS Cit	<i>Casuarina 'Cousin It'</i>	Groundcover Sheoak	140mm	F		R	P	cascading
CLI min	<i>Clivea miniata 'Cream'</i>	Cream Natal Lily	140mm		S			
DIA LJ	<i>Dianella 'Little Jess'</i>	Little Jess Flax Lily	140mm	F	S	R	P	
DIC rep	<i>Dichondra repens</i>	Emerald Falls	140mm		S		P	cascading
GOO ova	<i>Goodenia ovata 'Prostrate'</i>	Creeping Hop Goodenia	140mm	F		R	P	cascading
GRE CC	<i>Grevillea 'Cooroora Cascade'</i>	Gold Cascading Grevillea	200mm	F		R	P	
LOM LT	<i>Lomandra 'Lime Tuff'</i>	Just Right Lilyturf	140mm	F		R	P	
MYO par	<i>Myoporum parvifolium</i>	Creeping Boobiella	140mm	F		R	P	cascading
NEO gra	<i>Neomarica gracilis</i>	Walking Iris	140mm		S			
NEO spp.	<i>Neoregelia species</i>	Bromeliad mixed species	140mm		S			
PLE arg	<i>Plectranthus argentatus</i>	Silver Spurflower	140mm		S			cascading
PLE aus	<i>Plectranthus australis</i>	Creeping Charlie	140mm		S			cascading
SEN man	<i>Senecio mandraliscae</i>	Blue Chalk Sticks	140mm	F		R	P	cascading
VIO hed	<i>Viola hederacea</i>	Native Violet	140mm		S			
<b>CREEPING / CLIMBING VINES</b>								
CIS ant	<i>Cissus antarctica</i>	Kangaroo Vine	140mm		S			L02 cascading to rear façade
CIS ED	<i>Cissus 'Ellen Danica'</i>	Grape Ivy	140mm		S			cascading from raised planters
TRA jas	<i>Trachelospermum jasminoides</i>	Star Jasmine	140mm		S			L02 cascading to rear façade
HOY aus	<i>Hoya australis</i>	Wax Flower Vine	140mm		S			L02 cascading to rear façade
PAN pan	<i>Pandorea pandorana 'Ruby Belle'</i>	Ruby Wonga Wonga Vine	140mm			R		Façade / Roof Terrace pergola

LANDSCAPE

General Notes  
 This drawing is Copyright © Any design or drawing is not to be reproduced, either in whole or part, without written permission by Hayes Anderson Lynch Architects Pty. Ltd. Confirm all dimensions on site. Do not scale off drawings. All levels are approximate only and are subject to confirmation by licensed surveyor. All workmanship, materials and construction to comply with the Queensland Building Act 1975-2011 and The Building Code of Australia 2015, Premises Standard and AS1428.1. Work to be carried out in a neat and appropriate manner. Where ambiguities or discrepancies exist, Hayes Anderson Lynch Architects Pty. Ltd. shall be contacted for clarification. These drawings have been prepared by a registered landscape architect. This is a concept plan for Development Approvals only. Landscape Compliance Certification necessary for Building Approval stage of development.

**BCC DS**  
 RECEIVED  
 03/03/2026  
 APPLICATION REF  
 A006737871

27/02/26 C Information Request Issue AL  
 24/11/25 B Information Request Issue AL  
 17/03/25 A DA Lodgement Issue AL



Project  
**Multi-Residential Apartment**  
 70 Sylvan Road  
 Toowong  
 QLD 4066

Drawing Title  
**Landscape Concept - Plant Species Palette**  
 Scale @ A3 Drawn: Checked:  
 NTS SC AL  
 Project Number Drawing Number Issue  
**H4899SYL L008 C**