

BCC DS
RECEIVED
23/06/2026
APPLICATION REF
A007054434



This plan was prepared as a Contour Survey and should not be used for any other purpose. House Surveys Aust Pty Ltd therefore can accept no responsibility for failure to use this plan within the limitations intended.

This Contour/Detail survey should not be used to determine Ground Level for building height restrictions. Appropriate maps and methods as defined from council records should be adopted in determining the Ground Level.

Services have been plotted from a combination of surveying surface installations, locations supplied using GPR & electromagnetic devices by accredited service locators and record information.

This database is a record of site detail and services as located or compiled at the time of survey. The survey does not account for other services that may exist and have not been documented or supplied.

Caution should be exercised when excavating near any service and critical services locations and level should be confirmed with potholing by a service locator prior to construction.

Unless otherwise noted, Cadastral information contained in this dataset or shown on associated plans is vide title and subject to definition by formal Cadastral Survey. As such it is approximate only and should not be used for Design and/or construction in close proximity to the boundary.

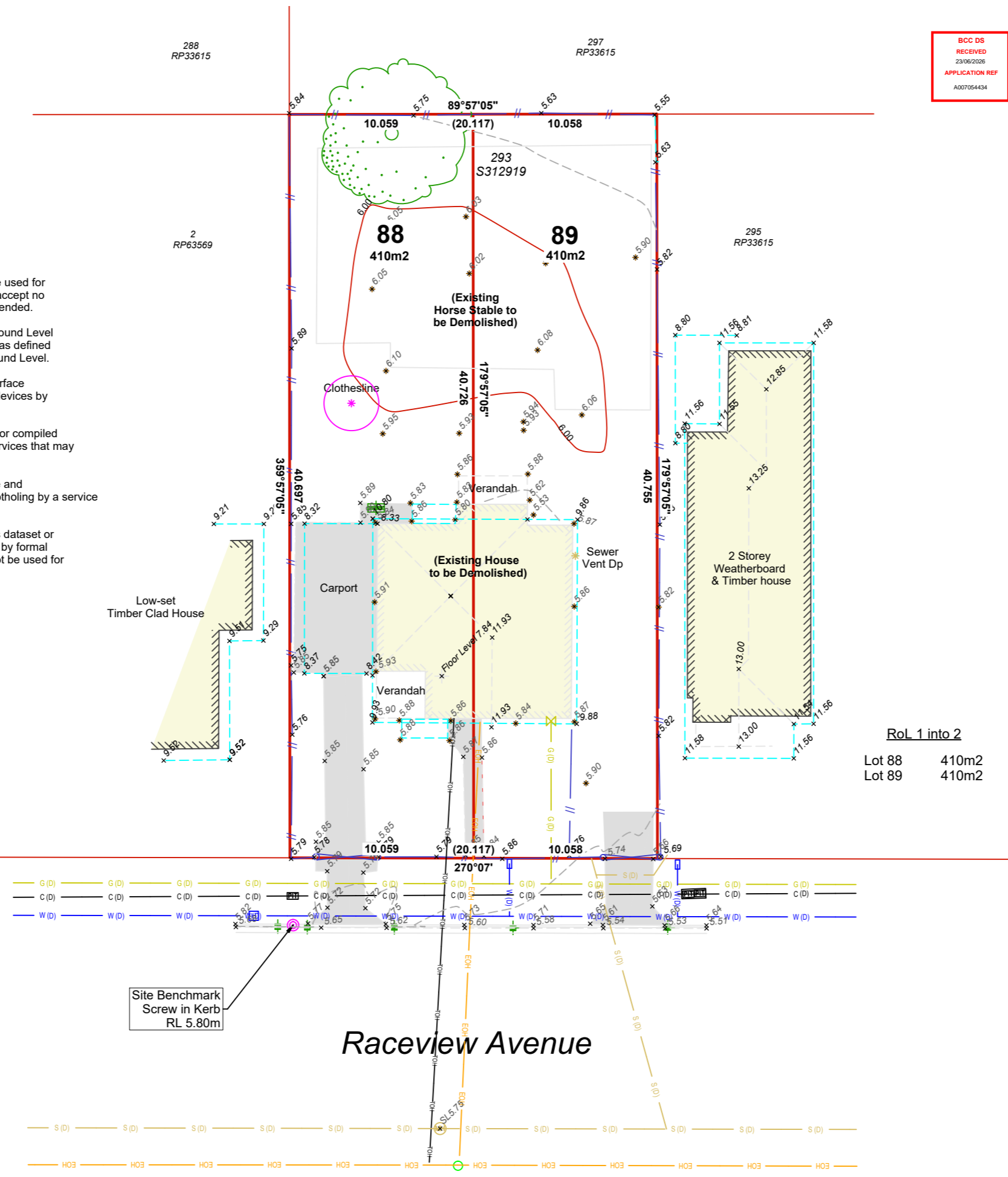

RoL 1 into 2
Lot 88 410m²
Lot 89 410m²

LEGEND:

- | | |
|--------------------|---------------------------------|
| Road | Terrain |
| Kerb Back | Driveway |
| Kerb Invert | Footpath |
| Edge of Bitumen | Slab Edge |
| Edge of Gravel | Retaining Wall Base |
| Road Crown | Retaining Wall Top |
| Traffic Park Meter | Change of Grade |
| Traffic Light | Top of Bank |
| Traffic Pit | Toe of Bank |
| Traffic Sign | Waterline |
| Traffic Post Box | Garden Edge |
| Structures | Creek Toe of Bank |
| Building Line | Creek Top of Bank |
| Roof Ridgeline | Creek Invert |
| Fence Line | Creek Waterline |
| Gate | Tree |
| Hand Rail | Tree Canopy |
| Cattle Grid | Control Point/PSM |
| Bollard | Drainage |
| Sewer | Drainage line |
| Sewer Line | Open Drain |
| Valve | Manhole |
| Inspection Opening | Field Inlet |
| Manhole | Downpipe |
| Electrical | Communications |
| Electricity Line | Communication Line |
| Overhead Line | Overhead Line |
| Pits/Manholes | Pits/Manholes |
| Pole | Pillar |
| Street Light | Gas |
| Light In-Ground | Gas Line |
| Water | Valve |
| Water Line | Marker |
| Meter | General |
| Valve | Pothole |
| Fire Hydrant | Subsurface Utility - QL |
| Tap | * (A) * QL-A (H±50mm, V±50mm) |
| Sprinkler | * (B) * QL-B (H±300mm, V±500mm) |
| Fuel | * (C) * QL-C (H±300mm, 2D) |
| Fuel Line | * (D) * QL-D (Exist Record) |
| Fitting | |

NOTES:

1. Drawn to scale on an A3 sheet.
2. Contour Interval... 0.25m
3. All levels are in metres on the Australian Height Datum referred to PSM 7637 - 8.123 AHD
4. All Boundaries are vide title and subject to confirmation by survey.
5. The Location of Underground services are in accordance with AS5488:2019, the Australian Standard for classification of Subsurface Utility Information (SUI). The exact nature and location of these services should be confirmed prior to construction.
6. Area vide title : 819m²
7. Field Survey Completed on 6/5/26

Level datum: AHD Derived (PSM 7637)
Horiz datum: PLAN (IS287167)
Coord Origin: Arbitrary (n/a)
GDA System: Not Applicable Coordinate System: Plane 1:1
Meridian: IS287167

Title:
Proposed Subdivision Plan
Lots 88 & 89 cancelling L293 on S312919
88 Raceview Ave, Hendra

Client: **Chrissy Dou**
Locality:
Local Gov: Brisbane City Council
Surveyed By: Approved:
Date Created: 28/05/26 Scale: 1:250
File Ref: H26-0665
Plan No: **H26-0665_002_DET** Rev: 1

