

**BCC DS
RECEIVED**
01/11/2022
APPLICATION REF
A006125616

Proposed VP8 Collections Area Upgrade & Southern Road Repair

168 Paringa Road, Murarrie, QLD

GENERAL NOTES :-

- LEVELS ARE TO AUSTRALIAN HEIGHT DATUM (A.R.H.D.).
- DRAWINGS TO BE READ IN CONJUNCTION WITH ARCHITECT'S, STRUCTURAL ENGINEER'S AND OTHER CONSULTANTS DRAWINGS.
- BUILDER TO CONFIRM LOCATION AND VERIFY THE SIZE AND DEPTH OF ALL EXISTING DRAINS AND SERVICES PRIOR TO COMMENCEMENT OF ANY WORKS ON SITE AND IS TO ALLOW FOR RELOCATION IN REQUIRED. BUILDER SHALL MAKE ALL APPLICATIONS AND PAY ALL FEES AND CHARGES RELEVANT TO THE APPLICABLE AUTHORITY.
- THE BUILDER IS TO CHECK THE SETOUT OF ALL PROPOSED AND EXISTING DRAINS AND SERVICES AND IS TO REPORT ANY CLASHES OR DISCREPANCIES IN THE SETOUT OF PIPE WORK TO THE CIVIL ENGINEER. DESPITE OUR BEST EFFORTS, THIS OFFICE MAY NOT BE IN POSSESSION OF ALL INFORMATION DETAILING EXISTING SERVICES AT THE TIME OF ISSUE. WHERE SERVICES NEED TO BE RELOCATED, THE BUILDER SHALL MAKE ALL APPLICATIONS AND PAY ALL FEES AND CHARGES RELEVANT TO THE APPLICABLE AUTHORITY.
- ANY PROPRIETARY PRODUCTS THAT ARE SPECIFIED ON THESE DRAWINGS (OR APPROVED BY THIS OFFICE) ARE TO BE INSTALLED IN ACCORDANCE WITH MANUFACTURER'S DETAILS AND SPECIFICATIONS.
- MATERIAL OR COMPONENT SUBSTITUTIONS SHALL NOT BE MADE WITHOUT PRIOR APPROVAL FROM THIS OFFICE.
- THE WORKS SHALL COMPLY IN EVERY WAY WITH THE REQUIREMENTS OF ANY AUTHORITY HAVING JURISDICTION OVER THEM WORK NOT COVERED BY THE REQUIREMENTS OF THE STATUTORY AUTHORITIES SHALL COMPLY WITH THE RELEVANT AUSTRALIAN STANDARDS.
- DRAINAGE PIPES TO BE AS SPECIFIED ON DRAWING:
 - PIPES 300mm AND SMALLER TO BE UPVC SEWER QUALITY S/NB (MIN. U.N.O.) WITH RUBBER RING OR SOLVENT WELDED JOINTS.
 - PIPES LARGER THAN 300mm TO BE R.C.P. CLASS 2 (MIN. U.N.O.), F.R.C.P. CLASS 2 (MIN. U.N.O.) OR STORMDRAIN (OR EQUIVALENT) WITH RUBBER RING JOINTS.

(NO PIPES BELOW COMPACTES COLLECTING FUEL SPILLAGE AND DISCHARGING INTO THE PARAPET TO BE HOPE PENN PIPE STRIP (MIN. U.N.O.) WITH ELECTRIFICATION OR NOT WELDED JOINTS.

 - NO SUBSTITUTIONS ARE ALLOWED WITHOUT PRIOR APPROVAL FROM THIS OFFICE.
- ALL DOWNPIPES TO BE 100mm UPVC MIN. (U.N.O.) & THEIR CONNECTIONS TO UNDERGROUND DRAINS TO BE 100mm UPVC MIN. (U.N.O.), USE FLEXIBLE CONNECTION OR SLEEV JOINT BETWEEN DOWNPIPE & UNDERGROUND DRAIN TO ALLOW FOR POSSIBLE SETTLEMENT. **REFER TO HYDRAULIC STRATEGY CONSULTANT DRAWINGS FOR DOWNPIPE SIZES.**
- ALL DRAINAGE DOWNPIPES SHALL RUN VERTICALLY ONLY. ANY NON-VERTICAL DOWNPIPES SHALL BE TREATED AS SUSPENDED DRAINS AND HANGERS OR CRACKLES SHALL BE INSTALLED AT 1m SPACINGS AND CHECKED BY THE STRUCTURAL ENGINEER FOR IMPACT ON THE STRUCTURE.
- ALL SUSPENDED DRAINAGE PIPES TO BE UPVC SEWER QUALITY S/NB (MIN. U.N.O.) OR SIMILAR APPROVED.
- UNLESS OTHERWISE NOTED ALL 150mm UPVC DRAINS TO BE LAID NOT FLATTER THAN 1 IN 100.
 - 450mm MIN. COVER UNDER LANDSCAPING & PATHS.
 - 600mm MIN. COVER UNDER PAVED AREAS.
- (A) DRAINAGE PIPES TO BE BEDDED ON 100mm COMPACTED THICKNESS OF FINE CRUSHED ROCK.
 - DRAINAGE PIPES IN EXTERNAL PAVED AREAS ARE TO BE FULLY BACKFILLED WITH COMPACTED CLASS 1 FINE CRUSHED ROCK.
 - DRAINAGE PIPES UNDER BUILDING SLAB TO BE FULLY BACKFILLED WITH COMPACTED CLASS 2 FINE CRUSHED ROCK.
 - DRAINAGE PIPES IN UNPAVED AREAS TO BE FULLY BACKFILLED WITH COMPACTED FINE CRUSHED ROCK TO PROVIDE 150mm CLEAR COVER OVER PIPE, THEN BACKFILLED AND COMPACTED WITH BEST EXCAVATED WELL GRADED MATERIAL.
 - WHERE EXISTING DRAINS PASS UNDER PROPOSED PAVEMENTS / SLABS THE CAPACITY OF THE BACKFILL TO SUPPORT THE PAVEMENT / SLAB IS TO BE APPROVED BY THE GEOTECHNICAL ENGINEER.
 - REFER ALSO TO TRENCH BACKFILL DETAILS.
- BUILDER SHALL REINSTATE ALL EXISTING ASSETS AFFECTED BY THE WORKS AND MAKE GOOD TO EXISTING CONDITIONS TO THE SATISFACTION OF THE CLIENT & RELEVANT AUTHORITIES.
- THE BUILDER IS TO PROVIDE AN EROSION CONTROL PLAN THAT IS TO THE SATISFACTION OF THE RESPONSIBLE AUTHORITY THAT DEMONSTRATES THERE IS NO DISCHARGE OF SEDIMENT FROM THIS SITE DURING CONSTRUCTION.
- THESE DRAWINGS HAVE BEEN PRODUCED WITH OUR BEST POSSIBLE CARE AND ACCURACY TOWARDS A SYMBOLOGICAL DEFINITION OF THE CIVIL ASPECTS OF THE PROJECT. CARE MUST BE TAKEN WHEN INTERPRETING INFORMATION FROM THESE DRAWINGS AS THEY ARE SCHEMATIC DRAWINGS ONLY & MAY NOT BE ACCURATE FOR THE PURPOSES INTENDED BY ANY SUCH THIRD PARTY. ALL SET-OUT INFORMATION SHOULD BE TAKEN FROM THE ARCHITECTURAL DRAWINGS.
- THESE DRAWINGS HAVE BEEN CREATED USING AUTODESK CIVIL 3D. AUTODESK CIVIL 3D MAY NOT BE COMPATIBLE WITH OTHER CAD SOFTWARE THEREFORE, WE CANNOT GUARANTEE THAT ALL INFORMATION IF USED IN DWG FORMAT WILL BE DISPLAYED IF THESE DRAWINGS ARE USED IN A PROGRAM OTHER THAN AUTODESK CIVIL 3D.

PREPARATION OF SUBGRADE :-

- THE SUBGRADE PREPARATION AND EARTHWORKS ARE TO BE READ IN CONJUNCTION WITH THE SOIL REPORT PREPARED BY [XXXXXXXXXXXXXXXXXXXX](#) AND AS3798.
- COMPACTION TESTING OF THE SUBGRADE AND EARTHWORKS SHALL BE CARRIED OUT IN ACCORDANCE WITH THE "FREQUENCY OF FIELD DENSITY TESTS" AS3798 TABLE B.1 AND "METHOD OF TESTING SOILS FOR ENGINEERING PURPOSES" AS1289. THEY ARE TO BE TESTED BY AN APPROVED GEOTECHNICAL ENGINEER WHO WILL BE REQUIRED TO ISSUE A COMPLIANCE CERTIFICATE THAT THE WORKS HAVE BEEN COMPLETED TO THE STANDARD SPECIFIED.
- ALL GRASS, TOPSOIL AND ORGANIC MATTER IS TO BE REMOVED UNDER ALL BUILDING AND PAVEMENT AREAS.
- CUT AND FILL IS REQUIRED TO PRODUCE FINISHED SURFACE LEVELS AS SPECIFIED MINUS THE PAVEMENT THICKNESS AS INDICATED ON THE DRAWINGS.
- ALL FILLING IS TO BE LAID IN 150mm MAXIMUM LAYERS AND COMPACTED TO 98% STANDARD COMPACTION DENSITY. THE GEOTECHNICAL ENGINEER IS TO APPROVE THE MATERIAL USED FOR FILLING AND IS TO SUPERVISE PLACING OF COMPACTED FILL.
- THE FILL SHALL BE CLEAN WELL GRADED MATERIAL TO HAVE A MIN. STANDARD CBR VALUE OF 1% AND A MAX. PLASTICITY INDEX OF 1%. THE MAX. PARTICLE SIZE TO BE LESS THAN 150mm. THIS IS TO BE PLACED IN ACCORDANCE WITH AS3798.
- PROOF ROLL THE SUBGRADE SURFACE WITH A 10 TONNE STATIC WEIGHT SHEEP'S FOOT VIBRATING ROLLER AND REPLACE ANY SOFT SPOTS.

SLAB & PAVEMENT MAINTENANCE NOTES :-

- THE BUILDING SLABS AND EXTERNAL PAVEMENTS SHALL BE MAINTAINED IN ORDER TO COMPLY WITH OCCUPATIONAL HEALTH AND SAFETY REQUIREMENTS.
- A MONITORING PROGRAM SPECIFICALLY RELATED TO SLABS AND EXTERNAL PAVEMENTS SHALL BE UNDERTAKEN WHICH INCORPORATES REGULAR INSPECTIONS AT FREQUENCIES NOT LESS THAN THE FOLLOWING:

TIME PERIOD	FREQUENCY	ACTION
YEAR 1	3 MONTHLY	REPAIR AS REQUIRED
YEAR 2	6 MONTHLY	REPAIR AS REQUIRED
YEAR 3+	ANNUALLY	REPAIR AS REQUIRED
- RECTIFY JOINT FILLERS/SEALANTS AS SOON AS POSSIBLE IF THE SEALANT DISPENSES FROM THE CONCRETE. TENANT/OCCUPIER MAINTENANCE PERSONNEL SHOULD BE SUITABLY TRAINED TO UNDERTAKE IMMEDIATE REPAIRS OR ENGAGE SPECIALIST CONTRACTORS TO CARRY OUT THE WORK.
- THERE ARE GENERAL MAINTENANCE PRINCIPLES THAT NEED TO BE ADOPTED TO MINIMISE BUILDING, SLAB AND PAVEMENT DAMAGE CAUSED BY SOIL MOVEMENT. BUILDINGS, SLABS & PAVEMENTS CAN BE MOVED UP, DOWN, LATERALLY OR ROTATIONALLY AND SOME MOVEMENT IS TO BE EXPECTED. THIS MOVEMENT CAN BE CAUSED BY 'CONDENS' IN THE SOIL. MOISTURE CONTENT OR BY EROSION. SANDY SOILS ARE MORE SUSCEPTIBLE TO EROSION AND CLAY SOILS ARE SUSCEPTIBLE TO VOLUME CHANGE (SWELL OR SHRINKAGE) DUE TO SOIL MOISTURE CHANGES.

IN ORDER TO MINIMISE MOVEMENTS IT IS EXTREMELY IMPORTANT THAT THE TENANT / OWNER OCCUPIER:

 - PREVENT DAMAGE TO, AND PROPERLY MAINTAIN ANY WATER SERVICES THAT COULD LEAK INTO THE SOIL EITHER UNDER OR ADJACENT TO THE SLAB/PAVEMENT. ANY LEAKS MUST BE REPAIRED IMMEDIATELY.
 - DOES NOT PLANT ANY TREE OR LARGE SHRUB CLOSER THAN 1.5 x MATURE HEIGHT TO A BUILDING EDGE. ANY PLANTS THAT REQUIRE AUTOMATIC IRRIGATION SYSTEMS SHALL BE LOCATED IN GARDEN BEDS WHICH ARE AN APPROPRIATE DISTANCE AWAY FROM THE BUILDING OR PAVEMENT EDGE BASED ON THE SPECIFIC SOIL TYPE.
 - PROVIDE A ROOT BARRIER AROUND ANY TREE OR LARGE SHRUB THAT IS PLANTED CLOSER THAN 1/3 x MATURE HEIGHT TO A PAVEMENT EDGE.
 - MAINTAIN PAVEMENT SEALANTS, INCLUDING THOSE BETWEEN PAVEMENTS AND BUILDING EDGES. IN ORDER TO PREVENT WATER BEING INTRODUCED TO THE SOIL, NOTE THAT PAVEMENTS ADJACENT TO BUILDING EDGES ARE OFTEN THERE AS PART OF THE DESIGN TO MINIMISE SOIL MOISTURE CHANGES UNDER A BUILDING.
 - IN LANDSCAPE AREAS ENSURE THAT THE SURFACE FALLS AWAY FROM BUILDING AND PAVEMENT EDGES AT 1 IN 20 MINIMUM SLOPE FOR THE FIRST 2 METRES. ALL SURFACE WATER SHALL DRAIN VIA A SWALE OR STORM DRAINAGE THAT IS CONNECTED TO THE SITE STORMWATER DRAINAGE SYSTEM.
- FOR CONCRETE SLABS AND PAVEMENTS :-**
 - SHRINKAGE CONTINUES TO OCCUR OVER THE LIFE OF THE SLAB/PAVEMENT WHICH REQUIRES REGULAR MONITORING AND NECESSITATES REPAIR AND REPLACEMENT OF JOINT SEALANTS. INITIAL SEALANTS GENERALLY HAVE LARGE EXPANSIVE PROPERTIES TO COPE WITH JOINT GAP GROWTH BUT WILL NEED TO BE REPLACED WHEN THE RECOMMENDED EXPANSION LIMIT IS REACHED. IT IS EXPECTED THAT THE INITIAL SEALANTS ARE LIKELY TO REQUIRE REPLACEMENT AFTER 12-24 MONTHS WITH A 3000-KG/CM SEALANT.
 - CRACKS THAT OCCUR OVER THE BUILDING LIFETIME WHICH ARE GREATER THAN 1.0mm IN WIDTH SHOULD BE REPAIRED TO PREVENT LOCALISED FRETTING AND CRACK PROPAGATION. THE REPAIR SHALL BE CARRIED OUT USING AN APPROVED MATERIAL AND METHOD (EG. EPOXY INJECTION BY AN EXPERIENCED OPERATOR).
 - DAMAGED JOINT EDGES OR ACCIDENTAL DAMAGE TO THE CONCRETE SURFACE SHALL BE REPAIRED AS SOON AS POSSIBLE IN ACCORDANCE WITH DETAILS PROVIDED BY A STRUCTURAL ENGINEER.
 - CRACKS IN FLEXIBLE PAVEMENTS SHALL BE SEALED IMMEDIATELY TO PREVENT MOISTURE INFILTRATION OR EXITING THE SUBGRADE. THE INTERSECT BETWEEN THE CONCRETE AND BITUMEN PAVEMENTS SHALL BE SEALED AS SOON AS POSSIBLE IF A GAP OCCURS.
 - AGRICULTURAL DRAIN PIPES (A.G.) SHALL BE REGULARLY CLEANED TO MAINTAIN SUFFICIENT DRAINAGE. BLOCKED A.G. DRAINS ARE LIKELY TO RESULT IN DAMAGE TO THE SUBGRADE AND SUBSEQUENTLY THE PAVEMENT.



SITE LOCALITY PLAN
N.T.S.

EXISTING CONDITIONS :-

THE BUILDER IS TO CHECK & CONFIRM THAT THE EXISTING DRAINAGE SYSTEM, INCLUDING BUT NOT LIMITED TO PIPE SIZE, GRADE, INVERT LEVELS & DIRECTION OF FLOW, MATCHES THE ASSUMPTIONS MADE ON OUR DRAWINGS. SHOULD THE EXISTING DRAINAGE SYSTEM BE DIFFERENT IN ANY WAY, THE ENGINEER IS TO BE NOTIFIED FOR INSPECTION AND/OR APPROVAL OF ALTERNATIVE DESIGN.

SPOT LEVELS :-

ALL SPOT LEVELS SHOWN ARE TO BE CHECKED ON SITE PRIOR TO CONSTRUCTION TO ENSURE THE EXISTING LEVELS INTERACT WITH PROPOSED SPOT LEVELS AND THAT OVERLAND FLOW CAN ACHIEVED AS DESIGNED DURING FLOODS. IF PROPOSED SPOT LEVELS DON'T MATCH THE EXISTING CONDITIONS, NOTIFY THIS OFFICE FOR ALTERNATE DESIGN.

EXISTING UNDERGROUND SERVICES:-

THE LOCATIONS OF EXISTING UNDERGROUND SERVICES ARE APPROXIMATE ONLY AND THEIR EXACT DEPTH AND LOCATION SHOULD BE VERIFIED AND PROVEN ON SITE BY THE APPROPRIATE SERVICE PROVIDER PRIOR TO ANY SITE EXCAVATION. NO GUARANTEE IS GIVEN THAT ALL EXISTING SERVICES ARE SHOWN. CONTRACTOR TO TAKE PRECAUTIONS TO AVOID COLLISIONS.

EXISTING LEVELS:-

THE BUILDER IS TO CONFIRM ALL EXISTING LEVELS ON SITE PRIOR TO THE COMMENCEMENT OF WORKS AT THEIR OWN COST & ADVISE THIS OFFICE IF ANY LEVELS DIFFER TO THOSE SHOWN ON THE PLANS.

PIT No.	PIT TYPE	PIT SCHEDULE										COMMENTS		
		PIT WIDTH (mm)	PIT LENGTH (mm)	INLET DIA. (mm)	INLET I.L. (m)	OUTLET DIA. (mm)	OUTLET I.L. (m)	PIT TOP R.L. (m)	PIT DEPTH (m)	PIPE COVER (m)	COVER TYPE		STEP IRONS	
2	RETENTION PIT	6000	15000	600	2.16	600	-	-	2.50	-	-	-	YES	PROVIDE RETENTION PIT-REFER TO PLAN FOR INFORMATION-DETAILS TO BE CONFIRMED
3	GRATED	2x1500	1500	-	-	PUMP	2.18	3.15	0.97	0.37	CLASS 'D'	NO		

PRELIMINARY
THIS DRAWING IS FOR INFORMATION ONLY
NOT FOR CONSTRUCTION PURPOSES
26 October 2022

drawing index	revision history
18863-C0 GENERAL NOTES, LOCALITY PLAN & PIT SCHEDULE	
18863-C1 CIVIL WORKS LAYOUT PLAN	
18863-C2 PAVEMENT LAYOUT PLAN	
18863-C3 DETAILS - SHEET 1	
18863-C4 DETAILS - SHEET 2	
26.10.22 P4 ISSUED FOR INFORMATION	TM
24.08.22 P3 ISSUED FOR INFORMATION	TM
12.08.22 P2 ISSUED FOR INFORMATION	TM
05.08.22 P1 ISSUED FOR INFORMATION	AI

© COPYRIGHT

If any disputes or discrepancies arise from drawings transmitted electronically or otherwise, electronic drawing files and/or printed copies shall be deemed to prevail. The use of these plans and the accompanying computations for certification or construction purposes without payment of fees due to Klopfer Dobos Pty Ltd. is expressly prohibited.

If any disputes or discrepancies arise from drawings transmitted electronically or otherwise, electronic drawing files and/or printed copies shall be deemed to prevail. The use of these plans and the accompanying computations for certification or construction purposes without payment of fees due to Klopfer Dobos Pty Ltd. is expressly prohibited.

As also detail drawings (and/or subsequent construction) must be prepared with the most recent construction level structural and/or civil drawings. It is the contractor's responsibility to make certain that all drawings are the current issue.

architect/designer **VISY PAPER** TEL: (03) 9329 0806

designed **ALEX STOJANOVSKI**

drawing title **GENERAL NOTES, LOCALITY PLAN & PIT SCHEDULE**

drawn **ALLAN ABRAHAM**

scale **---** AT A0

date **JULY 2022**

revision **P4**

job/sheet number **18863-C0** 1 OF 5

KD ENGINEERING
STRUCTURAL | CIVIL

Klopfer Dobos Pty. Ltd.
ABN 11 107 284 757
166 Hoddle Street
Abbotsford Victoria 3067
t 03 9415 3000
e info@klopferdobos.com.au
www.klopferdobos.com.au

QUALITY
MANAGEMENT
SYSTEM
ISO 9001:2015

**BCC DS
RECEIVED
01/11/2022
APPLICATION REF
A006125616**

M.R.F

EXISTING CONDITIONS:
THE BUILDER IS TO CHECK & CONFIRM THAT THE EXISTING DRAINAGE SYSTEM, INCLUDING BUT NOT LIMITED TO PIPE SIZE, GRADE, INVERT LEVELS & DIRECTION OF FLOW, MATCHES THE ASSUMPTIONS MADE ON OUR DRAWINGS. SHOULD THE EXISTING DRAINAGE SYSTEM BE DIFFERENT IN ANY WAY, THE ENGINEER IS TO BE NOTIFIED FOR INSPECTION AND/OR APPROVAL OF ALTERNATIVE DESIGN.

SPOT LEVELS:
ALL SPOT LEVELS SHOWN ARE TO BE CHECKED ONSITE PRIOR TO CONSTRUCTION TO ENSURE THE EXISTING LEVELS INTERACT WITH PROPOSED SPOT LEVELS AND THAT OVERLAND FLOW CAN ACHIEVED AS DESIGNED DURING FLOODS. IF PROPOSED SPOT LEVELS DON'T MATCH THE EXISTING CONDITIONS, NOTIFY THIS OFFICE FOR ALTERNATE DESIGN.

EXISTING UNDERGROUND SERVICES:
THE LOCATIONS OF EXISTING UNDERGROUND SERVICES ARE APPROXIMATE ONLY AND THEIR EXACT DEPTH AND LOCATION SHOULD BE VERIFIED AND PROVEN ON SITE BY THE APPROPRIATE SERVICE PROVIDERS PRIOR TO ANY SITE EXCAVATION. NO GUARANTEE IS GIVEN THAT ALL EXISTING SERVICES ARE SHOWN. CONTRACTOR TO TAKE PRECAUTIONS TO AVOID CONFLICTS.

EXISTING LEVELS:
THE BUILDER IS TO CONFIRM ALL EXISTING LEVELS ON SITE PRIOR TO THE COMMENCEMENT OF WORKS AT THEIR OWN COST & ADVISE THIS OFFICE IF ANY LEVELS DIFFER TO THOSE SHOWN ON THE PLANS.

LEGEND:

(12.60)	EXISTING SURFACE CONTOUR (0.20m INTERVAL)	DP	PROPOSED DOWN PIPE
13.50	FINISHED SURFACE CONTOUR (0.1m INTERVAL)	IO	PROPOSED INSPECTION OPENING
x11.6.8	EXISTING SURFACE LEVEL	SC	PROPOSED SAW CUT
xP13.25	PROPOSED PAVEMENT LEVEL	SCD	PROPOSED SAW CUT
xF12.75	PROPOSED FINISHED SURFACE LEVEL	SCV	PROPOSED SAW CUT
[Symbol]	PROPOSED GRATED/JUNCTION PIT	CJ	PROPOSED CONSTRUCTION JOINT
[Symbol]	EXISTING DRAINAGE PIT	RW	PROPOSED RETAINING WALL
[Symbol]	PIT No. / PIT TYPE / REDUCED LEVEL	[Symbol]	PROPOSED HEAVY DUTY PAVEMENT
[Symbol]	PROPOSED GRATED TRENCH	[Symbol]	PROPOSED CRUSHED ROCK PAVEMENT
[Symbol]	PROPOSED DRAINAGE PIPE	[Symbol]	PROPOSED PEDESTRIAN PAVEMENT
[Symbol]	EXISTING DRAINAGE PIPE	[Symbol]	PROPOSED LANDSCAPING
[Symbol]	PROPOSED AG DRAIN	[Symbol]	EXISTING EASEMENT
[Symbol]	PROPOSED BATTERS		

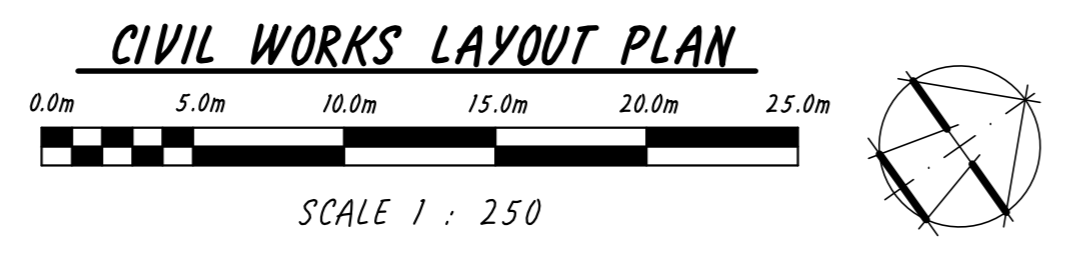

PRELIMINARY
THIS DRAWING IS FOR INFORMATION ONLY
NOT FOR CONSTRUCTION PURPOSES
26 October 2022

THIS DRAWING IS TO BE READ IN CONJUNCTION WITH THE PROJECT NOTES ON DRAWING 18861-00

DATE	DESCRIPTION	BY
26.10.22	P4 ISSUED FOR INFORMATION	TM
24.08.22	P3 ISSUED FOR INFORMATION	TM
12.08.22	P2 ISSUED FOR INFORMATION	TM
05.08.22	P1 ISSUED FOR INFORMATION	AA

revision history

© COPYRIGHT
All rights reserved. No part of these plans or accompanying computations may be reproduced or modified in any form without the written permission of Klopfer Dobos Pty. Ltd.

The use of these plans and the accompanying computations for certification or construction purposes without payment of fees due to Klopfer Dobos Pty. Ltd. is expressly prohibited.

If any disputes or discrepancies arise from drawings transmitted electronically or otherwise, including drawing files and/or printed copies stored at Klopfer Dobos Pty. Ltd. shall take precedence. Klopfer Dobos Pty. Ltd. takes no responsibility for drawings (electronic or otherwise) which may have been modified by third parties.

All other detail drawings (and/or subsequent construction) must be prepared using the correct recent construction laws structural and/or civil drawings. It is the contractor's responsibility to make certain that all drawings are the current issue.

architect/designer: **KLDP** Klopfer Dobos Pty. Ltd.
166 Hoddle Street, Adelaide Victoria 3067
t 03 9415 3000
e info@klopfersdobos.com.au
www.klopfersdobos.com.au

drawing title: **CIVIL WORKS LAYOUT PLAN**

project details: **CIVIL ENGINEERING PLANS FOR PROPOSED INDUSTRIAL DEVELOPMENT 166, PARINGA ROAD, MURARRIE, QLD**

job/sheet number: **18863-C1**

scale: **1 : 250** AT A0

date: **JULY 2022**

revision: **P4**

designed: **ALEX STOJANOVSKI**
drawn: **ALLAN ABRAHAM**

**BCC DS
RECEIVED**
01/11/2022
APPLICATION REF
A006125616

M.R.F

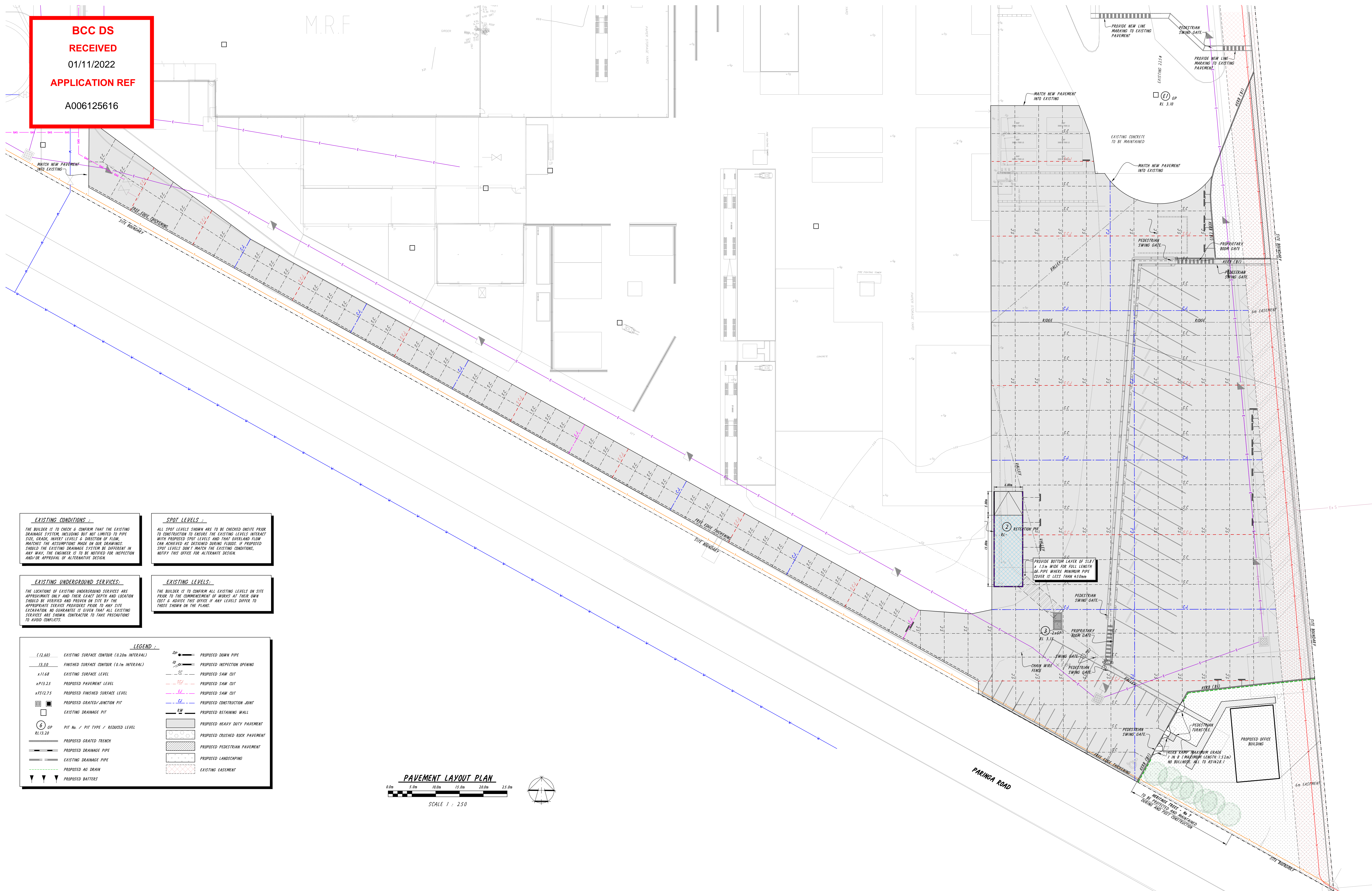

EXISTING CONDITIONS:
THE BUILDER IS TO CHECK & CONFIRM THAT THE EXISTING DRAINAGE SYSTEM, INCLUDING BUT NOT LIMITED TO PIPE SIZE, GRADE, INVERT LEVELS & DIRECTION OF FLOW, MATCHES THE ASSUMPTIONS MADE ON OUR DRAWINGS. SHOULD THE EXISTING DRAINAGE SYSTEM BE DIFFERENT IN ANY WAY, THE ENGINEER IS TO BE NOTIFIED FOR INSPECTION AND/OR APPROVAL OF ALTERNATIVE DESIGN.

SPOT LEVELS:
ALL SPOT LEVELS SHOWN ARE TO BE CHECKED ON SITE PRIOR TO CONSTRUCTION TO ENSURE THE EXISTING LEVELS INTERACT WITH PROPOSED SPOT LEVELS AND THAT OVERLAND FLOW CAN ACHIEVED AS DESIGNED DURING FLOODS. IF PROPOSED SPOT LEVELS DON'T MATCH THE EXISTING CONDITIONS, NOTIFY THIS OFFICE FOR ALTERNATE DESIGN.

EXISTING UNDERGROUND SERVICES:
THE LOCATIONS OF EXISTING UNDERGROUND SERVICES ARE APPROXIMATE ONLY AND THEIR EXACT DEPTH AND LOCATION SHOULD BE VERIFIED AND PROVEN ON SITE BY THE APPROPRIATE SERVICE PROVIDERS PRIOR TO ANY SITE EXCAVATION. NO GUARANTEE IS GIVEN THAT ALL EXISTING SERVICES ARE SHOWN. CONTRACTOR TO TAKE PRECAUTIONS TO AVOID CONFLICTS.

EXISTING LEVELS:
THE BUILDER IS TO CONFIRM ALL EXISTING LEVELS ON SITE PRIOR TO THE COMMENCEMENT OF WORKS AT THEIR OWN COST & ADVISE THIS OFFICE IF ANY LEVELS DIFFER TO THOSE SHOWN ON THE PLANS.

LEGEND:

(12.60)	EXISTING SURFACE CONTOUR (0.20m INTERVAL)	DP	PROPOSED DOWN PIPE
13.50	FINISHED SURFACE CONTOUR (0.1m INTERVAL)	IO	PROPOSED INSPECTION OPENING
X11.6.8	EXISTING SURFACE LEVEL	SC	PROPOSED SAW CUT
AP13.25	PROPOSED PAVEMENT LEVEL	SCU	PROPOSED SAW CUT
AF12.75	PROPOSED FINISHED SURFACE LEVEL	SCV	PROPOSED SAW CUT
[Symbol]	PROPOSED GRATED/JUNCTION PIT	CJ	PROPOSED CONSTRUCTION JOINT
[Symbol]	EXISTING DRAINAGE PIT	RW	PROPOSED RETAINING WALL
(E) OP	PIT No. / PIT TYPE / REDUCED LEVEL	[Symbol]	PROPOSED HEAVY DUTY PAVEMENT
RL13.20		[Symbol]	PROPOSED CRUSHED ROCK PAVEMENT
[Symbol]	PROPOSED GRATED TRENCH	[Symbol]	PROPOSED PEDESTRIAN PAVEMENT
[Symbol]	PROPOSED DRAINAGE PIPE	[Symbol]	PROPOSED LANDSCAPING
[Symbol]	EXISTING DRAINAGE PIPE	[Symbol]	EXISTING EASEMENT
[Symbol]	PROPOSED AG DRAIN		
[Symbol]	PROPOSED BATTERS		

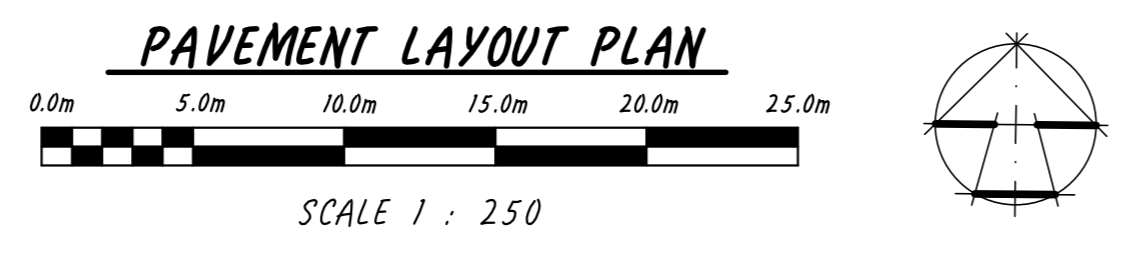

PRELIMINARY
THIS DRAWING IS FOR INFORMATION ONLY
NOT FOR CONSTRUCTION PURPOSES
26 October 2022

DATE	DESCRIPTION	BY
26.10.22	P4 ISSUED FOR INFORMATION	TM
24.08.22	P3 ISSUED FOR INFORMATION	TM
12.08.22	P2 ISSUED FOR INFORMATION	TM
05.08.22	P1 ISSUED FOR INFORMATION	AA

revision history

© COPYRIGHT
All rights reserved. No part of these plans or accompanying computations may be reproduced or modified in any form without the written permission of Klopfer Dobos Pty. Ltd.

KD ENGINEERING
STRUCTURAL | CIVIL

1 03 9415 3000
info@kloferdobos.com.au
www.kloferdobos.com.au

architect/designer: **VISY PAPER** TEL: (03) 9329 0806
drawing title: **PAVEMENT LAYOUT PLAN**
project details: **CIVIL ENGINEERING PLANS FOR: PROPOSED INDUSTRIAL DEVELOPMENT 166, PARINGA ROAD, MURARRIE, QLD**
job/sheet number: **18863-C2** 3 OF 5

designed: **ALEX STOJANOVSKI**
drawn: **ALLAN ABRAHAM**
scale: **1 : 250** AT A0
date: **JULY 2022**
revision: **P4**

BCC DS
RECEIVED
 01/11/2022
APPLICATION REF
 A006125616

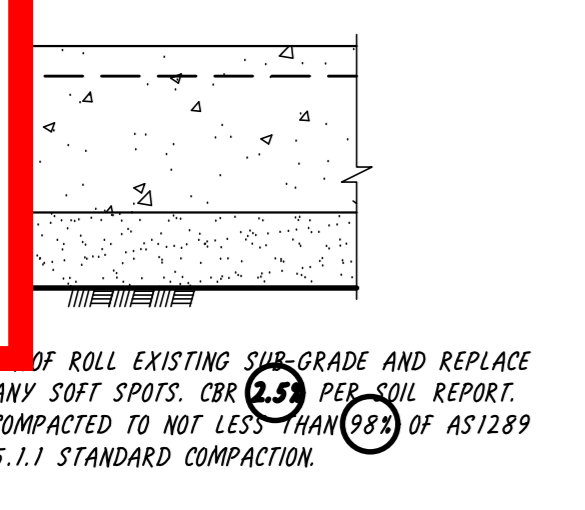

HEAVY DUTY CONCRETE PAVEMENT DETAIL
 (MAXIMUM AXLE LOAD 9.8 TONNE DUAL WHEELS)

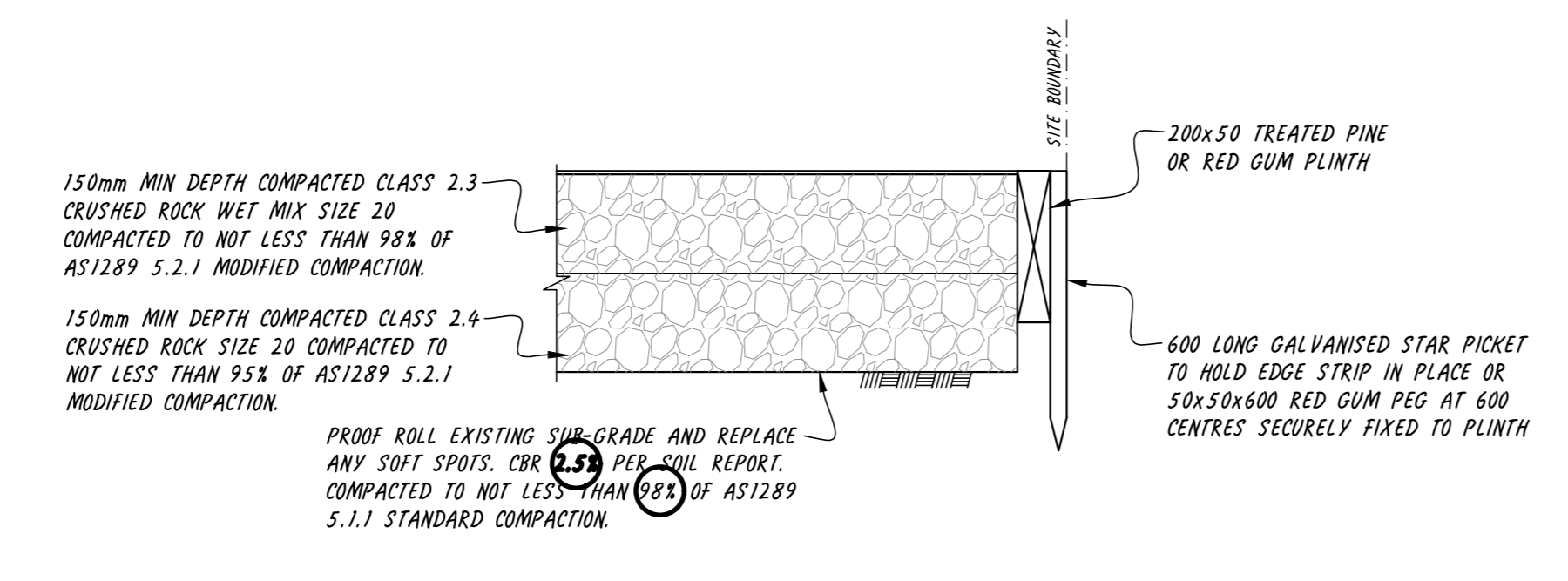

CRUSHED ROCK PAVEMENT
 (VALUES BASED ON 2 x 10 TONNES)

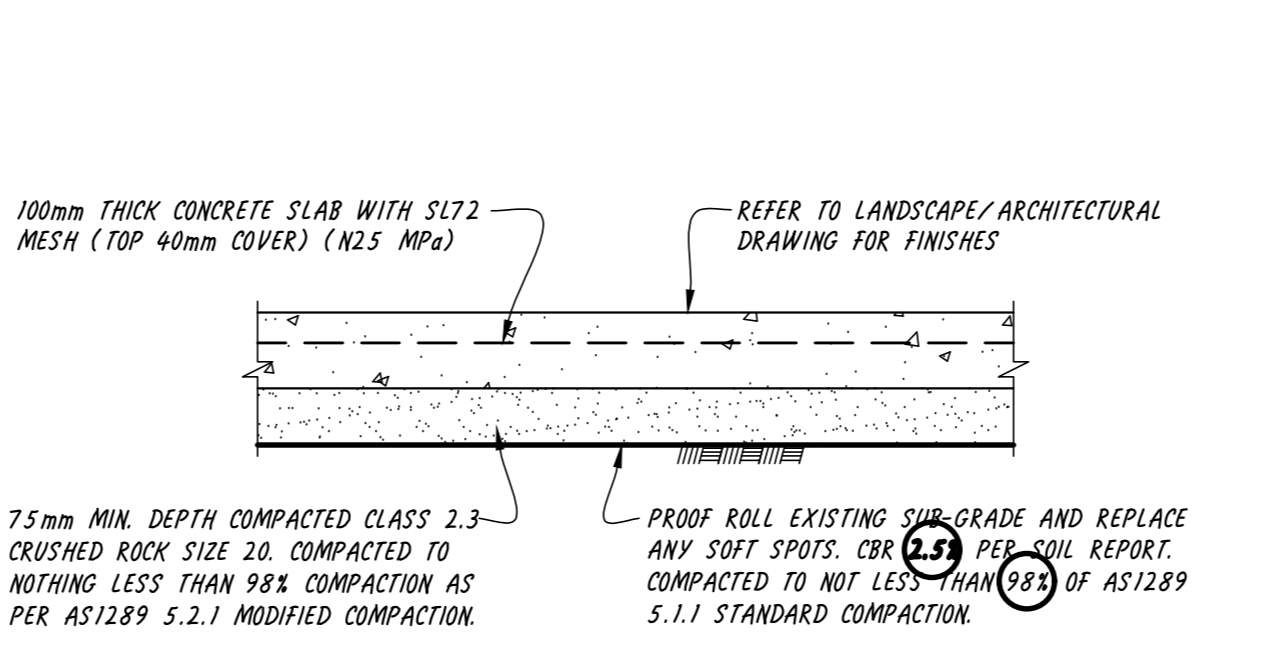

CONCRETE FOOTPATH DETAIL

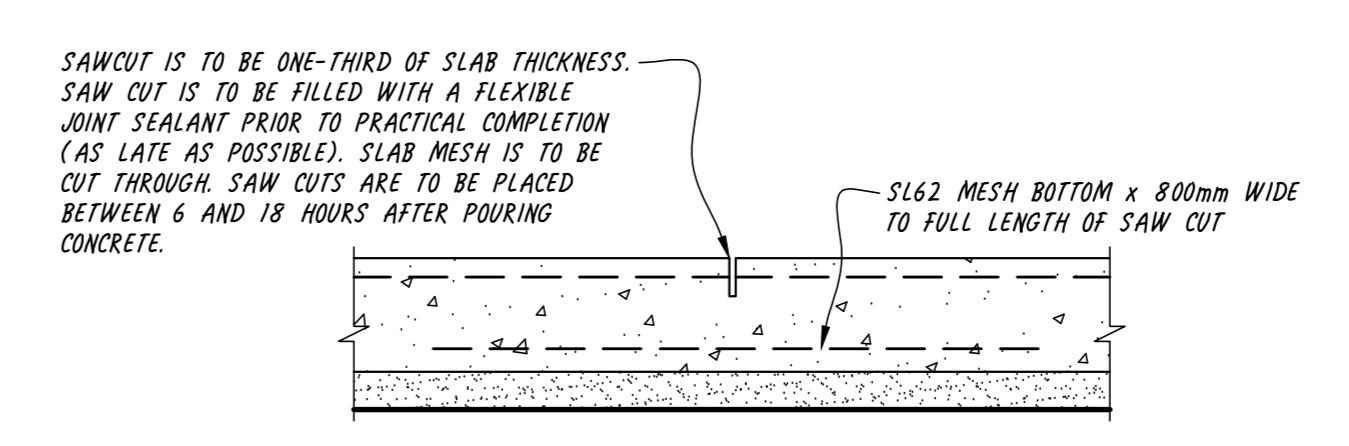

SAW CUT JOINT 'SC'

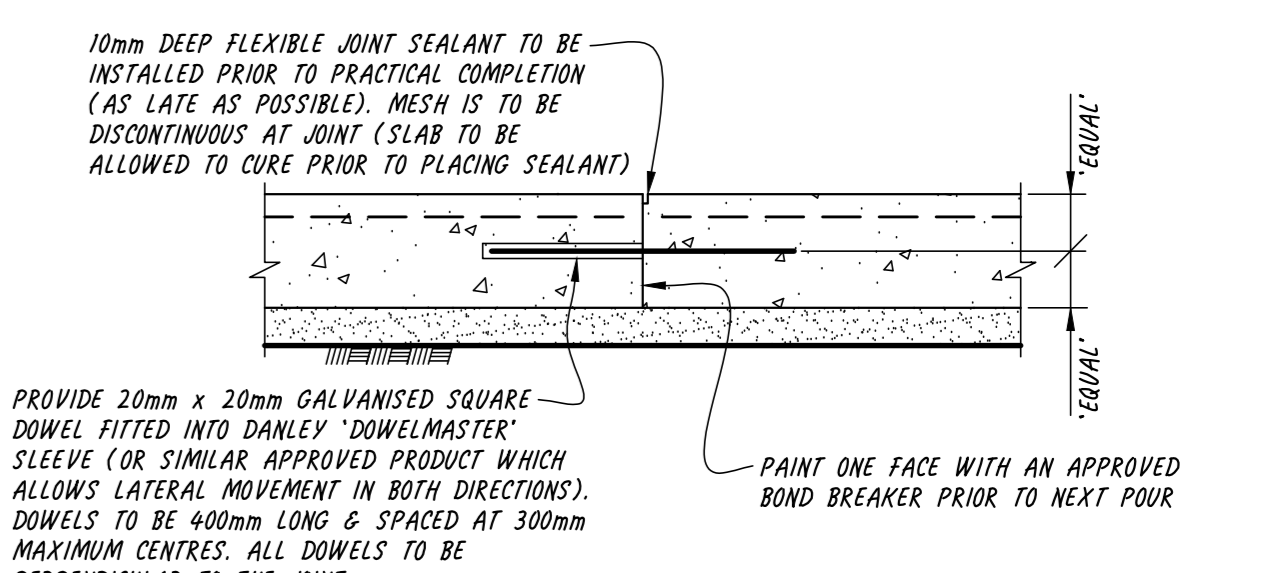

CONSTRUCTION JOINT 'CJ'

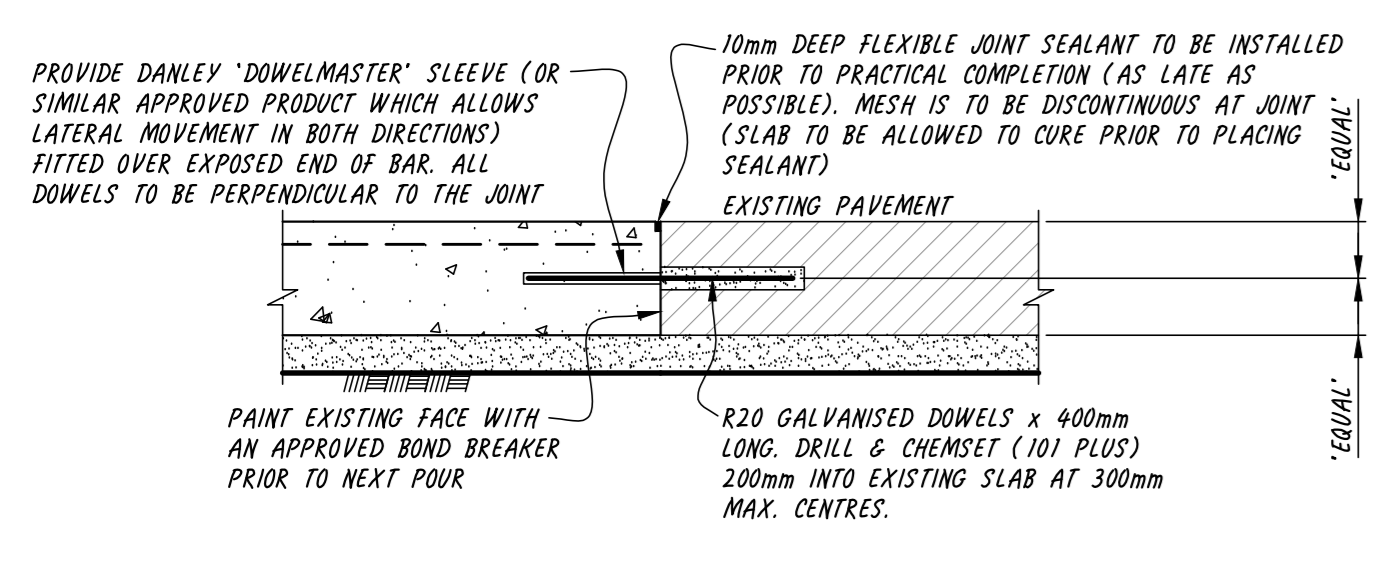

NEW PAVEMENT CONNECTION TO EXISTING
 * TO BE PROVIDED WHEREVER A NEW SLAB ABUTS AN EXISTING SLAB

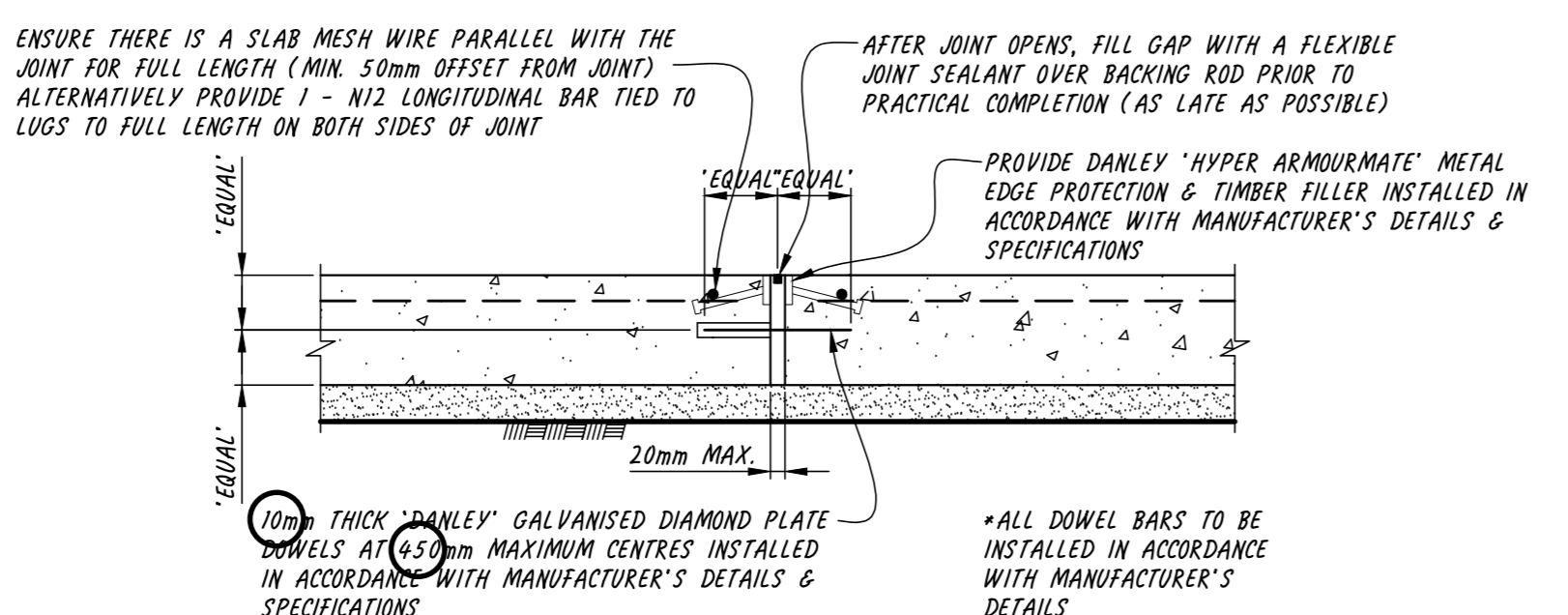

EXPANSION JOINT 'EJ'

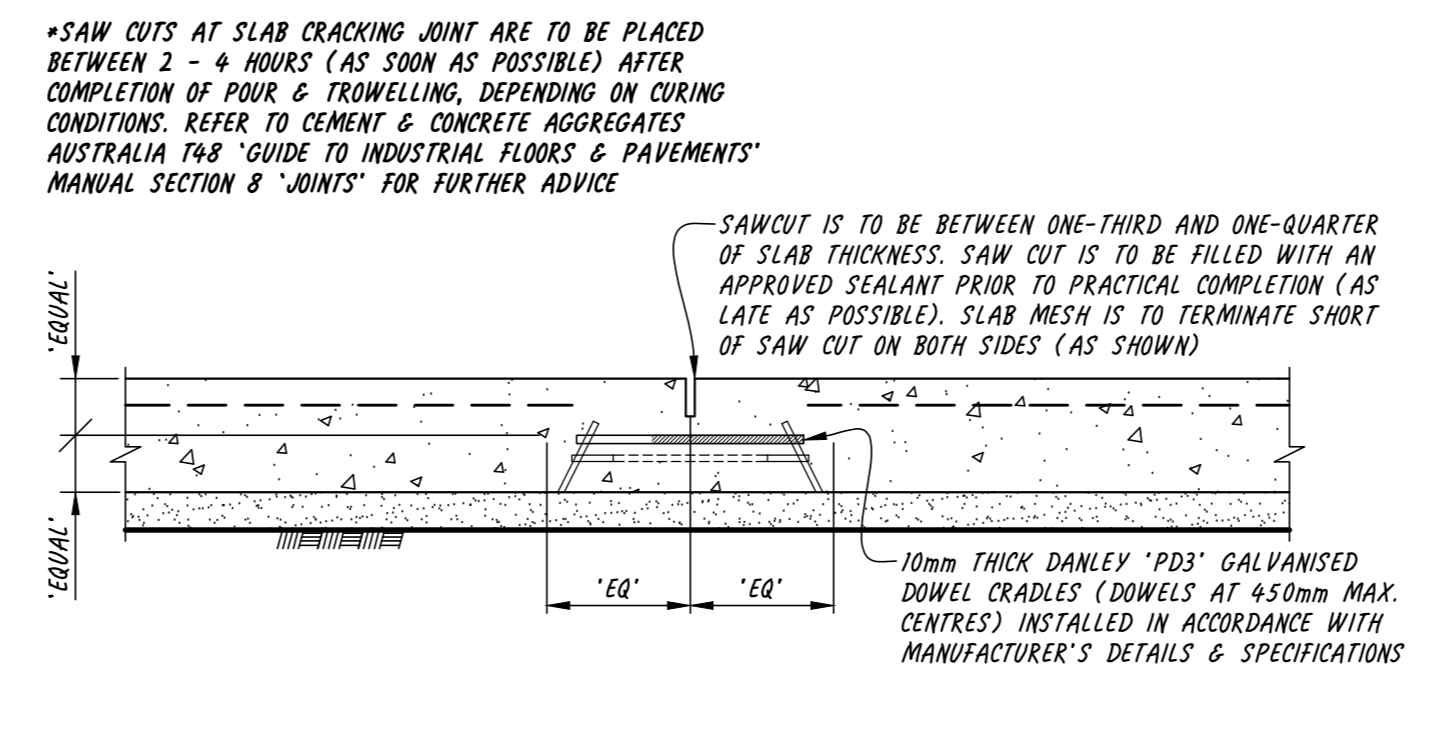

SLAB CRACKING JOINT 'SCJ'

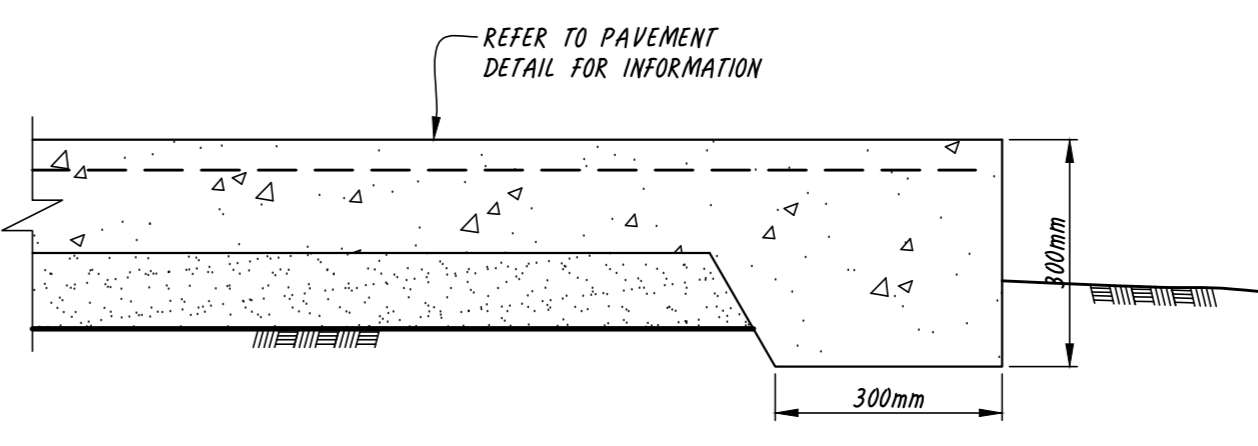

FREE EDGE THICKENING

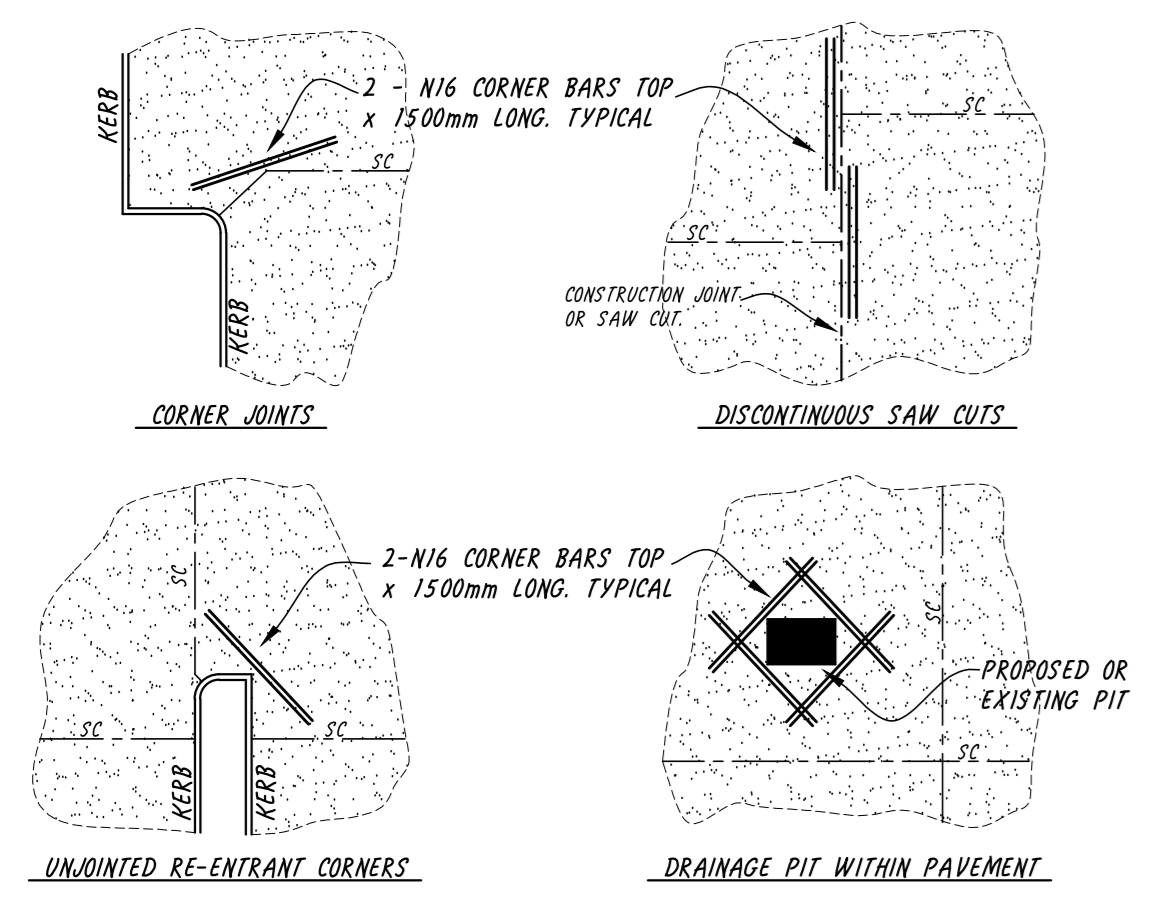

TYPICAL CORNER BAR DETAILS
 * CORNER BARS NOT SHOWN ON PLAN

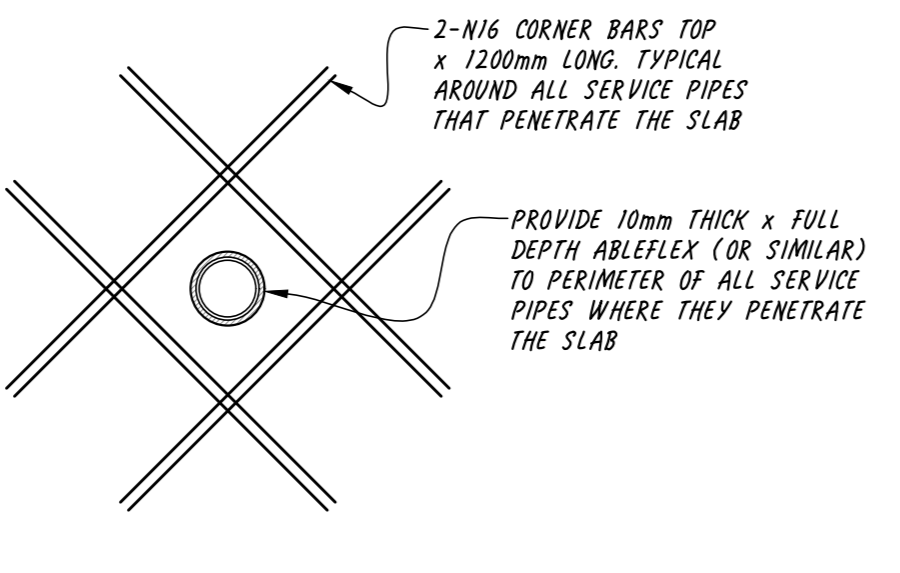

TYPICAL SERVICE PIPE CORNER BAR DETAILS
 * CORNER BARS & PIPES NOT SHOWN ON PLAN

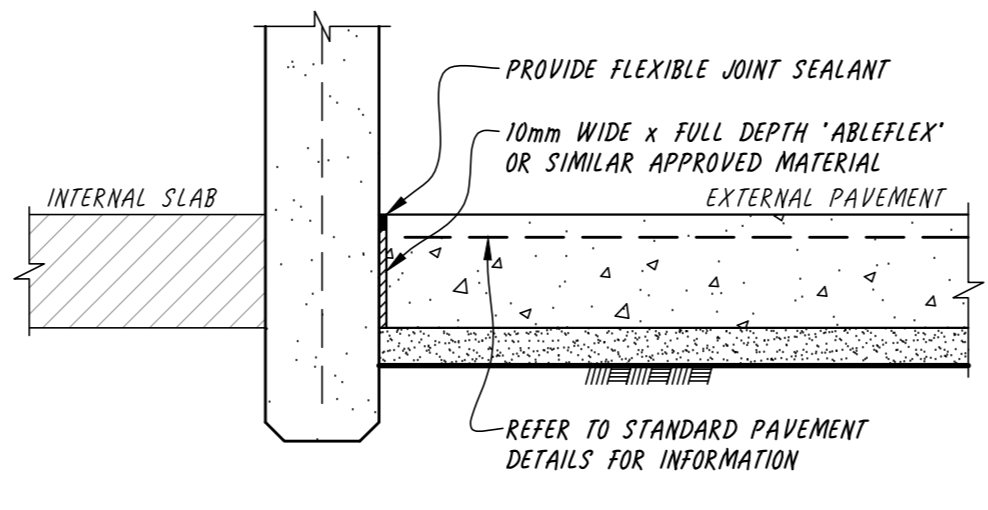

EXTERNAL SLAB TO PANEL JOINT DETAIL

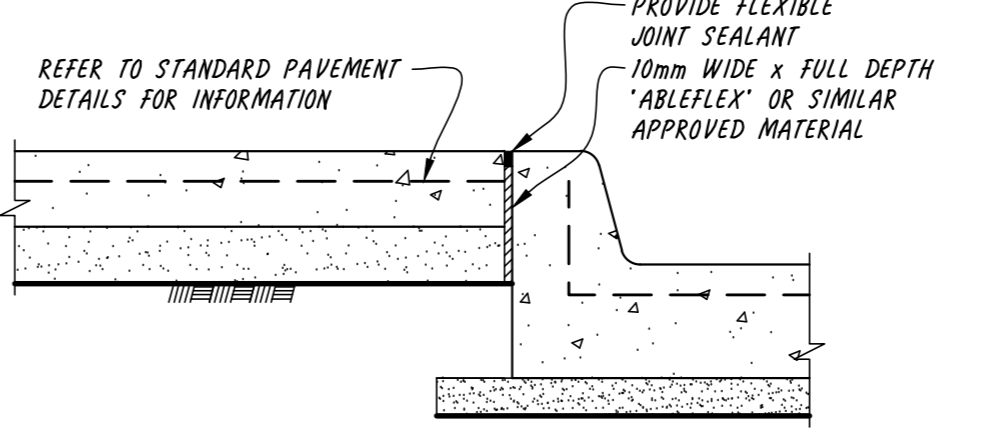

CONCRETE FOOTPATH TO KERB JOINT DETAIL

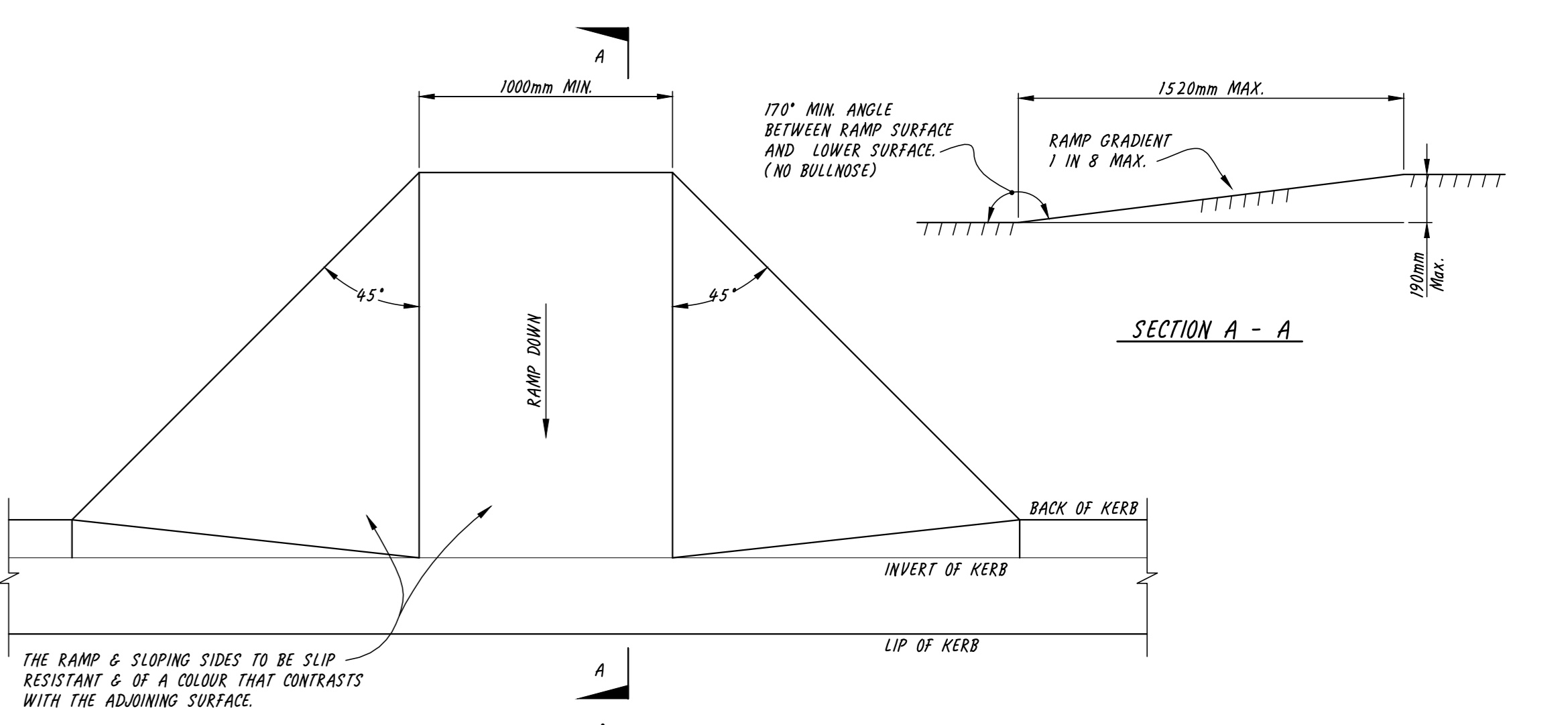

KERB RAMP
 PEDESTRIAN RAMP TO BE CONSTRUCTED IN ACCORDANCE WITH REQUIREMENTS AS 1428.1 & AS 2890.1
 SCALE 1:20

PRELIMINARY
 THIS DRAWING IS FOR INFORMATION ONLY
 NOT FOR CONSTRUCTION PURPOSES
 26 October 2022

DATE	DESCRIPTION	BY
26.10.22	P4 ISSUED FOR INFORMATION	TM
24.08.22	P3 ISSUED FOR INFORMATION	TM
12.08.22	P2 ISSUED FOR INFORMATION	TM
05.08.22	P1 ISSUED FOR INFORMATION	AL

© COPYRIGHT
 All rights reserved. No part of these plans or accompanying computations may be reproduced or modified in any form without the written permission of Klopfer Dobos Pty. Ltd.
 The use of these plans and the accompanying computations for certification or construction purposes without payment of fees due to Klopfer Dobos Pty. Ltd. is expressly prohibited.
 If any disputes or discrepancies arise from drawings transmitted electronically or otherwise, printed drawings files and/or printed copies stored at Klopfer Dobos Pty. Ltd. shall take precedence. Klopfer Dobos Pty. Ltd. takes no responsibility for damage (electronic or otherwise) which may have been modified by third parties.
 All other detail drawings (and/or subsequent construction) must be prepared using the most recent construction issue structural and/or civil drawings. It is the contractors responsibility to make certain that all drawings are the current issue.

KD ENGINEERING
 STRUCTURAL | CIVIL

Klopfer Dobos Pty. Ltd.
 ABN 11 107 284 757
 166 Hoddle Street
 Adelaide Victoria 3067
 T 03 9415 3000
 E info@klopferdobos.com.au
 W www.klopferdobos.com.au

architect/designer **VISION PAPER** TEL: (03) 9329 0806
 drawing title **DETAILS - SHEET 1**
 project details **CIVIL ENGINEERING PLANS FOR: PROPOSED INDUSTRIAL DEVELOPMENT 168, PARINGA ROAD, MURARRIE, QLD**
 job/sheet number **18863-C3** 4 OF 5

designed **ALEX STOJANOVSKI**
 drawn **ALLAN ABRAHAM**
 scale **1 : 10 U.N.O AT A0**
 date **JULY 2022**
 revision **P4**

BCC DS
RECEIVED
 01/11/2022
APPLICATION REF
 A006125616

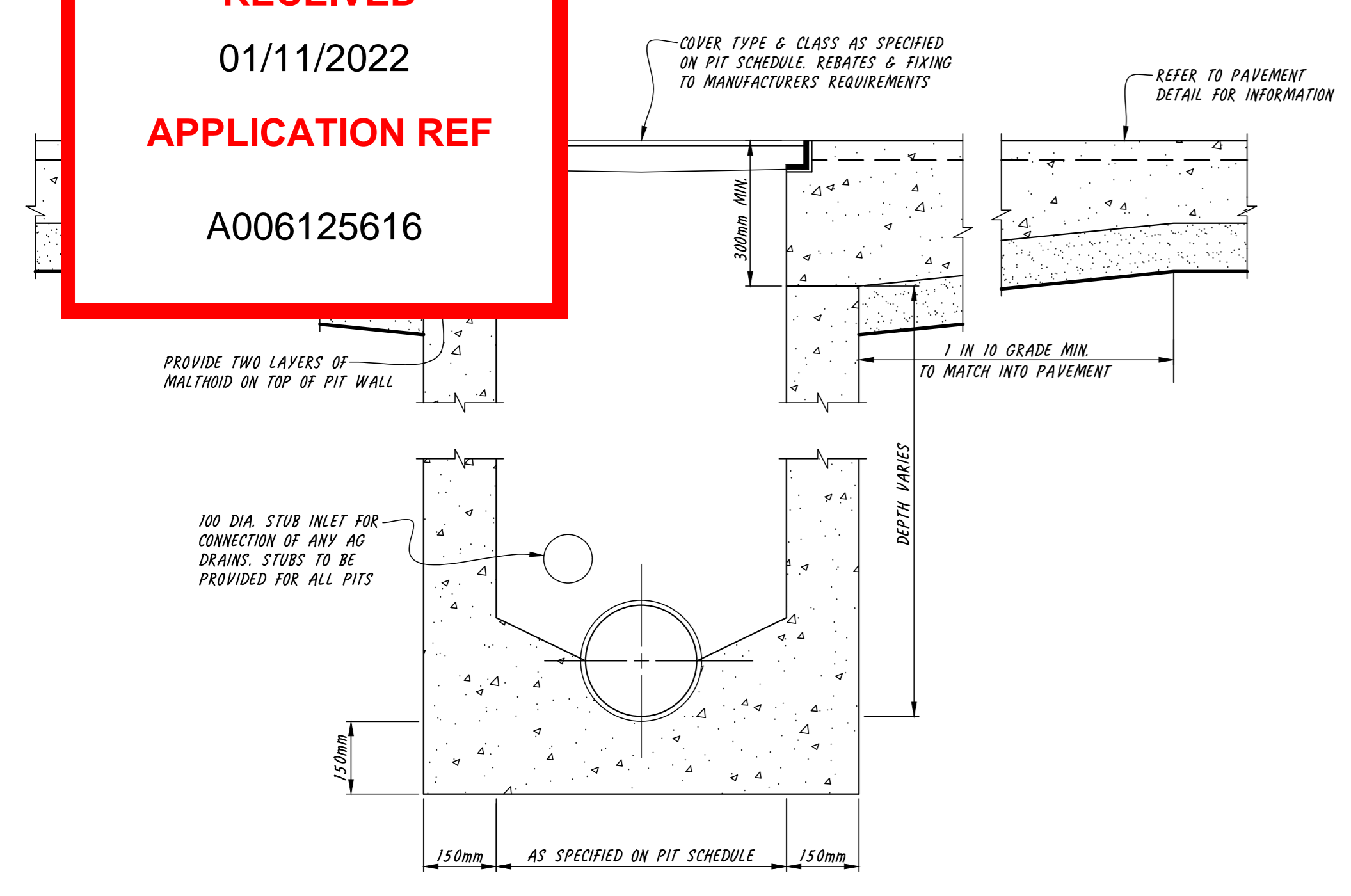

GRADED & JUNCTION PIT DETAIL WITHIN CONCRETE PAVED AREAS

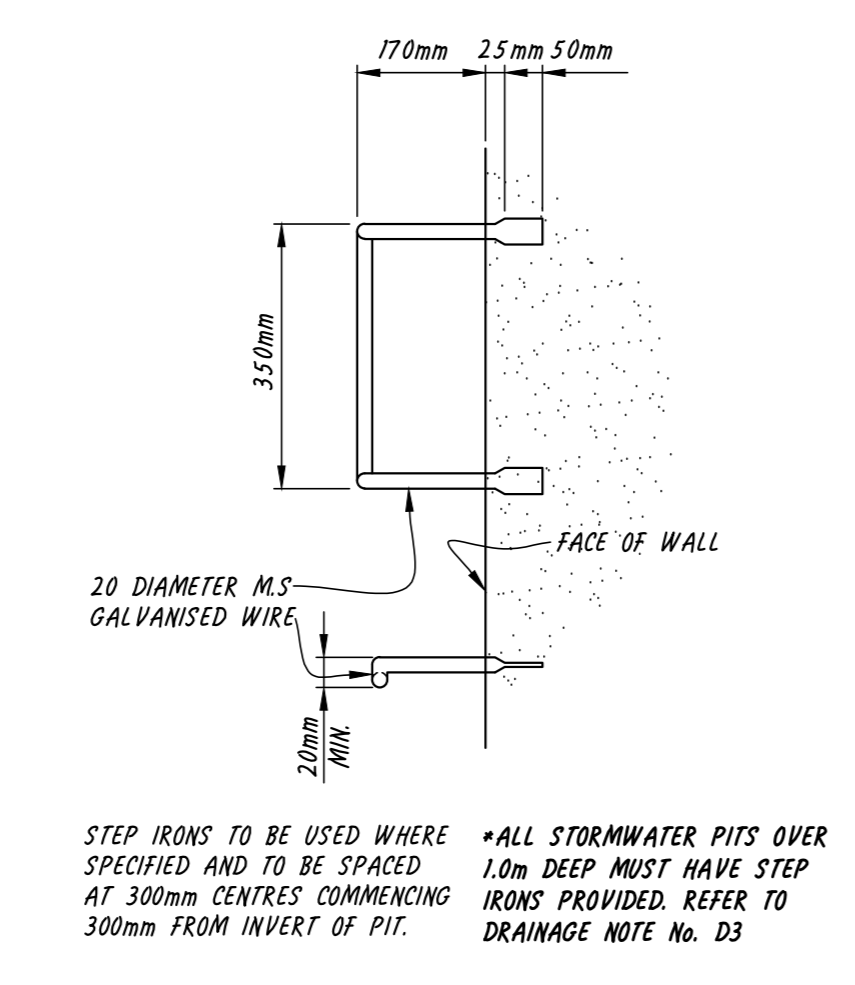

STEP IRON DETAIL
 REFER TO CLAUSE 7.6.3.3 OF AS1657

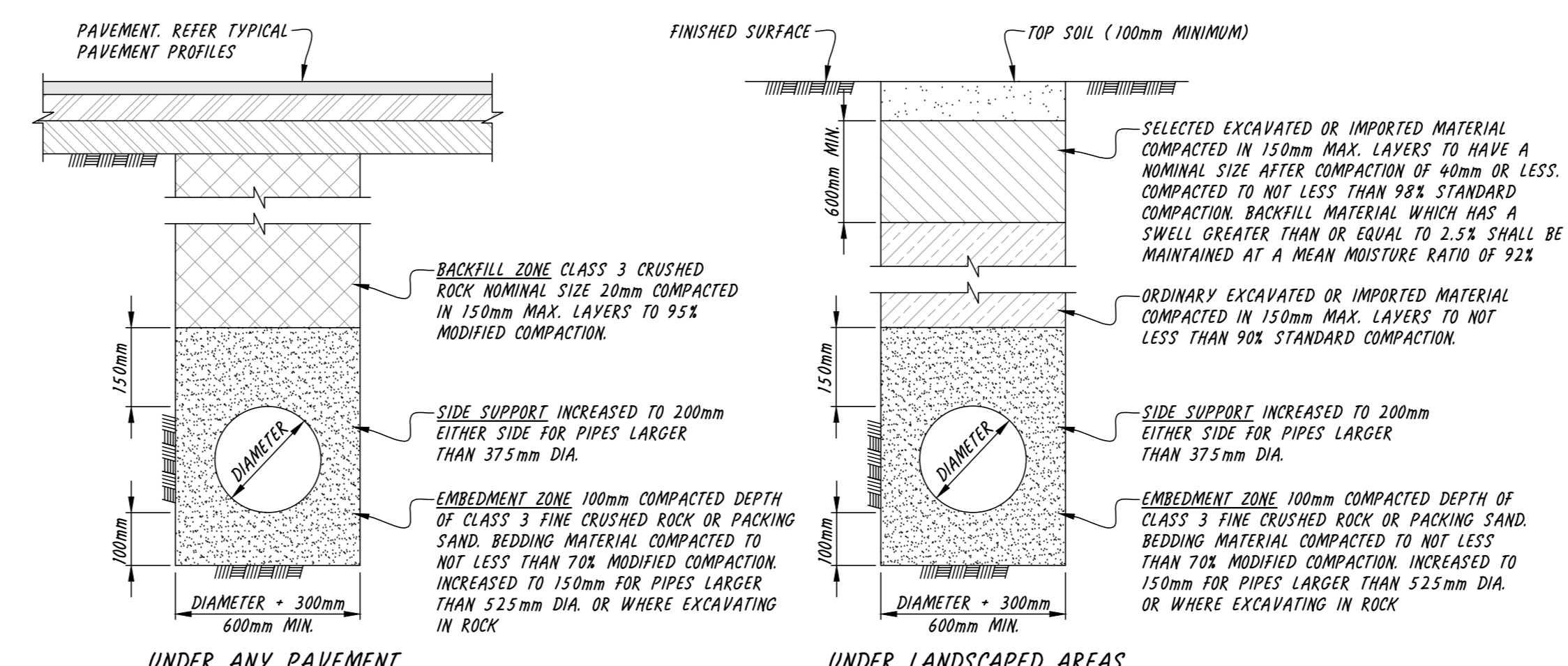

TYPICAL PIPE TRENCH DETAILS

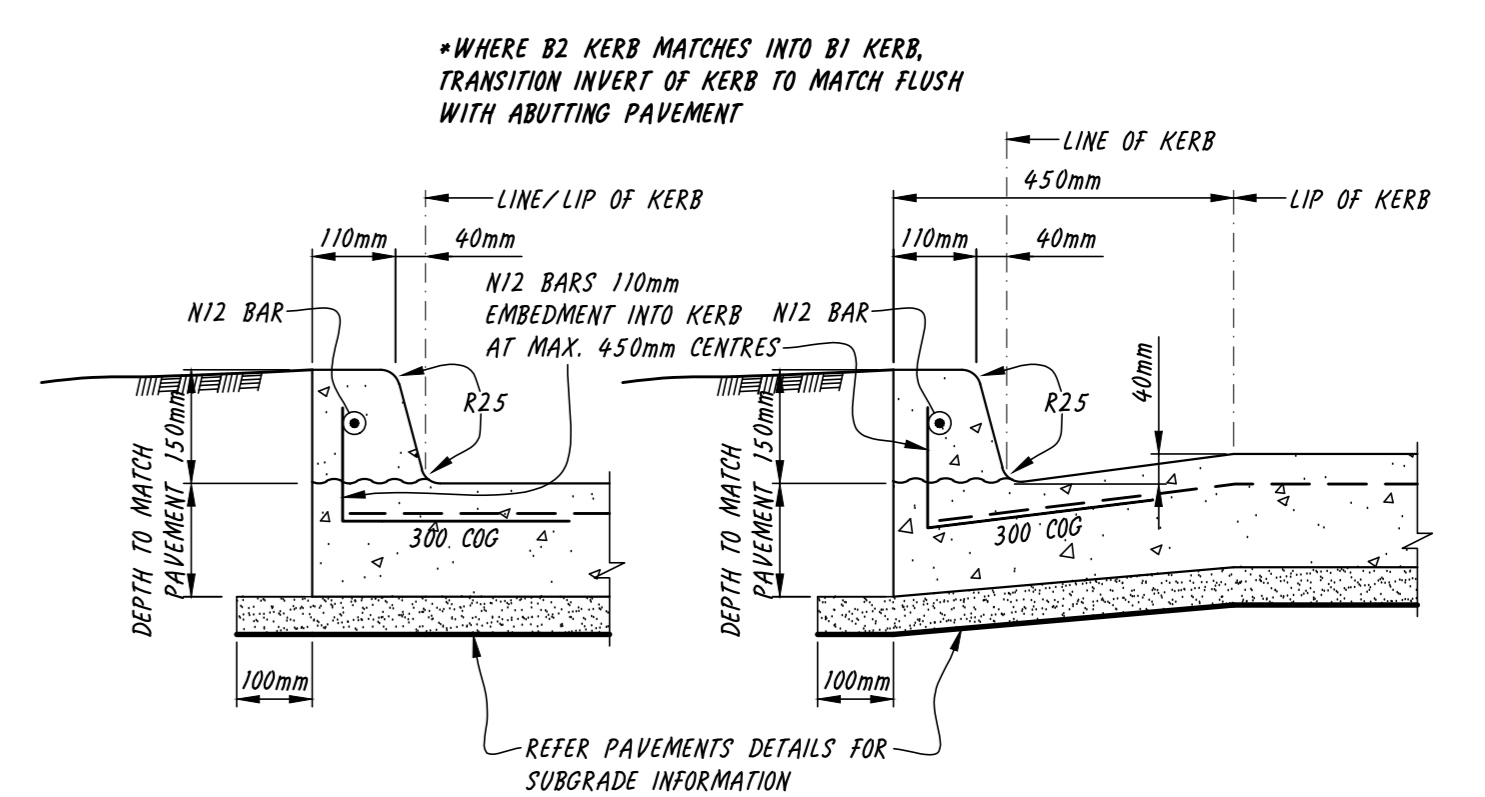

KERB DETAIL (B1) KERB & CHANNEL DETAIL (B2)
 KERB AND KERB & CHANNEL FOR CONCRETE HARDSTAND AREA

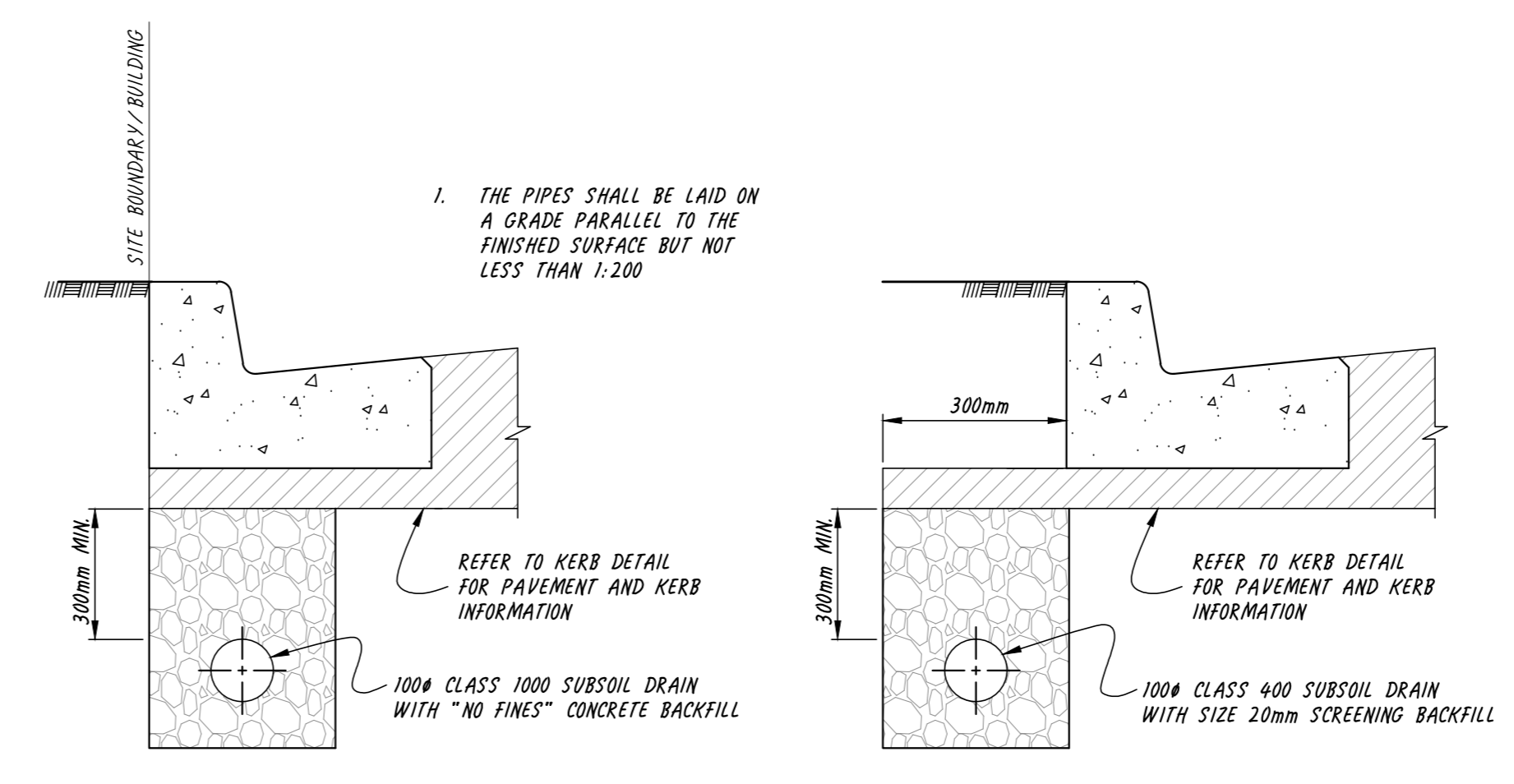

SUBSOIL DRAIN BEHIND / UNDER KERB

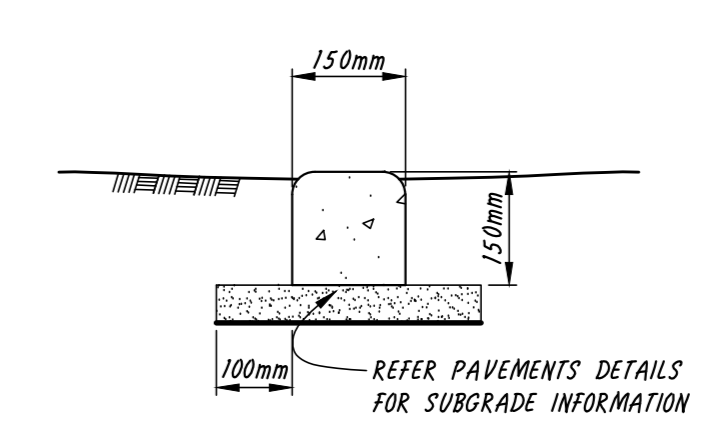

EDGE STRIP KERB DETAIL

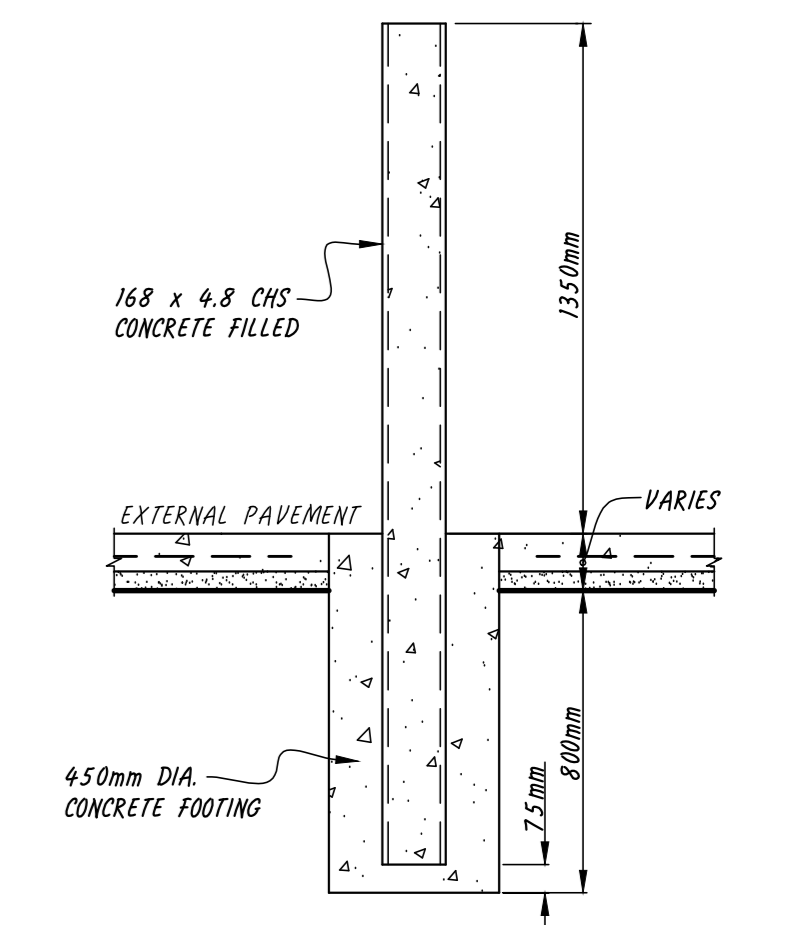

BOLLARD DETAIL
 REFER TO ARCHITECTURAL DRAWINGS FOR BOLLARD LOCATIONS
 SCALE: 1 : 20

PRELIMINARY
 THIS DRAWING IS FOR INFORMATION ONLY
 NOT FOR CONSTRUCTION PURPOSES
 26 October 2022

DATE	ISSUED FOR	BY	REVISION HISTORY
26.10.22	P4 ISSUED FOR INFORMATION	TM	
24.08.22	P3 ISSUED FOR INFORMATION	TM	
12.08.22	P2 ISSUED FOR INFORMATION	TM	
05.08.22	P1 ISSUED FOR INFORMATION	AL	

© COPYRIGHT
 All rights reserved. No part of these plans or accompanying computations may be reproduced or modified in any form without the written permission of Klopfer Dobos Pty. Ltd.
 The use of these plans and the accompanying computations for certification or construction purposes without payment of fees due to Klopfer Dobos Pty. Ltd. is expressly prohibited.
 If any disputes or discrepancies arise from drawings transmitted electronically or otherwise, electronic drawing files and/or printed copies stored at Klopfer Dobos Pty. Ltd. shall take precedence. Klopfer Dobos Pty. Ltd. takes no responsibility for drawings (electronic or otherwise) which may have been modified by third parties.
 All shop detail drawings (and/or subsequent construction) must be prepared with the most recent construction issue structural and/or civil drawings. It is the contractor's responsibility to make certain that all drawings are the current issue.

KD ENGINEERING
 STRUCTURAL | CIVIL

Klopfer Dobos Pty. Ltd.
 ABN 11 107 284 757
 166 Hoddle Street
 Abbotsford, Victoria 3067
 T 03 9415 3000
 E info@klopferdobos.com.au
 W www.klopferdobos.com.au

QUALITY
 ISO 9001:2015
 ISO 45001:2018

architect/designer **VISY PAPER** TEL: (03) 9329 0806
 drawing title **DETAILS - SHEET 2**
 project details **CIVIL ENGINEERING PLANS FOR:
 PROPOSED INDUSTRIAL DEVELOPMENT
 168, PARINGA ROAD,
 MURARRIE, QLD**
 job/sheet number **18863-C4** 5 OF 5

designed **ALEX STOJANOVSKI**
 drawn **ALLAN ABRAHAM**
 scale **1 : 10 U.N.O AT A0**
 date **JULY 2022**
 revision **P4**